

ALL DIMENSIONS ARE FINISHED

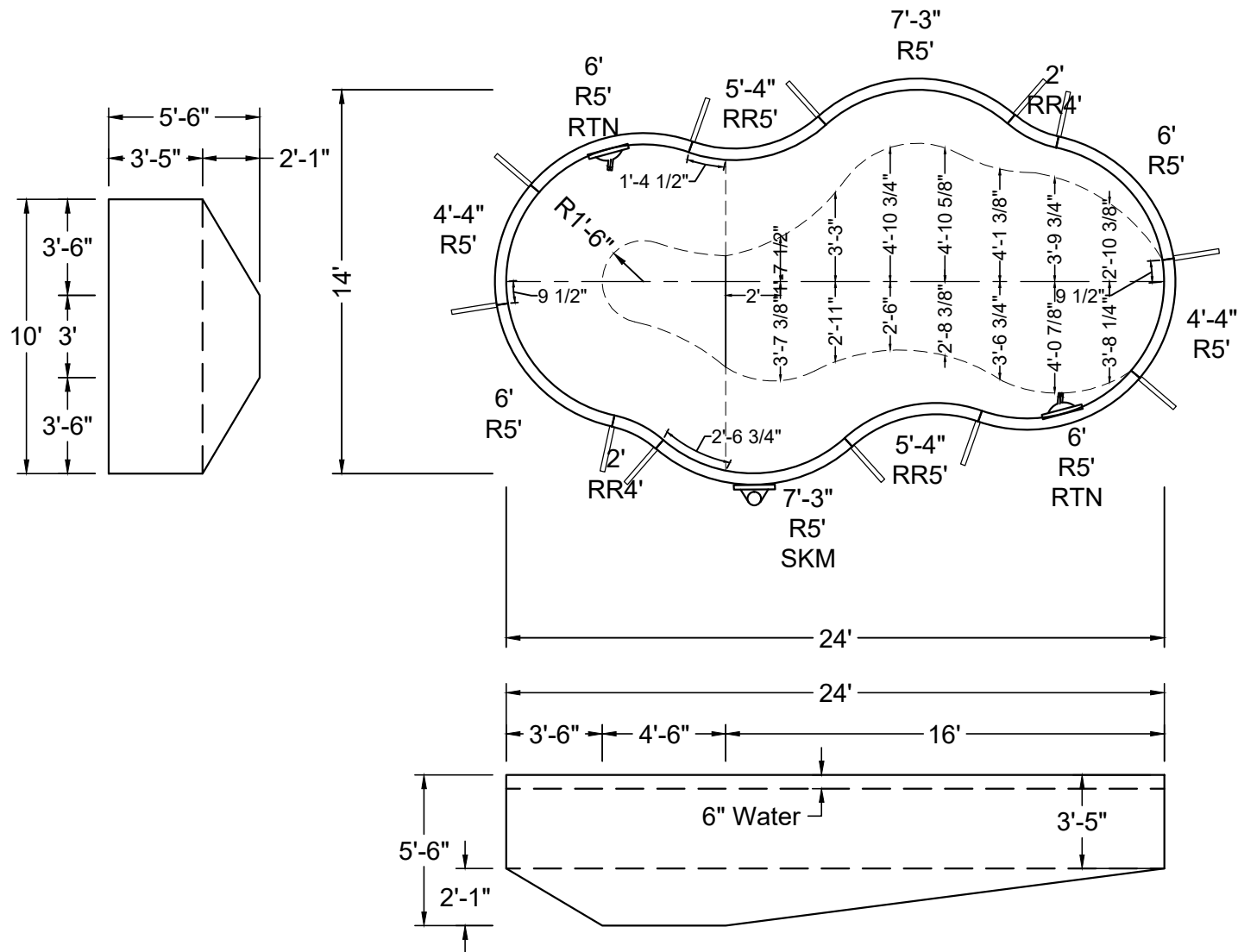

NON-DIVING POOL
USE OF DIVING EQUIPMENT IS PROHIBITED

MEETS DEPTH AND SHAPE MINIMUM STANDARD ANSI/NSPI5-2003



SHAPE : SAHARA	SIZE : 10' X 24'	HAND : LEFT	PANEL HEIGHT : 3'-6"	PANEL TYPE : 5" TOP
PERIMETER : 61'-10 9/32"	VOLUME : 7,665 US GAL.	SURFACE AREA : 237.773 SQ. FT.	SCALE : N.T.S	DRAWN BY : NM-BCC
DWG # : MN1424SA-19	DATE : 1/26/2017	REVISION # : 01	KIT REF : MN1424SA-19-L	A



MEETS DEPTH AND SHAPE MINIMUM STANDARD ANSI/NSPI5-2003

ALL DIMENSIONS ARE FINISHED

STEEL CHECK

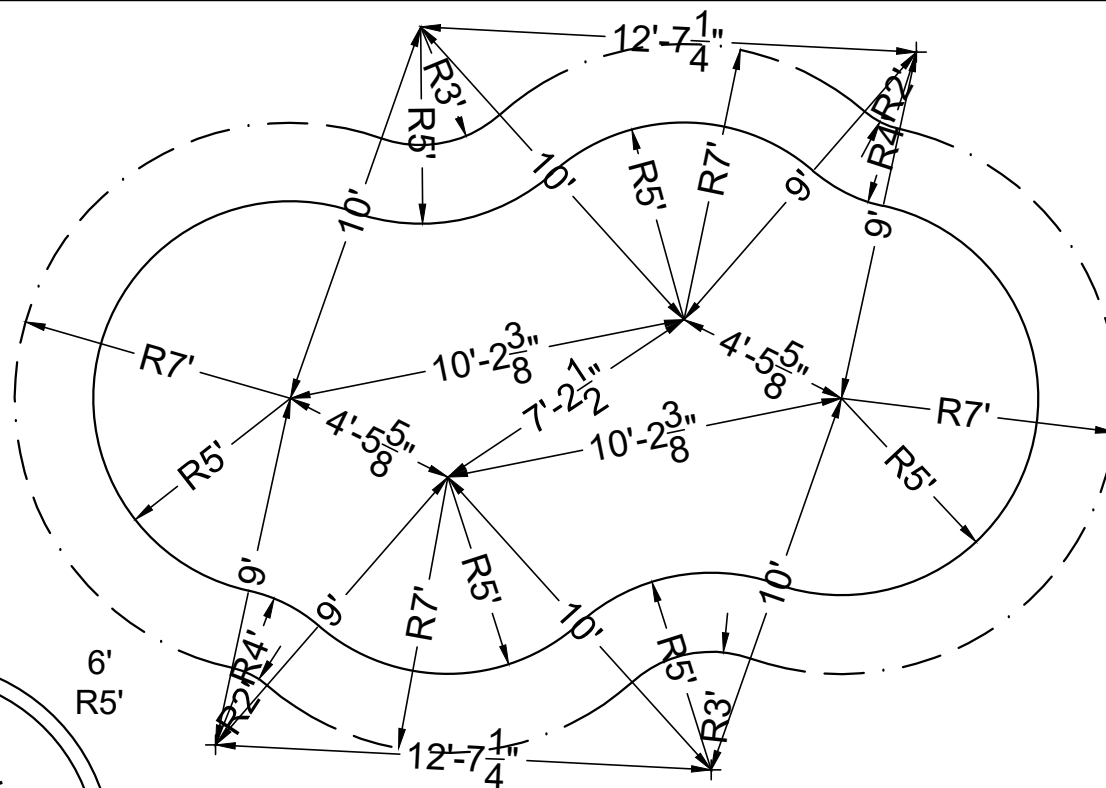
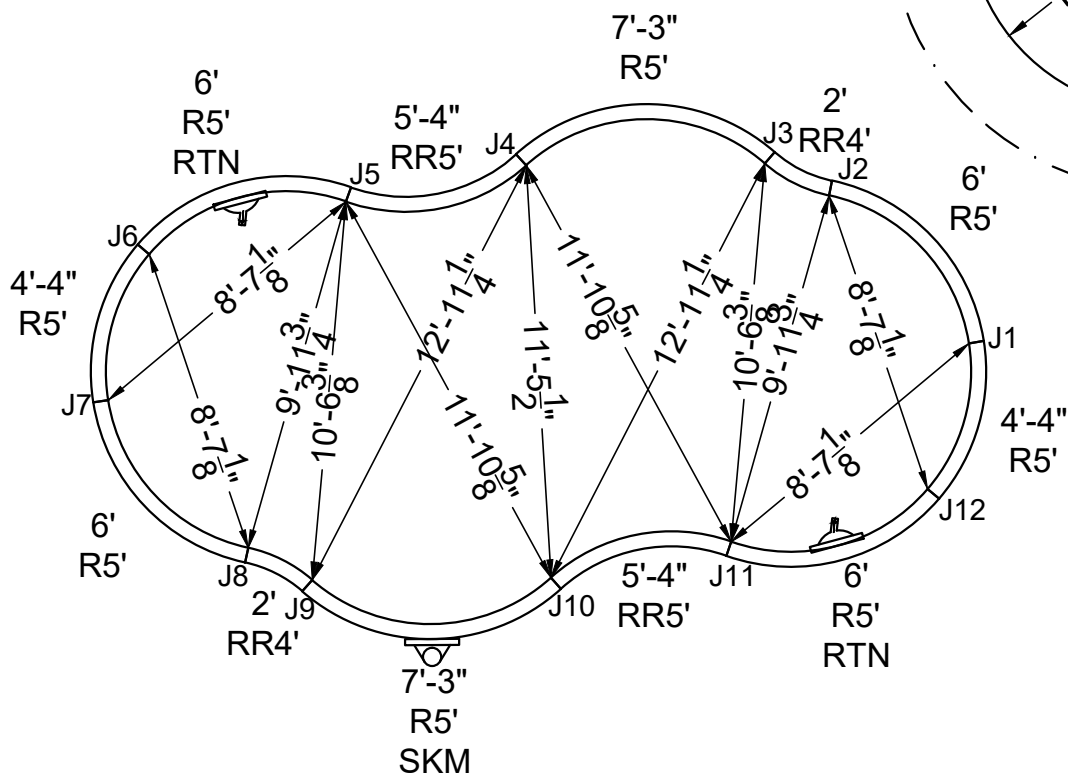

STAKE OUT

SHAPE : SAHARA	SIZE : 10' X 24'	HAND : LEFT	PANEL HEIGHT : 3'-6"	DRAWN BY : NM-BCC
DWG # : MN1424SA-19	DATE : 1/26/2017	REVISION # : 01	KIT REF : MN1424SA-19-L	B



USE OF DIVING EQUIPMENT IS PROHIBITED

MEETS DEPTH AND SHAPE MINIMUM STANDARD ANSI/NSPI5-2003

ALL DIMENSIONS ARE FINISHED

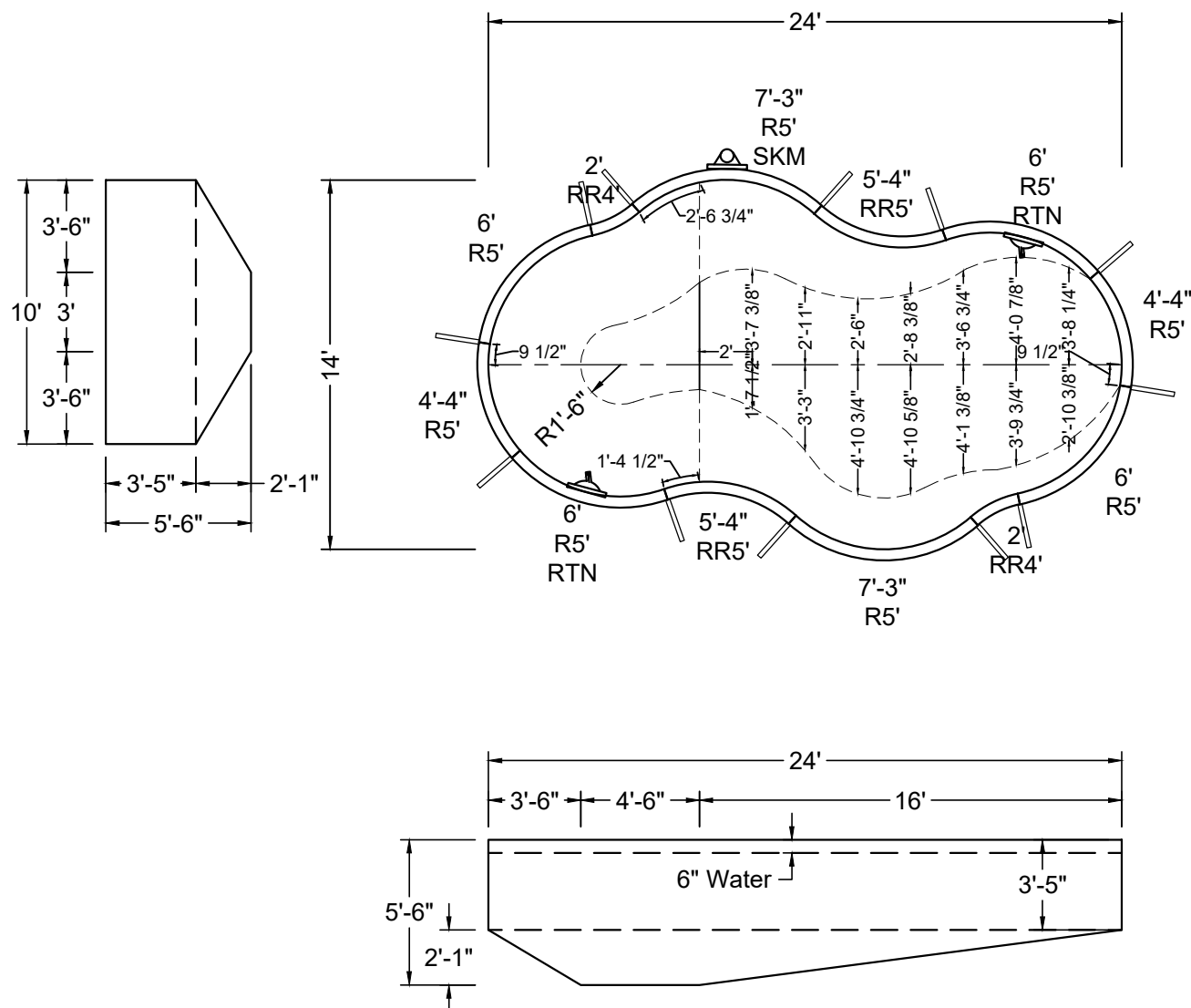

SHAPE : SAHARA	SIZE : 10' X 24'	HAND : RIGHT	PANEL HEIGHT : 3'-6"	PANEL TYPE : 5" TOP
PERIMETER : 61'-10 9/32"	VOLUME : 7,665 US GAL.	SURFACE AREA : 237.773 SQ. FT.	SCALE : N.T.S	DRAWN BY : NM-BCC
DWG # : MN1424SA-19	DATE : 1/26/2017	REVISION # : 01	KIT REF : MN1424SA-19-R	A

A



NON-DIVING POOL

USE OF DIVING EQUIPMENT IS PROHIBITED

MEETS DEPTH AND SHAPE MINIMUM STANDARD ANSI/NSPI5-2003

ALL DIMENSIONS ARE FINISHED

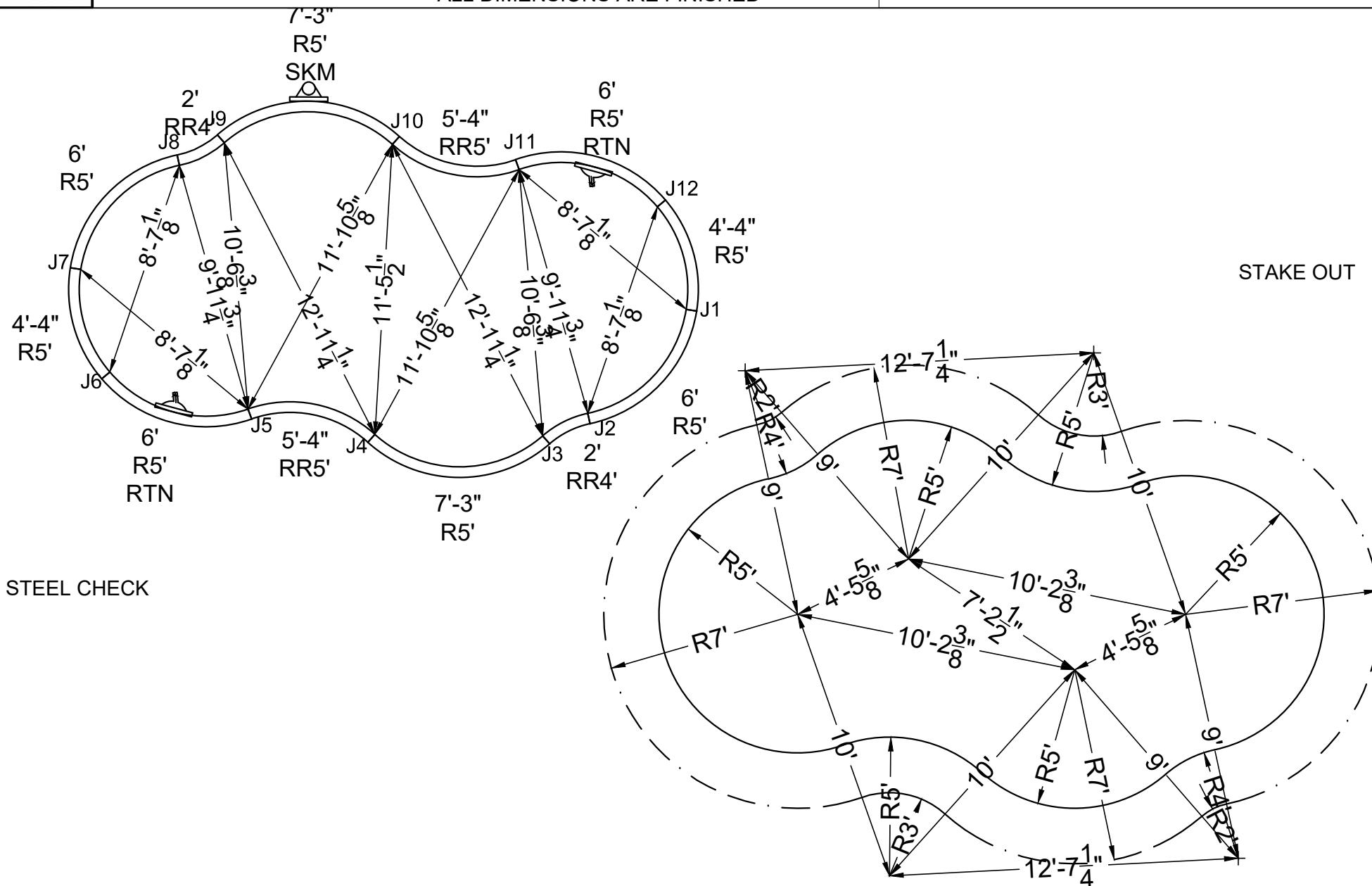

SHAPE : SAHARA

SIZE :	10' X 24'
--------	-----------

HAND : RIGHT

PANEL HEIGHT:	3'-6"
---------------	-------

DRAWN BY :	NM-BCC
------------	--------

DWG #: MN1424SA-19

DATE :	1/26/2017
--------	-----------

REVISION #:	01
-------------	----

KIT REF :	MN1424SA-19-R
-----------	---------------

BD

ALL DIMENSIONS ARE FINISHED



NON-DIVING POOL
USE OF DIVING EQUIPMENT IS PROHIBITED

MEETS DEPTH AND SHAPE MINIMUM STANDARD ANSI/NSPI5-2003

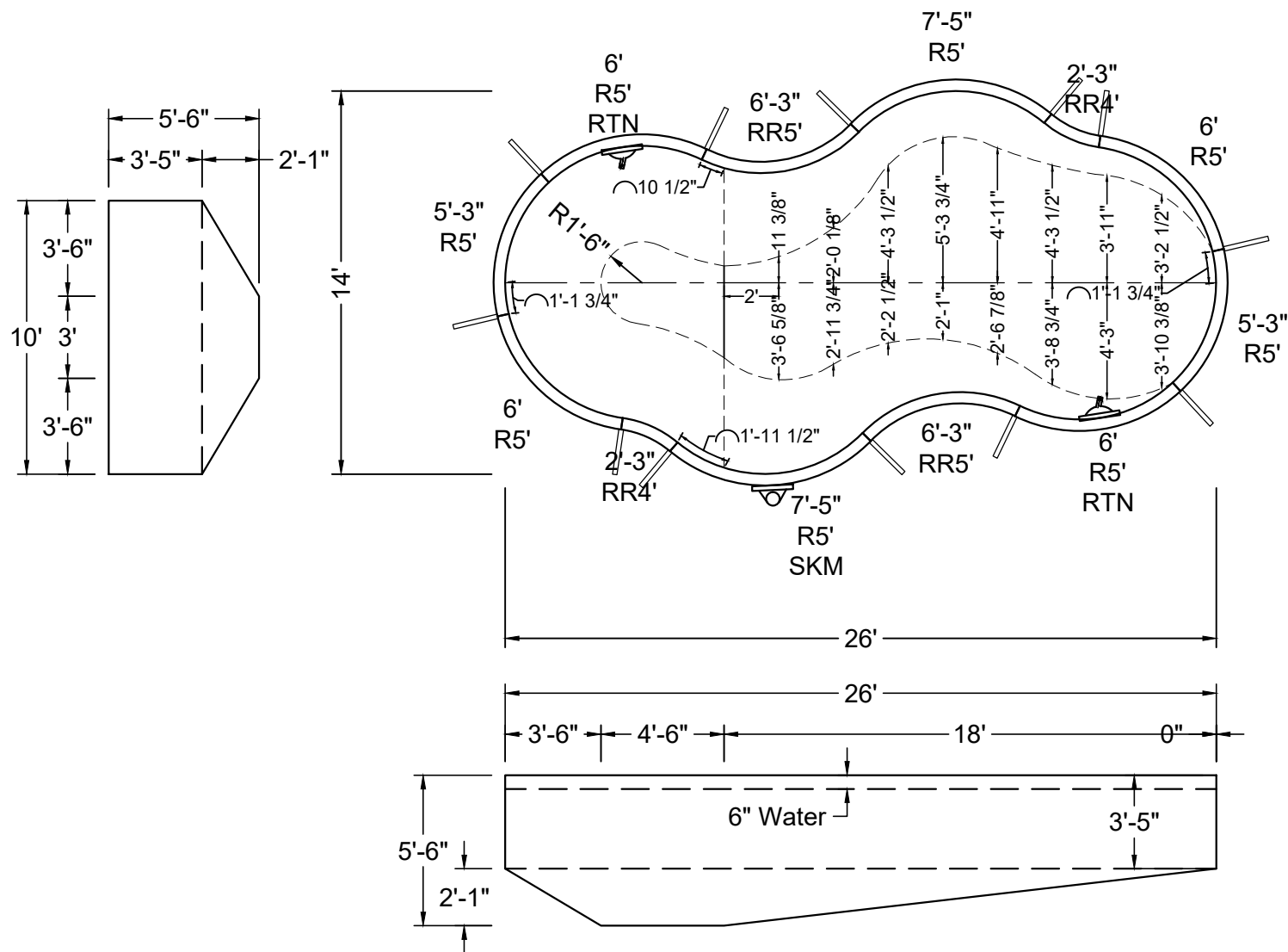

SHAPE : SAHARA	SIZE : 10' X 26'	HAND : LEFT	PANEL HEIGHT : 3'-6"	PANEL TYPE : 5" TOP
PERIMETER : 66'-3 27/32"	VOLUME : 8,161 US GAL.	SURFACE AREA : 252.941 SQ. FT.	SCALE : N.T.S	DRAWN BY : NM-BCC
DWG # : MN1426SA-19	DATE : 1/26/2017	REVISION # : 01	KIT REF : MN1426SA-19-L	A

ALL DIMENSIONS ARE FINISHED



NON-DIVING POOL
USE OF DIVING EQUIPMENT IS PROHIBITED

MEETS DEPTH AND SHAPE MINIMUM STANDARD ANSI/NSPI5-2003

STEEL CHECK

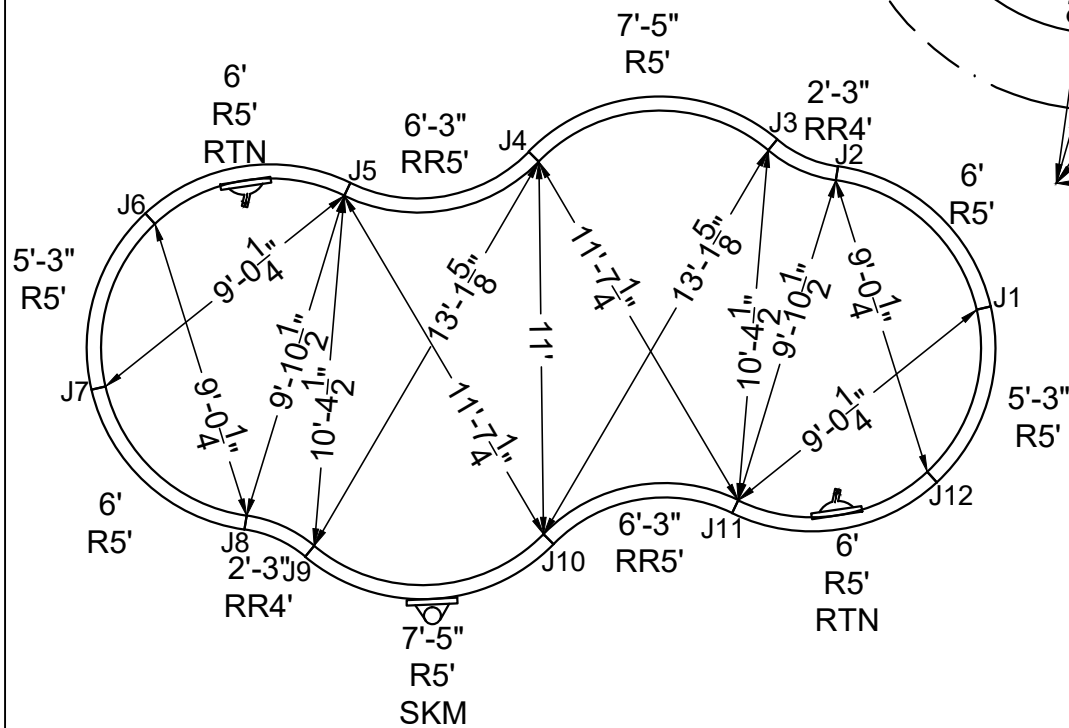

STAKE OUT

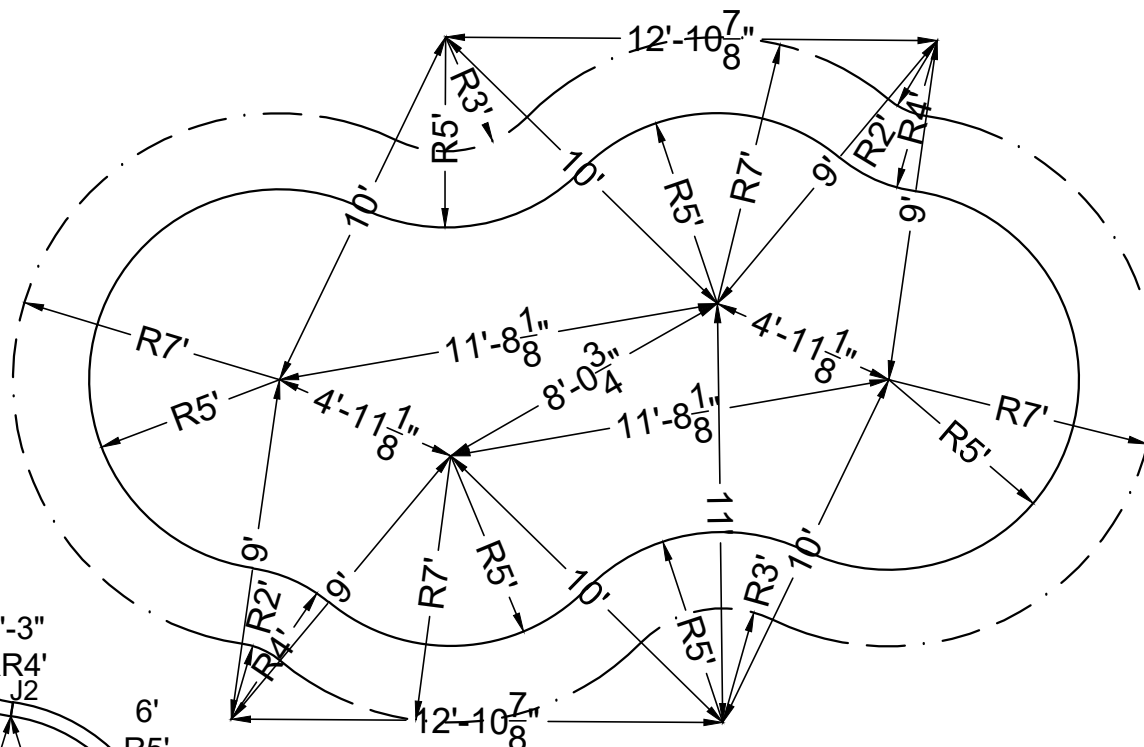

SHAPE : SAHARA	SIZE : 10' X 26'	HAND : LEFT	PANEL HEIGHT : 3'-6"	DRAWN BY : NM-BCC
DWG # : MN1426SA-19	DATE : 1/26/2017	REVISION # : 01	KIT REF : MN1426SA-19-L	B



NON-DIVING POOL
USE OF DIVING EQUIPMENT IS PROHIBITED

MEETS DEPTH AND SHAPE MINIMUM STANDARD ANSI/NSPI5-2003

ALL DIMENSIONS ARE FINISHED

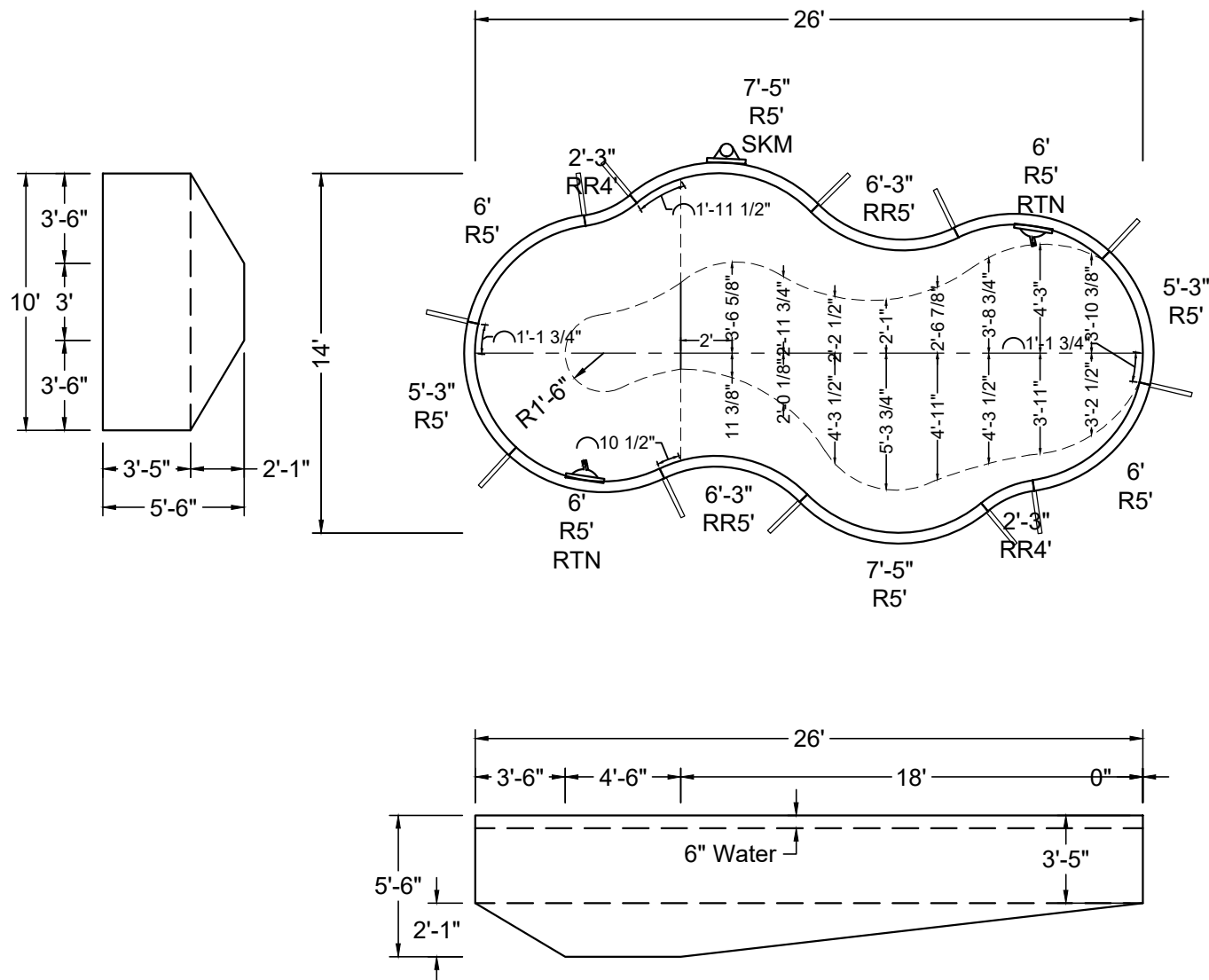

SHAPE : SAHARA	SIZE : 10' X 26'	HAND : RIGHT	PANEL HEIGHT : 3'-6"	PANEL TYPE : 5" TOP
PERIMETER : 66'-3 27/32"	VOLUME : 8,161 US GAL.	SURFACE AREA : 252.941 SQ. FT.	SCALE : N.T.S	DRAWN BY : NM-BCC
DWG # : MN1426SA-19	DATE : 1/26/2017	REVISION # : 01	KIT REF : MN1426SA-19-R	A

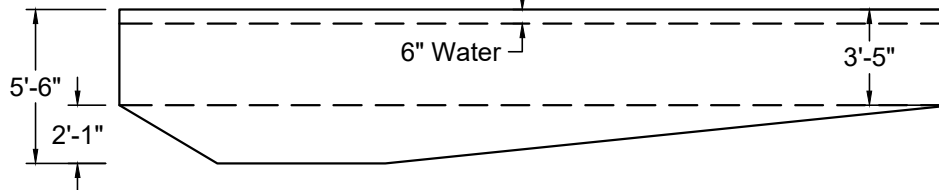

ALL DIMENSIONS ARE FINISHED

A

ALL DIMENSIONS ARE FINISHED



NON-DIVING POOL
USE OF DIVING EQUIPMENT IS PROHIBITED

MEETS DEPTH AND SHAPE MINIMUM STANDARD ANSI/NSPI-5-2003

STEEL CHECK

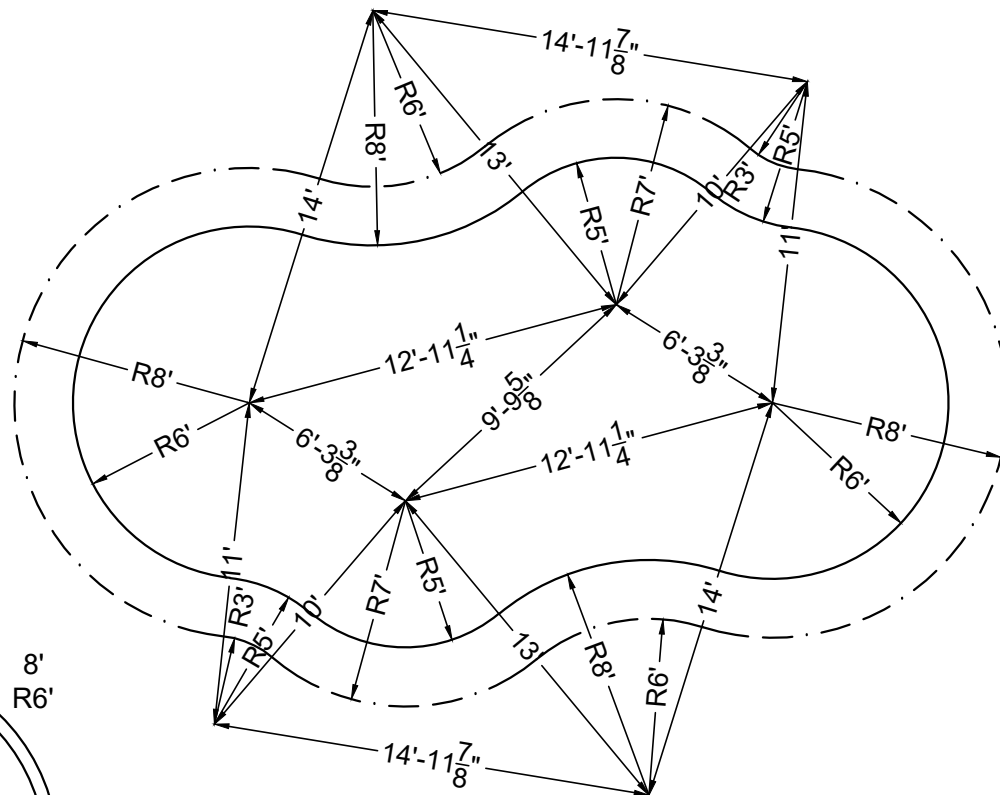
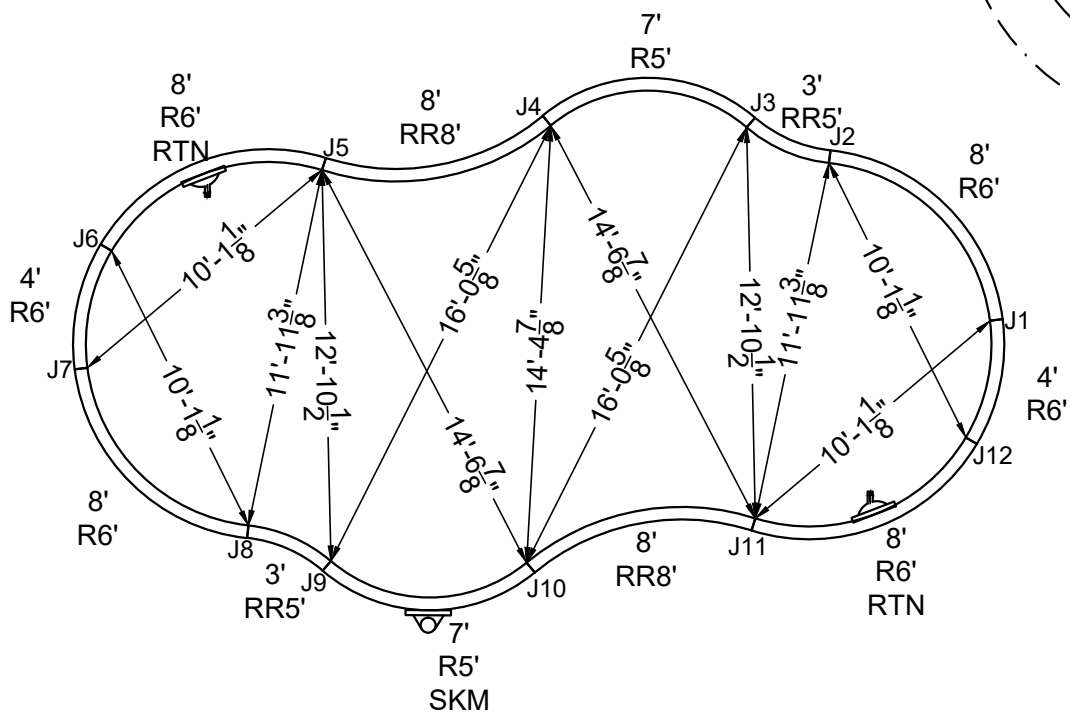

STAKE OUT

SHAPE : SAHARA	SIZE : 12' X 29'-10"	HAND : LEFT	PANEL HEIGHT : 3'-6"	DRAWN BY : NM-BCC
DWG # : MN1730SA-19	DATE : 1/26/2017	REVISION # : 01	KIT REF : MN1730SA-19-L	B

ALL DIMENSIONS ARE FINISHED



NON-DIVING POOL
USE OF DIVING EQUIPMENT IS PROHIBITED

MEETS DEPTH AND SHAPE MINIMUM STANDARD ANSI/NSPI5-2003

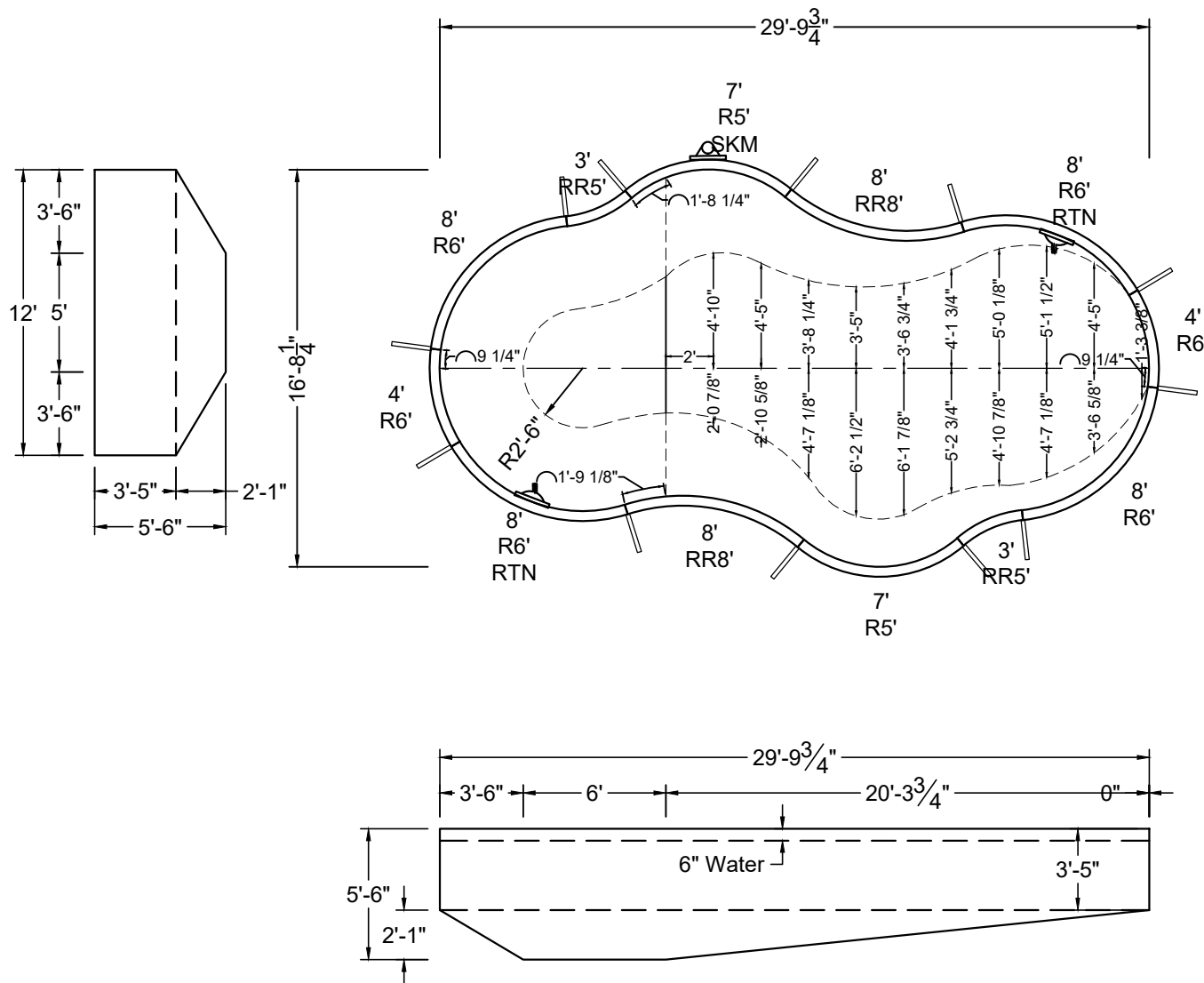

SHAPE : SAHARA	SIZE : 12' X 29'-10"	HAND : RIGHT	PANEL HEIGHT : 3'-6"	PANEL TYPE : 5" TOP
PERIMETER : 76'	VOLUME : 11,499 US GAL.	SURFACE AREA : 350.813 SQ. FT.	SCALE : N.T.S	DRAWN BY : NM-BCC
DWG # : MN1730SA-19	DATE : 1/26/2017	REVISION # : 01	KIT REF : MN1730SA-19-R	A

ALL DIMENSIONS ARE FINISHED



NON-DIVING POOL
USE OF DIVING EQUIPMENT IS PROHIBITED

MEETS DEPTH AND SHAPE MINIMUM STANDARD ANSI/NSPI5-2003

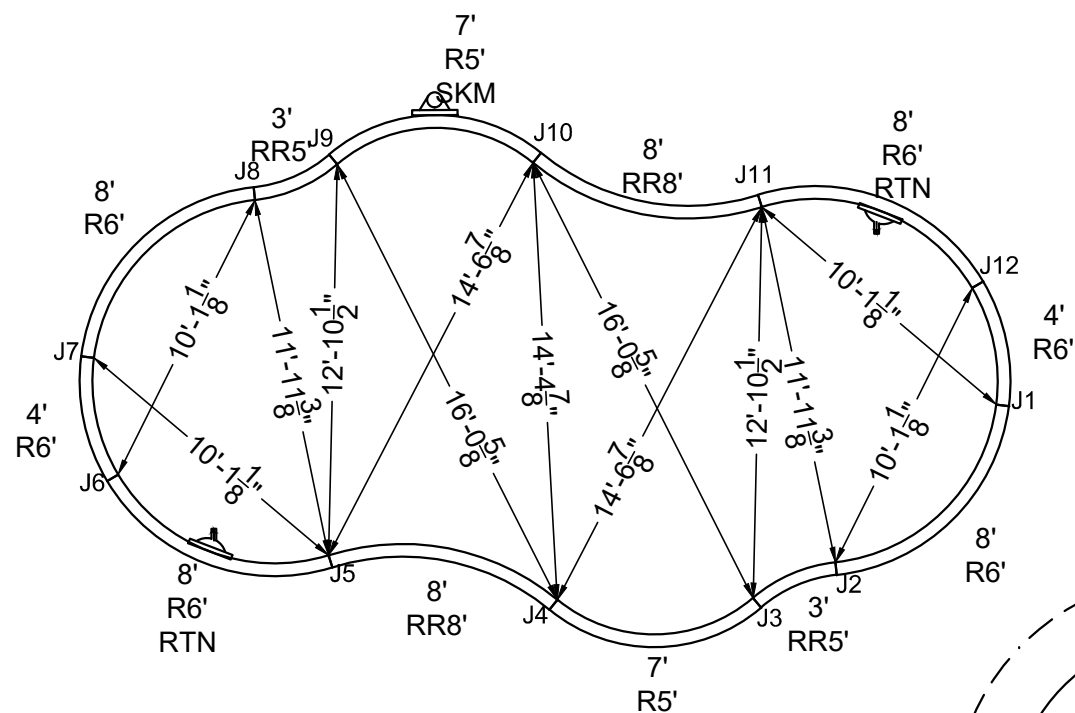

STAKE OUT

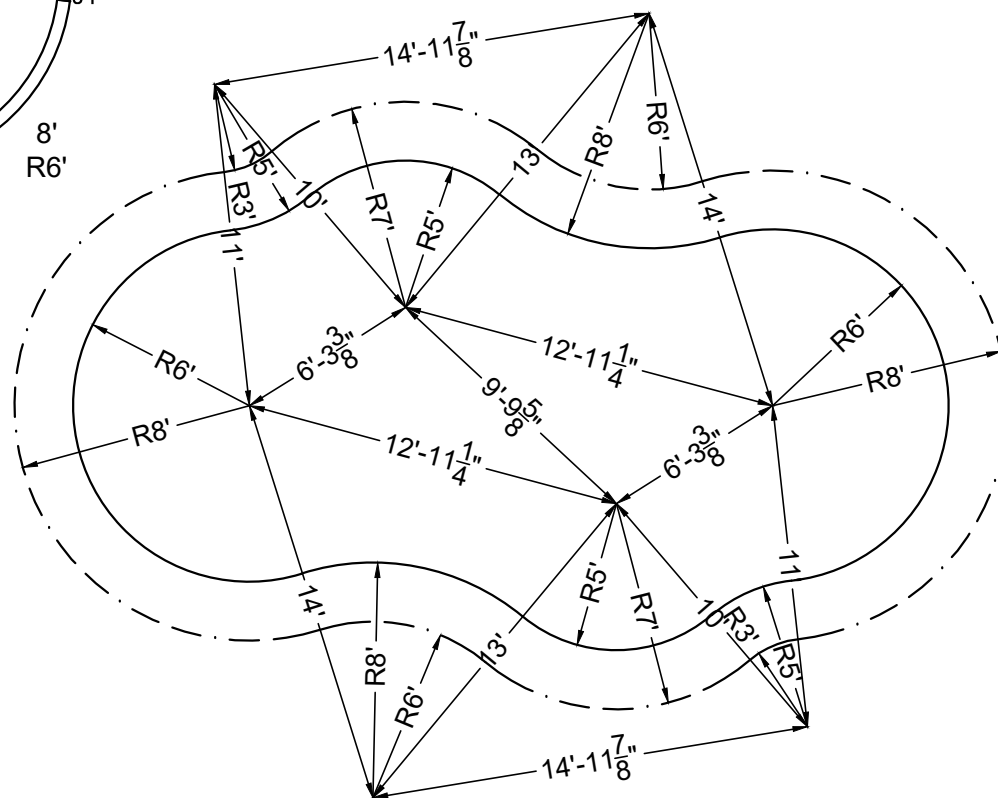

SHAPE: SAHARA

SIZE: 12' X 29'-10"

HAND: RIGHT

PANEL HEIGHT: 3'-6"

DRAWN BY: NM-BCC

DWG #: MN1730SA-19

DATE: 1/26/2017

REVISION #: 01

KIT REF: MN1730SA-19-R

B



MEETS DEPTH AND SHAPE MINIMUM STANDARD ANSI/NSPI5-2003

ALL DIMENSIONS ARE FINISHED

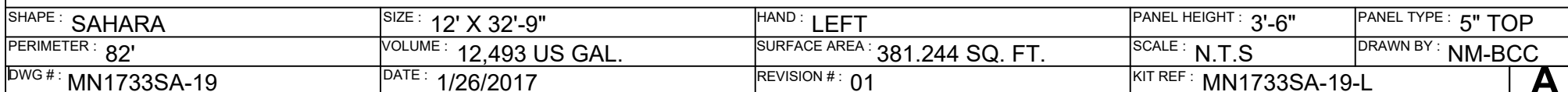



NON-DIVING POOL

USE OF DIVING EQUIPMENT IS PROHIBITED

MEETS DEPTH AND SHAPE MINIMUM STANDARD ANSI/NSPI5-2003

ALL DIMENSIONS ARE FINISHED

STEEL CHECK

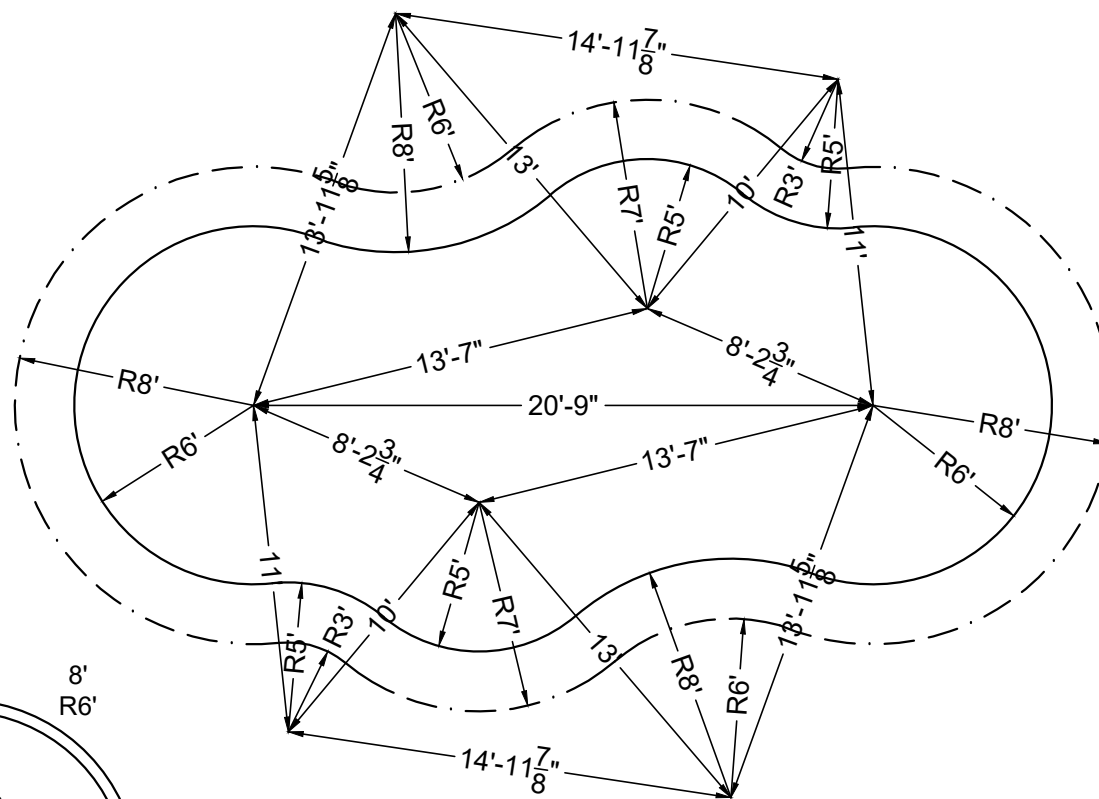
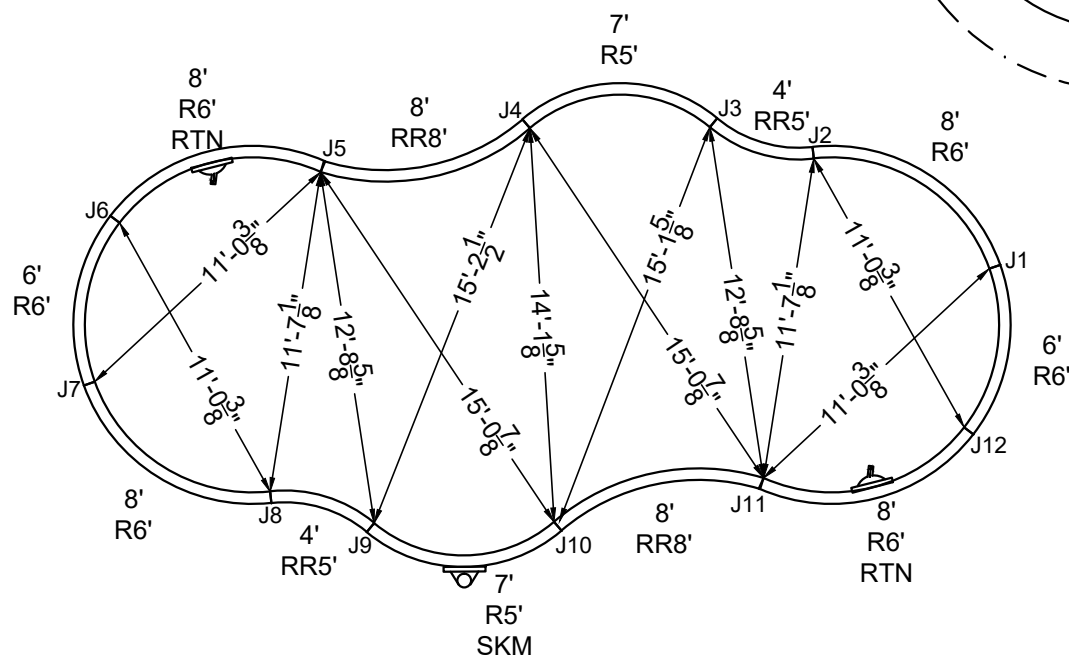

STAKE OUT

SHAPE : SAHARA	SIZE : 12' X 32'-9"	HAND : LEFT	PANEL HEIGHT : 3'-6"	DRAWN BY : NM-BCC
DWG # : MN1733SA-19	DATE : 1/26/2017	REVISION # : 01	KIT REF : MN1733SA-19-L	B



MEETS DEPTH AND SHAPE MINIMUM STANDARD ANSI/NSPI5-2003

ALL DIMENSIONS ARE FINISHED

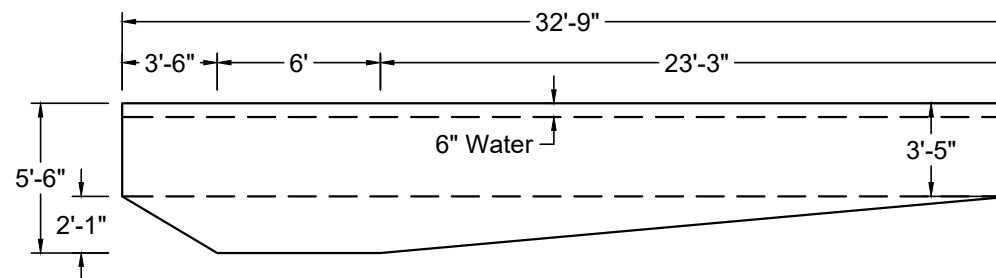

SHAPE : SAHARA	SIZE : 12' X 32'-9"	HAND : RIGHT	PANEL HEIGHT : 3'-6"	PANEL TYPE : 5" TOP
PERIMETER : 82'	VOLUME : 12,493 US GAL.	SURFACE AREA : 381.244 SQ. FT.	SCALE : N.T.S	DRAWN BY : NM-BCC
DWG # : MN1733SA-19	DATE : 1/26/2017	REVISION # : 01	KIT REF : MN1733SA-19-R	A

A

ALL DIMENSIONS ARE FINISHED



NON-DIVING POOL
USE OF DIVING EQUIPMENT IS PROHIBITED

MEETS DEPTH AND SHAPE MINIMUM STANDARD ANSI/NSPI5-2003

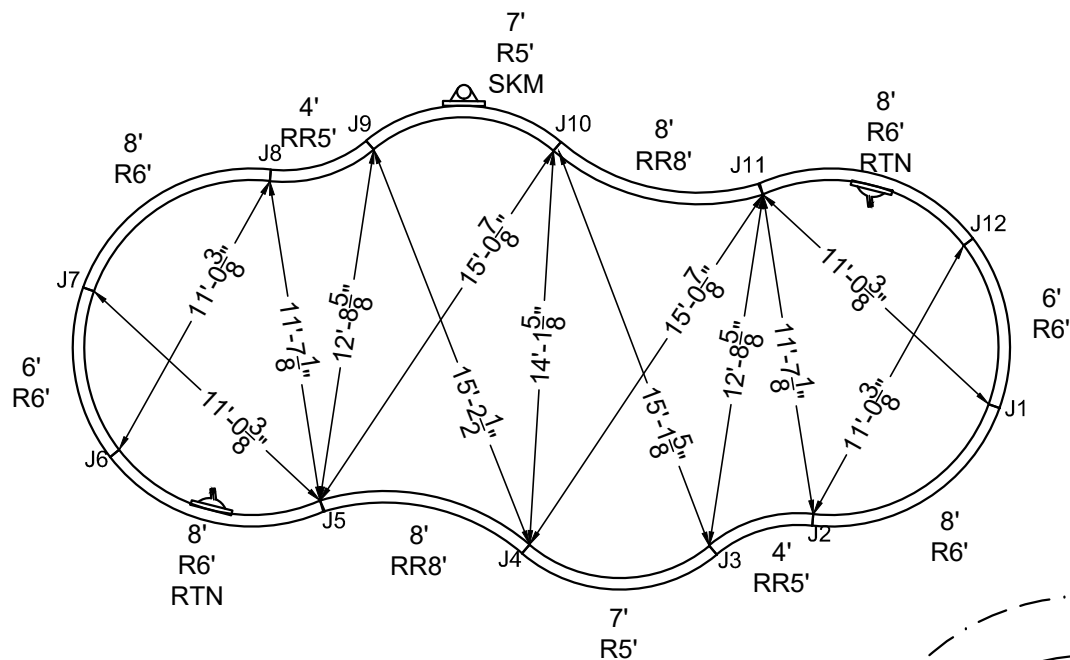

STEEL CHECK

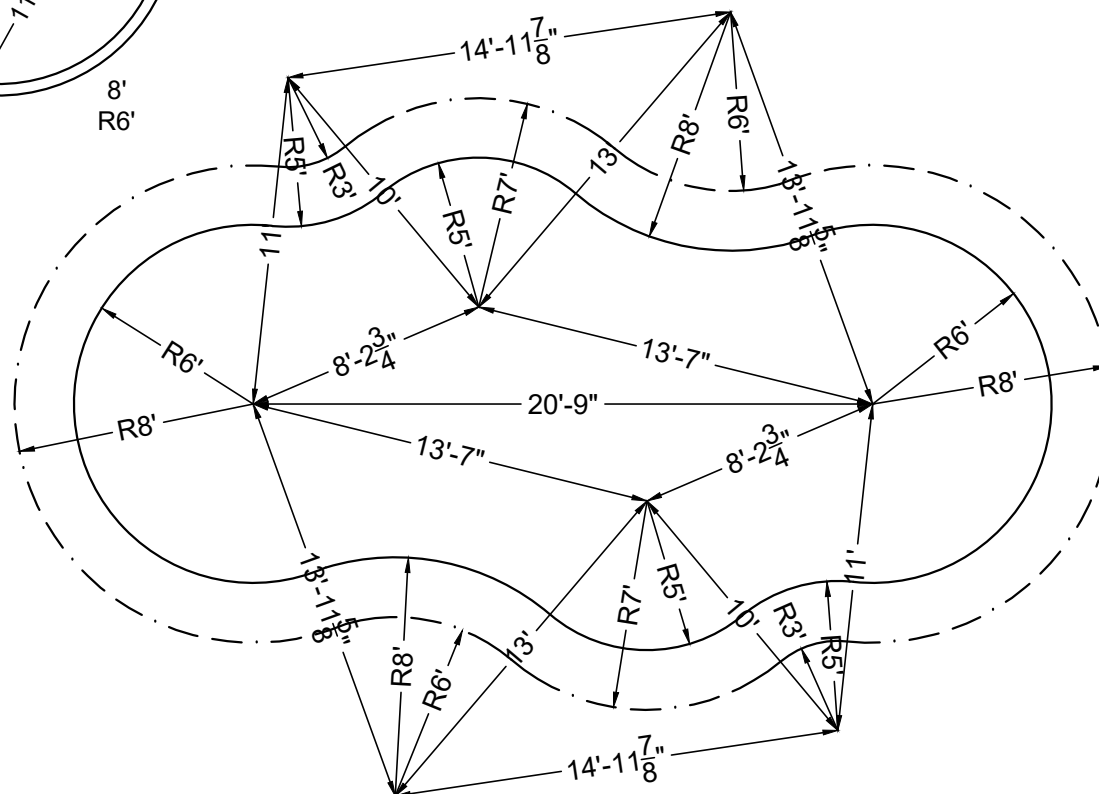

STAKE OUT

SHAPE : SAHARA

SIZE : 12' X 32'-9"

HAND : RIGHT

PANEL HEIGHT : 3'-6"

DRAWN BY : NM-BCC

DWG # : MN1733SA-19

DATE : 1/26/2017

REVISION # : 01

KIT REF : MN1733SA-19-R

B

ALL DIMENSIONS ARE FINISHED

DIVING / SLIDE EQUIPMENT DISCLAIMER:

THE BOTTOM CONFIGURATION SHOWN MEETS WITH THE CURRENT ISPSC MINIMUM STANDARDS FOR POOLS APPROVED FOR THE USE WITH MANUFACTURED DIVING EQUIPMENT. ALL DIVING EQUIPMENT MUST BE INSTALLED AND LOCATED IN ACCORDANCE WITH THE DIVING / SLIDE MANUFACTURER'S RECOMMENDATIONS. IF DIVING EQUIPMENT IS INSTALLED: PLEASE FOLLOW ALL THE DIVING / SLIDE EQUIPMENT MANUFACTURER'S INSTALLATION, USE AND SAFETY INSTRUCTIONS.

MEETS DEPTH AND SHAPE MINIMUM STANDARD ANSI/NSPI5-2003

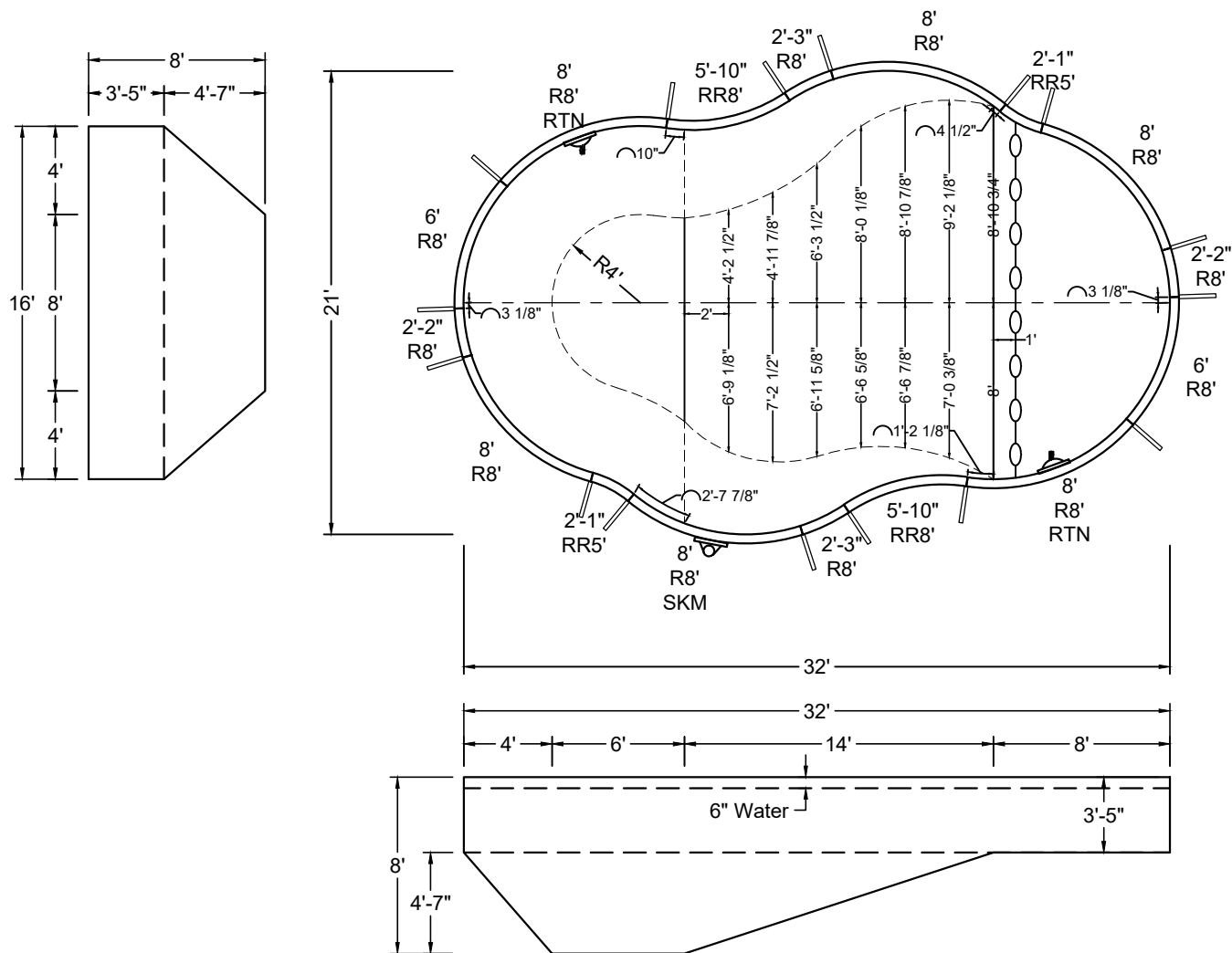

SHAPE : SAHARA	SIZE : 16' X 32'	HAND : LEFT	PANEL HEIGHT : 3'-6"	PANEL TYPE : 5" TOP
PERIMETER : 84'-7 23/32"	VOLUME : 19,131 US GAL.	SURFACE AREA : 497.630 SQ. FT.	SCALE : N.T.S	DRAWN BY : NM-BCC
DWG # : MN2132SA-19	DATE : 1/26/2017	REVISION # : 01	KIT REF : MN2132SA-19-L	A



DIVING / SLIDE EQUIPMENT DISCLAIMER:

THE BOTTOM CONFIGURATION SHOWN MEETS WITH THE CURRENT IPSC MINIMUM STANDARDS FOR POOLS APPROVED FOR THE USE WITH MANUFACTURED DIVING EQUIPMENT. ALL DIVING EQUIPMENT MUST BE INSTALLED AND LOCATED IN ACCORDANCE WITH THE DIVING / SLIDE MANUFACTURER'S RECOMMENDATIONS. IF DIVING EQUIPMENT IS INSTALLED: PLEASE FOLLOW ALL THE DIVING / SLIDE EQUIPMENT MANUFACTURER'S INSTALLATION, USE AND SAFETY INSTRUCTIONS.

MEETS DEPTH AND SHAPE MINIMUM STANDARD ANSI/NSPI5-2003

STAKE OUT

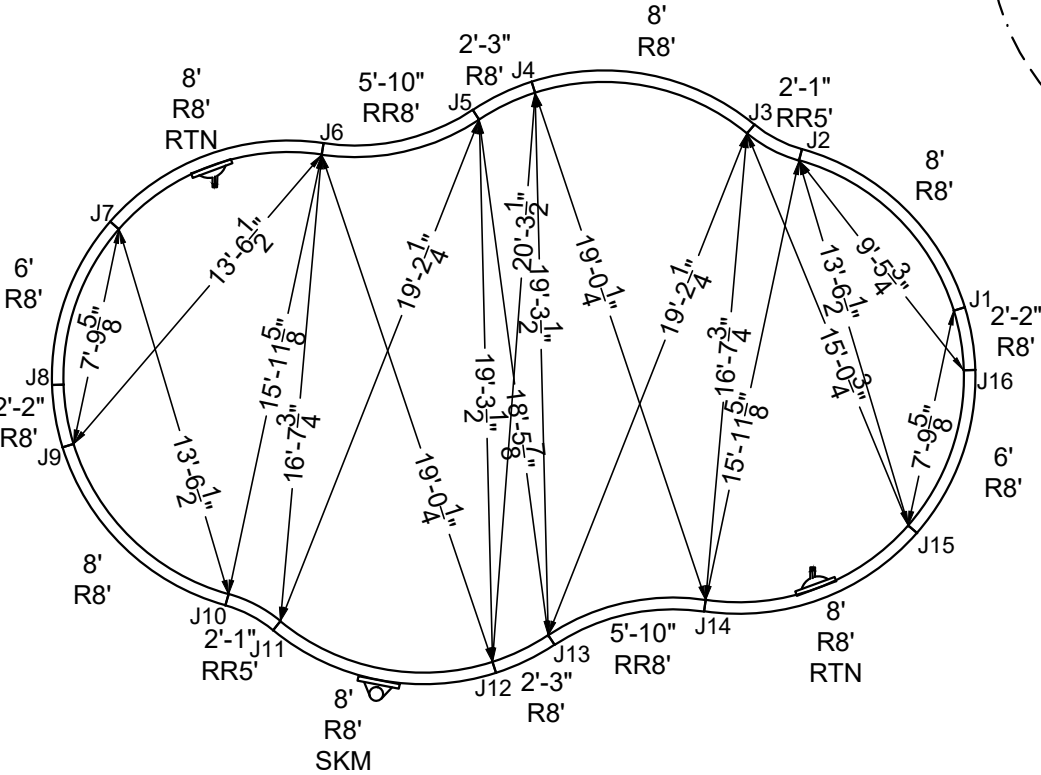

SHAPE : SAHARA	SIZE : 16' X 32'	HAND : LEFT	PANEL HEIGHT : 3'-6"	DRAWN BY : NM-BCC
DWG # : MN2132SA-19	DATE : 1/26/2017	REVISION # : 01	KIT REF : MN2132SA-19-L	B



DIVING / SLIDE EQUIPMENT DISCLAIMER:

THE BOTTOM CONFIGURATION SHOWN MEETS WITH THE CURRENT ISPSC MINIMUM STANDARDS FOR POOLS APPROVED FOR THE USE WITH MANUFACTURED DIVING EQUIPMENT. ALL DIVING EQUIPMENT MUST BE INSTALLED AND LOCATED IN ACCORDANCE WITH THE DIVING / SLIDE MANUFACTURER'S RECOMMENDATIONS. IF DIVING EQUIPMENT IS INSTALLED: PLEASE FOLLOW ALL THE DIVING / SLIDE EQUIPMENT MANUFACTURER'S INSTALLATION, USE AND SAFETY INSTRUCTIONS.

MEETS DEPTH AND SHAPE MINIMUM STANDARD ANSI/NSPI5-2003

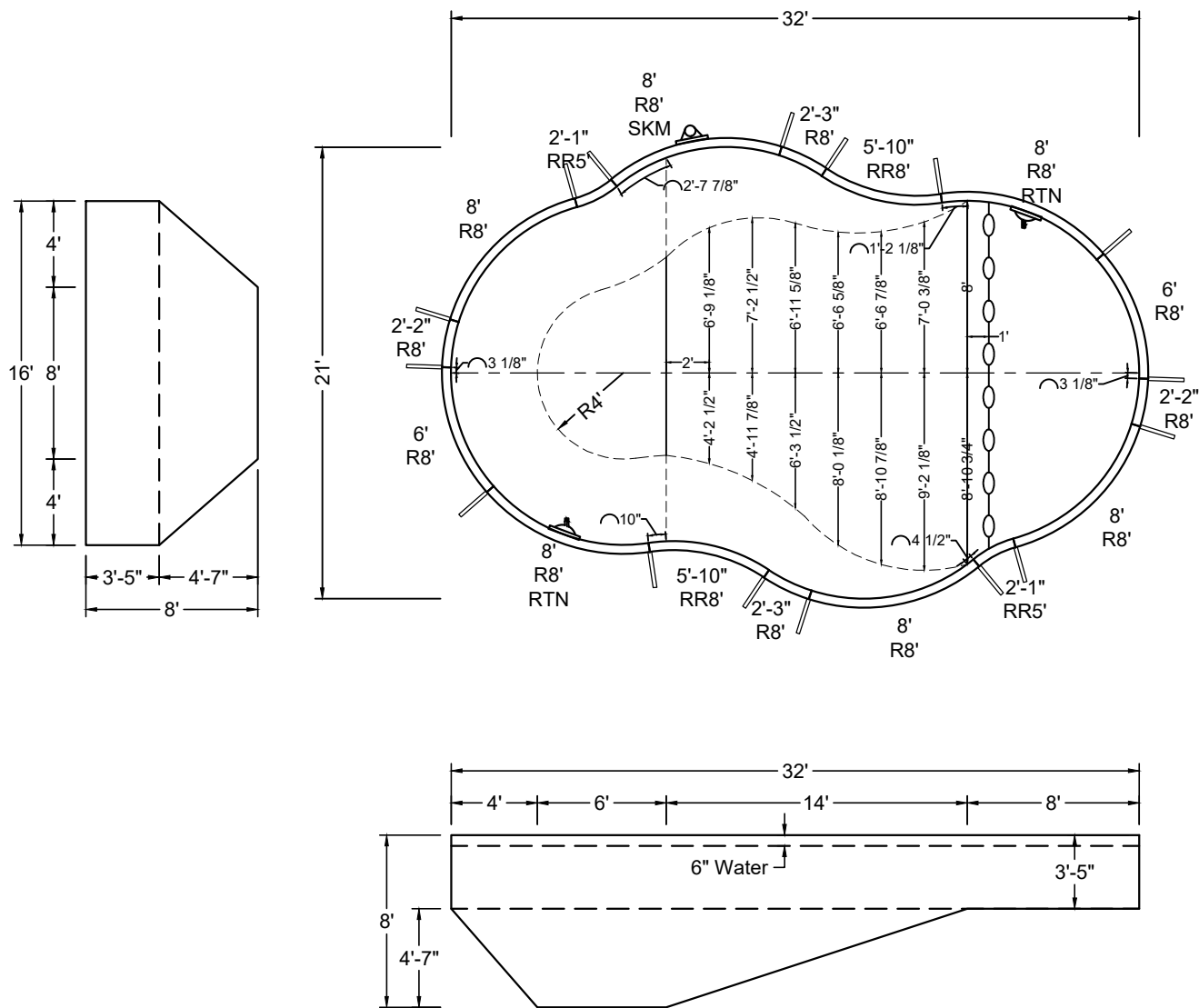

SHAPE : SAHARA	SIZE : 16' X 32'	HAND : RIGHT	PANEL HEIGHT : 3'-6"	PANEL TYPE : 5" TOP
PERIMETER : 84'-7 23/32"	VOLUME : 19,131 US GAL.	SURFACE AREA : 497.630 SQ. FT.	SCALE : N.T.S	DRAWN BY : NM-BCC
DWG # : MN2132SA-19	DATE : 1/26/2017	REVISION # : 01	KIT REF : MN2132SA-19-R	A

A



ALL DIMENSIONS ARE FINISHED

DIVING / SLIDE EQUIPMENT DISCLAIMER:

THE BOTTOM CONFIGURATION SHOWN MEETS WITH THE CURRENT IPSC MINIMUM STANDARDS FOR POOLS APPROVED FOR THE USE WITH MANUFACTURED DIVING EQUIPMENT. ALL DIVING EQUIPMENT MUST BE INSTALLED AND LOCATED IN ACCORDANCE WITH THE DIVING / SLIDE MANUFACTURER'S RECOMMENDATIONS. IF DIVING EQUIPMENT IS INSTALLED: PLEASE FOLLOW ALL THE DIVING / SLIDE EQUIPMENT MANUFACTURER'S INSTALLATION, USE AND SAFETY INSTRUCTIONS.

MEETS DEPTH AND SHAPE MINIMUM STANDARD ANSI/NSPI5-2003

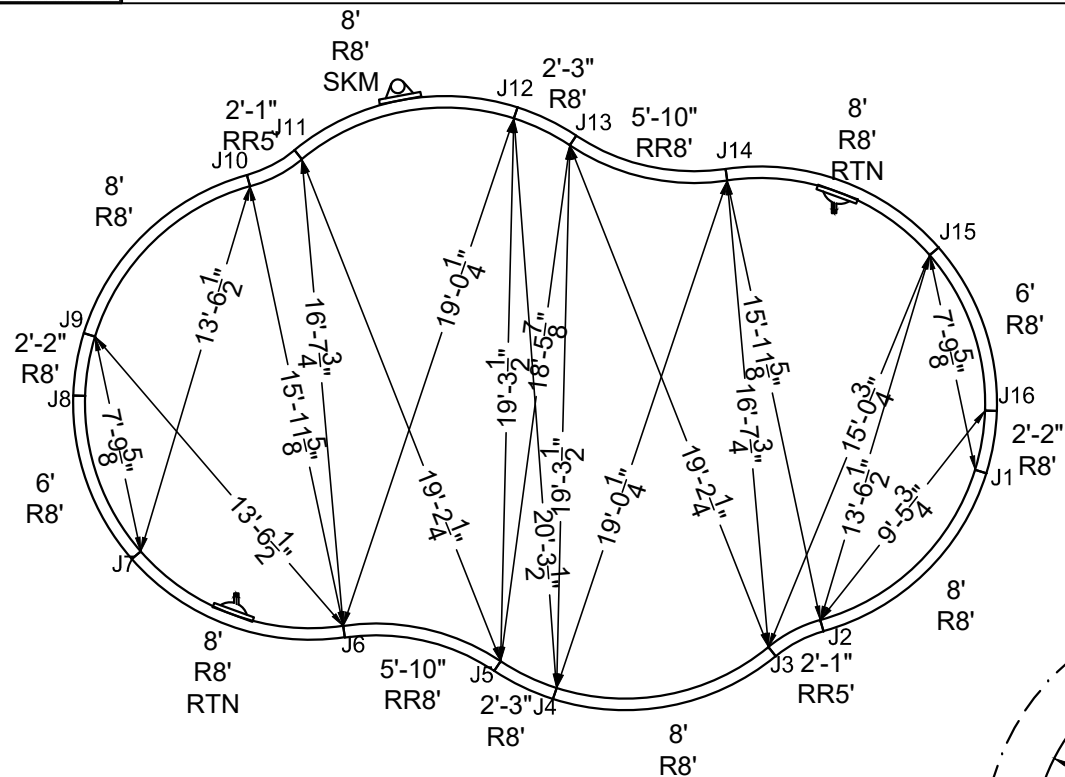

STEEL CHECK

STAKE OUT

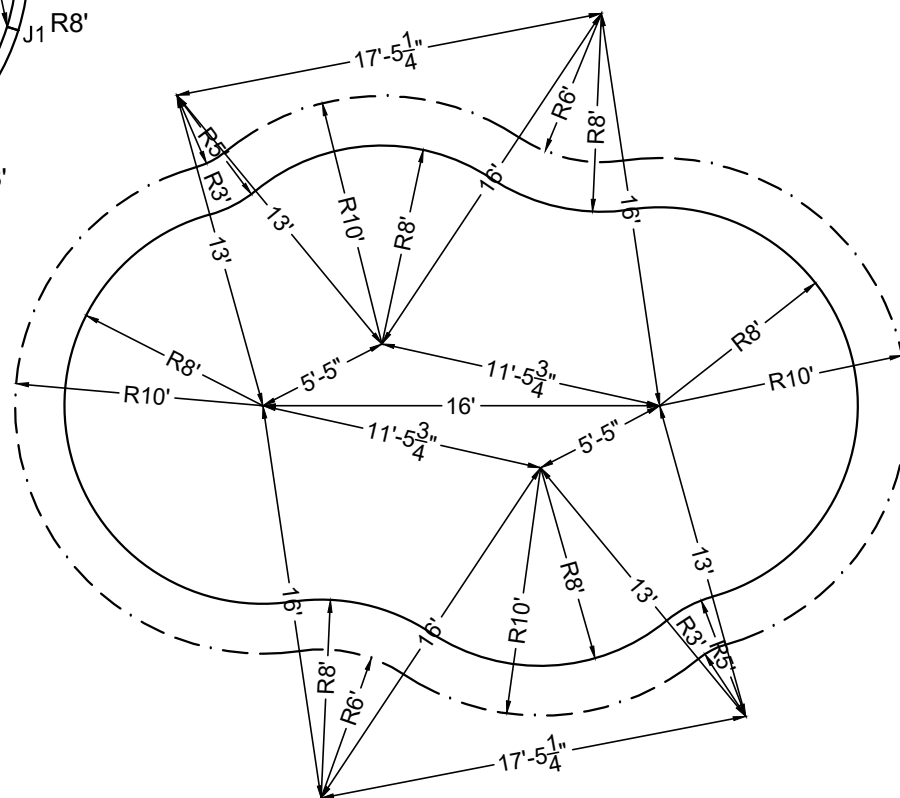

SHAPE : SAHARA	SIZE : 16' X 32'	HAND : RIGHT	PANEL HEIGHT : 3'-6"	DRAWN BY : NM-BCC
DWG # : MN2132SA-19	DATE : 1/26/2017	REVISION # : 01	KIT REF : MN2132SA-19-R	B



DIVING / SLIDE EQUIPMENT DISCLAIMER:

THE BOTTOM CONFIGURATION SHOWN MEETS WITH THE CURRENT IPSC MINIMUM STANDARDS FOR POOLS APPROVED FOR THE USE WITH MANUFACTURED DIVING EQUIPMENT. ALL DIVING EQUIPMENT MUST BE INSTALLED AND LOCATED IN ACCORDANCE WITH THE DIVING / SLIDE MANUFACTURER'S RECOMMENDATIONS. IF DIVING EQUIPMENT IS INSTALLED: PLEASE FOLLOW ALL THE DIVING / SLIDE EQUIPMENT MANUFACTURER'S INSTALLATION, USE AND SAFETY INSTRUCTIONS.

MEETS DEPTH AND SHAPE MINIMUM STANDARD ANSI/NSPI5-2003

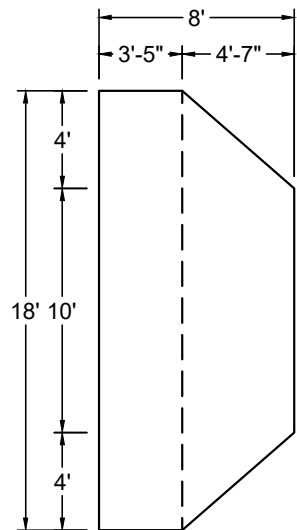

SHAPE : SAHARA	SIZE : 18' X 36'	HAND : LEFT	PANEL HEIGHT : 3'-6"	PANEL TYPE : 5" TOP
PERIMETER : 94'-9 11/16"	VOLUME : 23,175 US GAL.	SURFACE AREA : 618.417 SQ. FT.	SCALE : N.T.S	DRAWN BY : NM-BCC
DWG # : MN2336SA-19	DATE : 1/27/2017	REVISION # : 01	KIT REF : MN2336SA-19-L	A



DIVING / SLIDE EQUIPMENT DISCLAIMER:

THE BOTTOM CONFIGURATION SHOWN MEETS WITH THE CURRENT IPSC MINIMUM STANDARDS FOR POOLS APPROVED FOR THE USE WITH MANUFACTURED DIVING EQUIPMENT. ALL DIVING EQUIPMENT MUST BE INSTALLED AND LOCATED IN ACCORDANCE WITH THE DIVING / SLIDE MANUFACTURER'S RECOMMENDATIONS. IF DIVING EQUIPMENT IS INSTALLED: PLEASE FOLLOW ALL THE DIVING / SLIDE EQUIPMENT MANUFACTURER'S INSTALLATION, USE AND SAFETY INSTRUCTIONS.

MEETS DEPTH AND SHAPE MINIMUM STANDARD ANSI/NSPI5-2003

SHAPE : SAHARA	SIZE : 18' X 36'	HAND : LEFT	PANEL HEIGHT : 3'-6"	DRAWN BY : NM-BCC
DWG # : MN2336SA-19	DATE : 1/27/2017	REVISION # : 01	KIT REF : MN2336SA-19-L	B

ALL DIMENSIONS ARE FINISHED

DIVING / SLIDE EQUIPMENT DISCLAIMER:

THE BOTTOM CONFIGURATION SHOWN MEETS WITH THE CURRENT ISPSC MINIMUM STANDARDS FOR POOLS APPROVED FOR THE USE WITH MANUFACTURED DIVING EQUIPMENT. ALL DIVING EQUIPMENT MUST BE INSTALLED AND LOCATED IN ACCORDANCE WITH THE DIVING / SLIDE MANUFACTURER'S RECOMMENDATIONS. IF DIVING EQUIPMENT IS INSTALLED: PLEASE FOLLOW ALL THE DIVING / SLIDE EQUIPMENT MANUFACTURER'S INSTALLATION, USE AND SAFETY INSTRUCTIONS.

MEETS DEPTH AND SHAPE MINIMUM STANDARD ANSI/NSPI5-2003

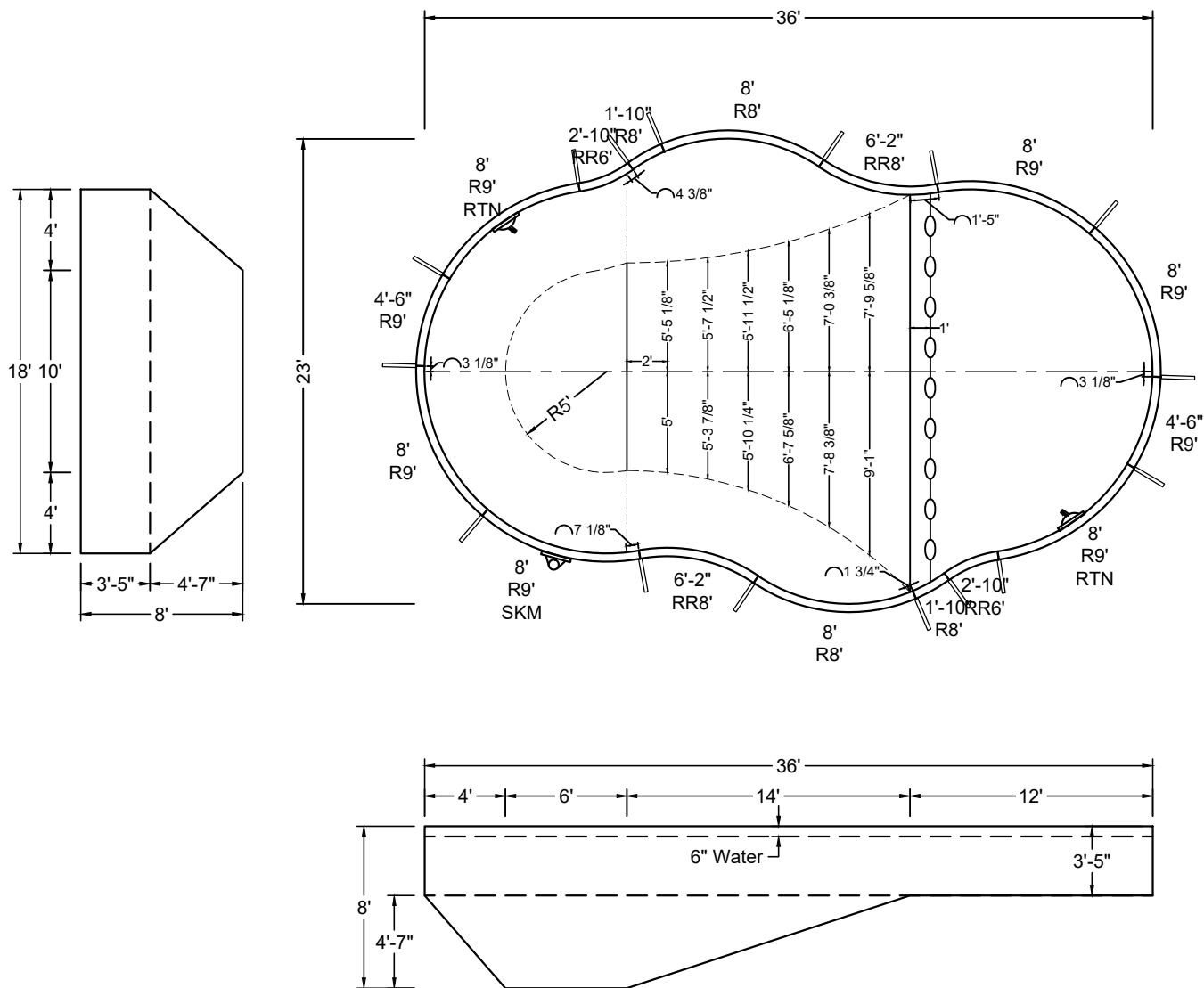

SHAPE : SAHARA

SIZE : 18' X 36'

HAND : RIGHT

PANEL HEIGHT : 3'-6"

PANEL TYPE : 5" TOP

PERIMETER : 94'-9 11/16"

VOLUME : 23,175 US GAL.

SURFACE AREA : 618.417 SQ. FT.

SCALE : N.T.S

DRAWN BY : NM-BCC

DWG # : MN2336SA-19

DATE : 1/27/2017

REVISION # : 01

KIT REF : MN2336SA-19-R

A



DIVING / SLIDE EQUIPMENT DISCLAIMER:

THE BOTTOM CONFIGURATION SHOWN MEETS WITH THE CURRENT IPSC MINIMUM STANDARDS FOR POOLS APPROVED FOR THE USE WITH MANUFACTURED DIVING EQUIPMENT. ALL DIVING EQUIPMENT MUST BE INSTALLED AND LOCATED IN ACCORDANCE WITH THE DIVING / SLIDE MANUFACTURER'S RECOMMENDATIONS. IF DIVING EQUIPMENT IS INSTALLED: PLEASE FOLLOW ALL THE DIVING / SLIDE EQUIPMENT MANUFACTURER'S INSTALLATION, USE AND SAFETY INSTRUCTIONS.

MEETS DEPTH AND SHAPE MINIMUM STANDARD ANSI/NSPI5-2003



SHAPE : SAHARA	SIZE : 18' X 36'	HAND : RIGHT	PANEL HEIGHT : 3'-6"	DRAWN BY : NM-BCC
DWG # : MN2336SA-19	DATE : 1/27/2017	REVISION # : 01	KIT REF : MN2336SA-19-R	B