

ALL DIMENSIONS ARE FINISHED

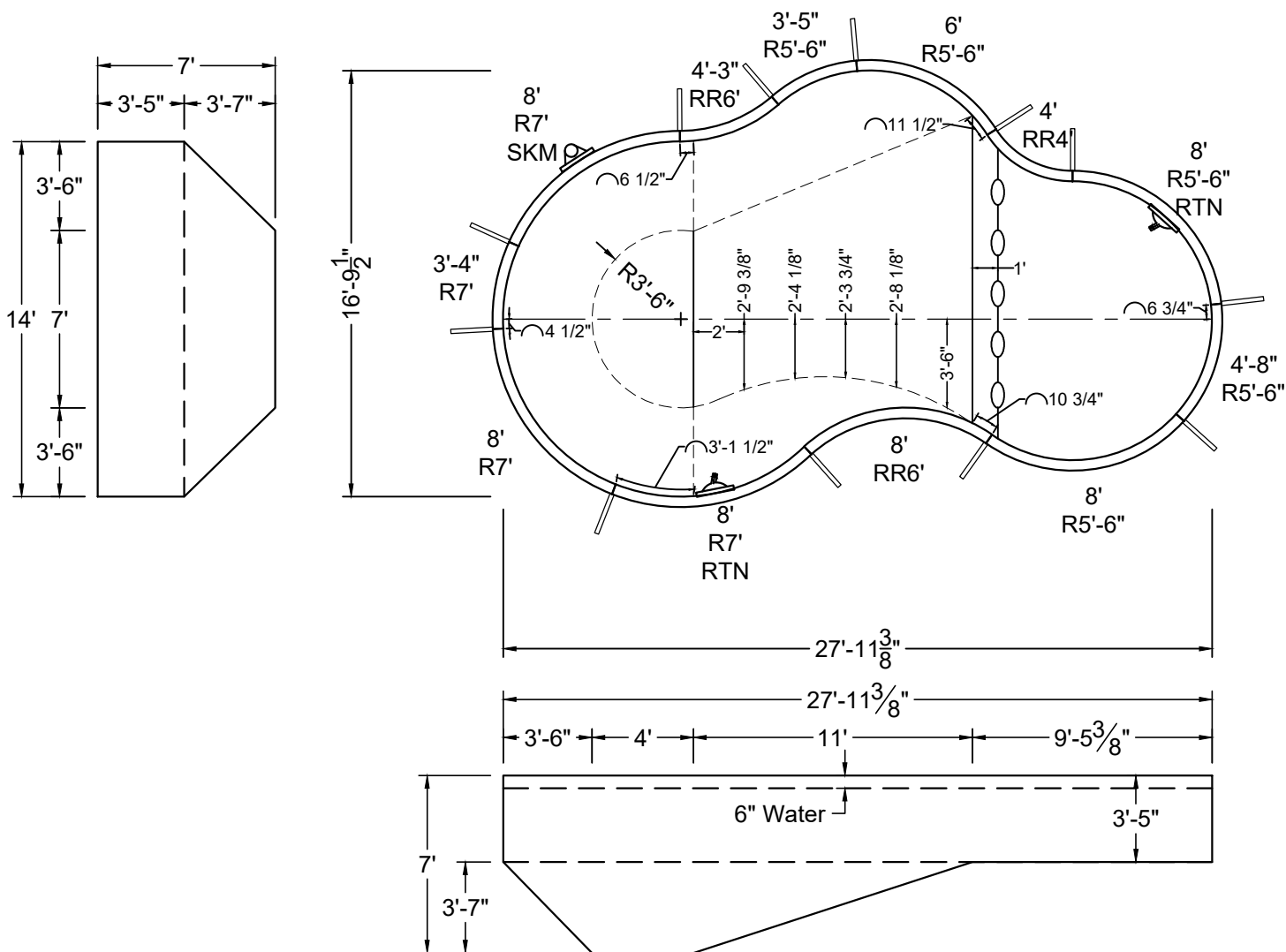

**NON-DIVING POOL**  
USE OF DIVING EQUIPMENT IS PROHIBITED

MEETS DEPTH AND SHAPE MINIMUM STANDARD ANSI/NSPI5-2003



SHAPE : HUMPBACK KIDNEY	SIZE : 14' X 27'-11"	HAND : LEFT	PANEL HEIGHT : 3'-6"	PANEL TYPE : 3" TOP
PERIMETER : 73'-8"	VOLUME : 11,481 US GAL.	SURFACE AREA : 325.742 SQ. FT.	SCALE : N.T.S	DRAWN BY : NM-BCC
DWG # : MN1428HK-19	DATE : 1/9/2017	REVISION # : 01	KIT REF : MN1428HK-19-L	<b>A</b>



## NON-DIVING POOL

USE OF DIVING EQUIPMENT IS PROHIBITED

MEETS DEPTH AND SHAPE MINIMUM STANDARD ANSI/NSPI5-2003

ALL DIMENSIONS ARE FINISHED

STEEL CHECK

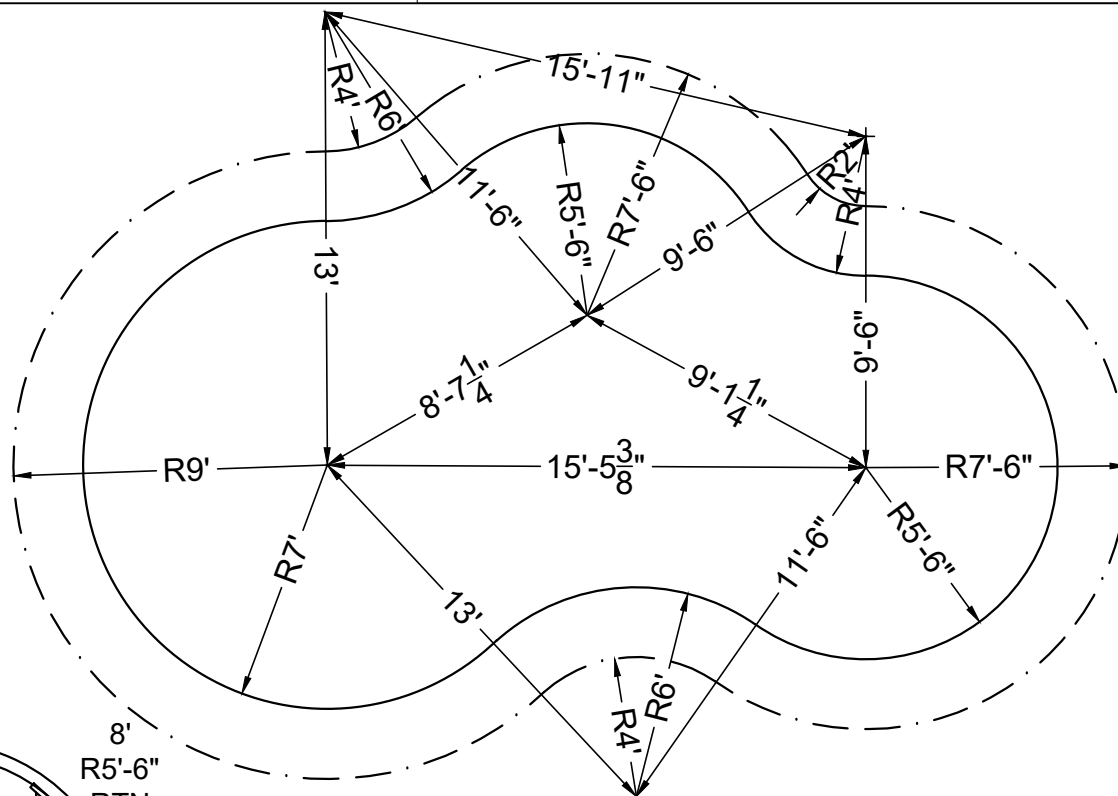
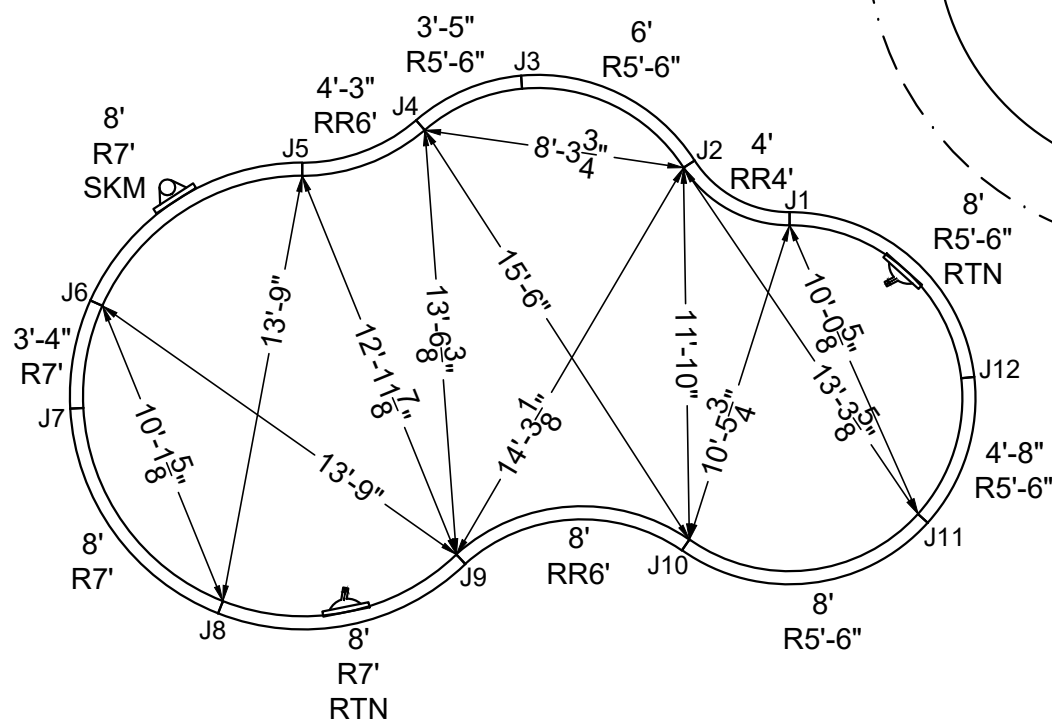

## STAKE OUT

SHAPE : HUMPBACK KIDNEY	SIZE : 14' X 27'-11"	HAND : LEFT	PANEL HEIGHT : 3'-6"	DRAWN BY : NM-BCC
DWG # : MN1428HK-19	DATE : 1/9/2017	REVISION # : 01	KIT REF : MN1428HK-19-L	<b>B</b>

ALL DIMENSIONS ARE FINISHED



**NON-DIVING POOL**  
USE OF DIVING EQUIPMENT IS PROHIBITED

MEETS DEPTH AND SHAPE MINIMUM STANDARD ANSI/NSPI5-2003

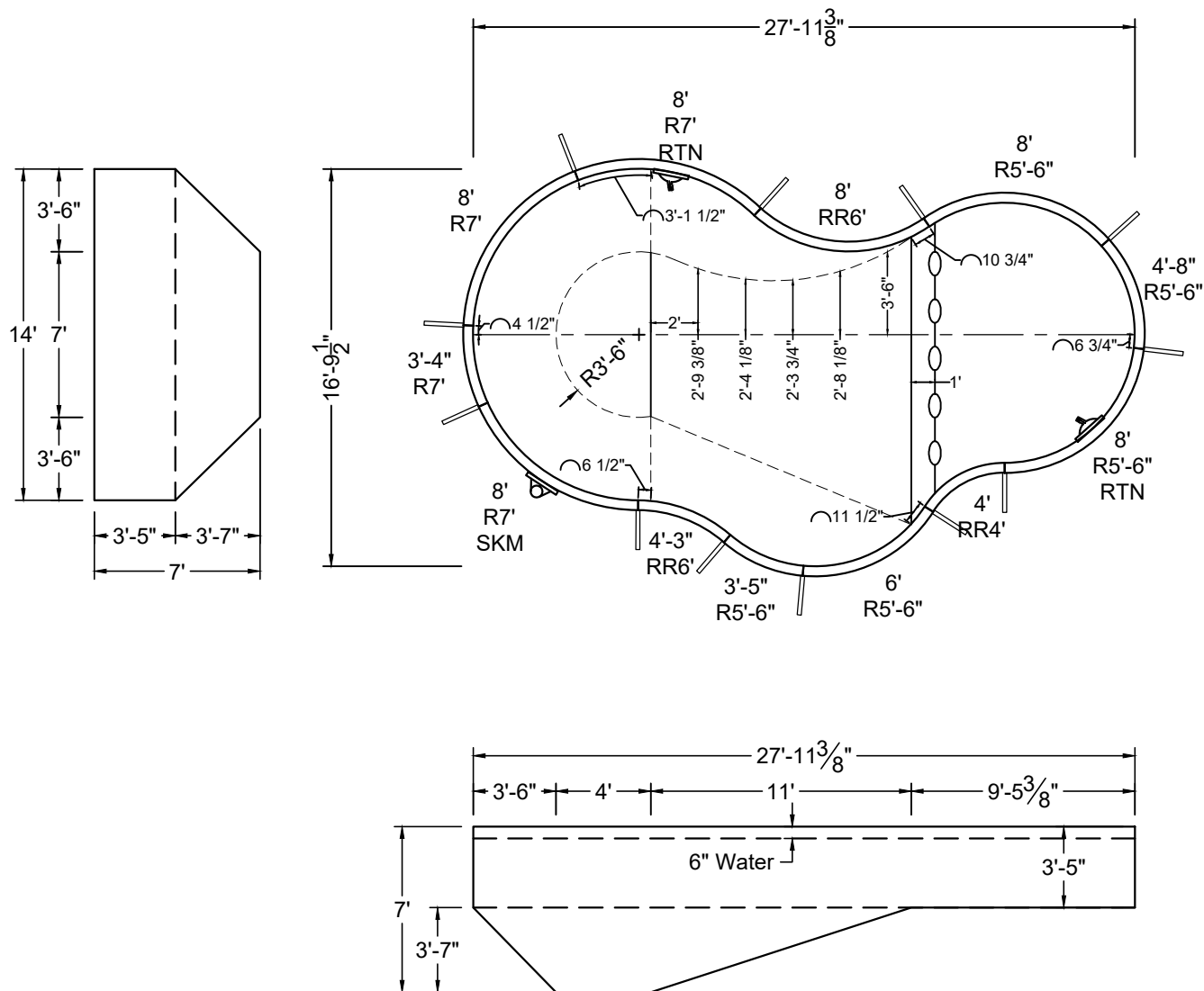

SHAPE: HUMPBACK KIDNEY	SIZE: 14' X 27'-11"	HAND: RIGHT	PANEL HEIGHT: 3'-6"	PANEL TYPE: 3" TOP
PERIMETER: 73'-8"	VOLUME: 11,481 US GAL.	SURFACE AREA: 325.742 SQ. FT.	SCALE: N.T.S	DRAWN BY: NM-BCC
DWG #: MN1428HK-19	DATE: 1/9/2017	REVISION #: 01	KIT REF: MN1428HK-19-R	<b>A</b>



## NON-DIVING POOL

USE OF DIVING EQUIPMENT IS PROHIBITED

MEETS DEPTH AND SHAPE MINIMUM STANDARD ANSI/NSPI5-2003

ALL DIMENSIONS ARE FINISHED

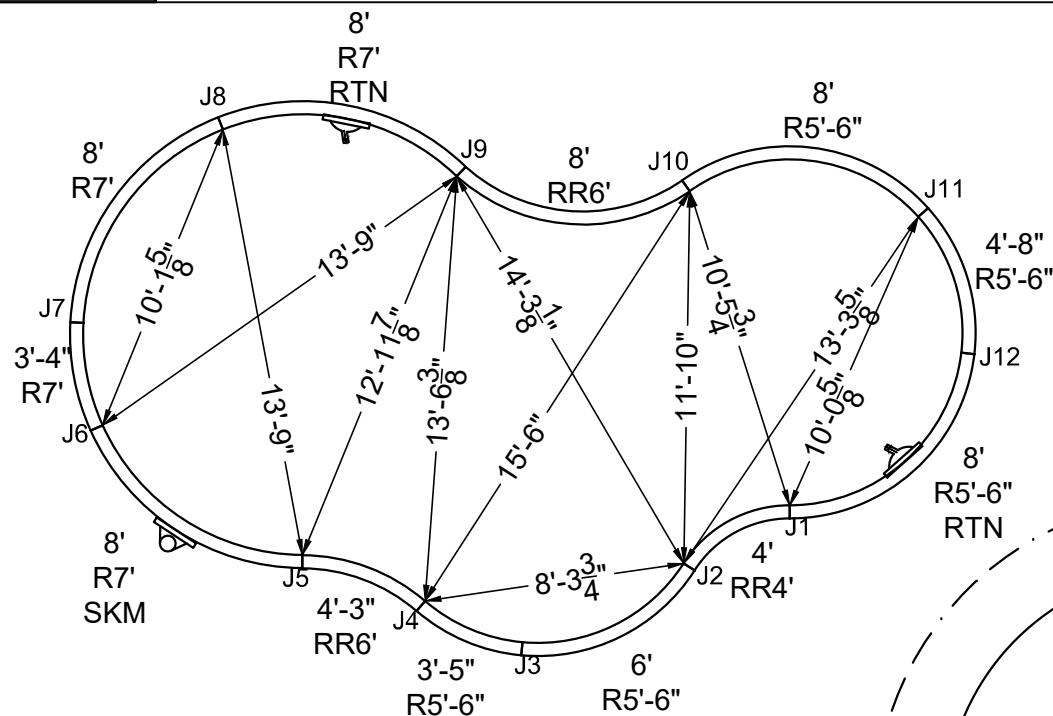

## STEEL CHECK

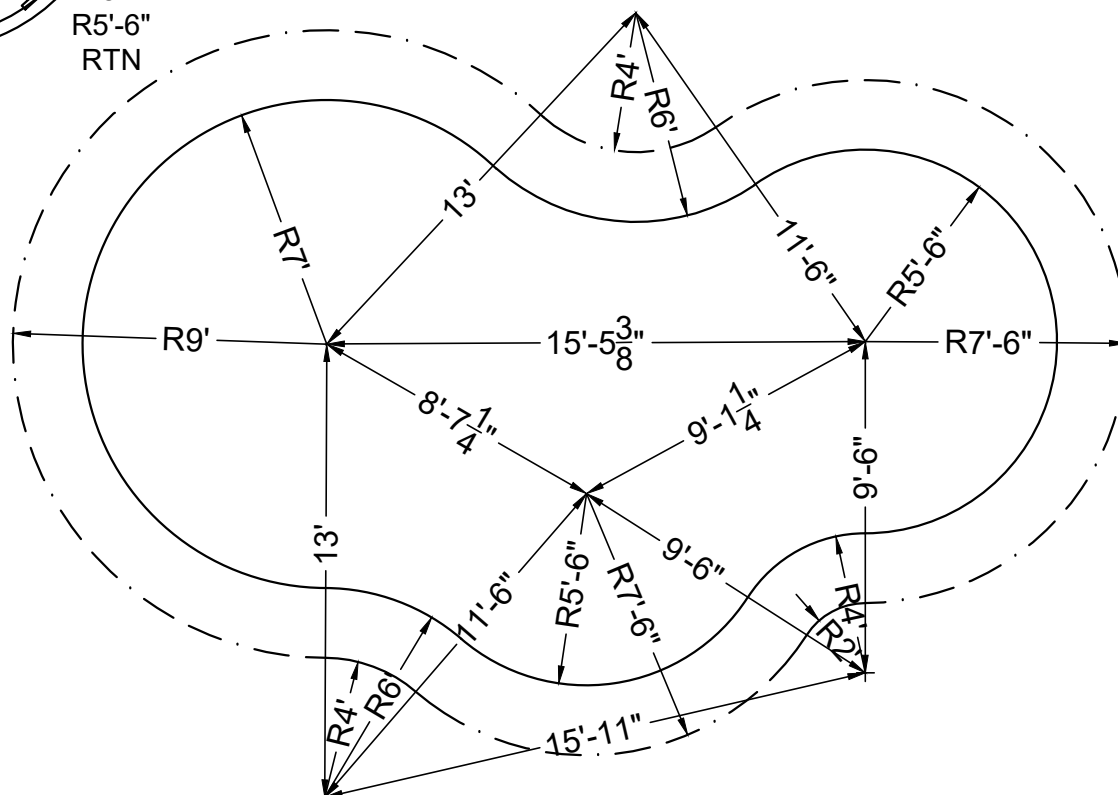

## STAKE OUT

SHAPE : HUMPBACK KIDNEY	SIZE : 14' X 27'-11"	HAND : RIGHT	PANEL HEIGHT : 3'-6"	DRAWN BY : NM-BCC
DWG # : MN1428HK-19	DATE : 1/9/2017	REVISION # : 01	KIT REF : MN1428HK-19-R	<b>B</b>



**NON-DIVING POOL**  
USE OF DIVING EQUIPMENT IS PROHIBITED

MEETS DEPTH AND SHAPE MINIMUM STANDARD ANSI/NSPI5-2003

ALL DIMENSIONS ARE FINISHED

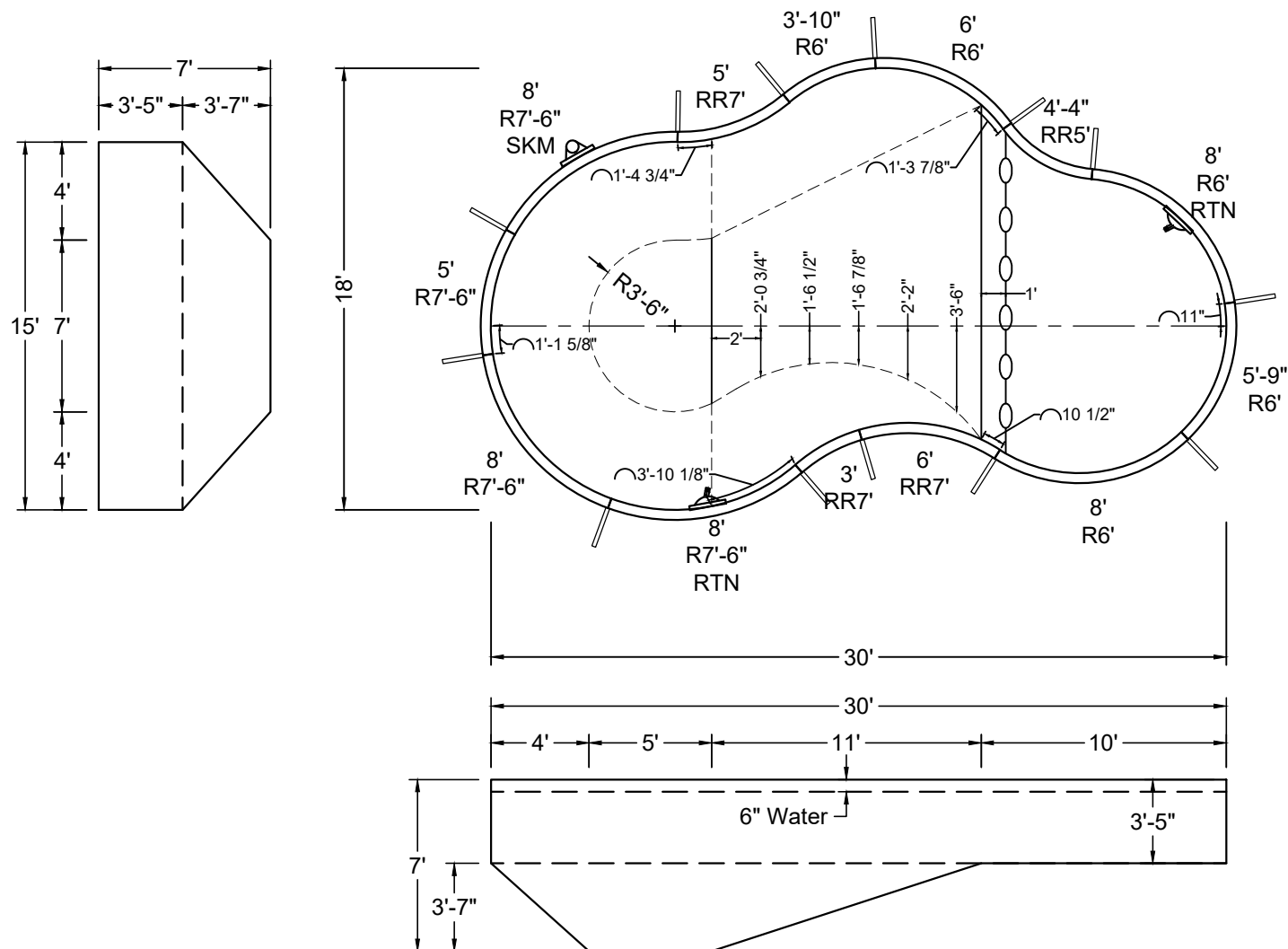

SHAPE: HUMPBACK KIDNEY	SIZE: 15' X 30'	HAND: LEFT	PANEL HEIGHT: 3'-6"	PANEL TYPE: 3" TOP
PERIMETER: 78'-10 3/32"	VOLUME: 13,369 US GAL.	SURFACE AREA: 378.737 SQ. FT.	SCALE: N.T.S	DRAWN BY: NM-BCC
DWG #: MN1530HK-19	DATE: 1/9/2017	REVISION #: 01	KIT REF: MN1530HK-19-L	<b>A</b>



## NON-DIVING POOL

USE OF DIVING EQUIPMENT IS PROHIBITED

MEETS DEPTH AND SHAPE MINIMUM STANDARD ANSI/NSPI5-2003

ALL DIMENSIONS ARE FINISHED

STEEL CHECK

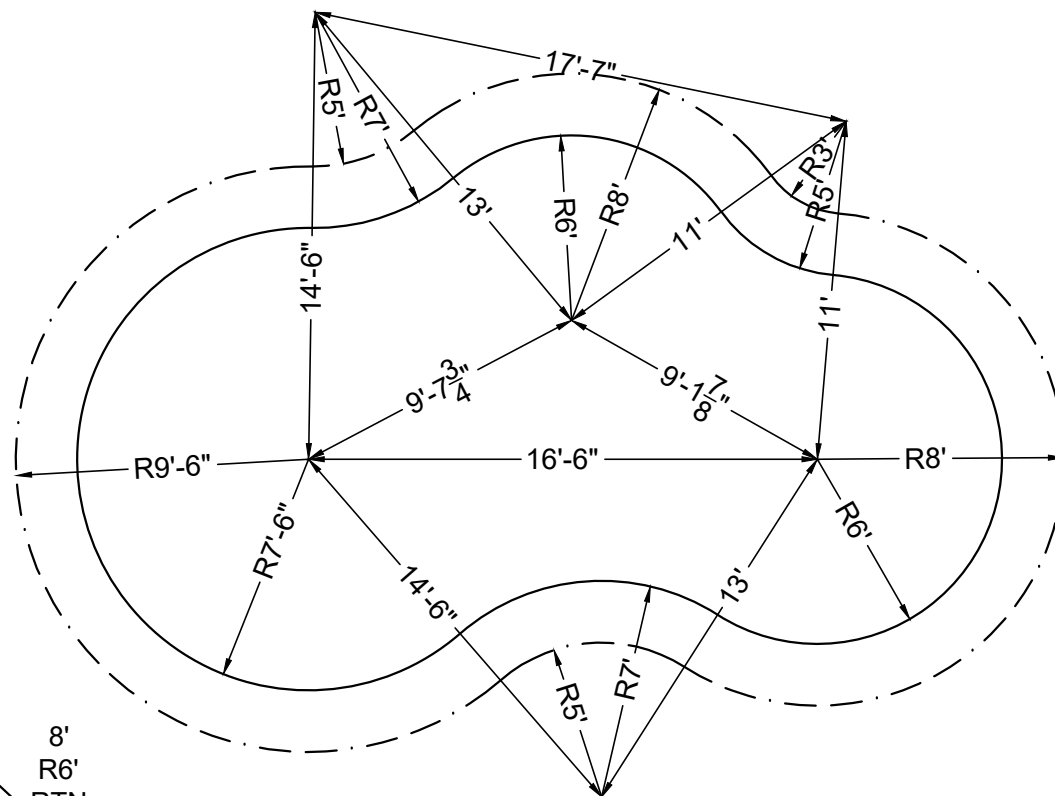
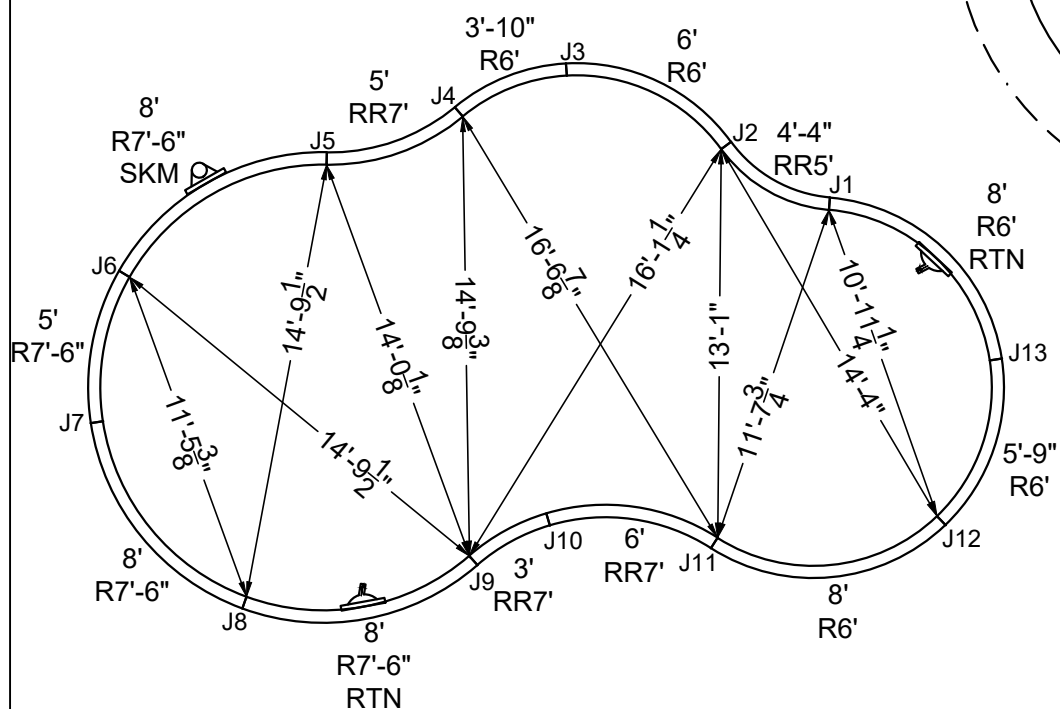

## STAKE OUT

SHAPE : HUMPBACK KIDNEY	SIZE : 15' X 30'	HAND : LEFT	PANEL HEIGHT : 3'-6"	DRAWN BY : NM-BCC
DWG # : MN1530HK-19	DATE : 1/9/2017	REVISION # : 01	KIT REF : MN1530HK-19-L	<b>B</b>



**NON-DIVING POOL**  
USE OF DIVING EQUIPMENT IS PROHIBITED

MEETS DEPTH AND SHAPE MINIMUM STANDARD ANSI/NSPI5-2003

ALL DIMENSIONS ARE FINISHED

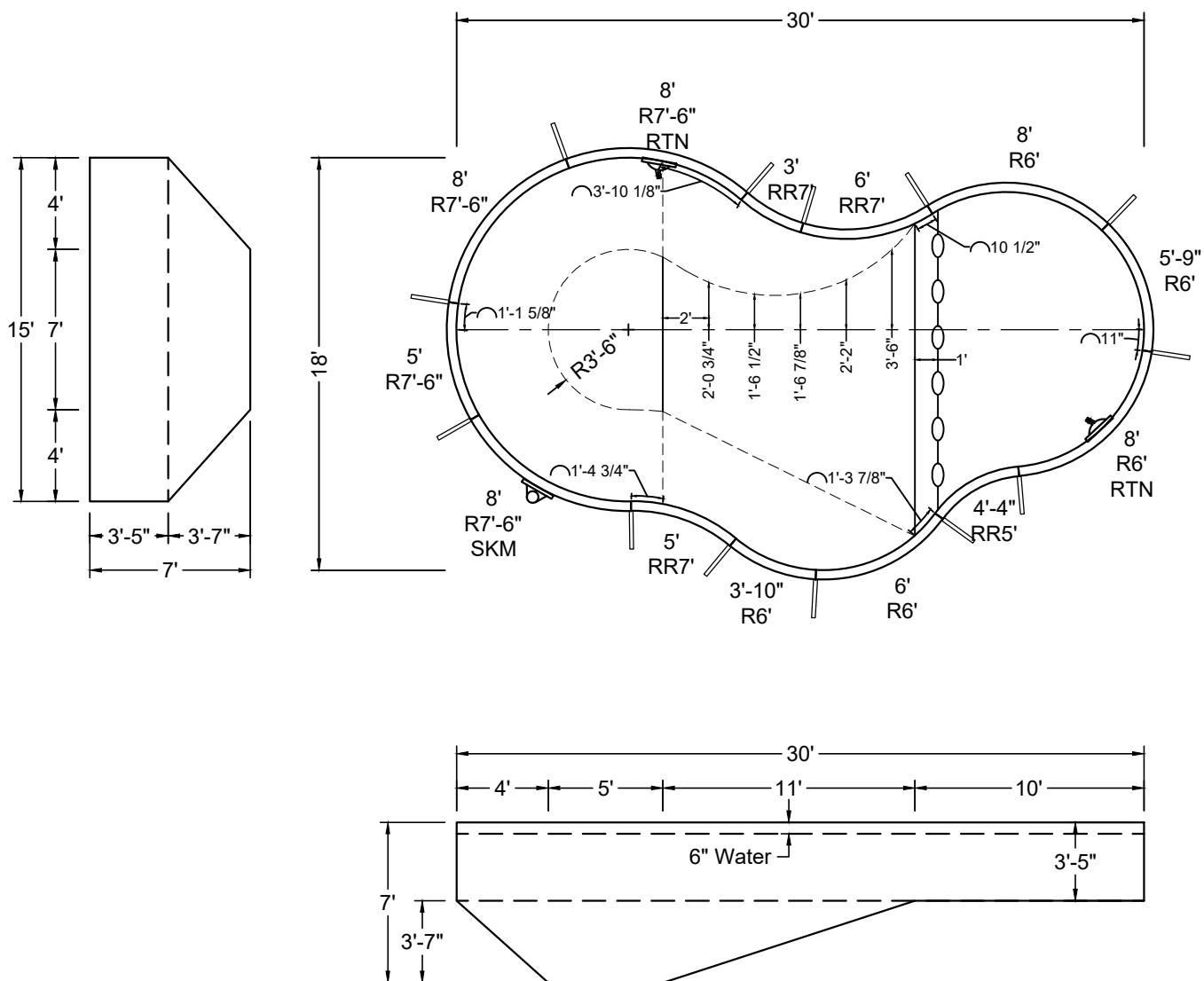

SHAPE : HUMPBACK KIDNEY	SIZE : 15' X 30'	HAND : RIGHT	PANEL HEIGHT : 3'-6"	PANEL TYPE : 3" TOP
PERIMETER : 78'-10 3/32"	VOLUME : 13,369 US GAL.	SURFACE AREA : 378.737 SQ. FT.	SCALE : N.T.S	DRAWN BY : NM-BCC
DWG # : MN1530HK-19	DATE : 1/9/2017	REVISION # : 01	KIT REF : MN1530HK-19-R	<b>A</b>



## NON-DIVING POOL

USE OF DIVING EQUIPMENT IS PROHIBITED

MEETS DEPTH AND SHAPE MINIMUM STANDARD ANSI/NSPI5-2003

ALL DIMENSIONS ARE FINISHED

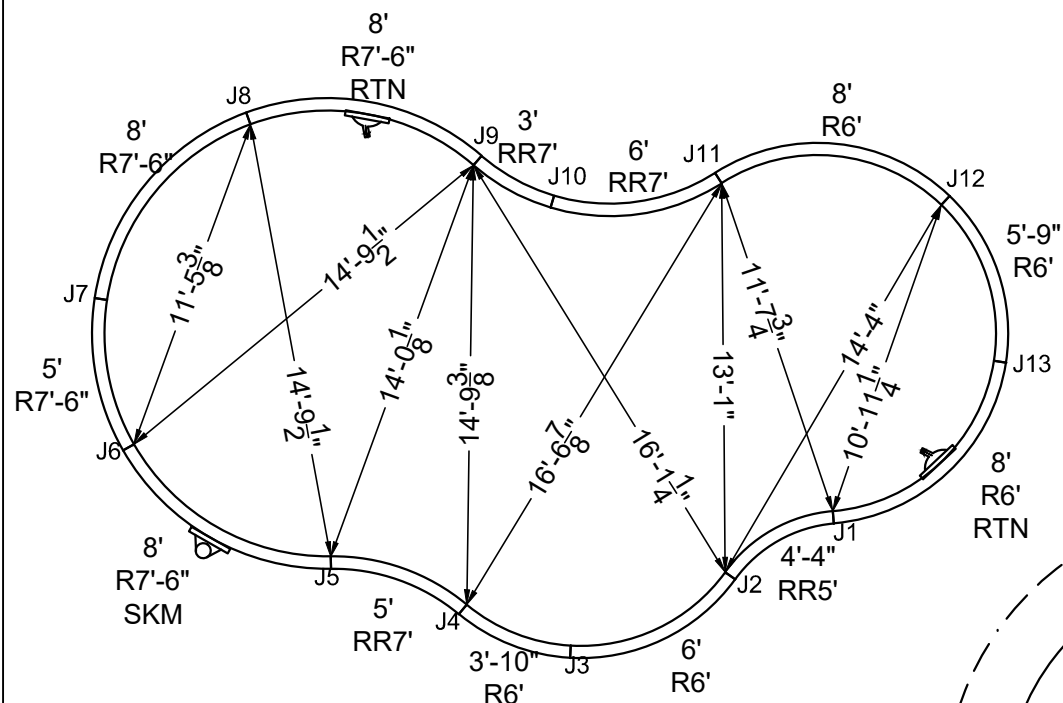

STEEL CHECK

## STAKE OUT

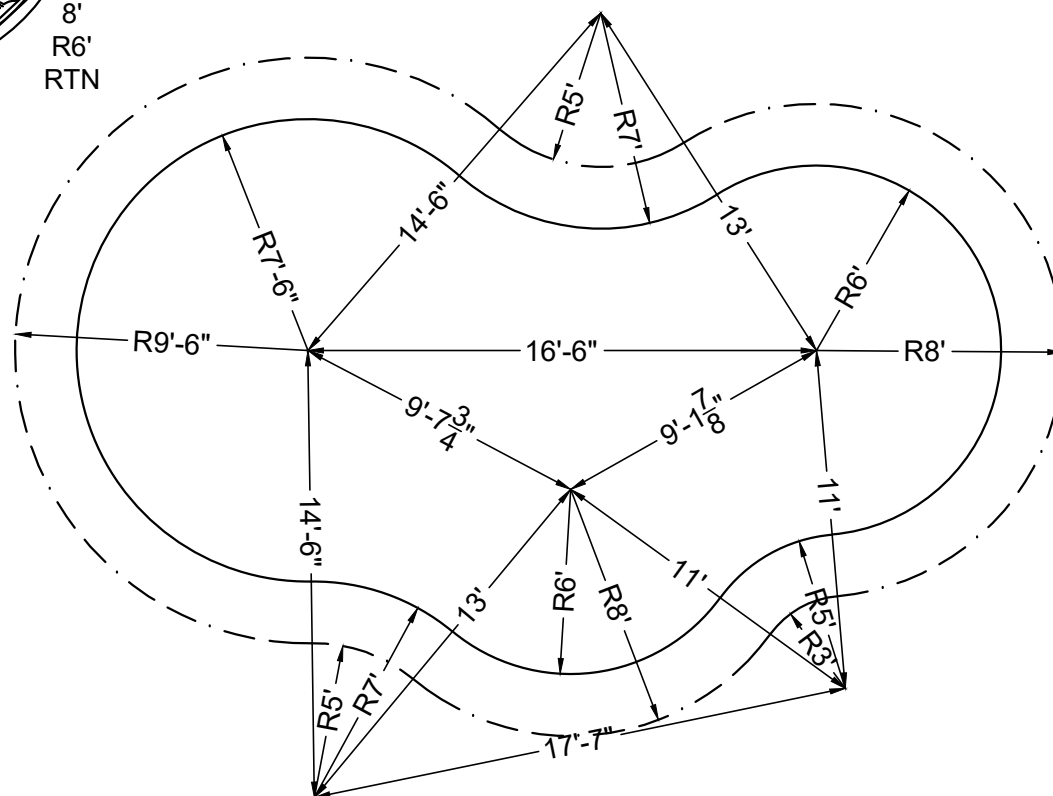

SHAPE : HUMPBACK KIDNEY	SIZE : 15' X 30'	HAND : RIGHT	PANEL HEIGHT : 3'-6"	DRAWN BY : NM-BCC
DWG # : MN1530HK-19	DATE : 1/9/2017	REVISION # : 01	KIT REF : MN1530HK-19-R	<b>B</b>



ALL DIMENSIONS ARE FINISHED



**NON-DIVING POOL**  
USE OF DIVING EQUIPMENT IS PROHIBITED

MEETS DEPTH AND SHAPE MINIMUM STANDARD ANSI/NSPI5-2003

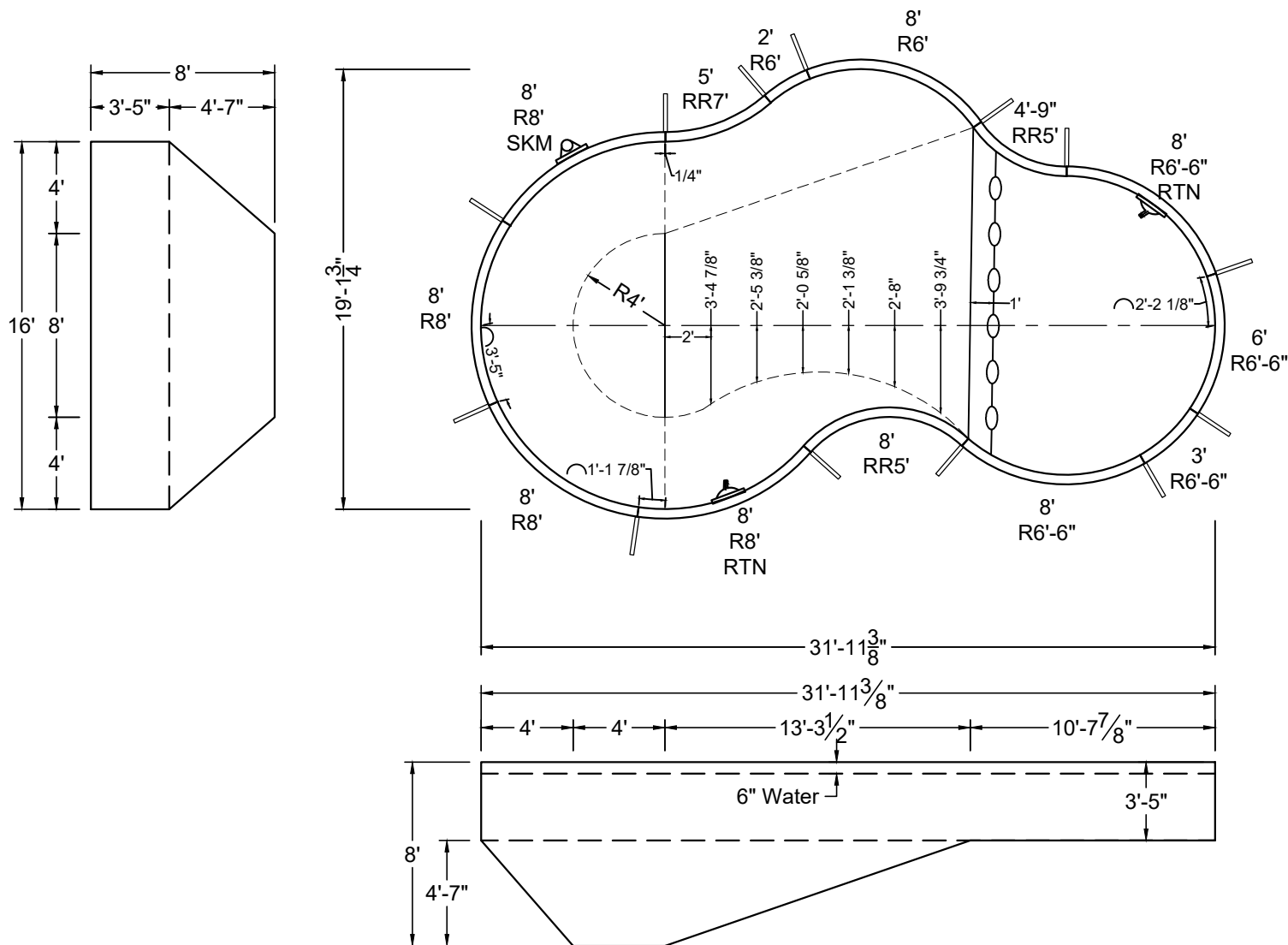

SHAPE : HUMPBACK KIDNEY	SIZE : 16' X 31'-11"	HAND : LEFT	PANEL HEIGHT : 3'-6"	PANEL TYPE : 3" TOP
PERIMETER : 84'-9"	VOLUME : 16,048 US GAL.	SURFACE AREA : 425.347 SQ. FT.	SCALE : N.T.S	DRAWN BY : NM-BCC
DWG # : MN1632HK-19	DATE : 1/9/2017	REVISION # : 01	KIT REF : MN1632HK-19-L	<b>A</b>

ALL DIMENSIONS ARE FINISHED



**NON-DIVING POOL**  
USE OF DIVING EQUIPMENT IS PROHIBITED

MEETS DEPTH AND SHAPE MINIMUM STANDARD ANSI/NSPI5-2003

STEEL CHECK

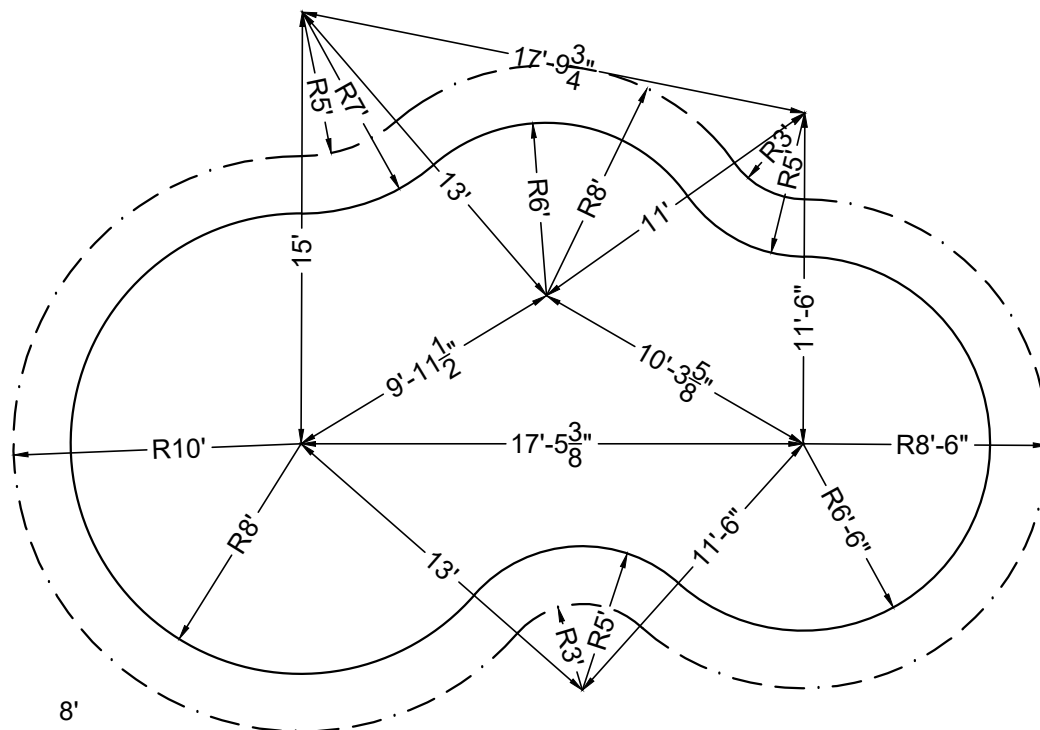
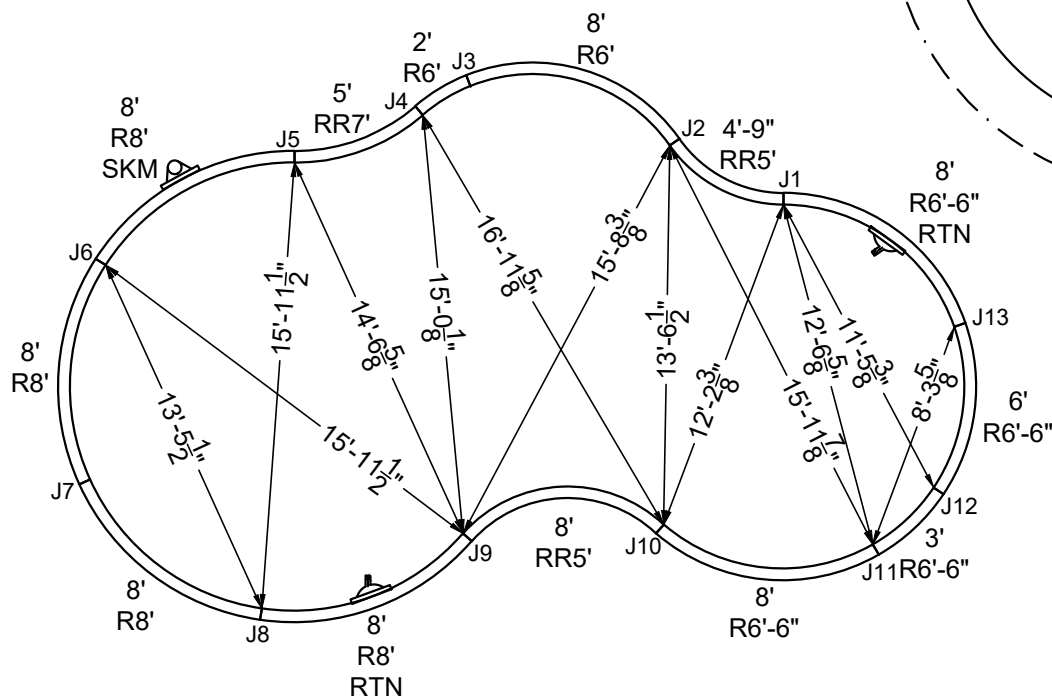

STAKE OUT

SHAPE : HUMPBACK KIDNEY	SIZE : 16' X 31'-11"	HAND : LEFT	PANEL HEIGHT : 3'-6"	DRAWN BY : NM-BCC
DWG # : MN1632HK-19	DATE : 1/9/2017	REVISION # : 01	KIT REF : MN1632HK-19-L	<b>B</b>

ALL DIMENSIONS ARE FINISHED



**NON-DIVING POOL**  
USE OF DIVING EQUIPMENT IS PROHIBITED

MEETS DEPTH AND SHAPE MINIMUM STANDARD ANSI/NSPI5-2003

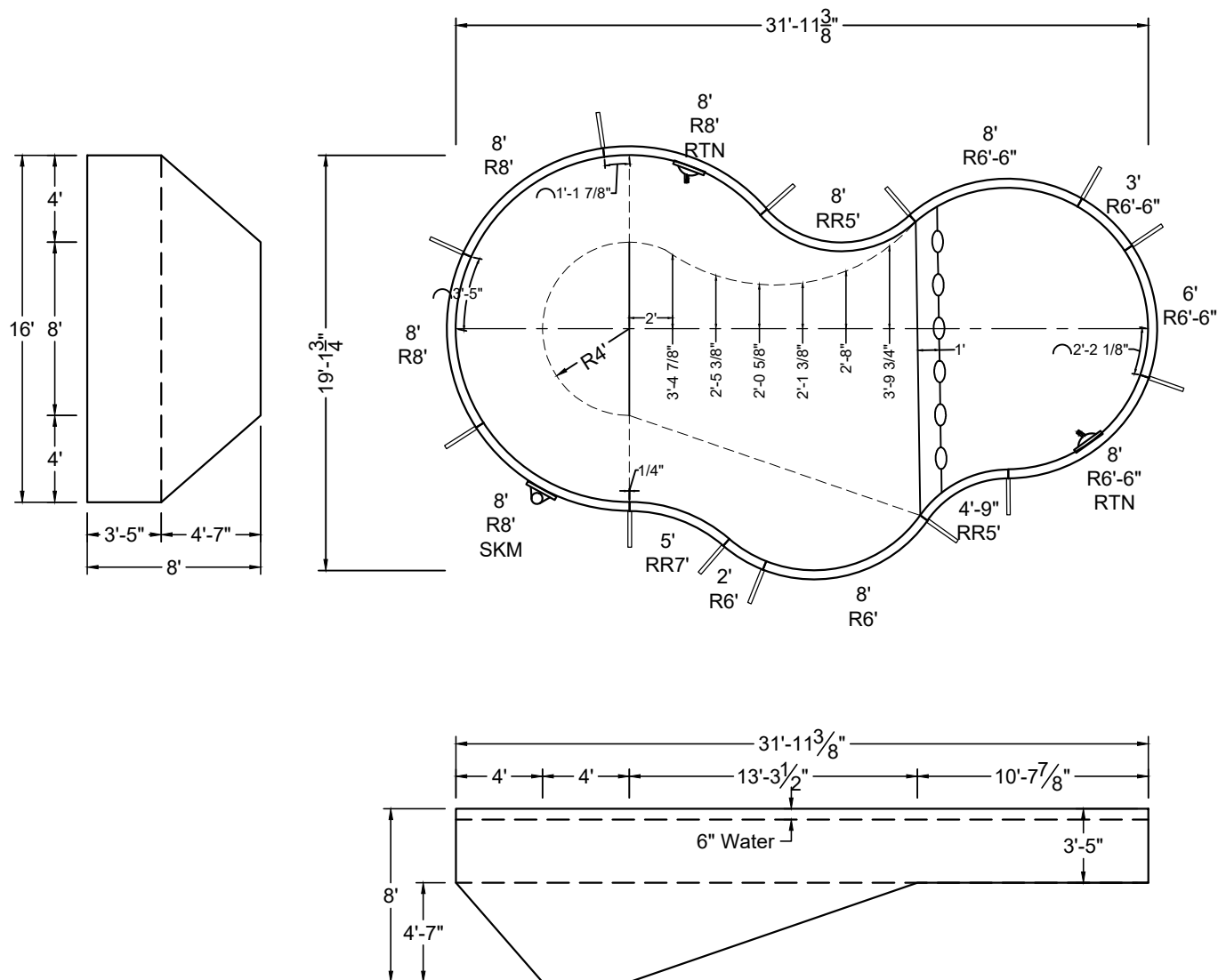

SHAPE : HUMPBACK KIDNEY	SIZE : 16' X 31'-11"	HAND : RIGHT	PANEL HEIGHT : 3'-6"	PANEL TYPE : 3" TOP
PERIMETER : 84'-9"	VOLUME : 16,048 US GAL.	SURFACE AREA : 425.347 SQ. FT.	SCALE : N.T.S	DRAWN BY : NM-BCC
DWG # : MN1632HK-19	DATE : 1/9/2017	REVISION # : 01	KIT REF : MN1632HK-19-R	<b>A</b>



ALL DIMENSIONS ARE FINISHED



## STAKE OUT

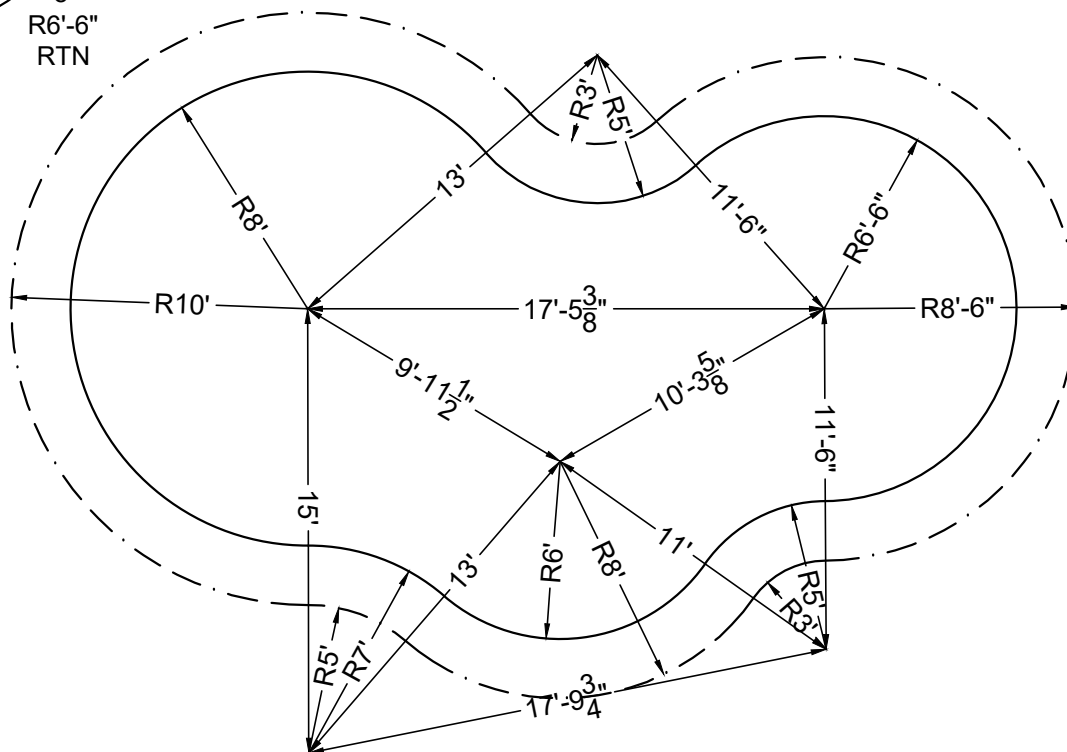

SHAPE : HUMPBACK KIDNEY	SIZE : 16' X 31'-11"	HAND : RIGHT	PANEL HEIGHT : 3'-6"	DRAWN BY : NM-BCC
DWG # : MN1632HK-19	DATE : 1/9/2017	REVISION # : 01	KIT REF : MN1632HK-19-R	<b>B</b>

ALL DIMENSIONS ARE FINISHED

DIVING / SLIDE EQUIPMENT DISCLAIMER:

THE BOTTOM CONFIGURATION SHOWN MEETS WITH THE CURRENT ISPS MINIMUM STANDARDS FOR POOLS APPROVED FOR THE USE WITH MANUFACTURED DIVING EQUIPMENT. ALL DIVING EQUIPMENT MUST BE INSTALLED AND LOCATED IN ACCORDANCE WITH THE DIVING / SLIDE MANUFACTURER'S RECOMMENDATIONS. IF DIVING EQUIPMENT IS INSTALLED: PLEASE FOLLOW ALL THE DIVING / SLIDE EQUIPMENT MANUFACTURER'S INSTALLATION, USE AND SAFETY INSTRUCTIONS.

MEETS DEPTH AND SHAPE MINIMUM STANDARD ANSI/NSPI-2003

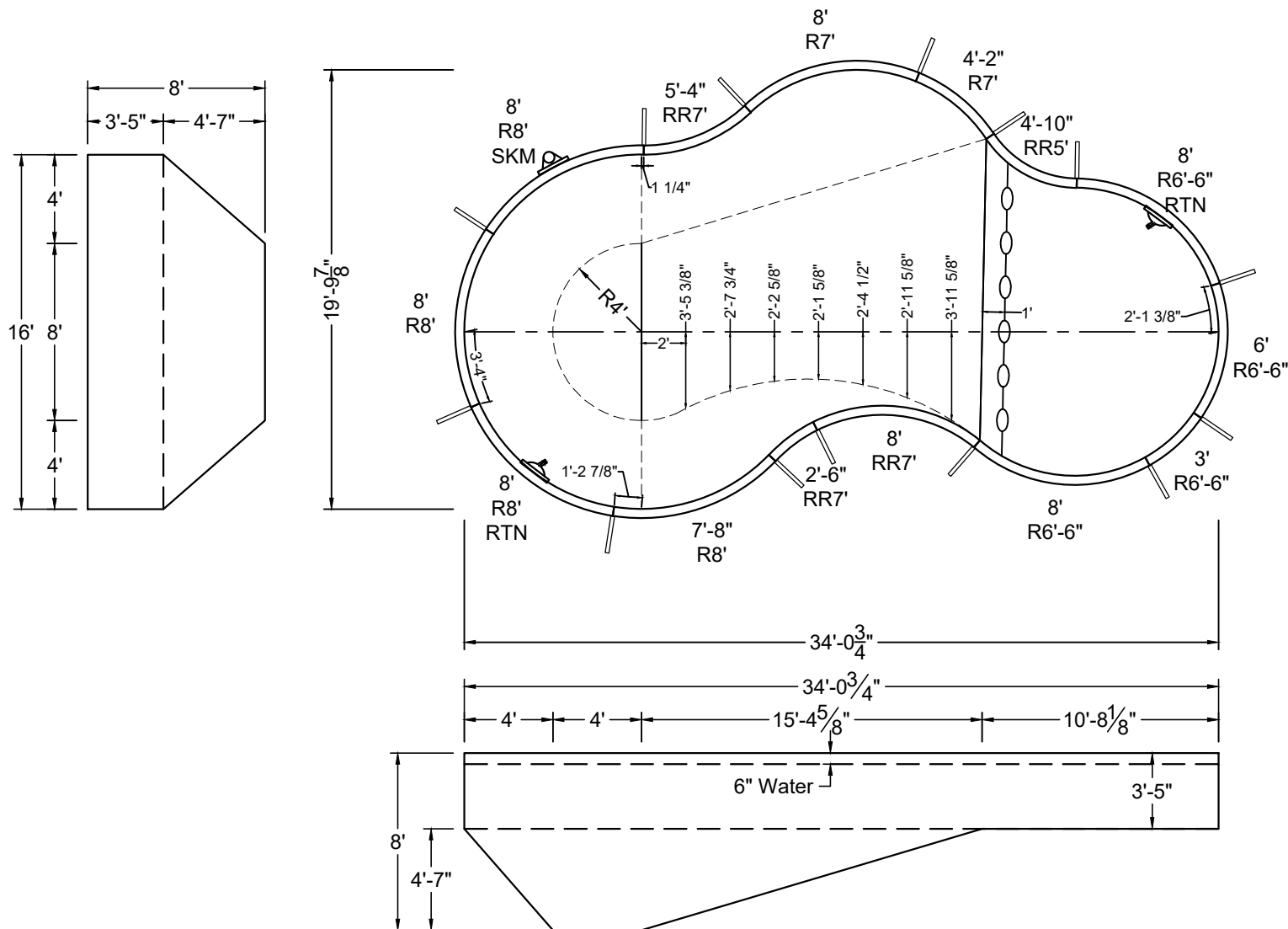

SHAPE: HUMPBACK KIDNEY	SIZE: 16' X 34'-1"	HAND: LEFT	PANEL HEIGHT: 3'-6"	PANEL TYPE: 3" TOP
PERIMETER: 89'-6"	VOLUME: 17,316 US GAL.	SURFACE AREA: 460.157 SQ. FT.	SCALE: N.T.S	DRAWN BY: NM-BCC
DWG #: MN1634HK-19	DATE: 1/9/2017	REVISION #: 01	KIT REF: MN1634HK-19-L	<b>A</b>

ALL DIMENSIONS ARE FINISHED

DIVING / SLIDE EQUIPMENT DISCLAIMER:

THE BOTTOM CONFIGURATION SHOWN MEETS WITH THE CURRENT ISPSC MINIMUM STANDARDS FOR POOLS APPROVED FOR THE USE WITH MANUFACTURED DIVING EQUIPMENT. ALL DIVING EQUIPMENT MUST BE INSTALLED AND LOCATED IN ACCORDANCE WITH THE DIVING / SLIDE MANUFACTURER'S RECOMMENDATIONS. IF DIVING EQUIPMENT IS INSTALLED: PLEASE FOLLOW ALL THE DIVING / SLIDE EQUIPMENT MANUFACTURER'S INSTALLATION, USE AND SAFETY INSTRUCTIONS.

MEETS DEPTH AND SHAPE MINIMUM STANDARD ANSI/NSPI-2003

STEEL CHECK

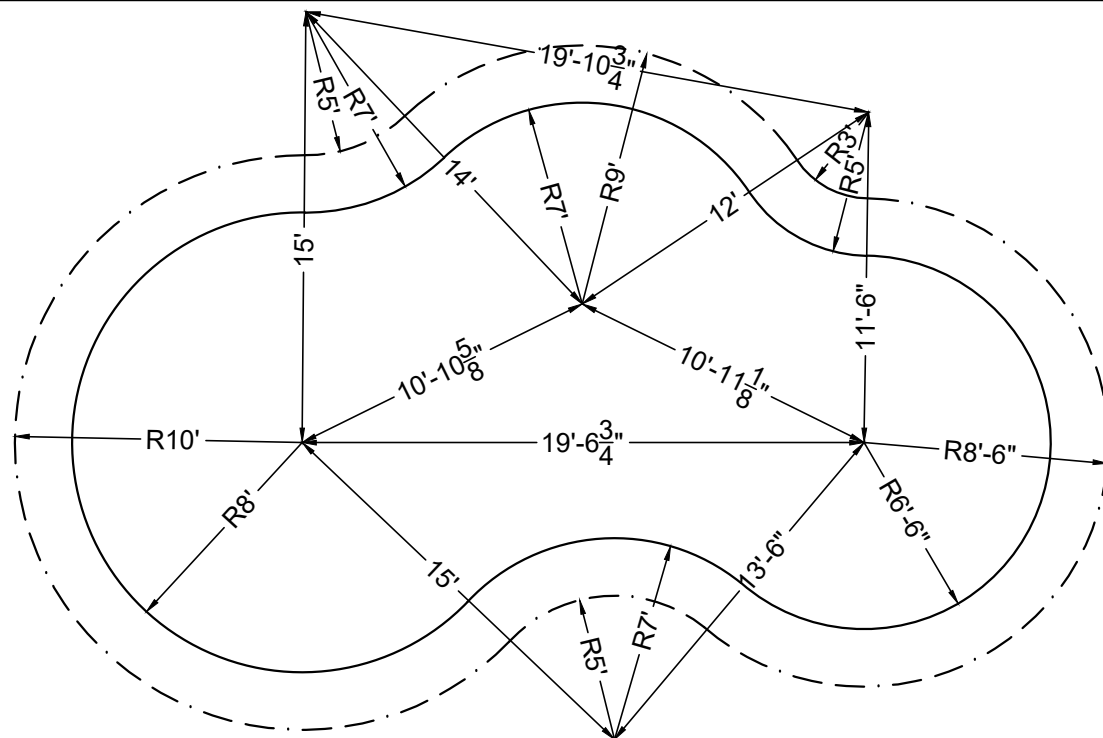

STAKE OUT

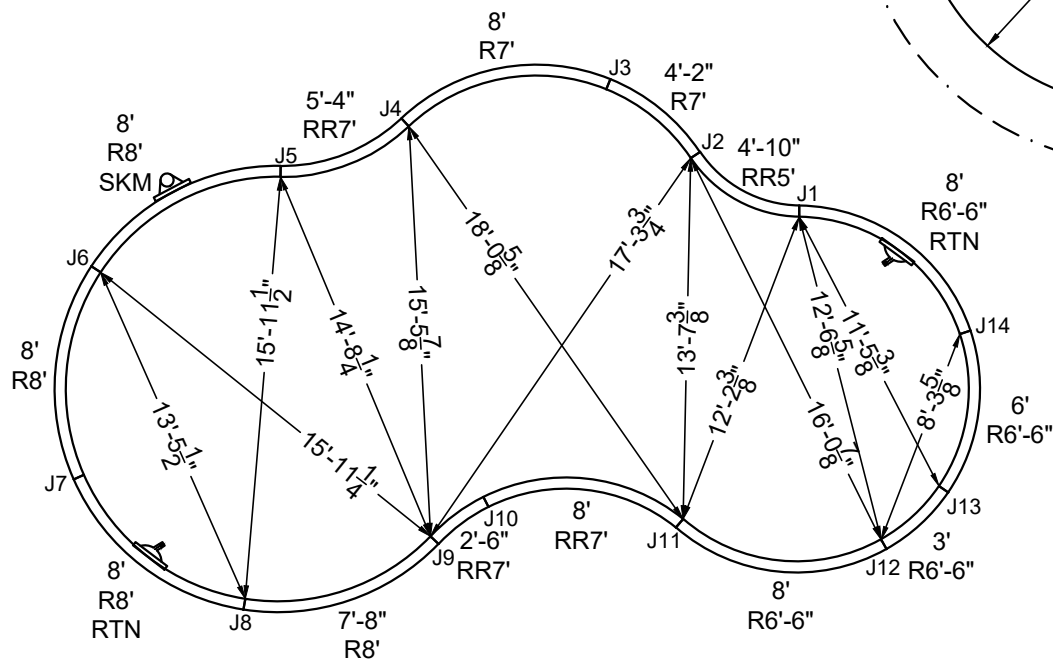

SHAPE : HUMPBACK KIDNEY	SIZE : 16' X 34'-1"	HAND : LEFT	PANEL HEIGHT : 3'-6"	DRAWN BY : NM-BCC
DWG # : MN1634HK-19	DATE : 1/9/2017	REVISION # : 01	KIT REF : MN1634HK-19-L	<b>B</b>

ALL DIMENSIONS ARE FINISHED

DIVING / SLIDE EQUIPMENT DISCLAIMER:

THE BOTTOM CONFIGURATION SHOWN MEETS WITH THE CURRENT ISPS MINIMUM STANDARDS FOR POOLS APPROVED FOR THE USE WITH MANUFACTURED DIVING EQUIPMENT. ALL DIVING EQUIPMENT MUST BE INSTALLED AND LOCATED IN ACCORDANCE WITH THE DIVING / SLIDE MANUFACTURER'S RECOMMENDATIONS. IF DIVING EQUIPMENT IS INSTALLED: PLEASE FOLLOW ALL THE DIVING / SLIDE EQUIPMENT MANUFACTURER'S INSTALLATION, USE AND SAFETY INSTRUCTIONS.

MEETS DEPTH AND SHAPE MINIMUM STANDARD ANSI/NSPI-2003

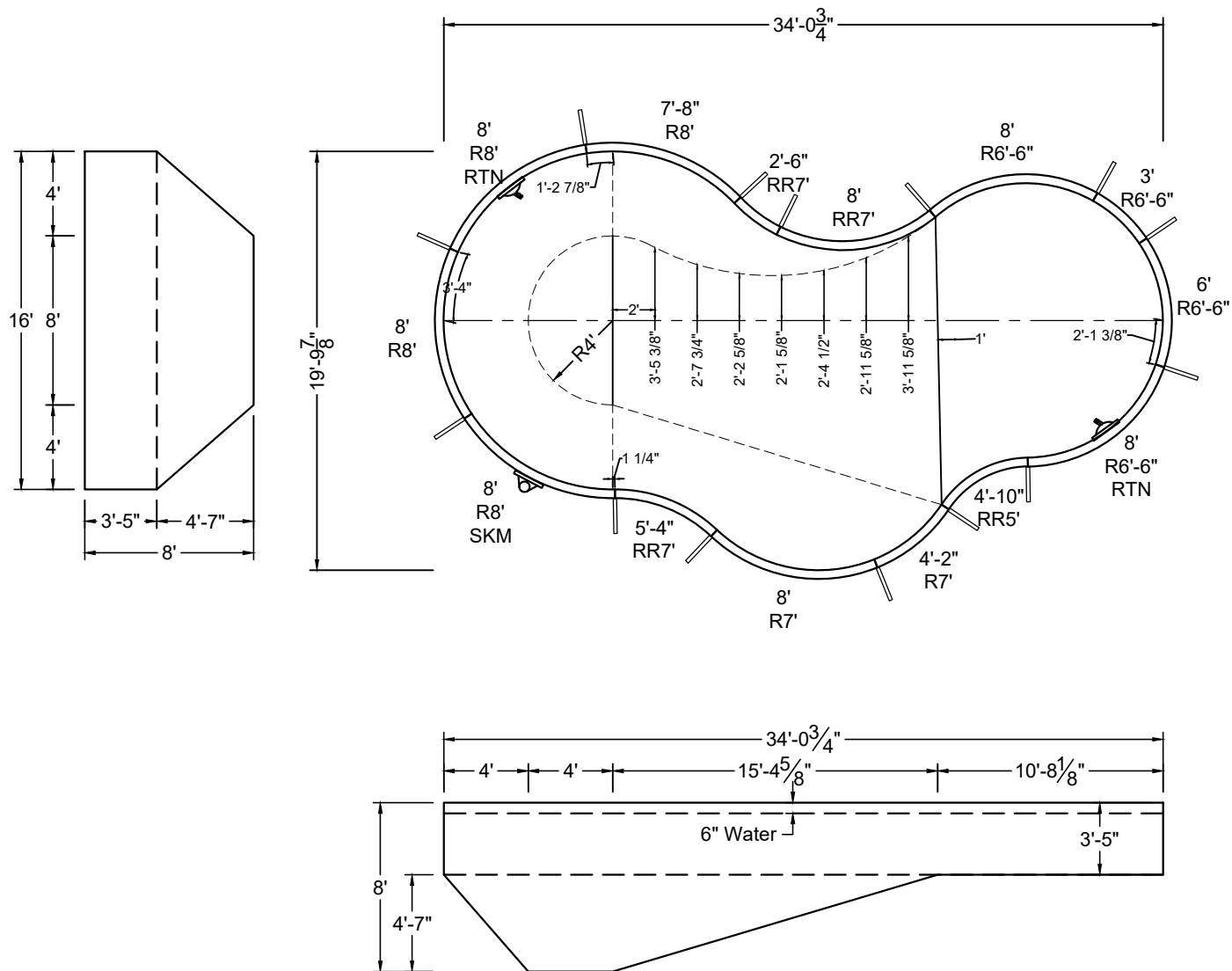

SHAPE : HUMPBAC KIDNEY	SIZE : 16' X 34'-1"	HAND : RIGHT	PANEL HEIGHT : 3'-6"	PANEL TYPE : 3" TOP
PERIMETER : 89'-6"	VOLUME : 17,316 US GAL.	SURFACE AREA : 460.157 SQ. FT.	SCALE : N.T.S	DRAWN BY : NM-BCC
DWG # : MN1634HK-19	DATE : 1/9/2017	REVISION # : 01	KIT REF : MN1634HK-19-R	<b>A</b>



**DIVING / SLIDE EQUIPMENT DISCLAIMER:**

THE BOTTOM CONFIGURATION SHOWN MEETS WITH THE CURRENT IPSC MINIMUM STANDARDS FOR POOLS APPROVED FOR THE USE WITH MANUFACTURED DIVING EQUIPMENT. ALL DIVING EQUIPMENT MUST BE INSTALLED AND LOCATED IN ACCORDANCE WITH THE DIVING / SLIDE MANUFACTURER'S RECOMMENDATIONS. IF DIVING EQUIPMENT IS INSTALLED: PLEASE FOLLOW ALL THE DIVING / SLIDE EQUIPMENT MANUFACTURER'S INSTALLATION, USE AND SAFETY INSTRUCTIONS.

MEETS DEPTH AND SHAPE MINIMUM STANDARD ANSI/NSPI5-2003

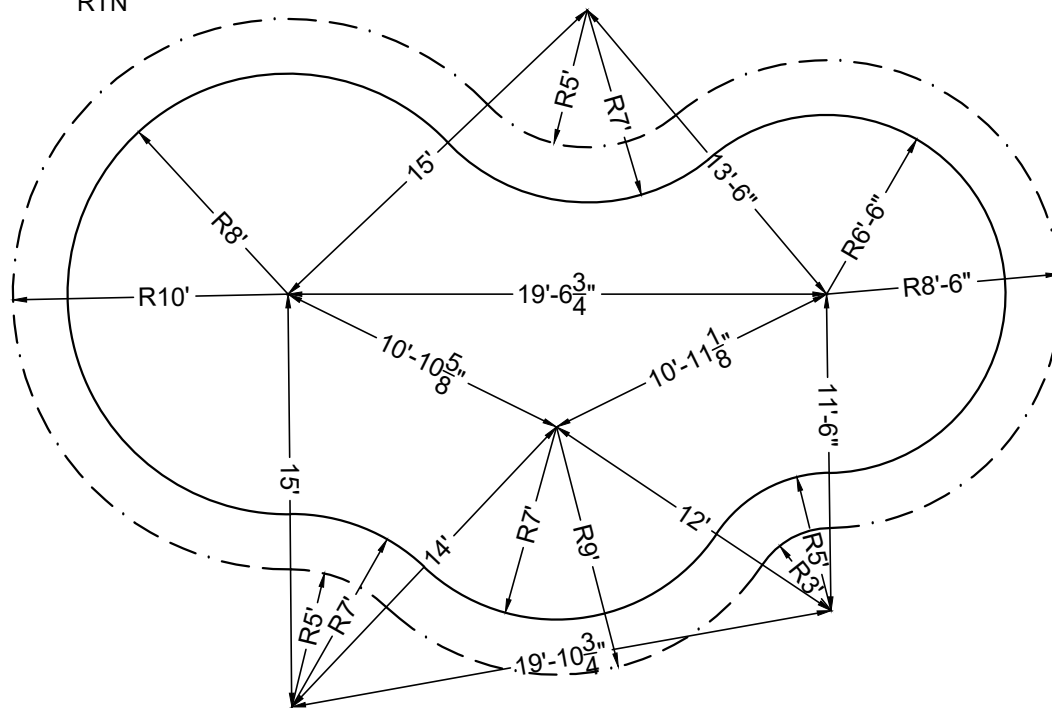

## STAKE OUT

## STEEL CHECK

SHAPE : HUMPBACK KIDNEY	SIZE : 16' X 34'-1"	HAND : RIGHT	PANEL HEIGHT : 3'-6"	DRAWN BY : NM-BCC
DWG # : MN1634HK-19	DATE : 1/9/2017	REVISION # : 01	KIT REF : MN1634HK-19-R	<b>B</b>



ALL DIMENSIONS ARE FINISHED

DIVING / SLIDE EQUIPMENT DISCLAIMER:

THE BOTTOM CONFIGURATION SHOWN MEETS WITH THE CURRENT ISPSC MINIMUM STANDARDS FOR POOLS APPROVED FOR THE USE WITH MANUFACTURED DIVING EQUIPMENT. ALL DIVING EQUIPMENT MUST BE INSTALLED AND LOCATED IN ACCORDANCE WITH THE DIVING / SLIDE MANUFACTURER'S RECOMMENDATIONS. IF DIVING EQUIPMENT IS INSTALLED: PLEASE FOLLOW ALL THE DIVING / SLIDE EQUIPMENT MANUFACTURER'S INSTALLATION, USE AND SAFETY INSTRUCTIONS.

MEETS DEPTH AND SHAPE MINIMUM STANDARD ANSI/NSPI5-2003

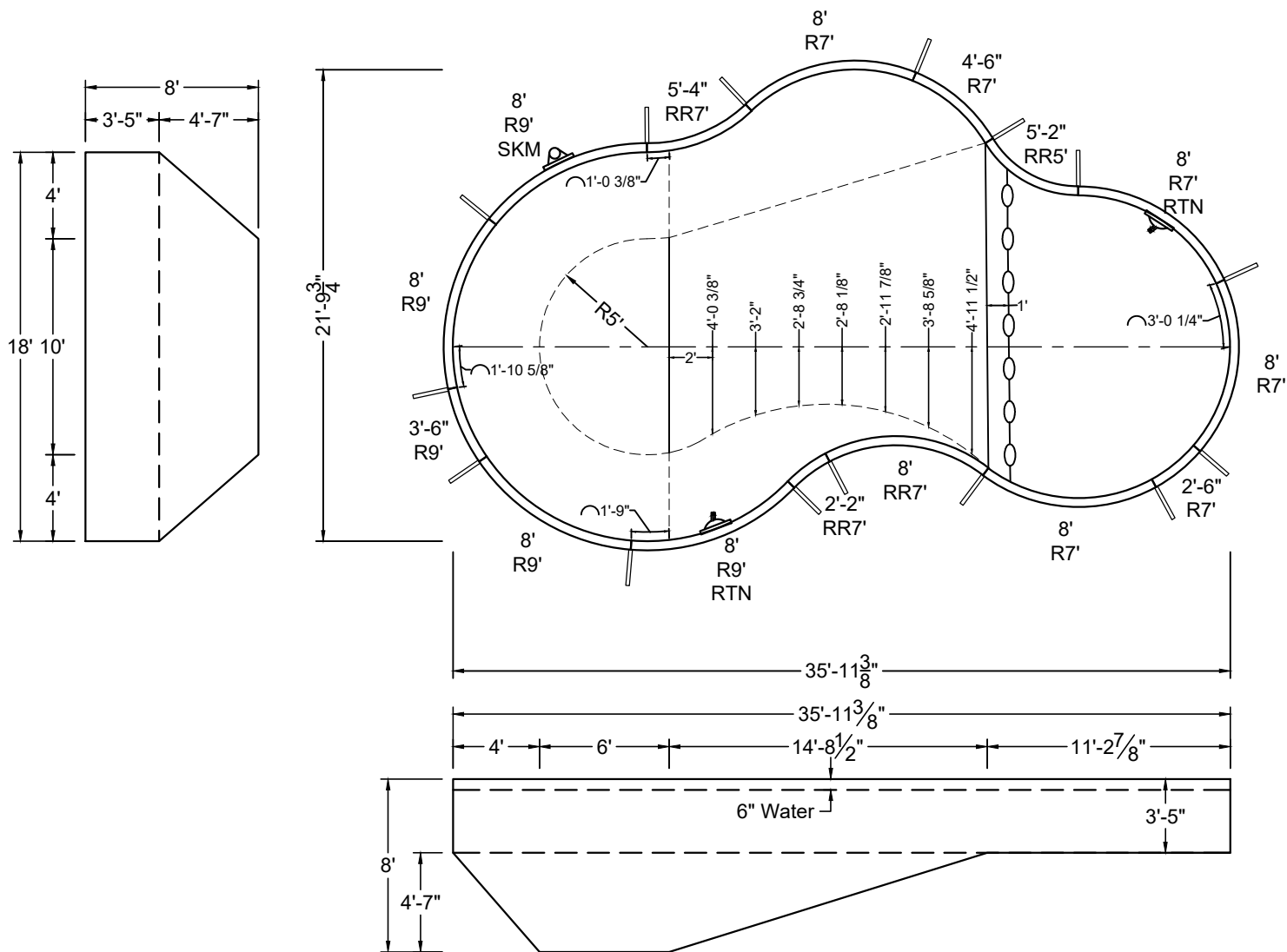

SHAPE : HUMPBACK KIDNEY	SIZE : 18' X 35'-11"	HAND : LEFT	PANEL HEIGHT : 3'-6"	PANEL TYPE : 3" TOP
PERIMETER : 95'-2"	VOLUME : 20,920 US GAL.	SURFACE AREA : 537.381 SQ. FT.	SCALE : N.T.S	DRAWN BY : NM-BCC
DWG # : MN1836HK-19	DATE : 1/9/2017	REVISION # : 01	KIT REF : MN1836HK-19-L	<b>A</b>



ALL DIMENSIONS ARE FINISHED

DIVING / SLIDE EQUIPMENT DISCLAIMER:

THE BOTTOM CONFIGURATION SHOWN MEETS WITH THE CURRENT ISPSC MINIMUM STANDARDS FOR POOLS APPROVED FOR THE USE WITH MANUFACTURED DIVING EQUIPMENT. ALL DIVING EQUIPMENT MUST BE INSTALLED AND LOCATED IN ACCORDANCE WITH THE DIVING / SLIDE MANUFACTURER'S RECOMMENDATIONS. IF DIVING EQUIPMENT IS INSTALLED: PLEASE FOLLOW ALL THE DIVING / SLIDE EQUIPMENT MANUFACTURER'S INSTALLATION, USE AND SAFETY INSTRUCTIONS.

MEETS DEPTH AND SHAPE MINIMUM STANDARD ANSI/NSPI5-2003

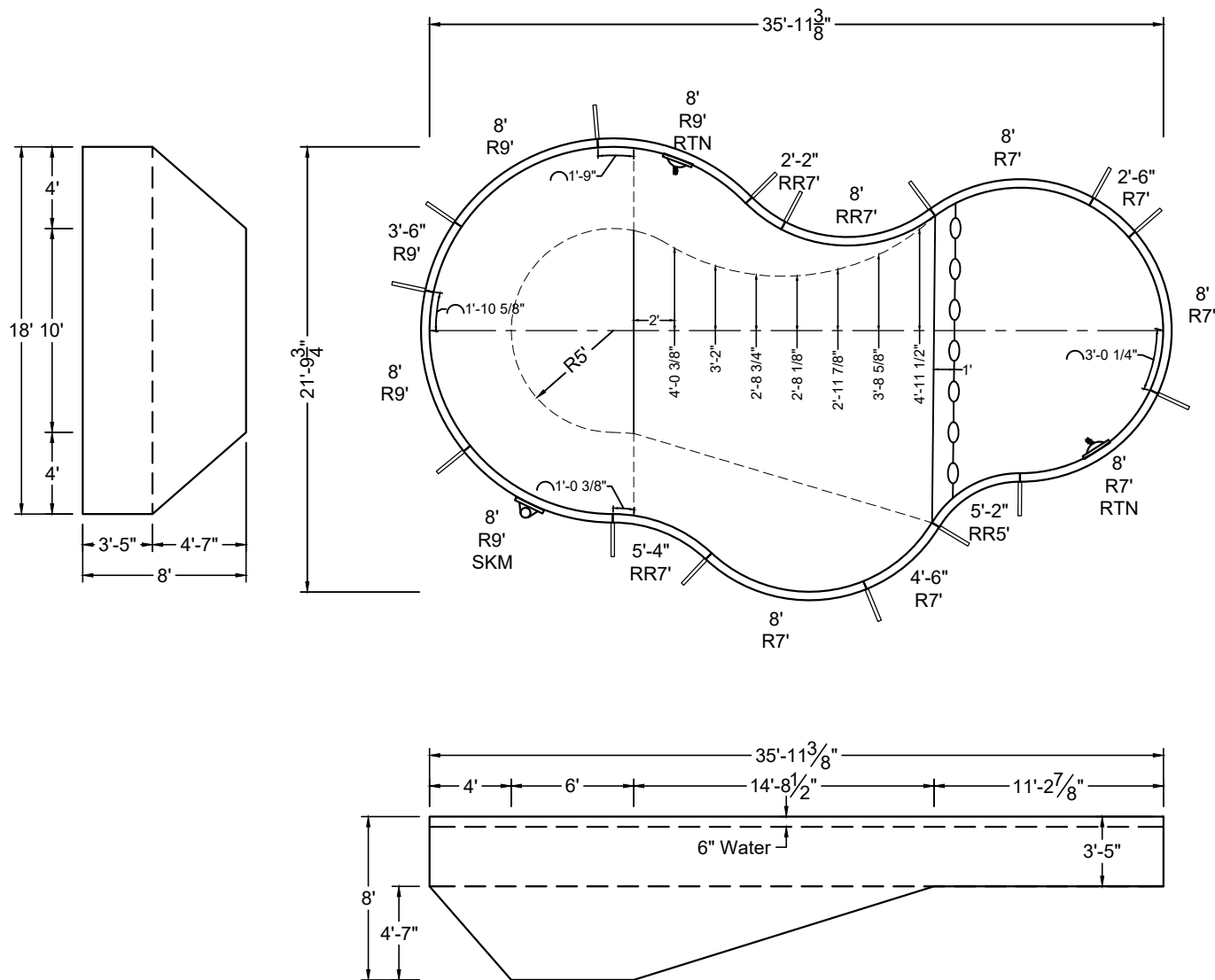

SHAPE : HUMPBACK KIDNEY	SIZE : 18' X 35'-11"	HAND : RIGHT	PANEL HEIGHT : 3'-6"	PANEL TYPE : 3" TOP
PERIMETER : 95'-2"	VOLUME : 20,920 US GAL.	SURFACE AREA : 537.381 SQ. FT.	SCALE : N.T.S	DRAWN BY : NM-BCC
DWG # : MN1836HK-19	DATE : 1/9/2017	REVISION # : 01	KIT REF : MN1836HK-19-R	<b>A</b>



## DIVING / SLIDE EQUIPMENT DISCLAIMER:

THE BOTTOM CONFIGURATION SHOWN MEETS WITH THE CURRENT IPSC MINIMUM STANDARDS FOR POOLS APPROVED FOR THE USE WITH MANUFACTURED DIVING EQUIPMENT. ALL DIVING EQUIPMENT MUST BE INSTALLED AND LOCATED IN ACCORDANCE WITH THE DIVING / SLIDE MANUFACTURER'S RECOMMENDATIONS. IF DIVING EQUIPMENT IS INSTALLED: PLEASE FOLLOW ALL THE DIVING / SLIDE EQUIPMENT MANUFACTURER'S INSTALLATION, USE AND SAFETY INSTRUCTIONS.

MEETS DEPTH AND SHAPE MINIMUM STANDARD ANSI/NSPI5-2003



## STAKE OUT

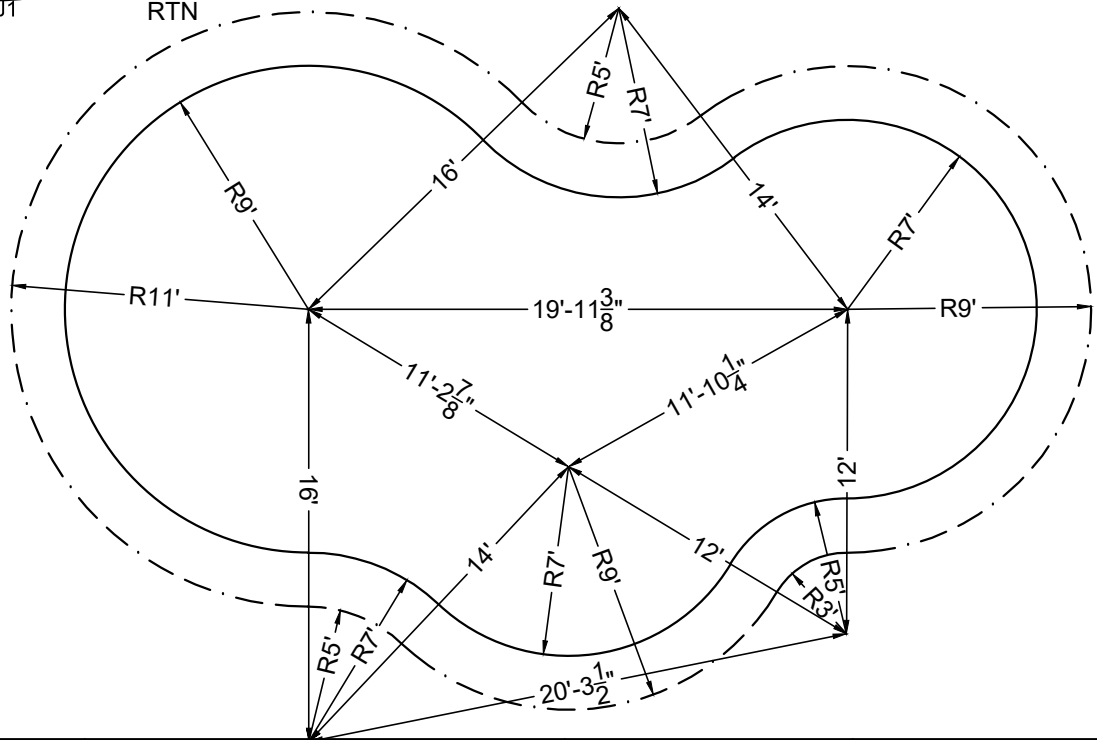

SHAPE : HUMPBACK KIDNEY	SIZE : 18' X 35'-11"	HAND : RIGHT	PANEL HEIGHT : 3'-6"	DRAWN BY : NM-BCC
DWG # : MN1836HK-19	DATE : 1/9/2017	REVISION # : 01	KIT REF : MN1836HK-19-R	<b>B</b>

ALL DIMENSIONS ARE FINISHED

DIVING / SLIDE EQUIPMENT DISCLAIMER:

THE BOTTOM CONFIGURATION SHOWN MEETS WITH THE CURRENT ISPSC MINIMUM STANDARDS FOR POOLS APPROVED FOR THE USE WITH MANUFACTURED DIVING EQUIPMENT. ALL DIVING EQUIPMENT MUST BE INSTALLED AND LOCATED IN ACCORDANCE WITH THE DIVING / SLIDE MANUFACTURER'S RECOMMENDATIONS. IF DIVING EQUIPMENT IS INSTALLED: PLEASE FOLLOW ALL THE DIVING / SLIDE EQUIPMENT MANUFACTURER'S INSTALLATION, USE AND SAFETY INSTRUCTIONS.

MEETS DEPTH AND SHAPE MINIMUM STANDARD ANSI/NSPI5-2003

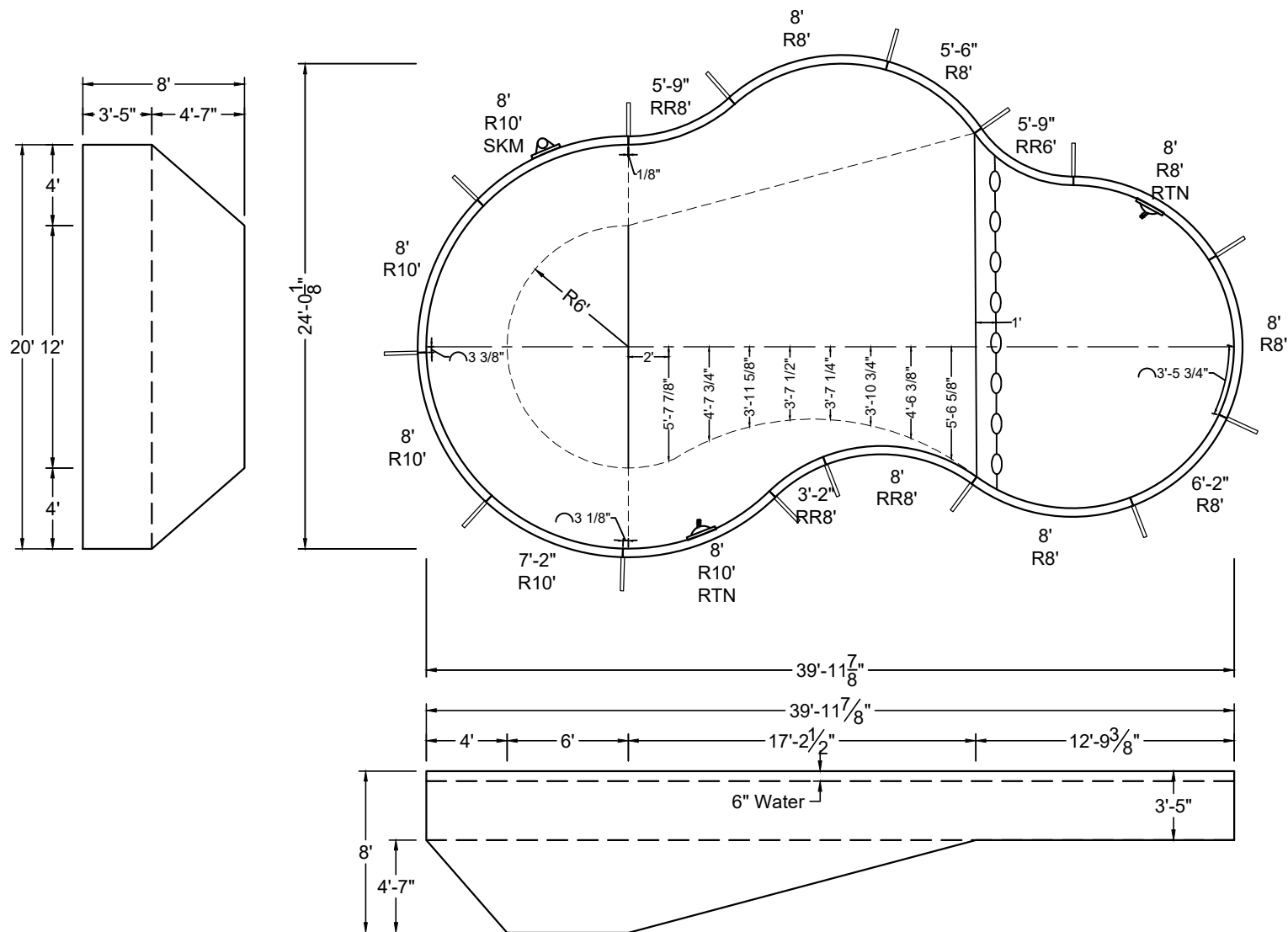

SHAPE : HUMPBACK KIDNEY	SIZE : 20' X 40'	HAND : LEFT	PANEL HEIGHT : 3'-6"	PANEL TYPE : 3" TOP
PERIMETER : 105'-6"	VOLUME : 25,925 US GAL.	SURFACE AREA : 668.315 SQ. FT.	SCALE : N.T.S	DRAWN BY : NM-BCC
DWG # : MN2040HK-19	DATE : 1/9/2017	REVISION # : 01	KIT REF : MN2040HK-19-L	<b>A</b>

ALL DIMENSIONS ARE FINISHED

DIVING / SLIDE EQUIPMENT DISCLAIMER:

THE BOTTOM CONFIGURATION SHOWN MEETS WITH THE CURRENT ISPSC MINIMUM STANDARDS FOR POOLS APPROVED FOR THE USE WITH MANUFACTURED DIVING EQUIPMENT. ALL DIVING EQUIPMENT MUST BE INSTALLED AND LOCATED IN ACCORDANCE WITH THE DIVING / SLIDE MANUFACTURER'S RECOMMENDATIONS. IF DIVING EQUIPMENT IS INSTALLED: PLEASE FOLLOW ALL THE DIVING / SLIDE EQUIPMENT MANUFACTURER'S INSTALLATION, USE AND SAFETY INSTRUCTIONS.

MEETS DEPTH AND SHAPE MINIMUM STANDARD ANSI/NSPI5-2003

STEEL CHECK

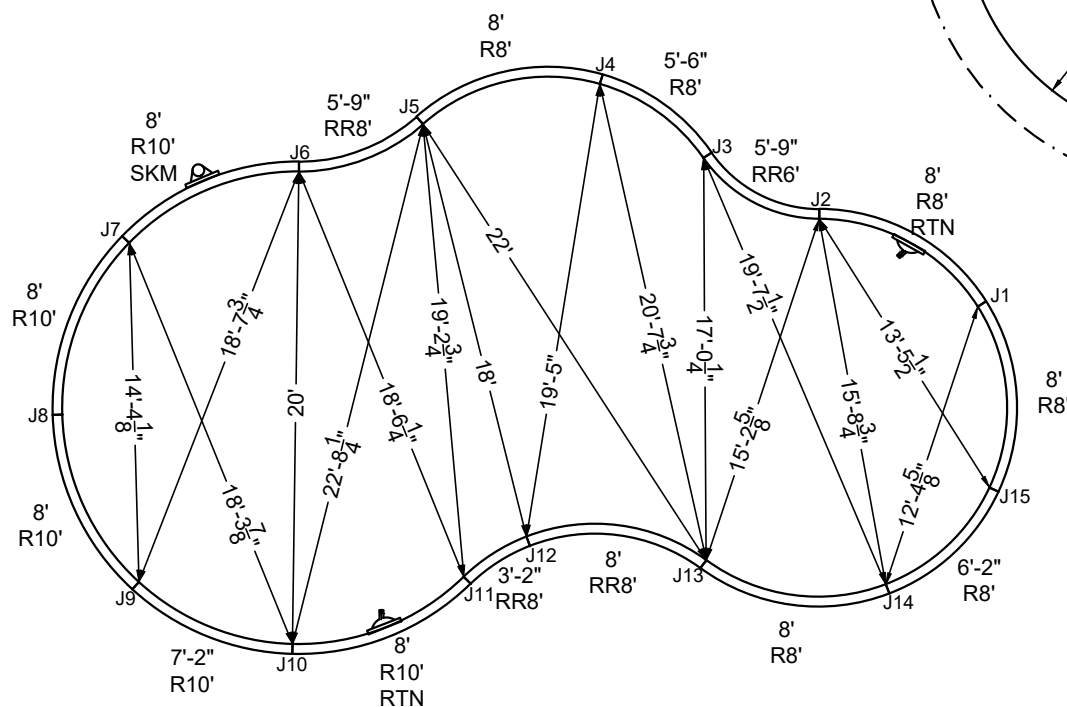

ALL DIMENSIONS ARE FINISHED

DIVING / SLIDE EQUIPMENT DISCLAIMER:

THE BOTTOM CONFIGURATION SHOWN MEETS WITH THE CURRENT ISPSC MINIMUM STANDARDS FOR POOLS APPROVED FOR THE USE WITH MANUFACTURED DIVING EQUIPMENT. ALL DIVING EQUIPMENT MUST BE INSTALLED AND LOCATED IN ACCORDANCE WITH THE DIVING / SLIDE MANUFACTURER'S RECOMMENDATIONS. IF DIVING EQUIPMENT IS INSTALLED: PLEASE FOLLOW ALL THE DIVING / SLIDE EQUIPMENT MANUFACTURER'S INSTALLATION, USE AND SAFETY INSTRUCTIONS.

MEETS DEPTH AND SHAPE MINIMUM STANDARD ANSI/NSPI5-2003

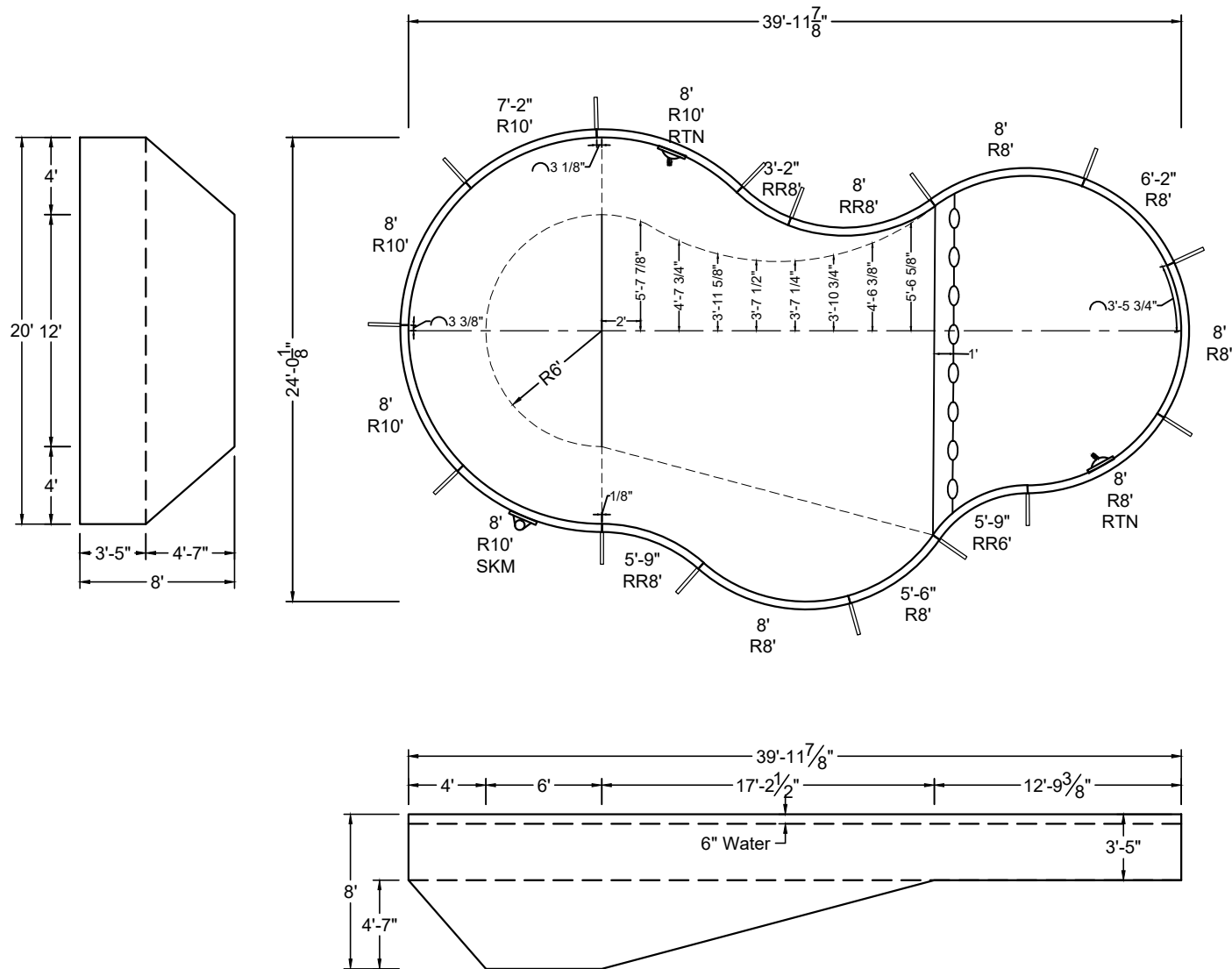

SHAPE : HUMPBAC KIDNEY	SIZE : 20' X 40'	HAND : RIGHT	PANEL HEIGHT : 3'-6"	PANEL TYPE : 3" TOP
PERIMETER : 105'-6"	VOLUME : 25,925 US GAL.	SURFACE AREA : 668.315 SQ. FT.	SCALE : N.T.S	DRAWN BY : NM-BCC
DWG # : MN2040HK-19	DATE : 1/9/2017	REVISION # : 01	KIT REF : MN2040HK-19-R	<b>A</b>

ALL DIMENSIONS ARE FINISHED

DIVING / SLIDE EQUIPMENT DISCLAIMER:

THE BOTTOM CONFIGURATION SHOWN MEETS WITH THE CURRENT ISPCS MINIMUM STANDARDS FOR POOLS APPROVED FOR THE USE WITH MANUFACTURED DIVING EQUIPMENT. ALL DIVING EQUIPMENT MUST BE INSTALLED AND LOCATED IN ACCORDANCE WITH THE DIVING / SLIDE MANUFACTURER'S RECOMMENDATIONS. IF DIVING EQUIPMENT IS INSTALLED: PLEASE FOLLOW ALL THE DIVING / SLIDE EQUIPMENT MANUFACTURER'S INSTALLATION, USE AND SAFETY INSTRUCTIONS.

MEETS DEPTH AND SHAPE MINIMUM STANDARD ANSI/NSPI5-2003

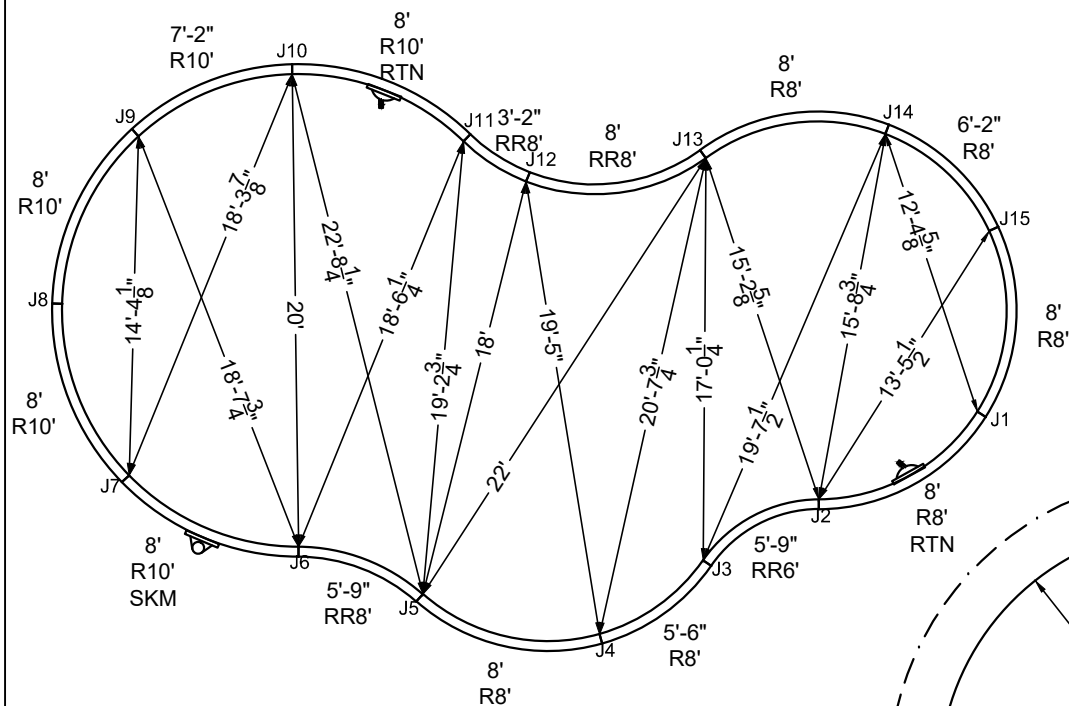

STAKE OUT

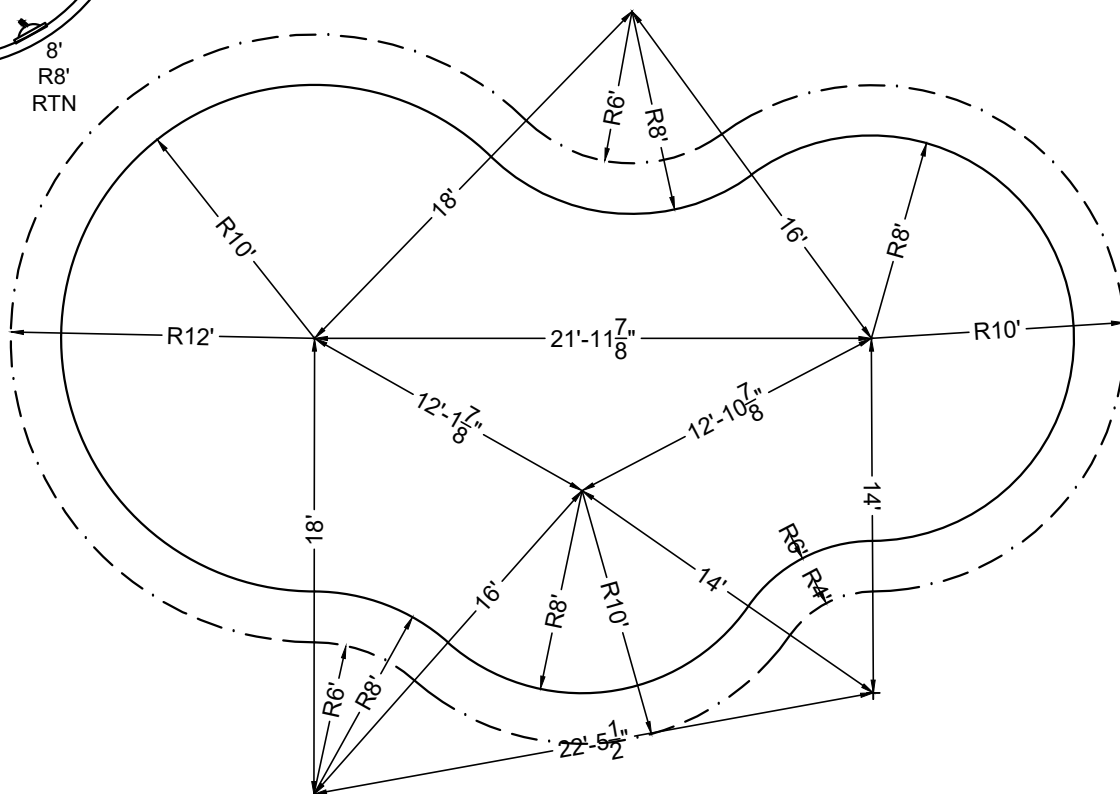

SHAPE: HUMPBACK KIDNEY

SIZE: 20' X 40'

HAND: RIGHT

PANEL HEIGHT: 3'-6"

DRAWN BY: NM-BCC

DWG #: MN2040HK-19

DATE: 1/9/2017

REVISION #: 01

KIT REF: MN2040HK-19-R

**B**