





## NON-DIVING POOL

USE OF DIVING EQUIPMENT IS PROHIBITED

MEETS DEPTH AND SHAPE MINIMUM STANDARD ANSI/NSPI5-2003

ALL DIMENSIONS ARE FINISHED

STEEL CHECK

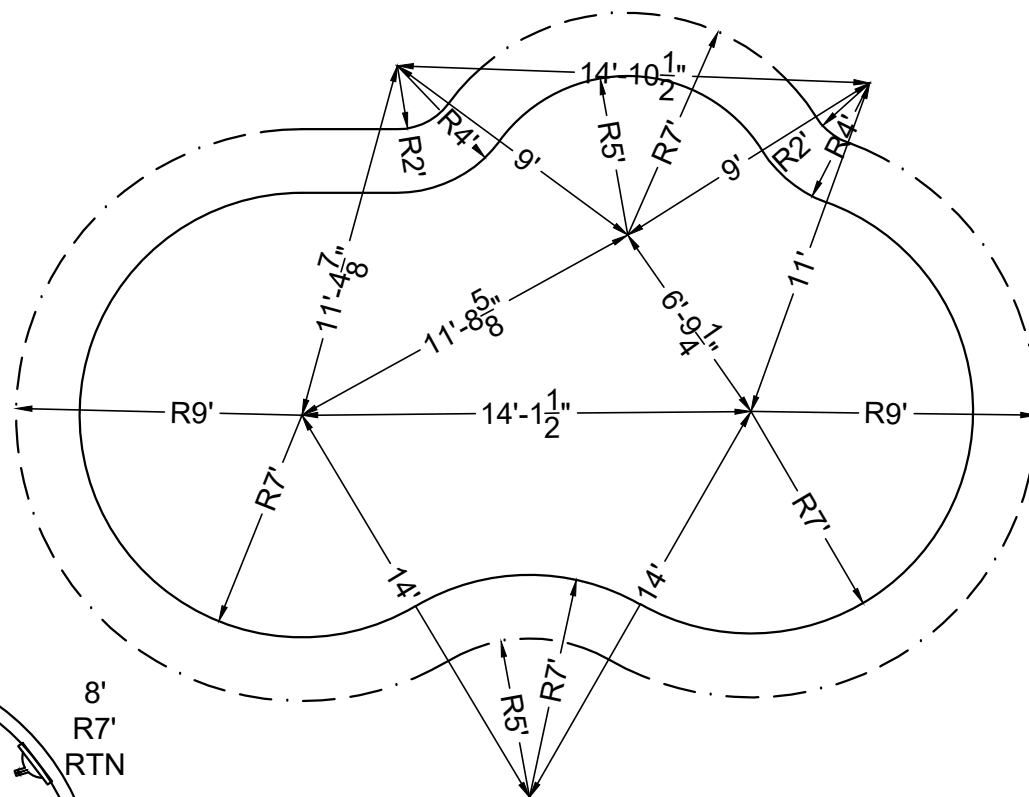
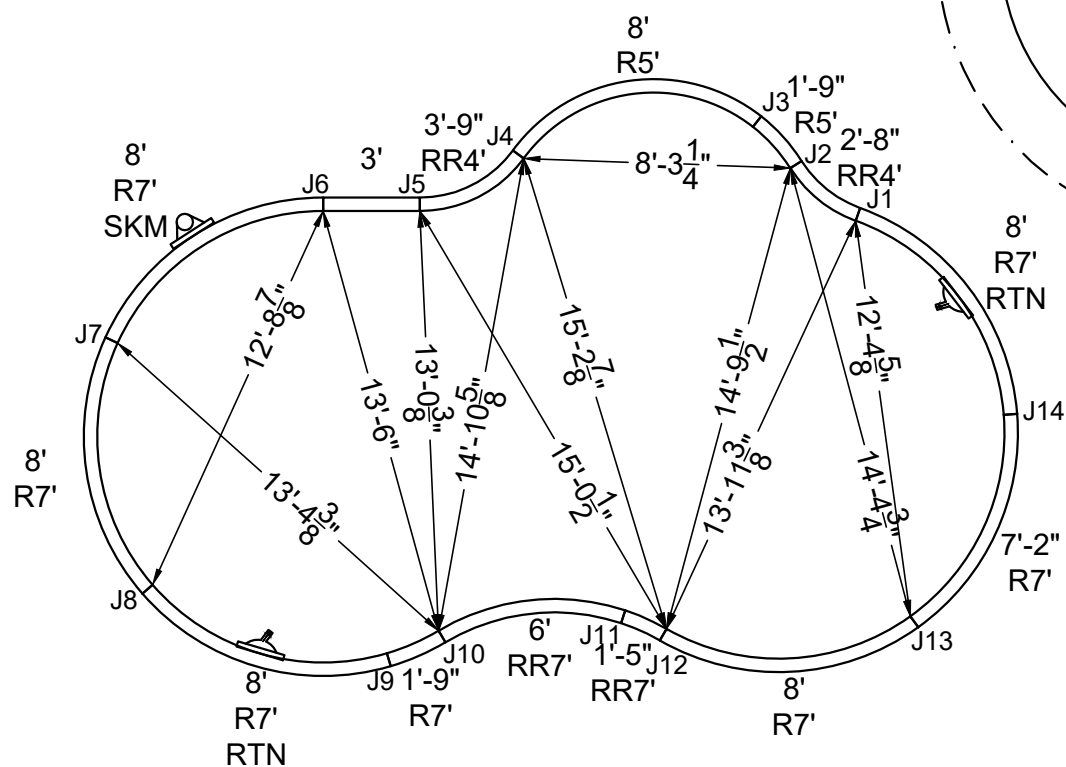

## STAKE OUT

SHAPE : HUMPBACK HAVEN	SIZE : 14' X 28'-2"	HAND : LEFT	PANEL HEIGHT : 3'-6"	DRAWN BY : NM-BCC
DWG # : MN1428HH-19	DATE : 12/23/2016	REVISION # : 01	KIT REF : MN1428HH-19-L	<b>B</b>

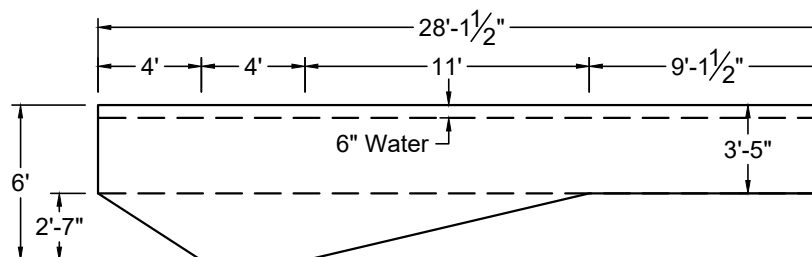

ALL DIMENSIONS ARE FINISHED

A



ALL DIMENSIONS ARE FINISHED



## STAKE OUT

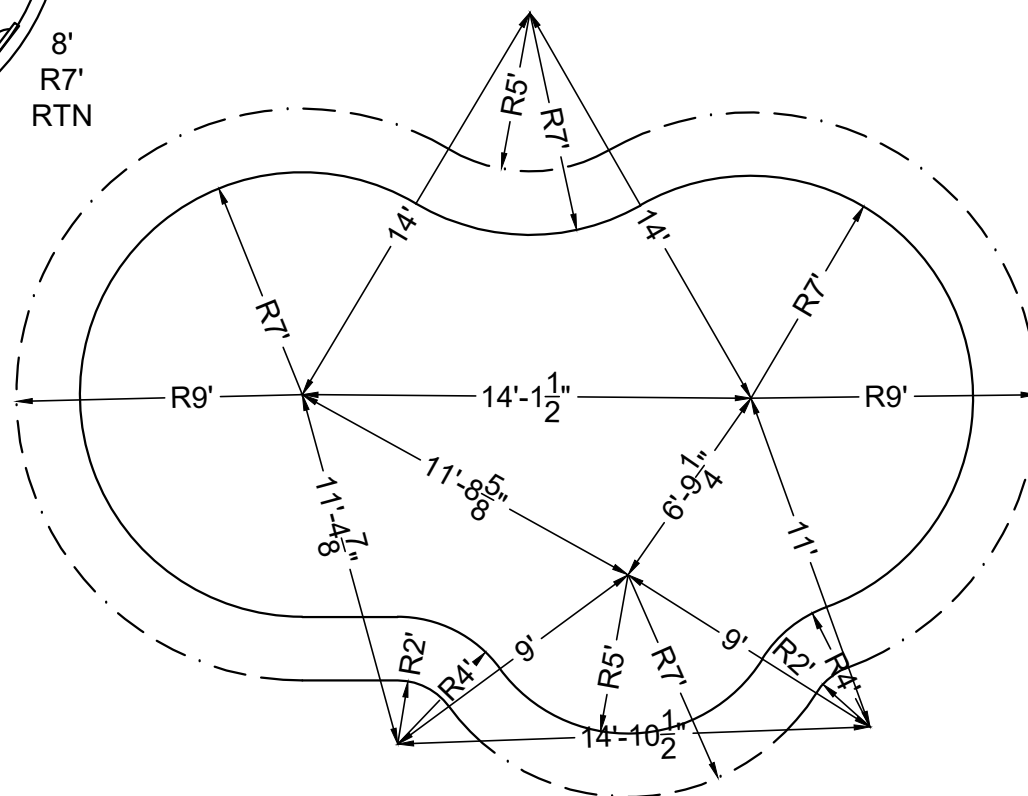

SHAPE : HUMPBACK HAVEN	SIZE : 14' X 28'-2"	HAND : RIGHT	PANEL HEIGHT : 3'-6"	DRAWN BY : NM-BCC
DWG # : MN1428HH-19	DATE : 12/23/2016	REVISION # : 01	KIT REF : MN1428HH-19-R	<b>B</b>



**NON-DIVING POOL**  
USE OF DIVING EQUIPMENT IS PROHIBITED

MEETS DEPTH AND SHAPE MINIMUM STANDARD ANSI/NSPI5-2003

ALL DIMENSIONS ARE FINISHED

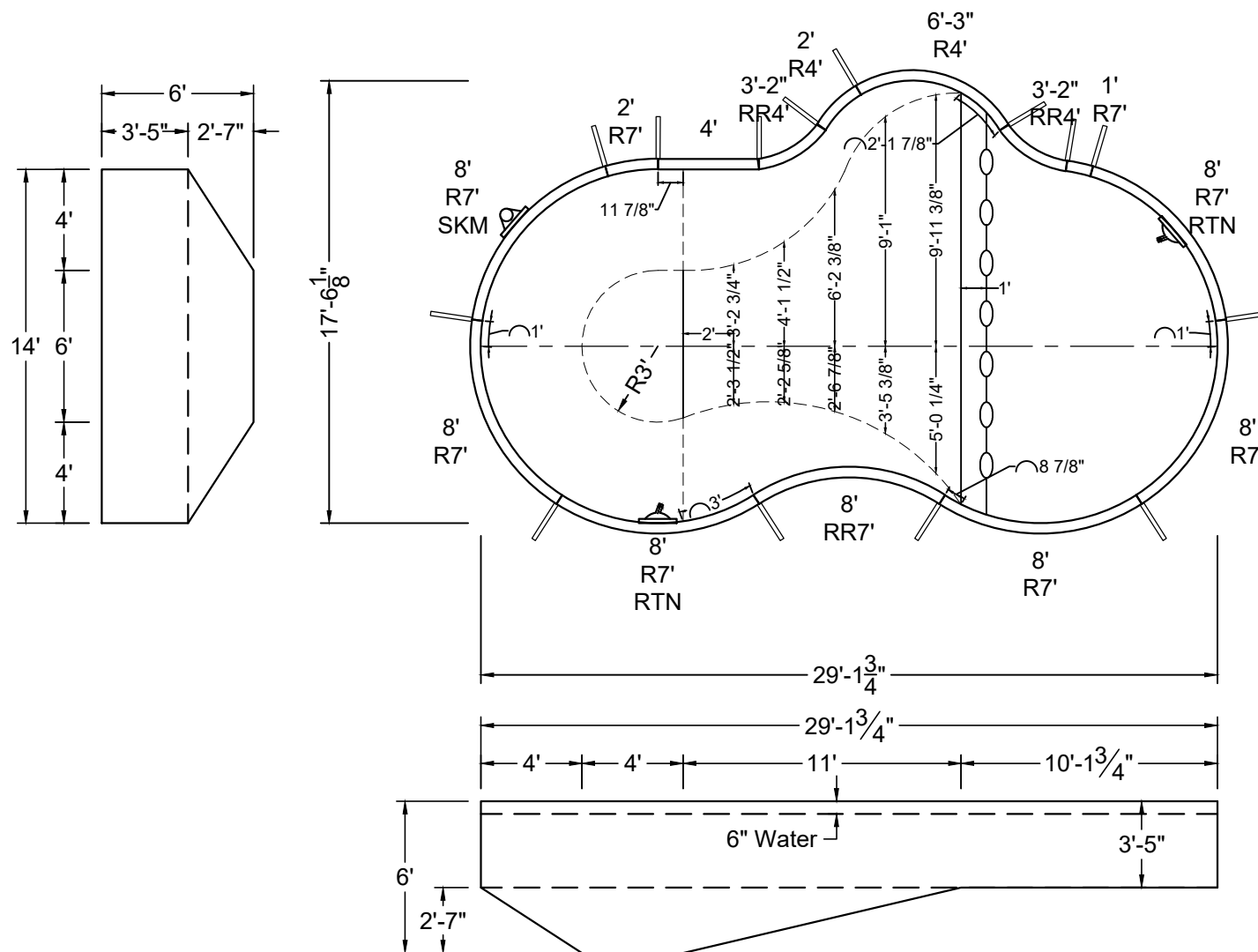

SHAPE : HUMPBACK HAVEN	SIZE : 14' X 29'-2"	HAND : LEFT	PANEL HEIGHT : 3'-6"	PANEL TYPE : 5" TOP
PERIMETER : 77'-6 25/32"	VOLUME : 11,800 US GAL.	SURFACE AREA : 372.025 SQ. FT.	SCALE : N.T.S	DRAWN BY : NM-BCC
DWG # : MN1429HH-19	DATE : 12/23/2016	REVISION # : 01	KIT REF : MN1429HH-19-L	<b>A</b>



MEETS DEPTH AND SHAPE MINIMUM STANDARD ANSI/NSPI5-2003

ALL DIMENSIONS ARE FINISHED

## STEEL CHECK

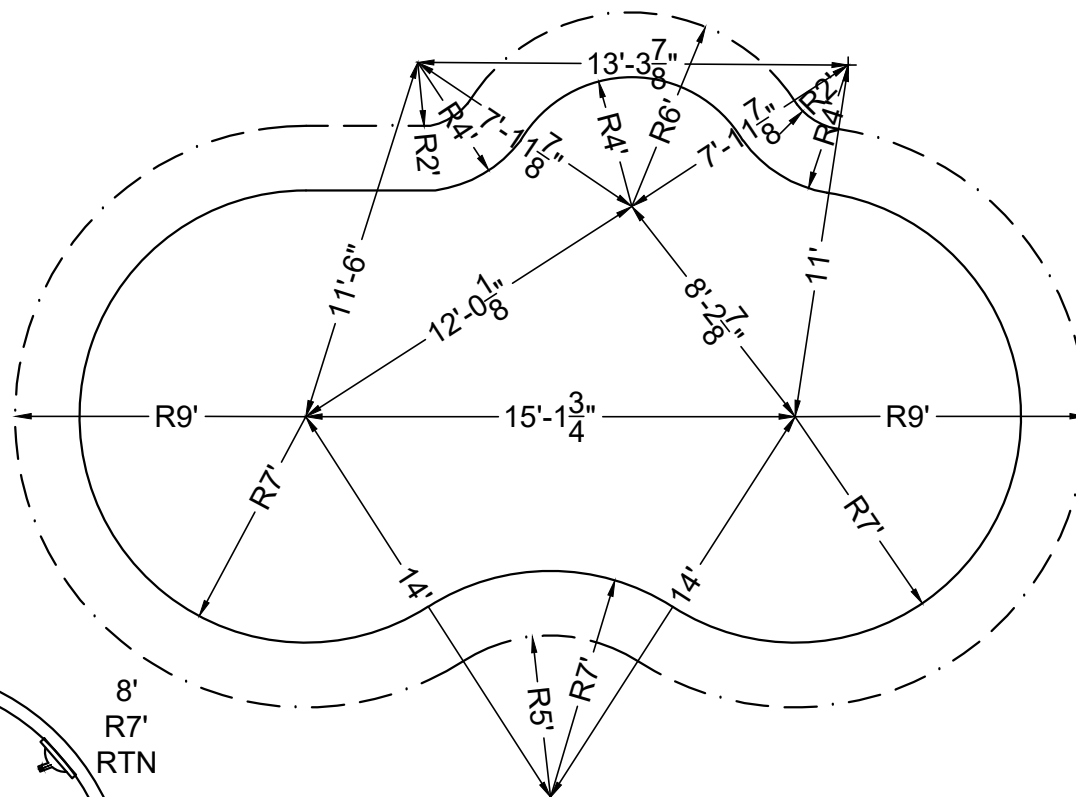
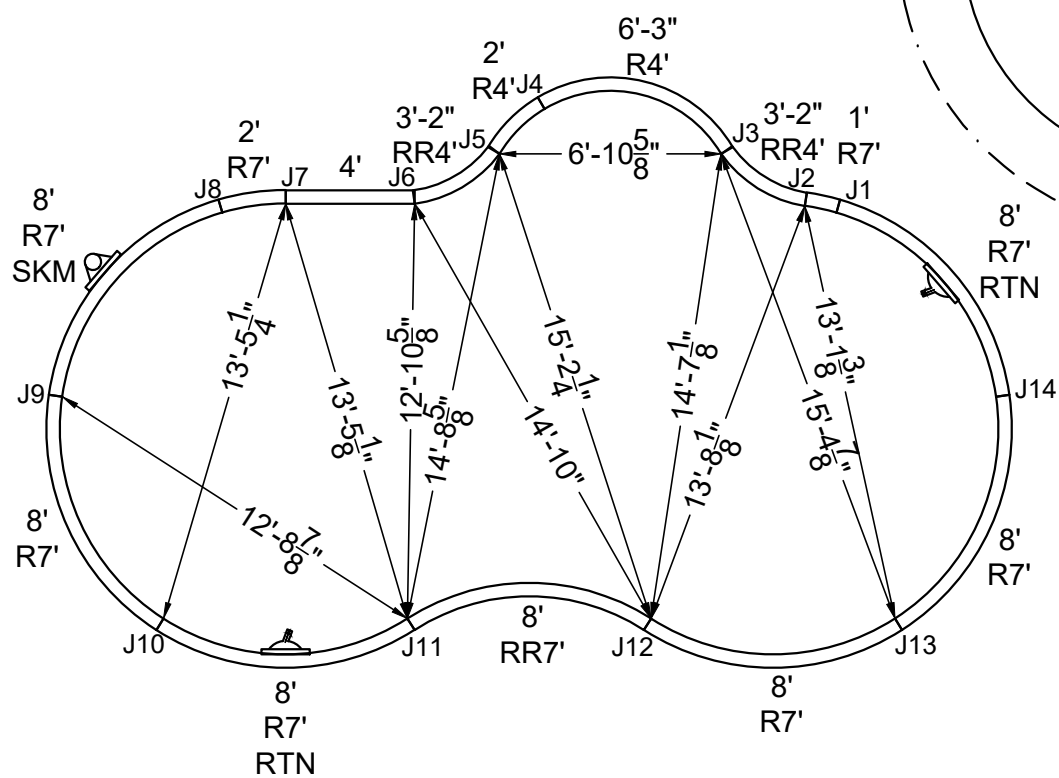

## STAKE OUT

SHAPE : HUMPBACK HAVEN	SIZE : 14' X 29'-2"	HAND : LEFT	PANEL HEIGHT : 3'-6"	DRAWN BY : NM-BCC
DWG # : MN1429HH-19	DATE : 12/23/2016	REVISION # : 01	KIT REF : MN1429HH-19-L	<b>B</b>

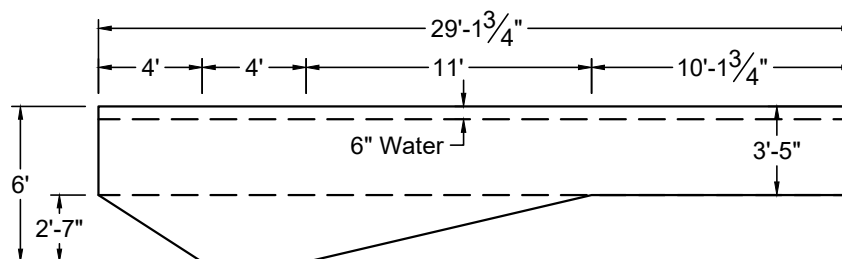

ALL DIMENSIONS ARE FINISHED

A

ALL DIMENSIONS ARE FINISHED



**NON-DIVING POOL**  
USE OF DIVING EQUIPMENT IS PROHIBITED

MEETS DEPTH AND SHAPE MINIMUM STANDARD ANSI/NSPI5-2003

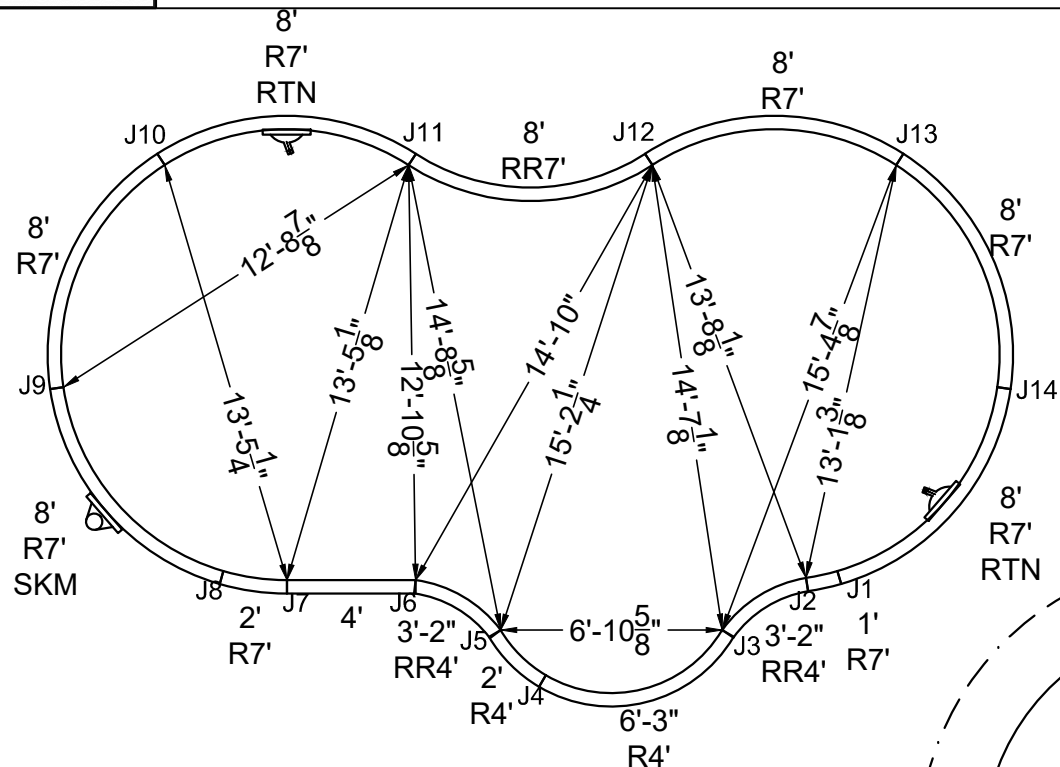

STEEL CHECK

STAKE OUT

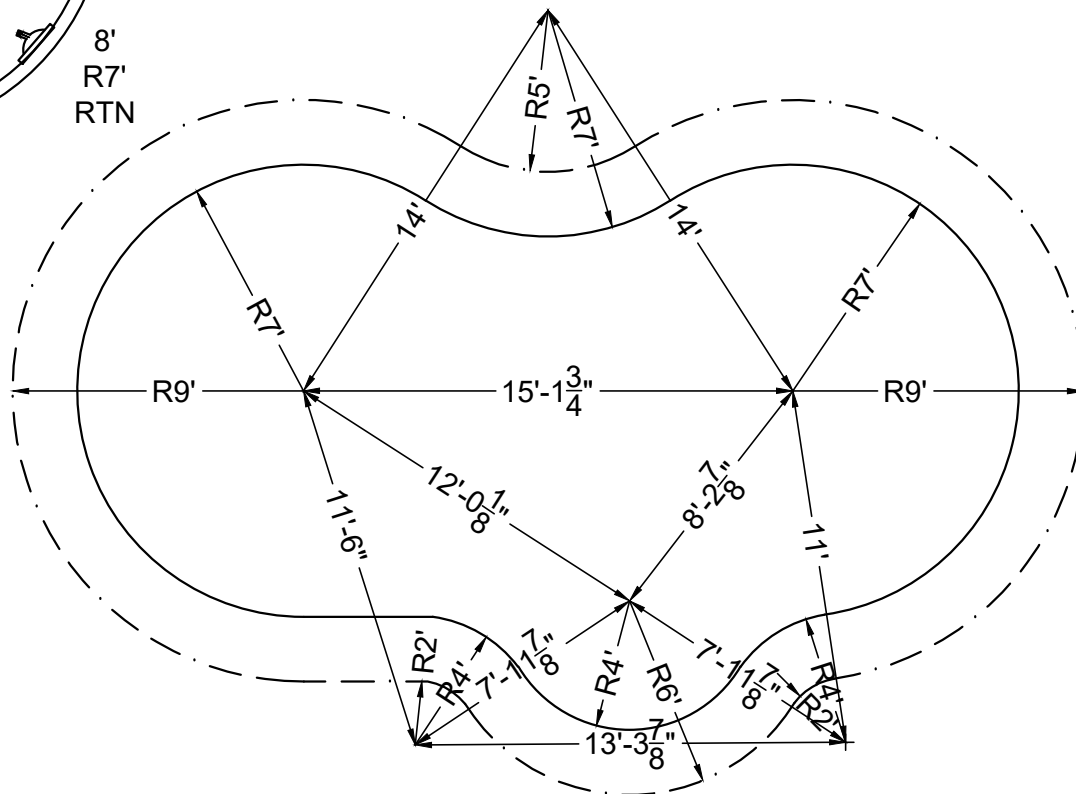

SHAPE: HUMPBACK HAVEN	SIZE: 14' X 29'-2"	HAND: RIGHT	PANEL HEIGHT: 3'-6"	DRAWN BY: NM-BCC
DWG #: MN1429HH-19	DATE: 12/23/2016	REVISION #: 01	KIT REF: MN1429HH-19-R	<b>B</b>





**NON-DIVING POOL**  
USE OF DIVING EQUIPMENT IS PROHIBITED

DOES NOT MEET DEPTH AND SHAPE MINIMUM STANDARD ANSI/NSPI5-2003

ALL DIMENSIONS ARE FINISHED

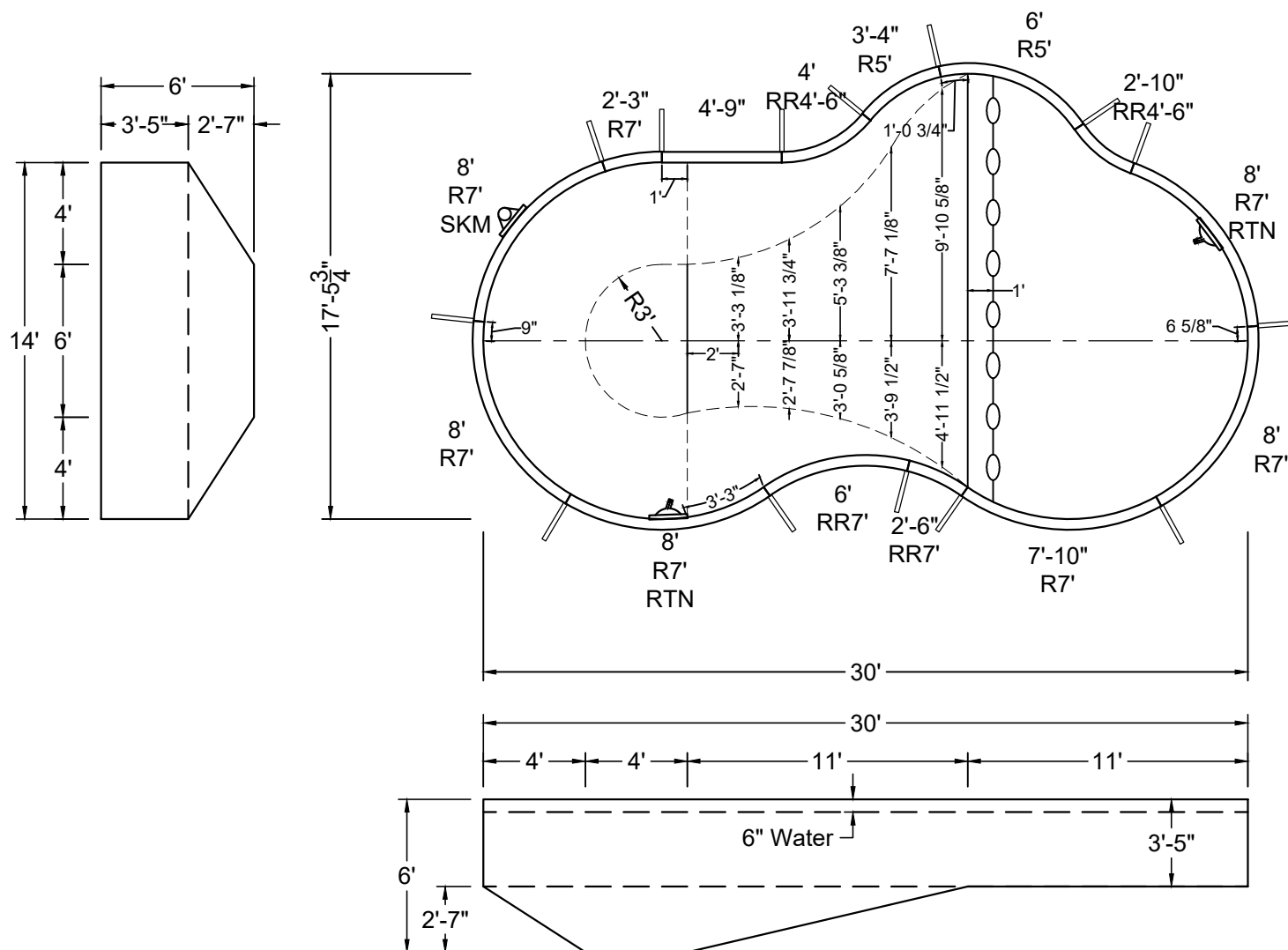

SHAPE : HUMPBACK HAVEN	SIZE : 14' X 30'	HAND : LEFT	PANEL HEIGHT : 3'-6"	PANEL TYPE : 5" TOP
PERIMETER : 79'-4 11/16"	VOLUME : 12,082 US GAL.	SURFACE AREA : 383.501 SQ. FT.	SCALE : N.T.S	DRAWN BY : NM-BCC
DWG # : MN1430HH-19	DATE : 12/23/2016	REVISION # : 01	KIT REF : MN1430HH-19-L	<b>A</b>



USE OF DIVING EQUIPMENT IS PROHIBITED

DOES NOT MEET DEPTH AND SHAPE MINIMUM STANDARD ANSI/NSPI5-2003

ALL DIMENSIONS ARE FINISHED

## STEEL CHECK

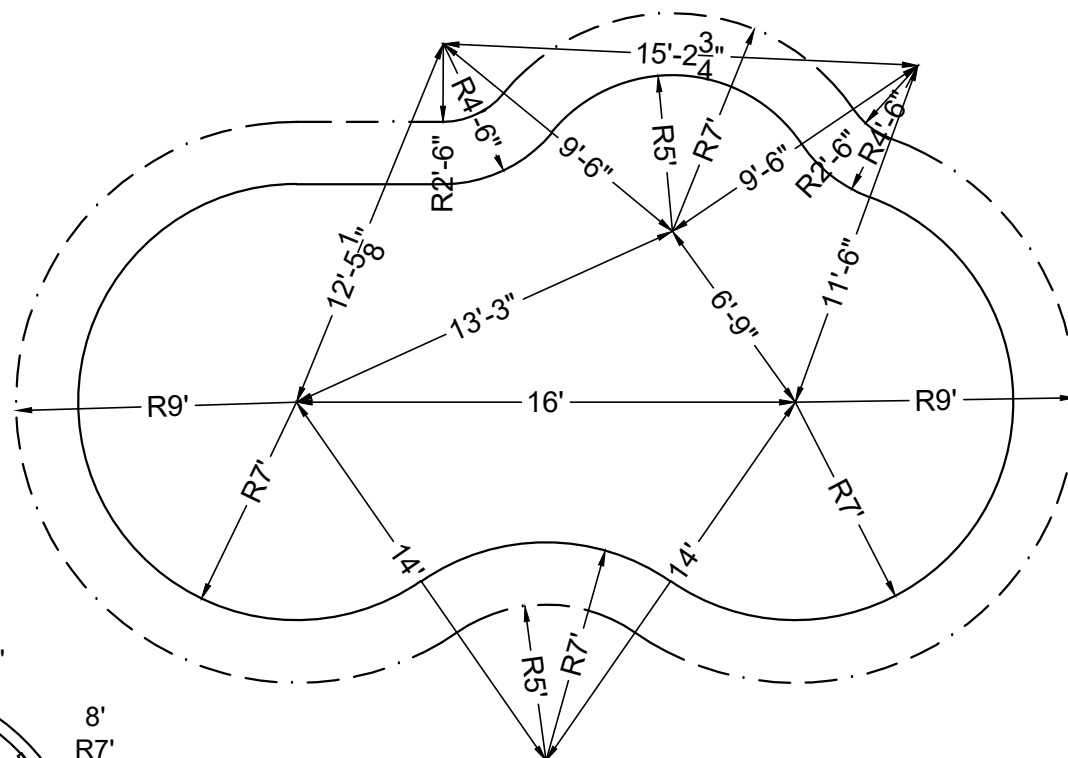
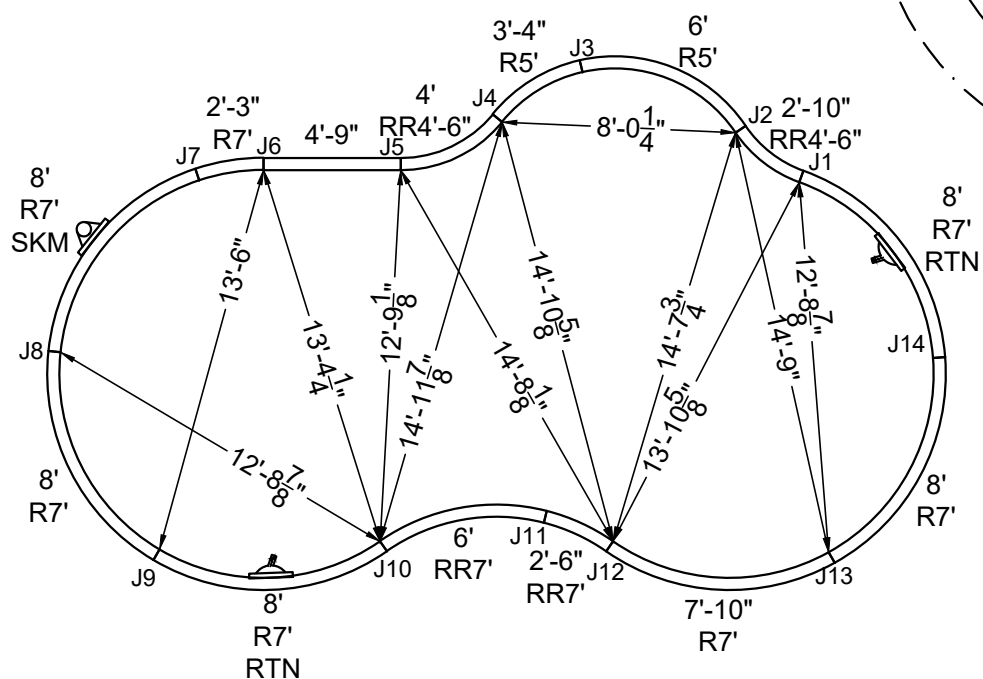

## STAKE OUT

SHAPE : HUMPBACK HAVEN	SIZE : 14' X 30'	HAND : LEFT	PANEL HEIGHT : 3'-6"	DRAWN BY : NM-BCC
DWG # : MN1430HH-19	DATE : 12/23/2016	REVISION # : 01	KIT REF : MN1430HH-19-L	<b>B</b>

ALL DIMENSIONS ARE FINISHED



**NON-DIVING POOL**  
USE OF DIVING EQUIPMENT IS PROHIBITED

DOES NOT MEET DEPTH AND SHAPE MINIMUM STANDARD ANSI/NSPI5-2003

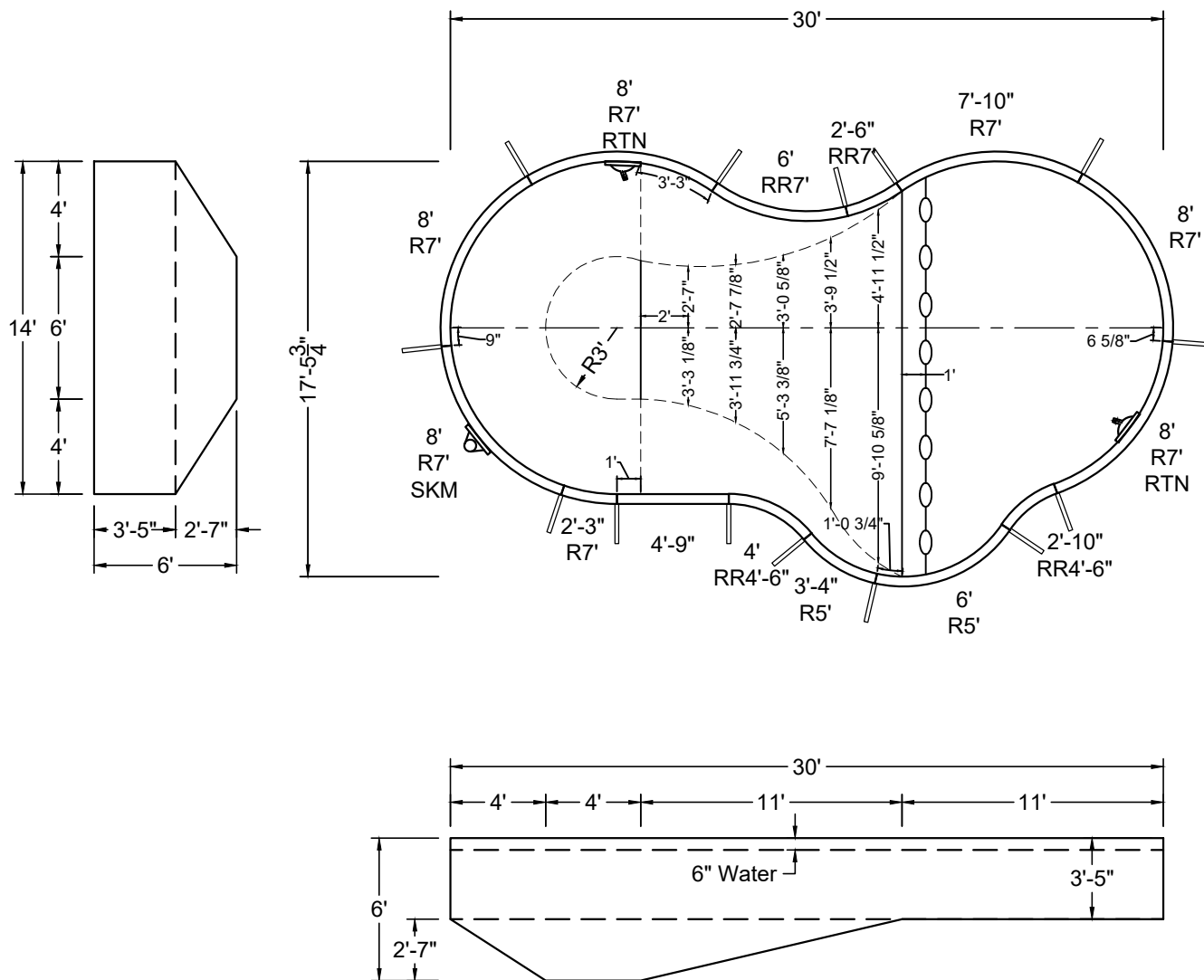

SHAPE : HUMPBACK HAVEN	SIZE : 14' X 30'	HAND : RIGHT	PANEL HEIGHT : 3'-6"	PANEL TYPE : 5" TOP
PERIMETER : 79'-4 11/16"	VOLUME : 12,082 US GAL.	SURFACE AREA : 383.501 SQ. FT.	SCALE : N.T.S	DRAWN BY : NM-BCC
DWG # : MN1430HH-19	DATE : 12/23/2016	REVISION # : 01	KIT REF : MN1430HH-19-R	<b>A</b>



**NON-DIVING POOL**  
USE OF DIVING EQUIPMENT IS PROHIBITED

DOES NOT MEET DEPTH AND SHAPE MINIMUM STANDARD ANSI/NSPI5-2003

ALL DIMENSIONS ARE FINISHED



## STAKE OUT

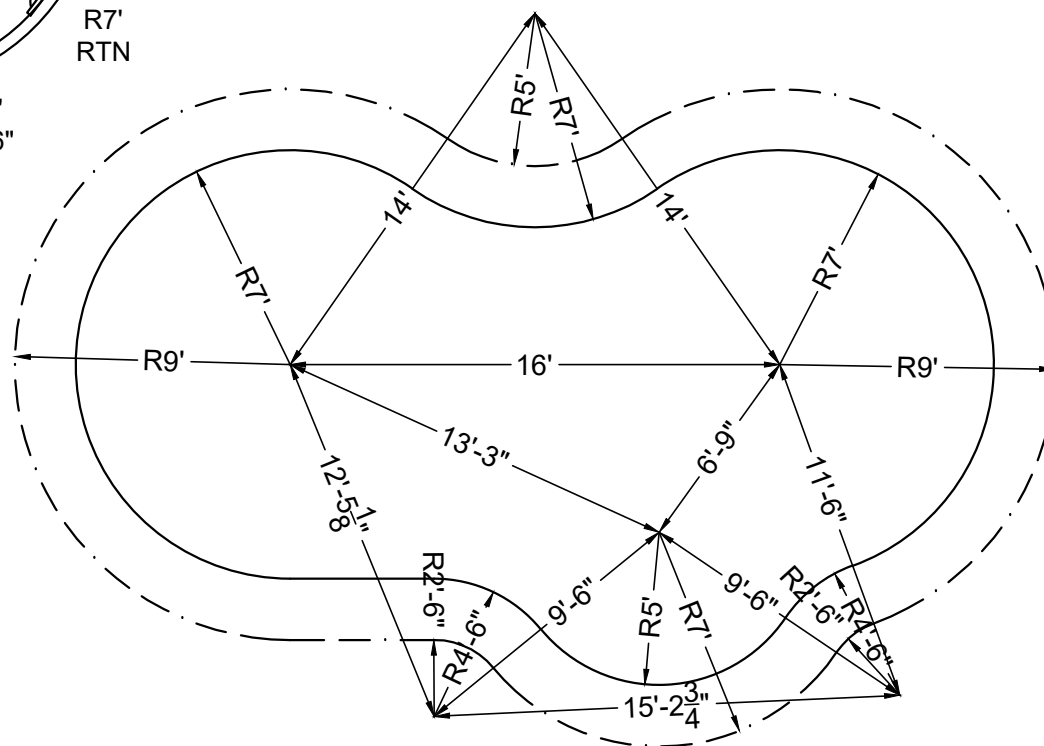

SHAPE : HUMPBACK HAVEN	SIZE : 14' X 30'	HAND : RIGHT	PANEL HEIGHT : 3'-6"	DRAWN BY : NM-BCC
DWG # : MN1430HH-19	DATE : 12/23/2016	REVISION # : 01	KIT REF : MN1430HH-19-R	<b>B</b>

B

ALL DIMENSIONS ARE FINISHED



**NON-DIVING POOL**  
USE OF DIVING EQUIPMENT IS PROHIBITED

DOES NOT MEET DEPTH AND SHAPE MINIMUM STANDARD ANSI/NSPI5-2003

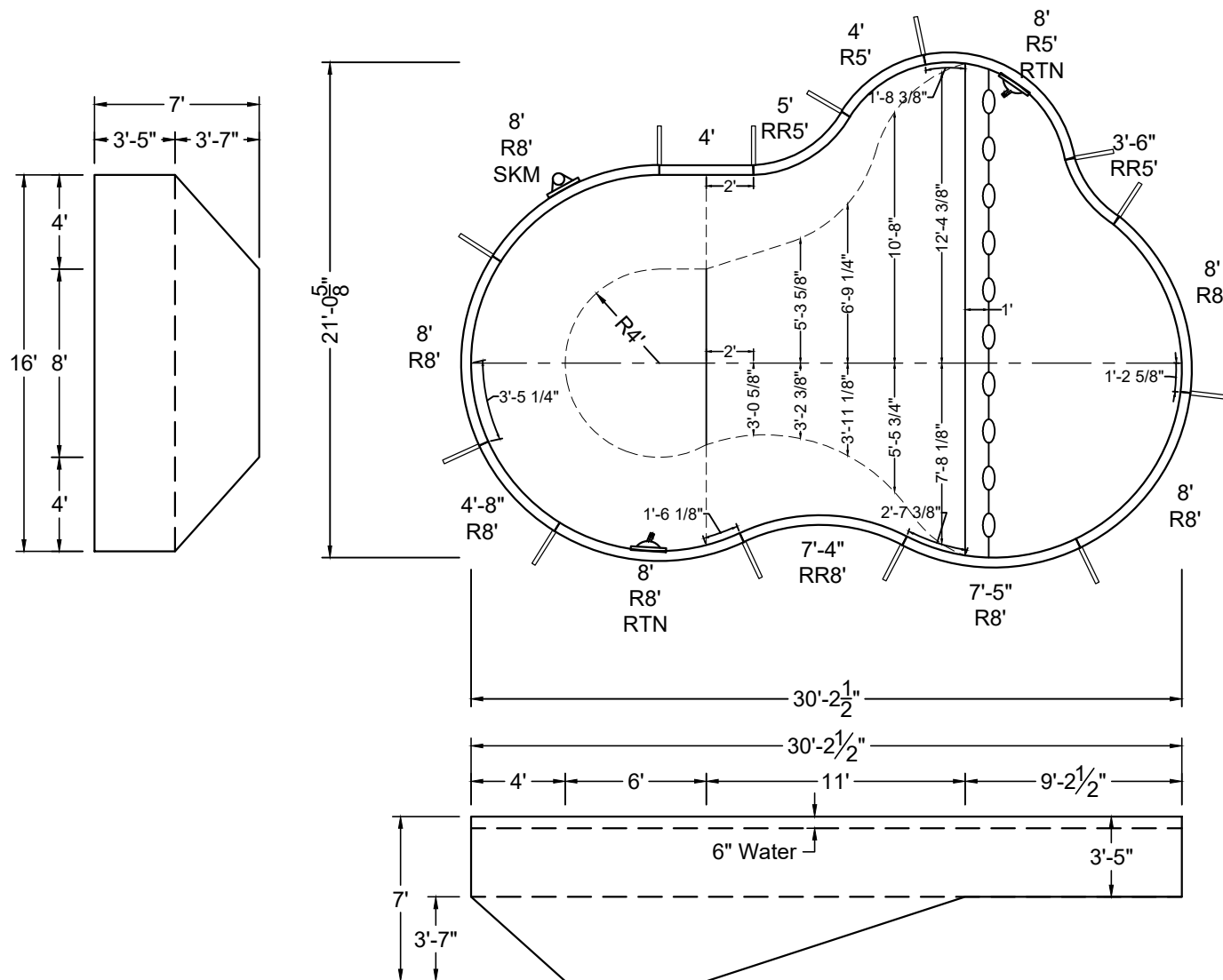

SHAPE : HUMPBACK HAVEN	SIZE : 16' X 30'-3"	HAND : LEFT	PANEL HEIGHT : 3'-6"	PANEL TYPE : 5" TOP
PERIMETER : 83'-11 23/32"	VOLUME : 16,134 US GAL.	SURFACE AREA : 459.589 SQ. FT.	SCALE : N.T.S	DRAWN BY : NM-BCC
DWG # : MN1630HH-19	DATE : 1/9/2017	REVISION # : 01	KIT REF : MN1630HH-19-L	<b>A</b>



USE OF DIVING EQUIPMENT IS PROHIBITED

DOES NOT MEET DEPTH AND SHAPE MINIMUM STANDARD ANSI/NSPI5-2003

ALL DIMENSIONS ARE FINISHED

STEEL CHECK

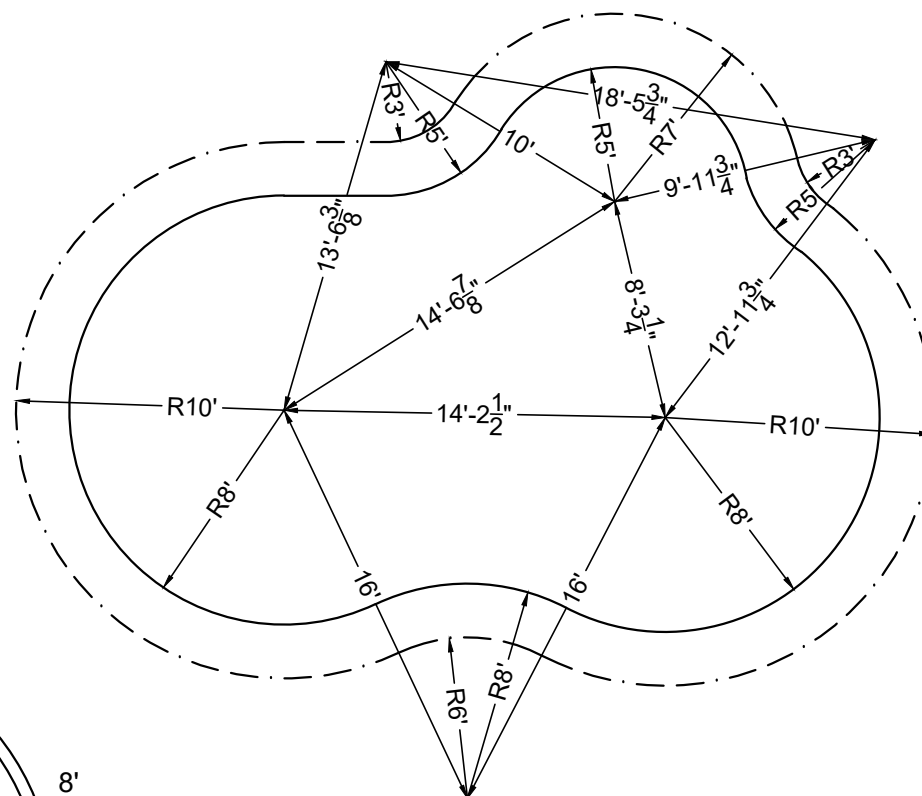
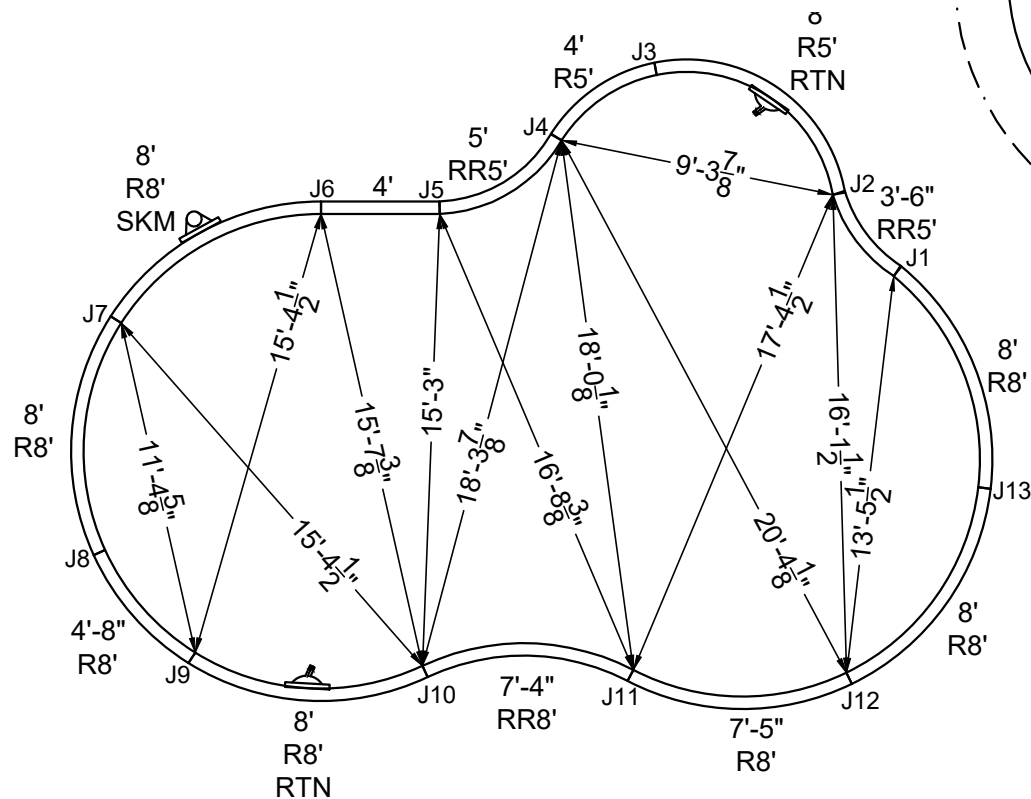

## STAKE OUT

SHAPE : HUMPBACK HAVEN	SIZE : 16' X 30'-3"	HAND : LEFT	PANEL HEIGHT : 3'-6"	DRAWN BY : NM-BCC
DWG # : MN1630HH-19	DATE : 1/9/2017	REVISION # : 01	KIT REF : MN1630HH-19-L	<b>B</b>

ALL DIMENSIONS ARE FINISHED



**NON-DIVING POOL**  
USE OF DIVING EQUIPMENT IS PROHIBITED

DOES NOT MEET DEPTH AND SHAPE MINIMUM STANDARD ANSI/NSPI5-2003

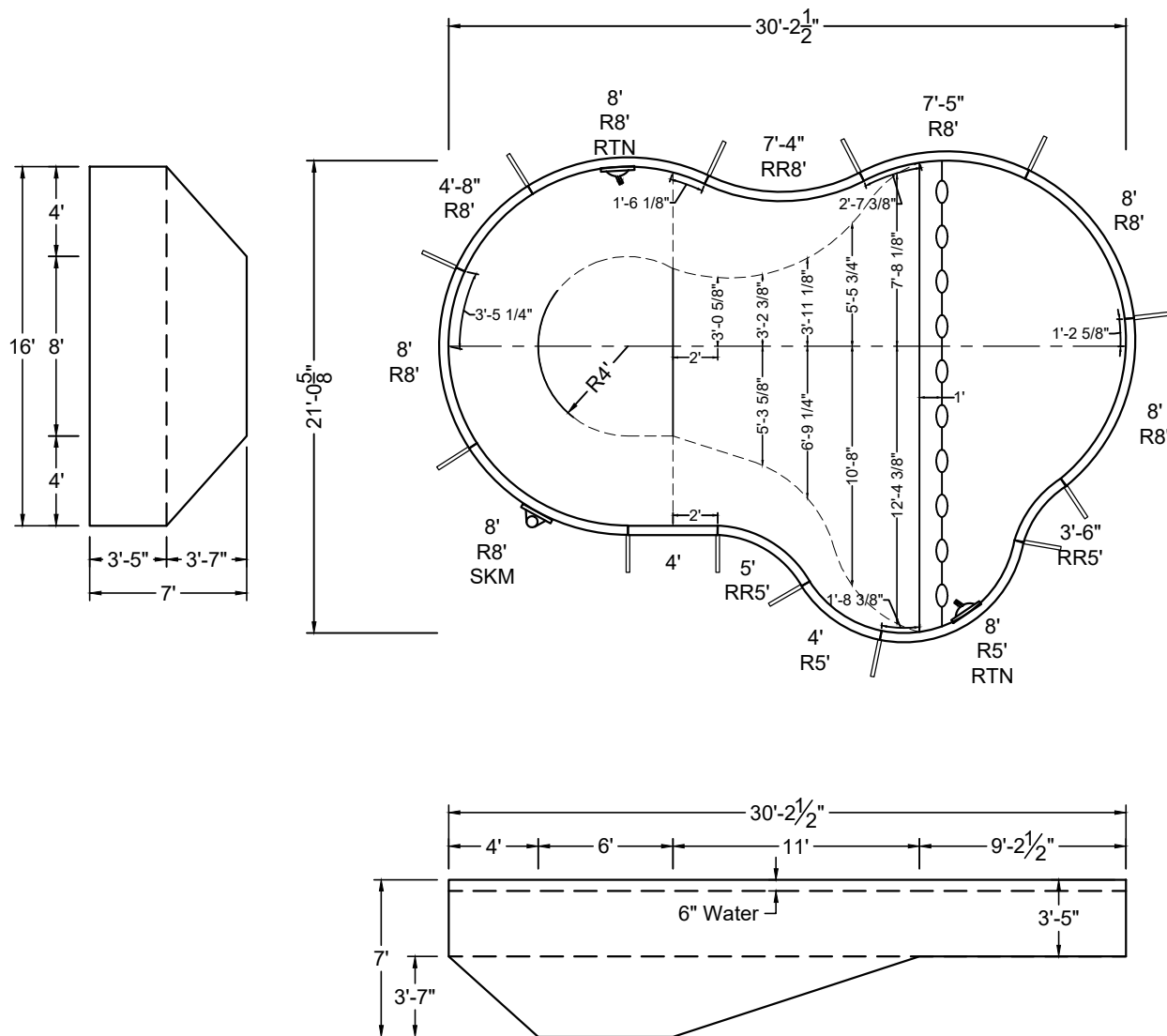

SHAPE : HUMPBACK HAVEN	SIZE : 16' X 30'-3"	HAND : RIGHT	PANEL HEIGHT : 3'-6"	PANEL TYPE : 5" TOP
PERIMETER : 83'-11 23/32"	VOLUME : 16,134 US GAL.	SURFACE AREA : 459.589 SQ. FT.	SCALE : N.T.S	DRAWN BY : NM-BCC
DWG # : MN1630HH-19	DATE : 1/9/2017	REVISION # : 01	KIT REF : MN1630HH-19-R	<b>A</b>



USE OF DIVING EQUIPMENT IS PROHIBITED

DOES NOT MEET DEPTH AND SHAPE MINIMUM STANDARD ANSI/NSPI5-2003

ALL DIMENSIONS ARE FINISHED

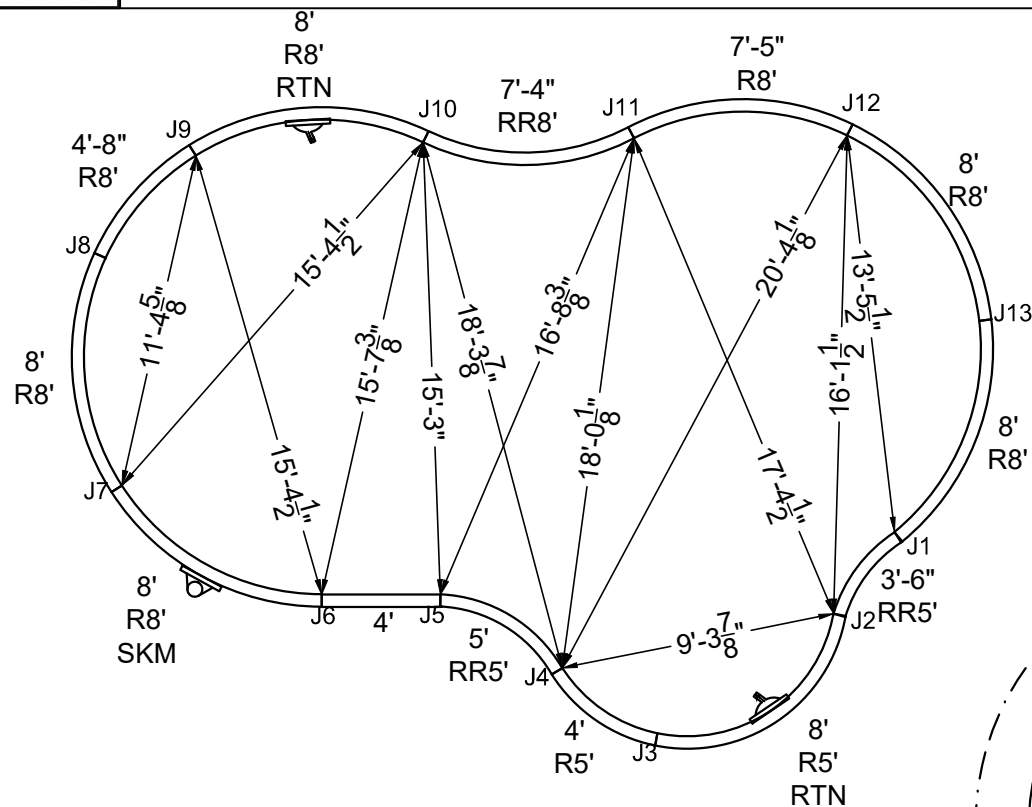

STEEL CHECK

## STAKE OUT

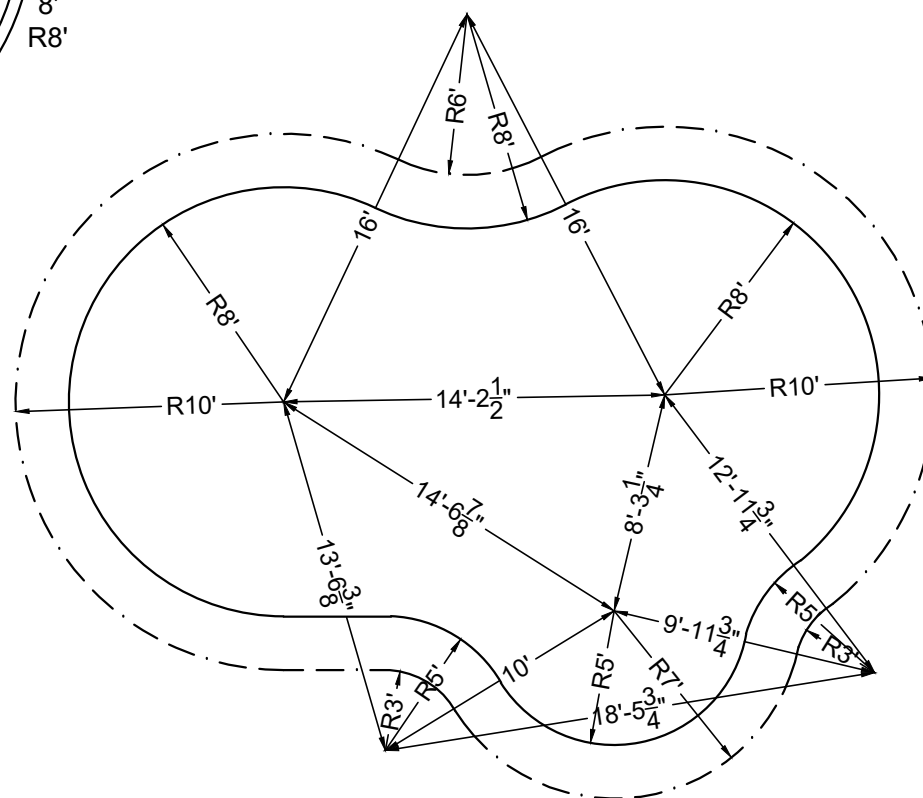

SHAPE : HUMPBACK HAVEN	SIZE : 16' X 30'-3"	HAND : RIGHT	PANEL HEIGHT : 3'-6"	DRAWN BY : NM-BCC
DWG # : MN1630HH-19	DATE : 1/9/2017	REVISION # : 01	KIT REF : MN1630HH-19-R	<b>B</b>



ALL DIMENSIONS ARE FINISHED

DIVING / SLIDE EQUIPMENT DISCLAIMER:

THE BOTTOM CONFIGURATION SHOWN MEETS WITH THE CURRENT ISPS MINIMUM STANDARDS FOR POOLS APPROVED FOR THE USE WITH MANUFACTURED DIVING EQUIPMENT. ALL DIVING EQUIPMENT MUST BE INSTALLED AND LOCATED IN ACCORDANCE WITH THE DIVING / SLIDE MANUFACTURER'S RECOMMENDATIONS. IF DIVING EQUIPMENT IS INSTALLED: PLEASE FOLLOW ALL THE DIVING / SLIDE EQUIPMENT MANUFACTURER'S INSTALLATION, USE AND SAFETY INSTRUCTIONS.

MEETS DEPTH AND SHAPE MINIMUM STANDARD ANSI/NSPI-2003

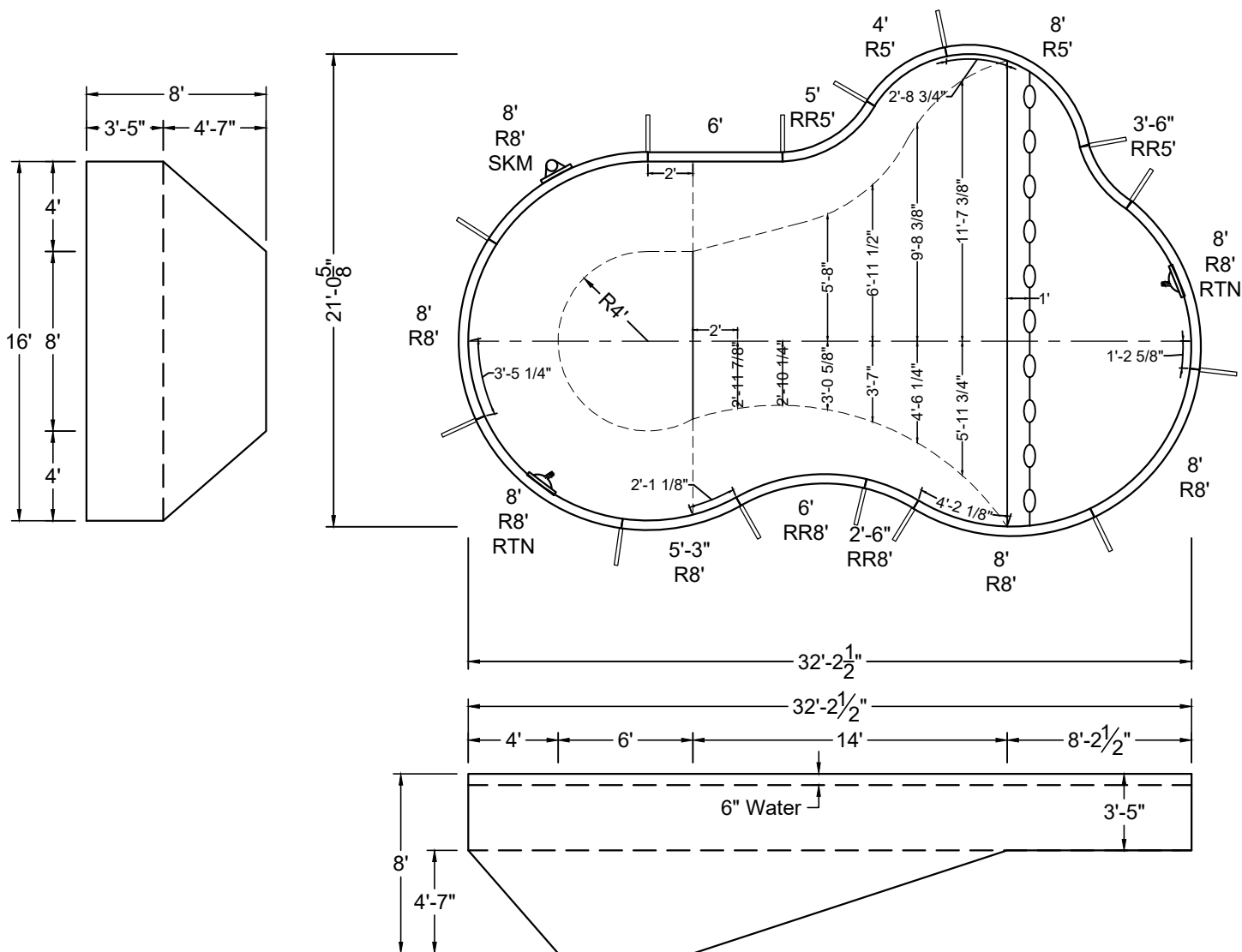

SHAPE : HUMPBAC HAVEN	SIZE : 16' X 32'-3"	HAND : LEFT	PANEL HEIGHT : 3'-6"	PANEL TYPE : 3" TOP
PERIMETER : 88'-3"	VOLUME : 18,718 US GAL.	SURFACE AREA : 485.809 SQ. FT.	SCALE : N.T.S	DRAWN BY : NM-BCC
DWG # : MN1632HH-19	DATE : 1/9/2017	REVISION # : 01	KIT REF : MN1632HH-19-L	<b>A</b>



ALL DIMENSIONS ARE FINISHED

**DIVING / SLIDE EQUIPMENT DISCLAIMER:**

THE BOTTOM CONFIGURATION SHOWN MEETS WITH THE CURRENT IPSC MINIMUM STANDARDS FOR POOLS APPROVED FOR THE USE WITH MANUFACTURED DIVING EQUIPMENT. ALL DIVING EQUIPMENT MUST BE INSTALLED AND LOCATED IN ACCORDANCE WITH THE DIVING / SLIDE MANUFACTURER'S RECOMMENDATIONS. IF DIVING EQUIPMENT IS INSTALLED: PLEASE FOLLOW ALL THE DIVING / SLIDE EQUIPMENT MANUFACTURER'S INSTALLATION, USE AND SAFETY INSTRUCTIONS.

MEETS DEPTH AND SHAPE MINIMUM STANDARD ANSI/NSPI5-2003

STEEL CHECK

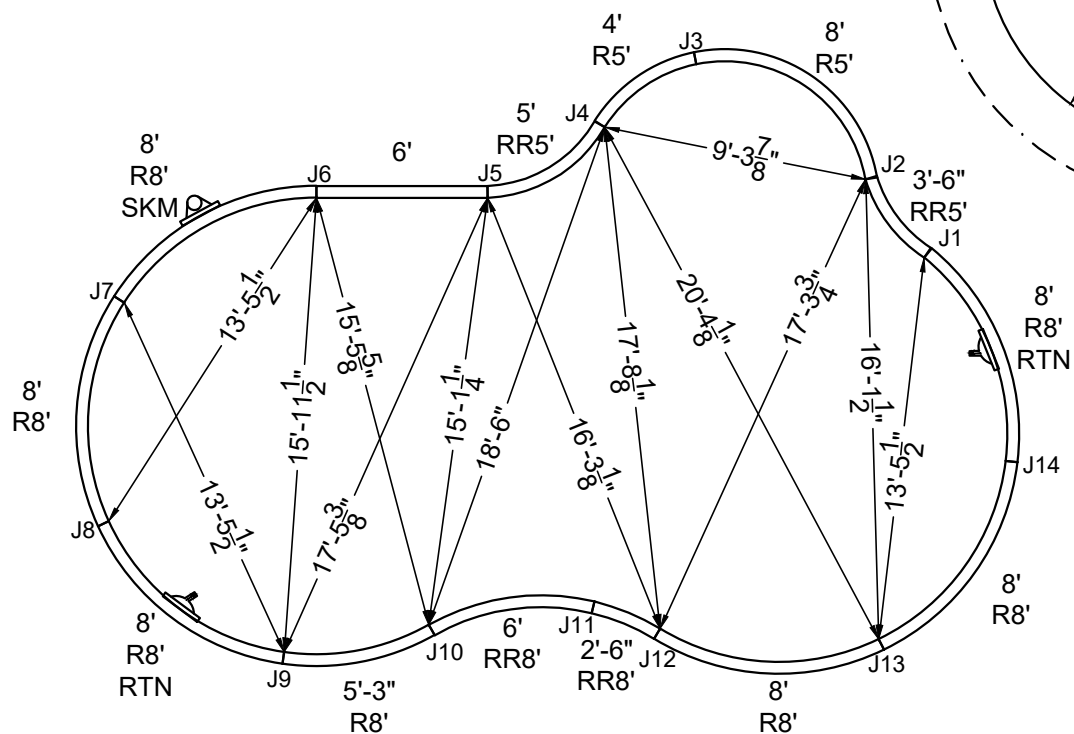

## STAKE OUT

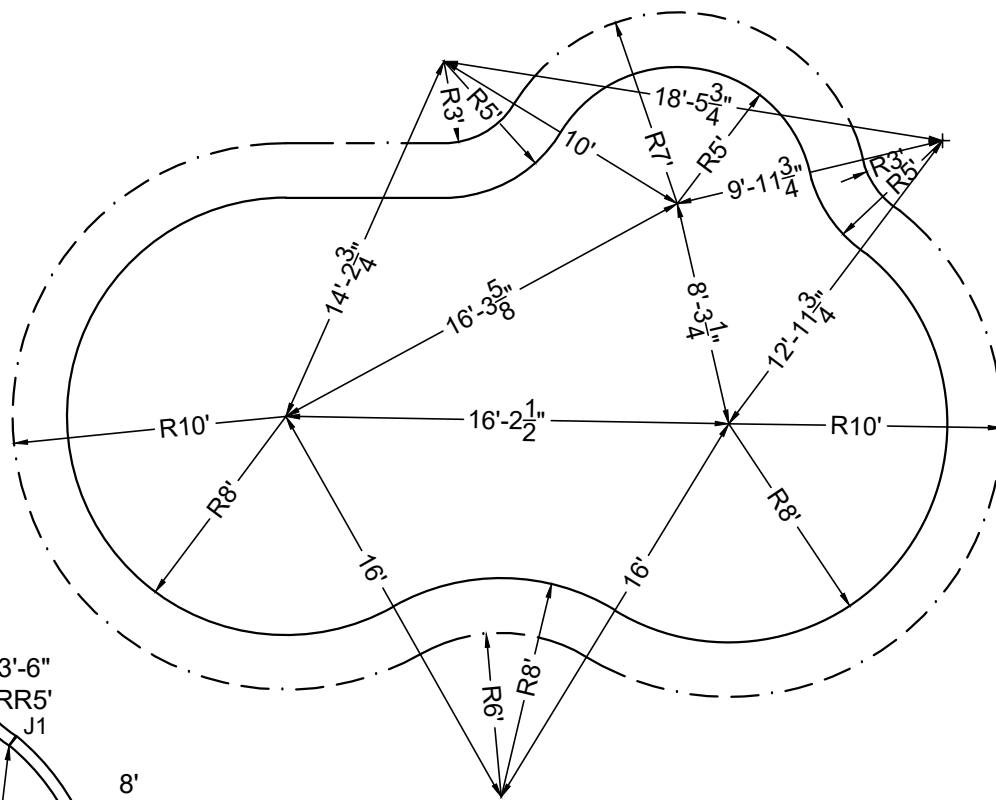

SHAPE: HUMPBACK HAVEN	SIZE: 16' X 32'-3"	HAND: LEFT	PANEL HEIGHT: 3'-6"	DRAWN BY: NM-BCC
DWG #: MN1632HH-19	DATE: 1/9/2017	REVISION #: 01	KIT REF: MN1632HH-19-L	<b>B</b>

ALL DIMENSIONS ARE FINISHED

**DIVING / SLIDE EQUIPMENT DISCLAIMER:**

THE BOTTOM CONFIGURATION SHOWN MEETS WITH THE CURRENT ISPSC MINIMUM STANDARDS FOR POOLS APPROVED FOR THE USE WITH MANUFACTURED DIVING EQUIPMENT. ALL DIVING EQUIPMENT MUST BE INSTALLED AND LOCATED IN ACCORDANCE WITH THE DIVING / SLIDE MANUFACTURER'S RECOMMENDATIONS. IF DIVING EQUIPMENT IS INSTALLED: PLEASE FOLLOW ALL THE DIVING / SLIDE EQUIPMENT MANUFACTURER'S INSTALLATION, USE AND SAFETY INSTRUCTIONS.

MEETS DEPTH AND SHAPE MINIMUM STANDARD ANSI/NSPI-2003

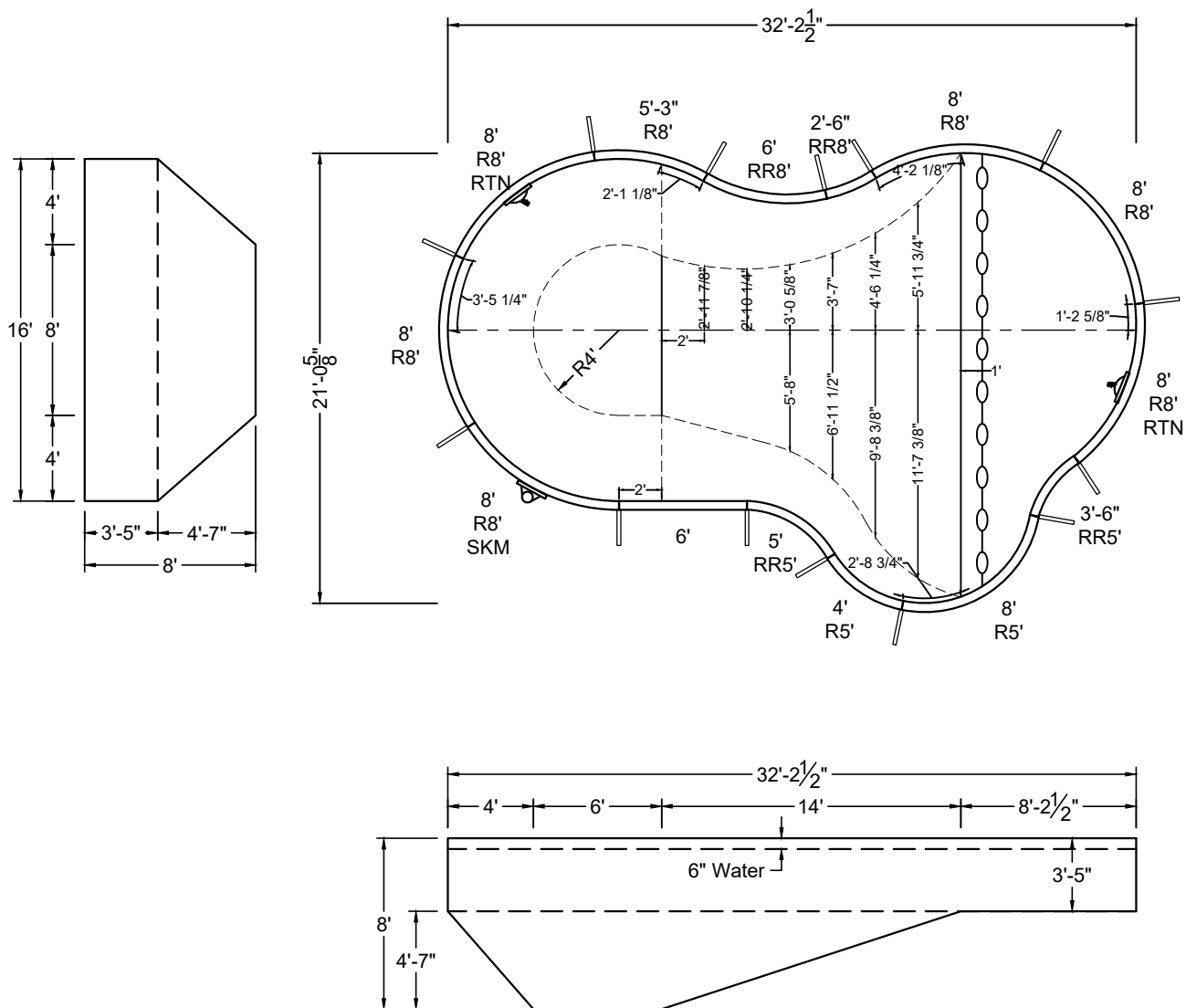

SHAPE : <b>HUMPBAC HAVEN</b>	SIZE : <b>16' X 32'-3"</b>	HAND : <b>RIGHT</b>	PANEL HEIGHT : <b>3'-6"</b>	PANEL TYPE : <b>3" TOP</b>
PERIMETER : <b>88'-3"</b>	VOLUME : <b>18,718 US GAL.</b>	SURFACE AREA : <b>485.809 SQ. FT.</b>	SCALE : <b>N.T.S</b>	DRAWN BY : <b>NM-BCC</b>
DWG # : <b>MN1632HH-19</b>	DATE : <b>1/9/2017</b>	REVISION # : <b>01</b>	KIT REF : <b>MN1632HH-19-R</b>	<b>A</b>



**DIVING / SLIDE EQUIPMENT DISCLAIMER:**

THE BOTTOM CONFIGURATION SHOWN MEETS WITH THE CURRENT IPSC MINIMUM STANDARDS FOR POOLS APPROVED FOR THE USE WITH MANUFACTURED DIVING EQUIPMENT. ALL DIVING EQUIPMENT MUST BE INSTALLED AND LOCATED IN ACCORDANCE WITH THE DIVING / SLIDE MANUFACTURER'S RECOMMENDATIONS. IF DIVING EQUIPMENT IS INSTALLED: PLEASE FOLLOW ALL THE DIVING / SLIDE EQUIPMENT MANUFACTURER'S INSTALLATION, USE AND SAFETY INSTRUCTIONS.

MEETS DEPTH AND SHAPE MINIMUM STANDARD ANSI/NSPI5-2003



## STEEL CHECK

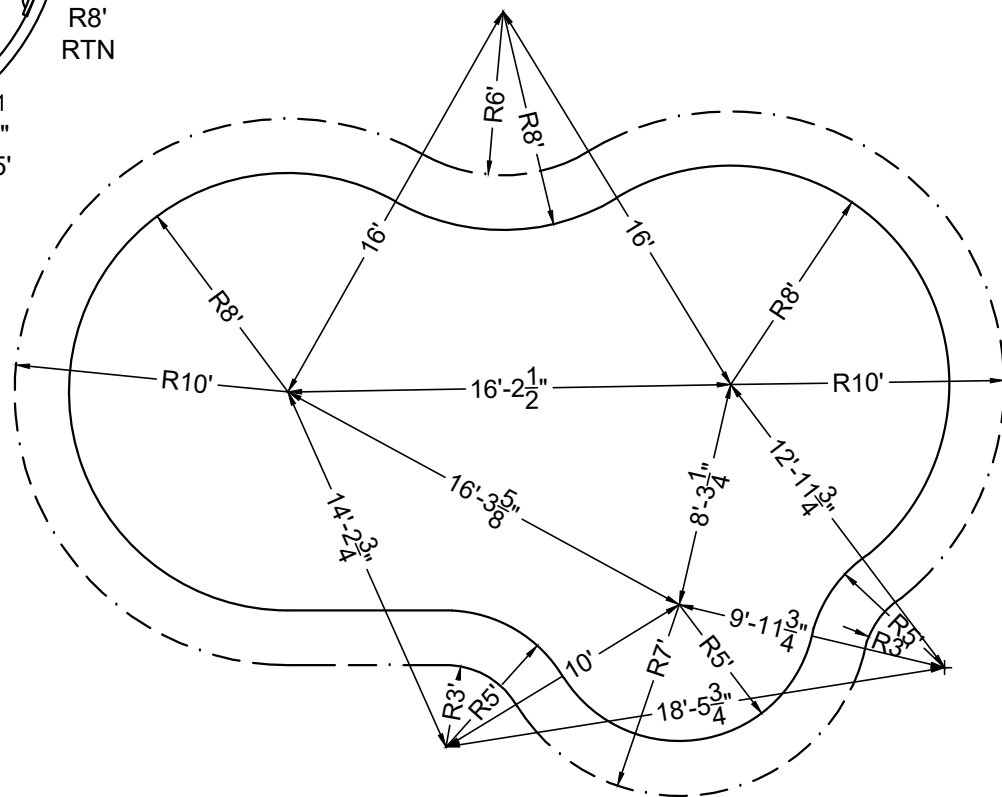

SHAPE : HUMPBACK HAVEN	SIZE : 16' X 32'-3"	HAND : RIGHT	PANEL HEIGHT : 3'-6"	DRAWN BY : NM-BCC
DWG # : MN1632HH-19	DATE : 1/9/2017	REVISION # : 01	KIT REF : MN1632HH-19-R	<b>B</b>

ALL DIMENSIONS ARE FINISHED

DIVING / SLIDE EQUIPMENT DISCLAIMER:

THE BOTTOM CONFIGURATION SHOWN MEETS WITH THE CURRENT ISPSC MINIMUM STANDARDS FOR POOLS APPROVED FOR THE USE WITH MANUFACTURED DIVING EQUIPMENT. ALL DIVING EQUIPMENT MUST BE INSTALLED AND LOCATED IN ACCORDANCE WITH THE DIVING / SLIDE MANUFACTURER'S RECOMMENDATIONS. IF DIVING EQUIPMENT IS INSTALLED: PLEASE FOLLOW ALL THE DIVING / SLIDE EQUIPMENT MANUFACTURER'S INSTALLATION, USE AND SAFETY INSTRUCTIONS.

MEETS DEPTH AND SHAPE MINIMUM STANDARD ANSI/NSPI5-2003

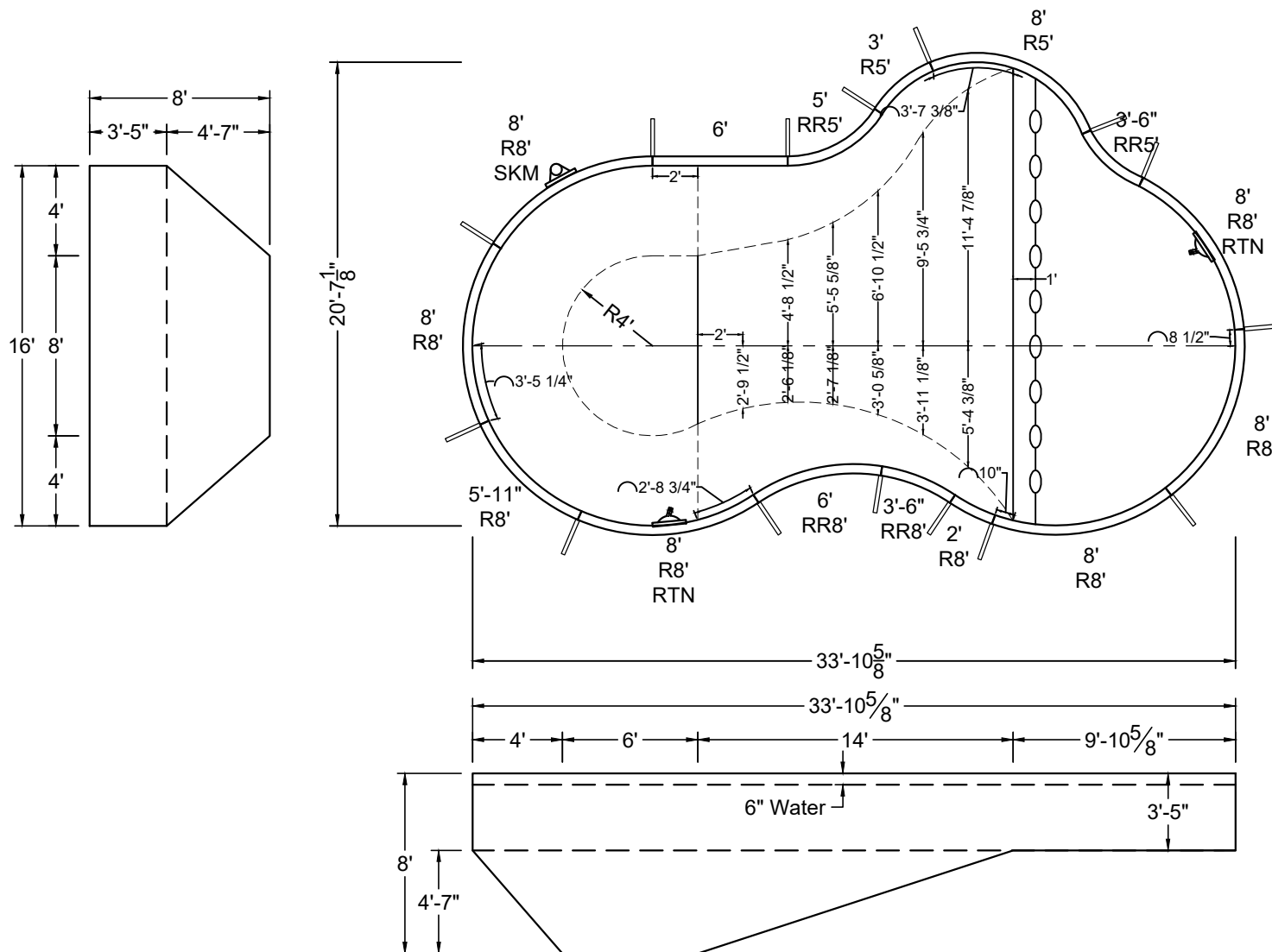

SHAPE : HUMPBACK HAVEN	SIZE : 16' X 33'-11"	HAND : LEFT	PANEL HEIGHT : 3'-6"	PANEL TYPE : 3" TOP
PERIMETER : 90'-10 5/8"	VOLUME : 19,002 US GAL.	SURFACE AREA : 500.439 SQ. FT.	SCALE : N.T.S	DRAWN BY : NM-BCC
DWG # : MN1634HH-19	DATE : 1/9/2017	REVISION # : 01	KIT REF : MN1634HH-19-L	<b>A</b>



ALL DIMENSIONS ARE FINISHED

**DIVING / SLIDE EQUIPMENT DISCLAIMER:**

THE BOTTOM CONFIGURATION SHOWN MEETS WITH THE CURRENT IPSC MINIMUM STANDARDS FOR POOLS APPROVED FOR THE USE WITH MANUFACTURED DIVING EQUIPMENT. ALL DIVING EQUIPMENT MUST BE INSTALLED AND LOCATED IN ACCORDANCE WITH THE DIVING / SLIDE MANUFACTURER'S RECOMMENDATIONS. IF DIVING EQUIPMENT IS INSTALLED: PLEASE FOLLOW ALL THE DIVING / SLIDE EQUIPMENT MANUFACTURER'S INSTALLATION, USE AND SAFETY INSTRUCTIONS.

MEETS DEPTH AND SHAPE MINIMUM STANDARD ANSI/NSPI5-2003

## STEEL CHECK

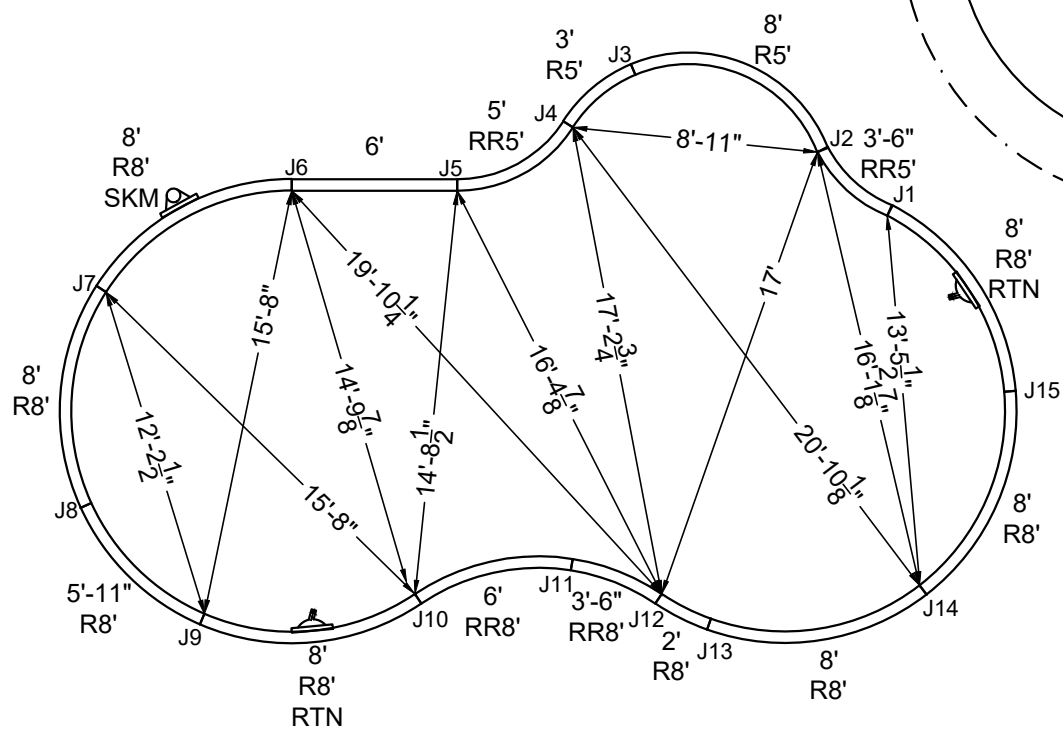

## STAKE OUT

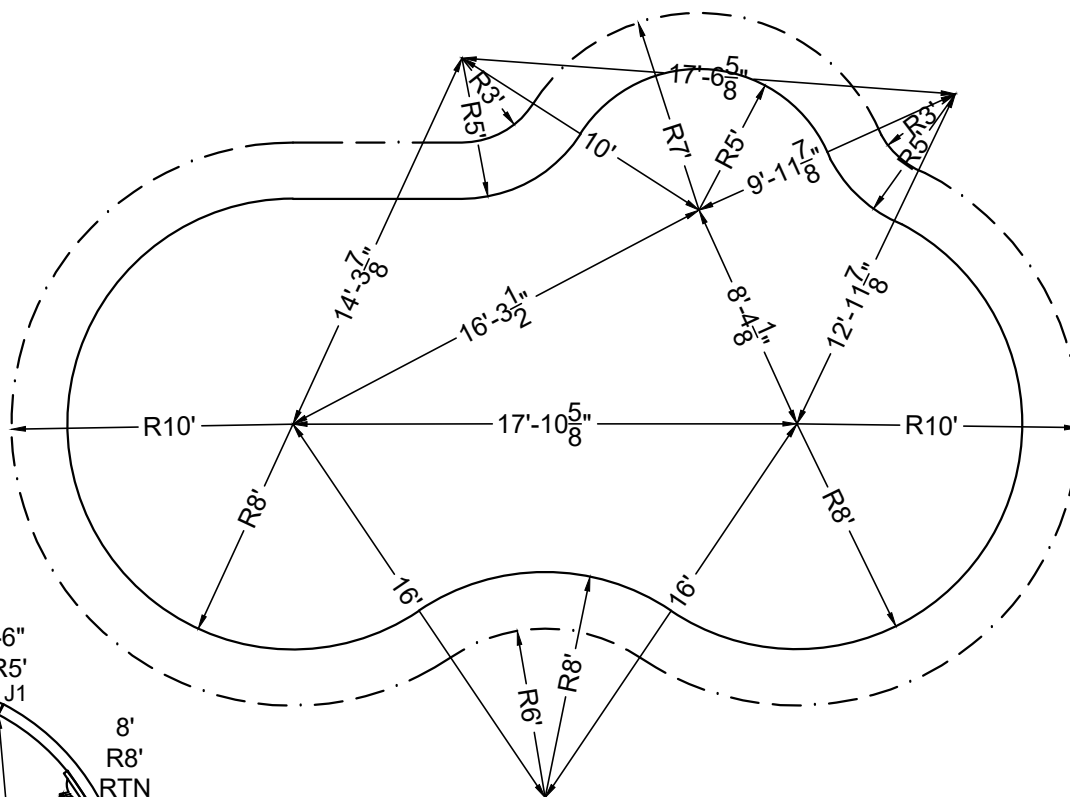

SHAPE : HUMPBACK HAVEN	SIZE : 16' X 33'-11"	HAND : LEFT	PANEL HEIGHT : 3'-6"	DRAWN BY : NM-BCC
DWG # : MN1634HH-19	DATE : 1/9/2017	REVISION # : 01	KIT REF : MN1634HH-19-L	<b>B</b>



### DIVING / SLIDE EQUIPMENT DISCLAIMER:

THE BOTTOM CONFIGURATION SHOWN MEETS WITH THE CURRENT IPSC MINIMUM STANDARDS FOR POOLS APPROVED FOR THE USE WITH MANUFACTURED DIVING EQUIPMENT. ALL DIVING EQUIPMENT MUST BE INSTALLED AND LOCATED IN ACCORDANCE WITH THE DIVING / SLIDE MANUFACTURER'S RECOMMENDATIONS. IF DIVING EQUIPMENT IS INSTALLED: PLEASE FOLLOW ALL THE DIVING / SLIDE EQUIPMENT MANUFACTURER'S INSTALLATION, USE AND SAFETY INSTRUCTIONS.

MEETS DEPTH AND SHAPE MINIMUM STANDARD ANSI/NSPI5-2003

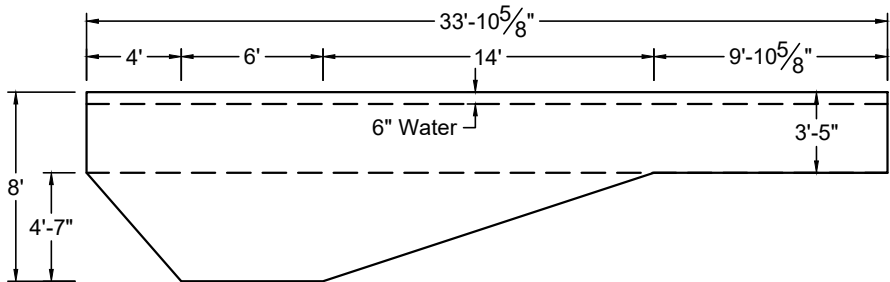

SHAPE : <b>HUMPBACK HAVEN</b>	SIZE : <b>16' X 33'-11"</b>	HAND : <b>RIGHT</b>	PANEL HEIGHT : <b>3'-6"</b>	PANEL TYPE : <b>3" TOP</b>
PERIMETER : <b>90'-10 5/8"</b>	VOLUME : <b>19,002 US GAL.</b>	SURFACE AREA : <b>500.439 SQ. FT.</b>	SCALE : <b>N.T.S</b>	DRAWN BY : <b>NM-BCC</b>
DWG # : <b>MN1634HH-19</b>	DATE : <b>1/9/2017</b>	REVISION # : <b>01</b>	KIT REF : <b>MN1634HH-19-R</b>	<b>A</b>

**A**



**DIVING / SLIDE EQUIPMENT DISCLAIMER:**

THE BOTTOM CONFIGURATION SHOWN MEETS WITH THE CURRENT IPSC MINIMUM STANDARDS FOR POOLS APPROVED FOR THE USE WITH MANUFACTURED DIVING EQUIPMENT. ALL DIVING EQUIPMENT MUST BE INSTALLED AND LOCATED IN ACCORDANCE WITH THE DIVING / SLIDE MANUFACTURER'S RECOMMENDATIONS. IF DIVING EQUIPMENT IS INSTALLED: PLEASE FOLLOW ALL THE DIVING / SLIDE EQUIPMENT MANUFACTURER'S INSTALLATION, USE AND SAFETY INSTRUCTIONS.

MEETS DEPTH AND SHAPE MINIMUM STANDARD ANSI/NSPI5-2003



## STAKE OUT

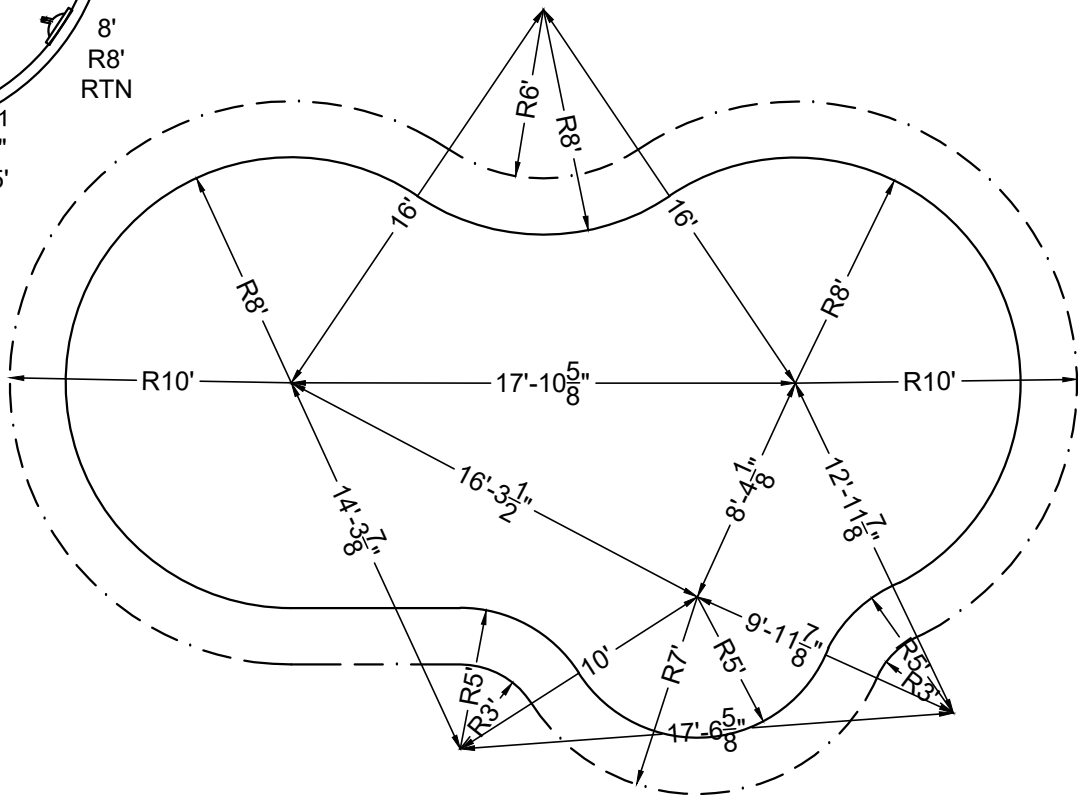

SHAPE: HUMPBACK HAVEN	SIZE: 16' X 33'-11"	HAND: RIGHT	PANEL HEIGHT: 3'-6"	DRAWN BY: NM-BCC
DWG #: MN1634HH-19	DATE: 1/9/2017	REVISION #: 01	KIT REF: MN1634HH-19-R	<b>B</b>



ALL DIMENSIONS ARE FINISHED

DIVING / SLIDE EQUIPMENT DISCLAIMER:

THE BOTTOM CONFIGURATION SHOWN MEETS WITH THE CURRENT ISPSA MINIMUM STANDARDS FOR POOLS APPROVED FOR THE USE WITH MANUFACTURED DIVING EQUIPMENT. ALL DIVING EQUIPMENT MUST BE INSTALLED AND LOCATED IN ACCORDANCE WITH THE DIVING / SLIDE MANUFACTURER'S RECOMMENDATIONS. IF DIVING EQUIPMENT IS INSTALLED: PLEASE FOLLOW ALL THE DIVING / SLIDE EQUIPMENT MANUFACTURER'S INSTALLATION, USE AND SAFETY INSTRUCTIONS.

MEETS DEPTH AND SHAPE MINIMUM STANDARD ANSI/NSPI-2003

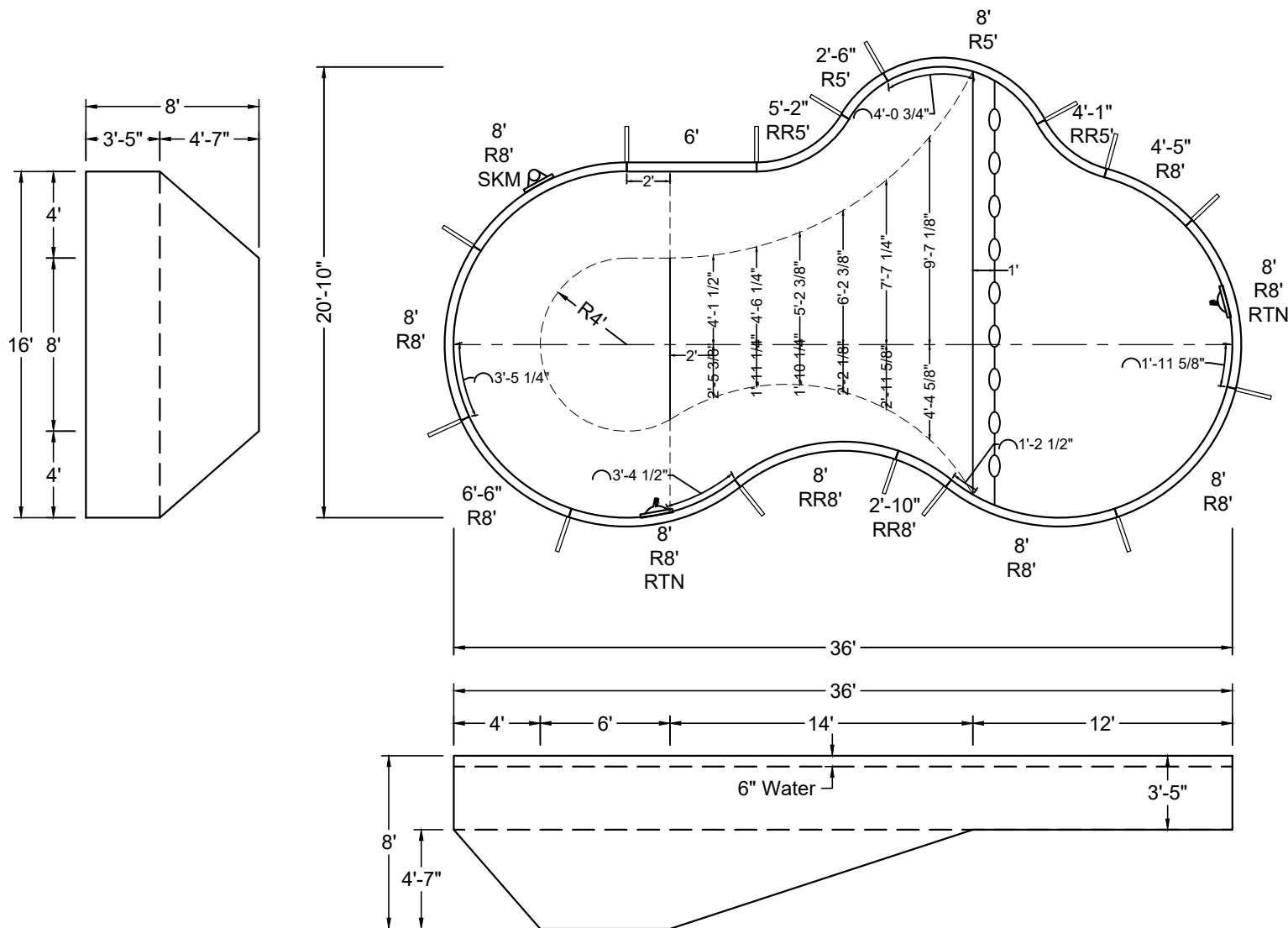

SHAPE : HUMPBACK HAVEN	SIZE : 16' X 36'	HAND : LEFT	PANEL HEIGHT : 3'-6"	PANEL TYPE : 3" TOP
PERIMETER : 95'-6 9/32"	VOLUME : 19,578 US GAL.	SURFACE AREA : 526.685 SQ. FT.	SCALE : N.T.S	DRAWN BY : NM-BCC
DWG # : MN1636HH-19	DATE : 1/9/2017	REVISION # : 01	KIT REF : MN1636HH-19-L	<b>A</b>



ALL DIMENSIONS ARE FINISHED

**DIVING / SLIDE EQUIPMENT DISCLAIMER:**

THE BOTTOM CONFIGURATION SHOWN MEETS WITH THE CURRENT IPSC MINIMUM STANDARDS FOR POOLS APPROVED FOR THE USE WITH MANUFACTURED DIVING EQUIPMENT. ALL DIVING EQUIPMENT MUST BE INSTALLED AND LOCATED IN ACCORDANCE WITH THE DIVING / SLIDE MANUFACTURER'S RECOMMENDATIONS. IF DIVING EQUIPMENT IS INSTALLED: PLEASE FOLLOW ALL THE DIVING / SLIDE EQUIPMENT MANUFACTURER'S INSTALLATION, USE AND SAFETY INSTRUCTIONS.

MEETS DEPTH AND SHAPE MINIMUM STANDARD ANSI/NSPI5-2003

STEEL CHECK

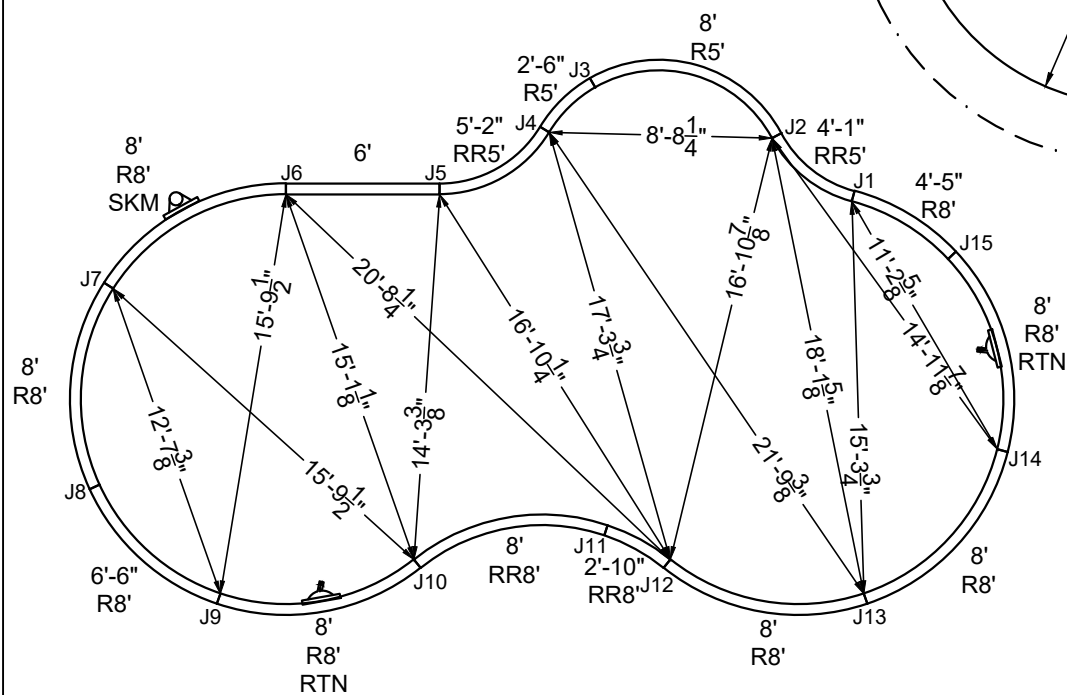

## STAKE OUT

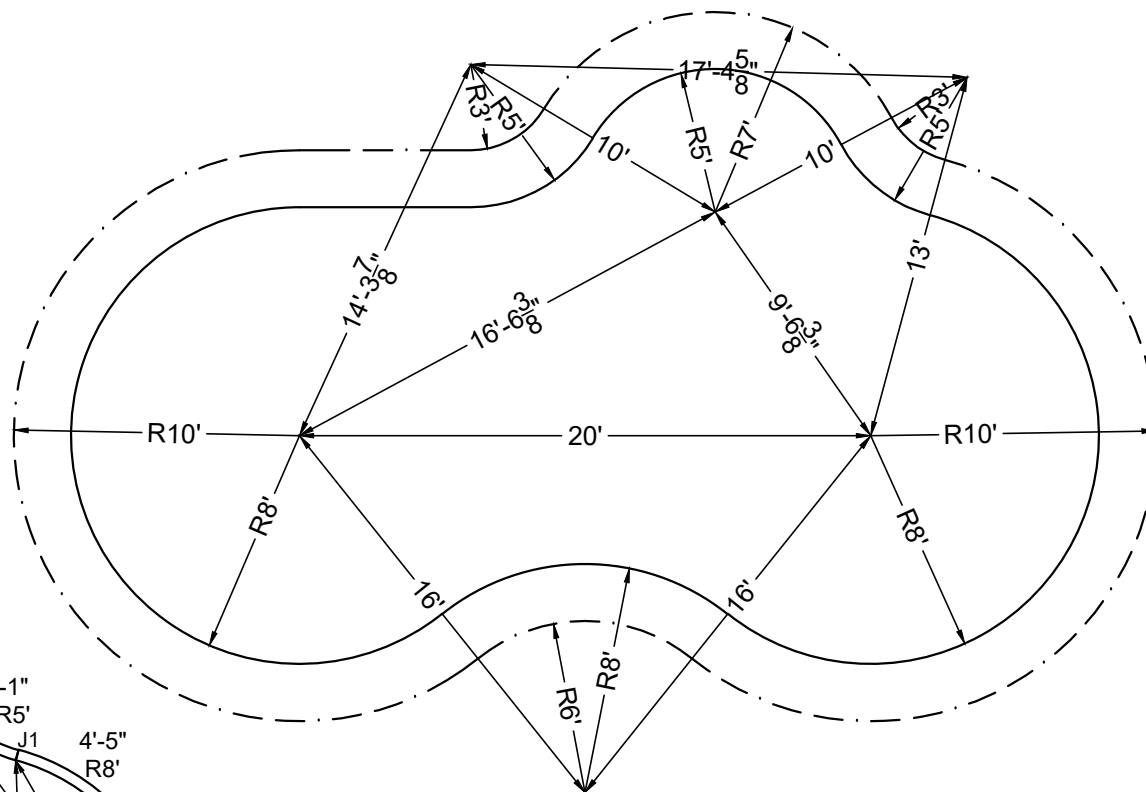

SHAPE : HUMPBACK HAVEN	SIZE : 16' X 36'	HAND : LEFT	PANEL HEIGHT : 3'-6"	DRAWN BY : NM-BCC
DWG # : MN1636HH-19	DATE : 1/9/2017	REVISION # : 01	KIT REF : MN1636HH-19-L	<b>B</b>

# DIVING / SLIDE EQUIPMENT DISCLAIMER:

THE BOTTOM CONFIGURATION SHOWN MEETS WITH THE CURRENT ISPSA MINIMUM STANDARDS FOR POOLS APPROVED FOR THE USE WITH MANUFACTURED DIVING EQUIPMENT. ALL DIVING EQUIPMENT MUST BE INSTALLED AND LOCATED IN ACCORDANCE WITH THE DIVING / SLIDE MANUFACTURER'S RECOMMENDATIONS. IF DIVING EQUIPMENT IS INSTALLED: PLEASE FOLLOW ALL THE DIVING / SLIDE EQUIPMENT MANUFACTURER'S INSTALLATION, USE AND SAFETY INSTRUCTIONS.

MEETS DEPTH AND SHAPE MINIMUM STANDARD ANSI/NSPI-2003

ALL DIMENSIONS ARE FINISHED

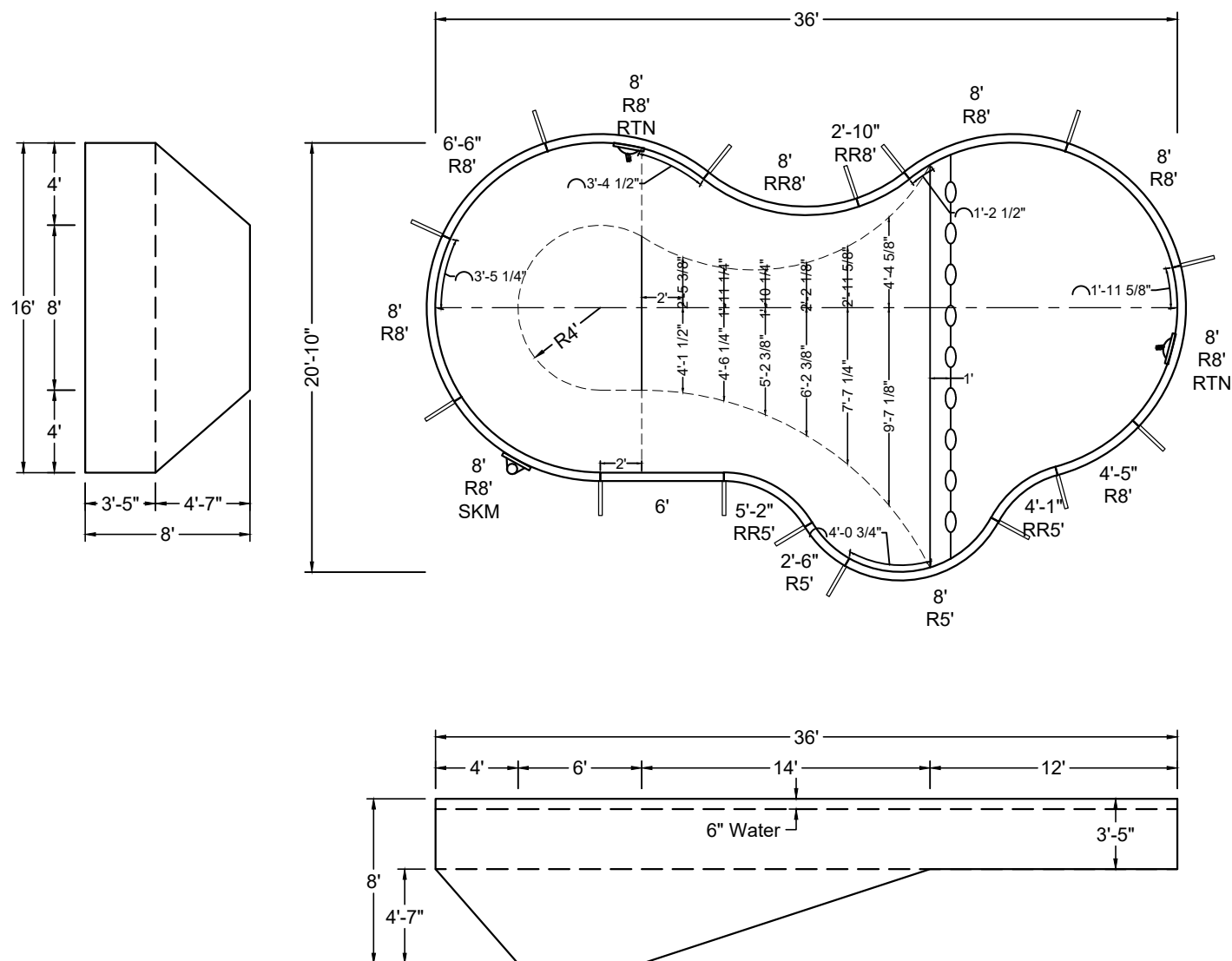

SHAPE : HUMPBACK HAVEN	SIZE : 16' X 36'	HAND : RIGHT	PANEL HEIGHT : 3'-6"	PANEL TYPE : 3" TOP
PERIMETER : 95'-6 9/32"	VOLUME : 19,578 US GAL.	SURFACE AREA : 526.685 SQ. FT.	SCALE : N.T.S	DRAWN BY : NM-BCC
DWG # : MN1636HH-19	DATE : 1/9/2017	REVISION # : 01	KIT REF : MN1636HH-19-R	<b>A</b>



**DIVING / SLIDE EQUIPMENT DISCLAIMER:**

THE BOTTOM CONFIGURATION SHOWN MEETS WITH THE CURRENT IPSC MINIMUM STANDARDS FOR POOLS APPROVED FOR THE USE WITH MANUFACTURED DIVING EQUIPMENT. ALL DIVING EQUIPMENT MUST BE INSTALLED AND LOCATED IN ACCORDANCE WITH THE DIVING / SLIDE MANUFACTURER'S RECOMMENDATIONS. IF DIVING EQUIPMENT IS INSTALLED: PLEASE FOLLOW ALL THE DIVING / SLIDE EQUIPMENT MANUFACTURER'S INSTALLATION, USE AND SAFETY INSTRUCTIONS.

MEETS DEPTH AND SHAPE MINIMUM STANDARD ANSI/NSPI5-2003



SHAPE : HUMPBACK HAVEN	SIZE : 16' X 36'	HAND : RIGHT	PANEL HEIGHT : 3'-6"	DRAWN BY : NM-BCC
DWG # : MN1636HH-19	DATE : 1/9/2017	REVISION # : 01	KIT REF : MN1636HH-19-R	<b>B</b>

ALL DIMENSIONS ARE FINISHED

DIVING / SLIDE EQUIPMENT DISCLAIMER:

THE BOTTOM CONFIGURATION SHOWN MEETS WITH THE CURRENT ISPSC MINIMUM STANDARDS FOR POOLS APPROVED FOR THE USE WITH MANUFACTURED DIVING EQUIPMENT. ALL DIVING EQUIPMENT MUST BE INSTALLED AND LOCATED IN ACCORDANCE WITH THE DIVING / SLIDE MANUFACTURER'S RECOMMENDATIONS. IF DIVING EQUIPMENT IS INSTALLED: PLEASE FOLLOW ALL THE DIVING / SLIDE EQUIPMENT MANUFACTURER'S INSTALLATION, USE AND SAFETY INSTRUCTIONS.

MEETS DEPTH AND SHAPE MINIMUM STANDARD ANSI/NSPI5-2003

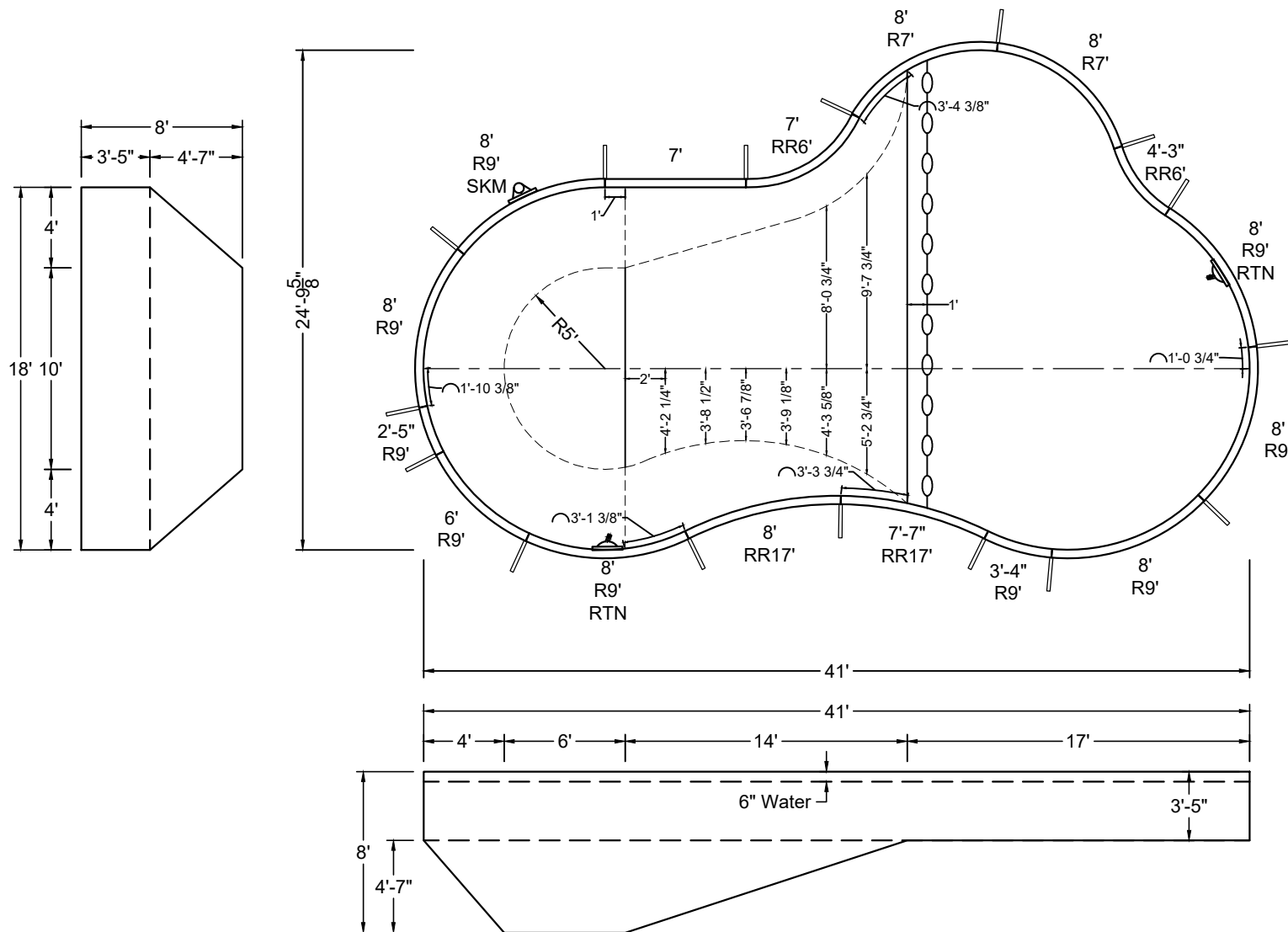

SHAPE : HUMPBAC HAVEN	SIZE : 18' X 41'	HAND : LEFT	PANEL HEIGHT : 3'-6"	PANEL TYPE : 3" TOP
PERIMETER : 109'-6 5/8"	VOLUME : 25,418 US GAL.	SURFACE AREA : 712.812 SQ. FT.	SCALE : N.T.S	DRAWN BY : NM-BCC
DWG # : MN1841HH-19	DATE : 1/9/2017	REVISION # : 01	KIT REF : MN1841HH-19-L	<b>A</b>



ALL DIMENSIONS ARE FINISHED

**DIVING / SLIDE EQUIPMENT DISCLAIMER:**

THE BOTTOM CONFIGURATION SHOWN MEETS WITH THE CURRENT IPSC MINIMUM STANDARDS FOR POOLS APPROVED FOR THE USE WITH MANUFACTURED DIVING EQUIPMENT. ALL DIVING EQUIPMENT MUST BE INSTALLED AND LOCATED IN ACCORDANCE WITH THE DIVING / SLIDE MANUFACTURER'S RECOMMENDATIONS. IF DIVING EQUIPMENT IS INSTALLED: PLEASE FOLLOW ALL THE DIVING / SLIDE EQUIPMENT MANUFACTURER'S INSTALLATION, USE AND SAFETY INSTRUCTIONS.

MEETS DEPTH AND SHAPE MINIMUM STANDARD ANSI/NSPI5-2003

STEEL CHECK

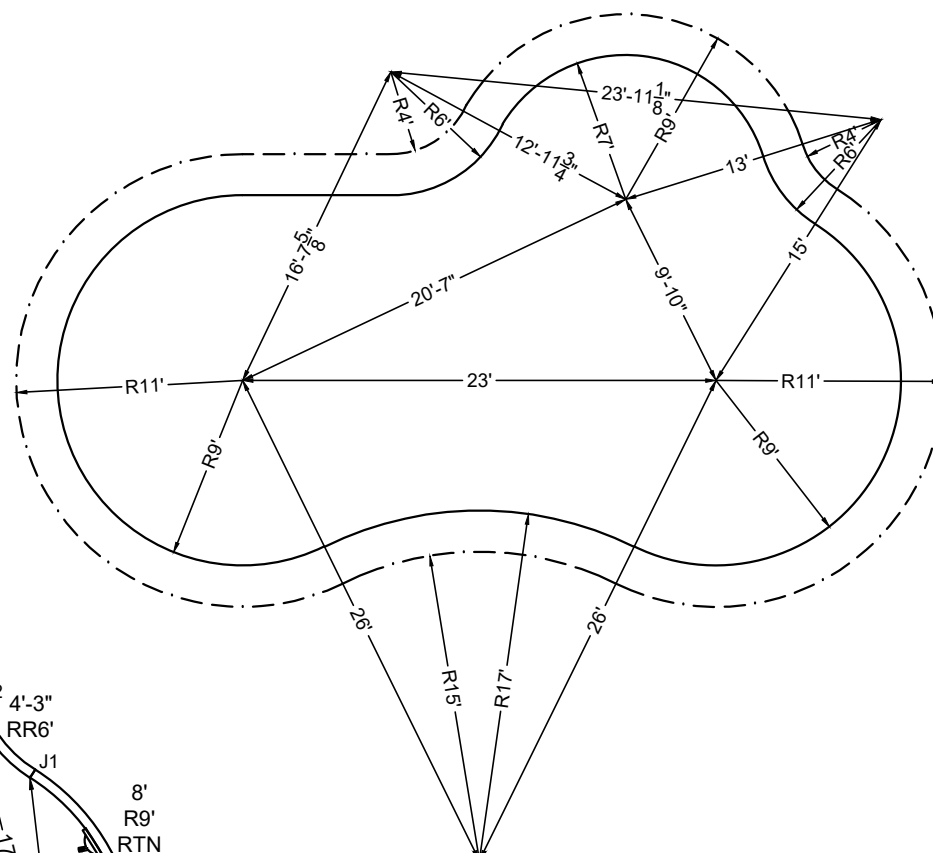
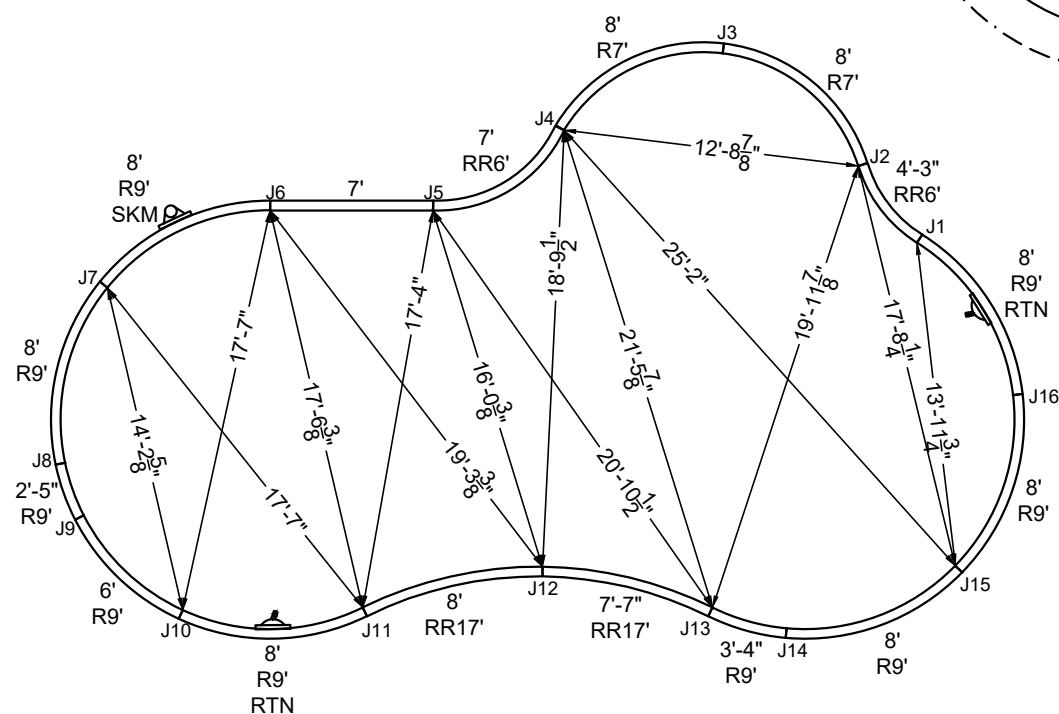

## STAKE OUT

SHAPE : HUMPBACK HAVEN	SIZE : 18' X 41'	HAND : LEFT	PANEL HEIGHT : 3'-6"	DRAWN BY : NM-BCC
DWG # : MN1841HH-19	DATE : 1/9/2017	REVISION # : 01	KIT REF : MN1841HH-19-L	<b>B</b>

ALL DIMENSIONS ARE FINISHED

DIVING / SLIDE EQUIPMENT DISCLAIMER:

THE BOTTOM CONFIGURATION SHOWN MEETS WITH THE CURRENT ISPSC MINIMUM STANDARDS FOR POOLS APPROVED FOR THE USE WITH MANUFACTURED DIVING EQUIPMENT. ALL DIVING EQUIPMENT MUST BE INSTALLED AND LOCATED IN ACCORDANCE WITH THE DIVING / SLIDE MANUFACTURER'S RECOMMENDATIONS. IF DIVING EQUIPMENT IS INSTALLED: PLEASE FOLLOW ALL THE DIVING / SLIDE EQUIPMENT MANUFACTURER'S INSTALLATION, USE AND SAFETY INSTRUCTIONS.

MEETS DEPTH AND SHAPE MINIMUM STANDARD ANSI/NSPI5-2003

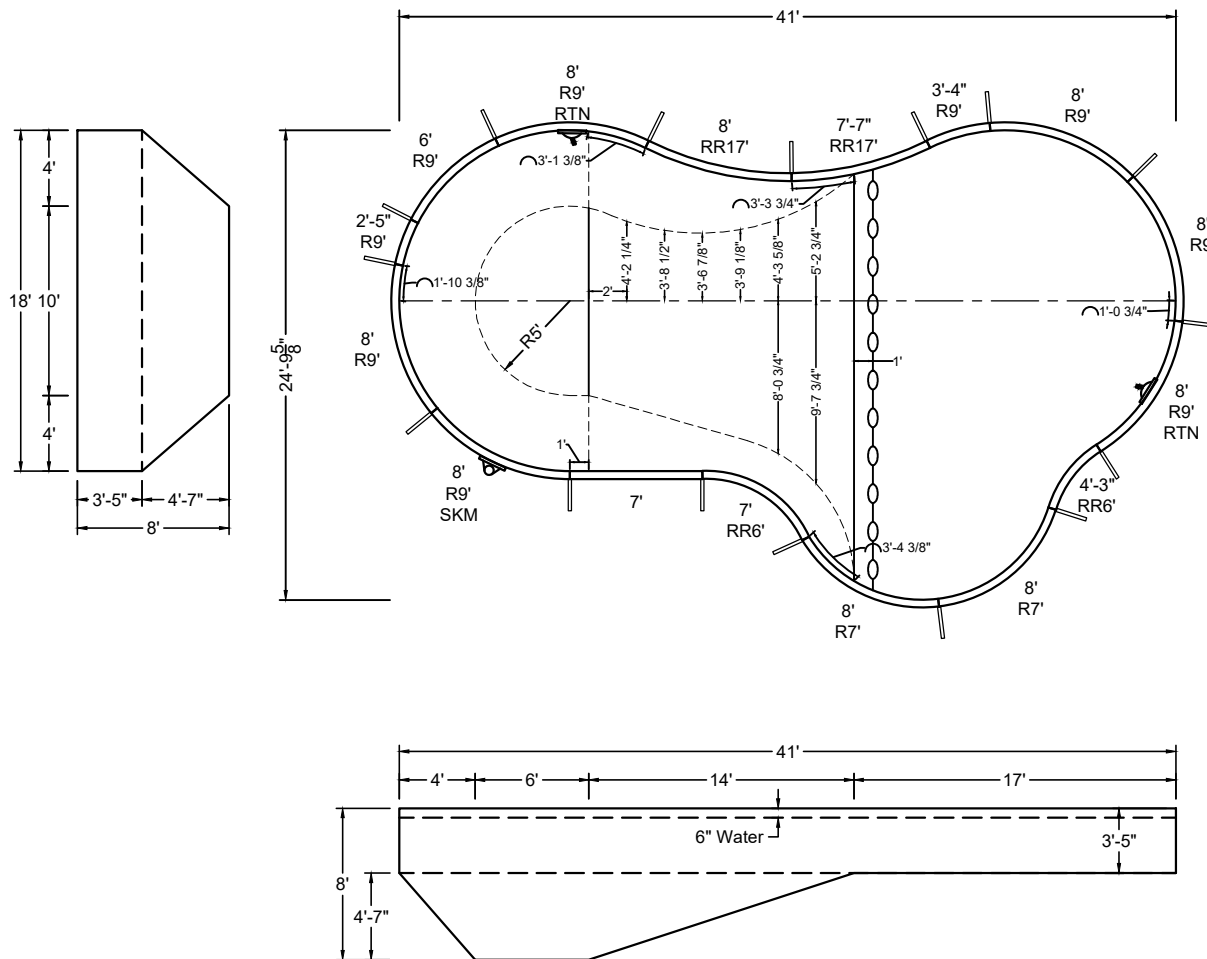

SHAPE : HUMPBACK HAVEN	SIZE : 18' X 41'	HAND : RIGHT	PANEL HEIGHT : 3'-6"	PANEL TYPE : 3" TOP
PERIMETER : 109'-6 5/8"	VOLUME : 25,418 US GAL.	SURFACE AREA : 712.812 SQ. FT.	SCALE : N.T.S	DRAWN BY : NM-BCC
DWG # : MN1841HH-19	DATE : 1/9/2017	REVISION # : 01	KIT REF : MN1841HH-19-R	<b>A</b>



## DIVING / SLIDE EQUIPMENT DISCLAIMER:

THE BOTTOM CONFIGURATION SHOWN MEETS WITH THE CURRENT IPSC MINIMUM STANDARDS FOR POOLS APPROVED FOR THE USE WITH MANUFACTURED DIVING EQUIPMENT. ALL DIVING EQUIPMENT MUST BE INSTALLED AND LOCATED IN ACCORDANCE WITH THE DIVING / SLIDE MANUFACTURER'S RECOMMENDATIONS. IF DIVING EQUIPMENT IS INSTALLED: PLEASE FOLLOW ALL THE DIVING / SLIDE EQUIPMENT MANUFACTURER'S INSTALLATION, USE AND SAFETY INSTRUCTIONS.

MEETS DEPTH AND SHAPE MINIMUM STANDARD ANSI/NSPI5-2003

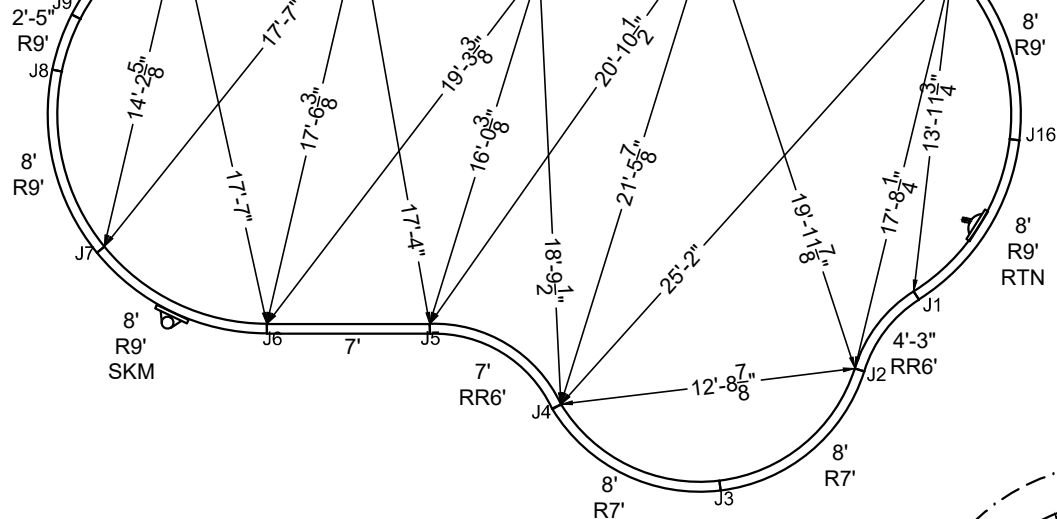

## STEEL CHECK

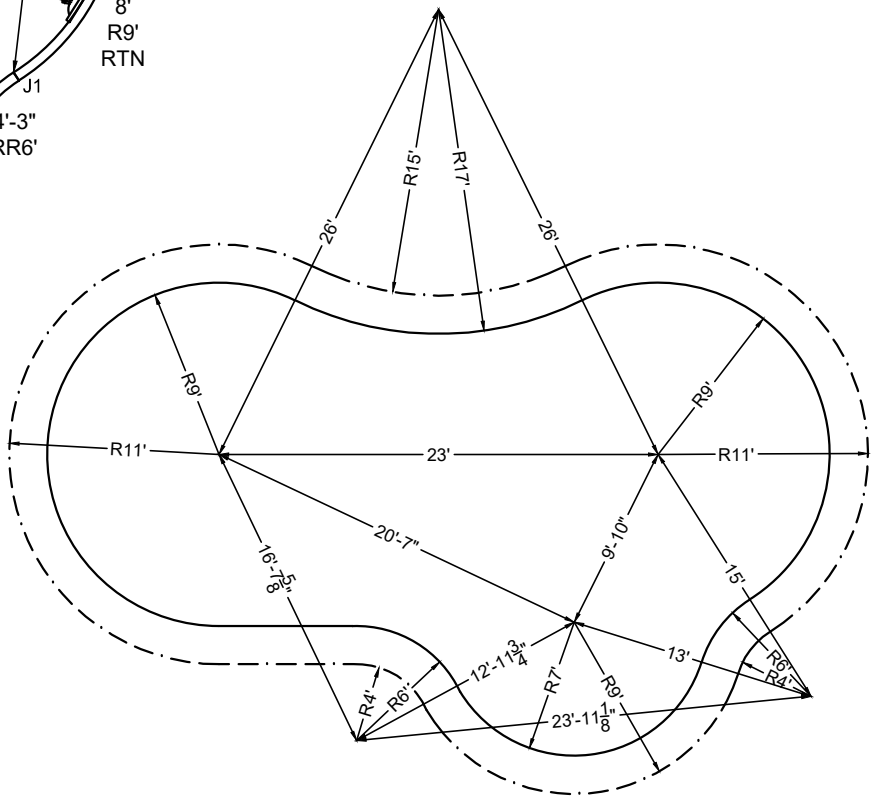

## STAKE OUT

SHAPE : HUMPBACK HAVEN	SIZE : 18' X 41'	HAND : RIGHT	PANEL HEIGHT : 3'-6"	DRAWN BY : NM-BCC
DWG # : MN1841HH-19	DATE : 1/9/2017	REVISION # : 01	KIT REF : MN1841HH-19-R	<b>B</b>