



NON-DIVING POOL

USE OF DIVING EQUIPMENT IS PROHIBITED

MEETS DEPTH AND SHAPE MINIMUM STANDARD ANSI/NSPI5-2003

ALL DIMENSIONS ARE FINISHED

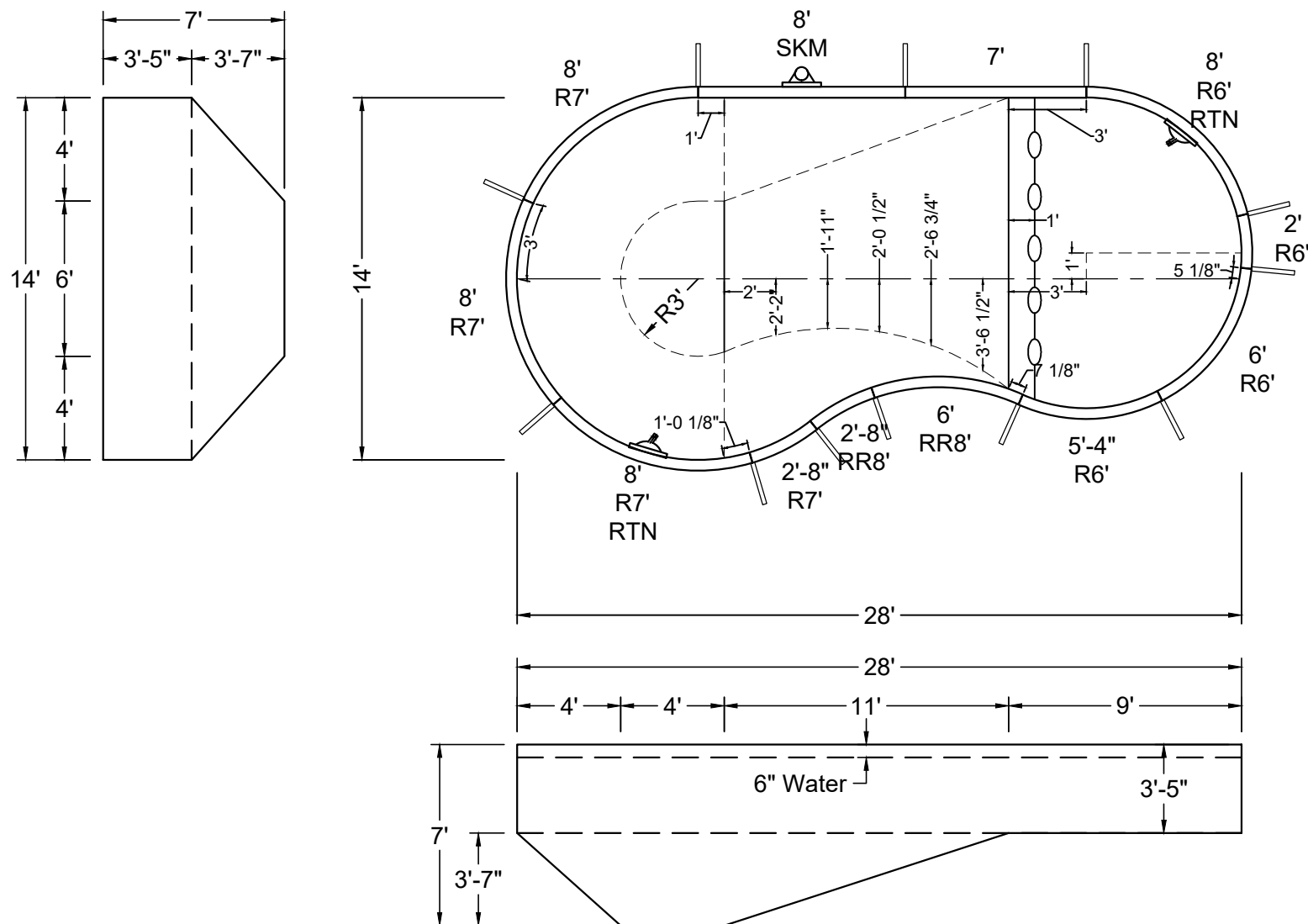

SHAPE : FLATBACK KIDNEY	SIZE : 14' X 28'	HAND : LEFT	PANEL HEIGHT : 3'-6"	PANEL TYPE : 5" TOP
PERIMETER : 71'-8 7/8"	VOLUME : 11,136 US GAL.	SURFACE AREA : 313.122 SQ. FT.	SCALE : N.T.S	DRAWN BY : NM-BCC
DWG # : MN1428FK-19	DATE : 12/20/2016	REVISION # : 01	KIT REF : MN1428FK-19-L	A

ALL DIMENSIONS ARE FINISHED



NON-DIVING POOL
USE OF DIVING EQUIPMENT IS PROHIBITED

MEETS DEPTH AND SHAPE MINIMUM STANDARD ANSI/NSPI5-2003

STEEL CHECK

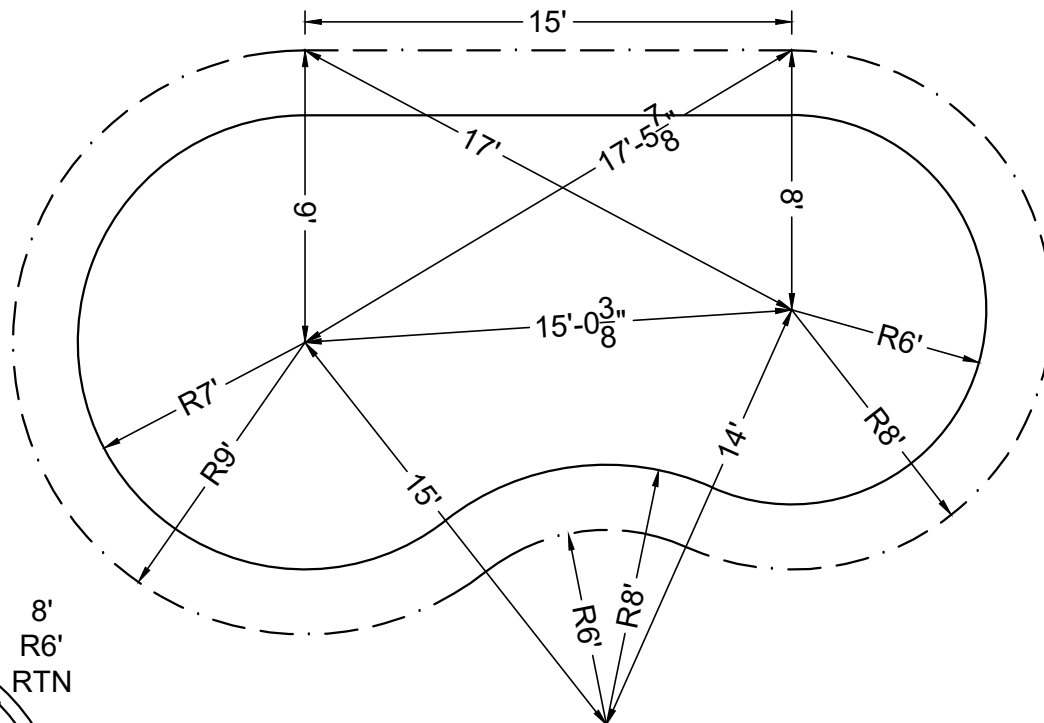
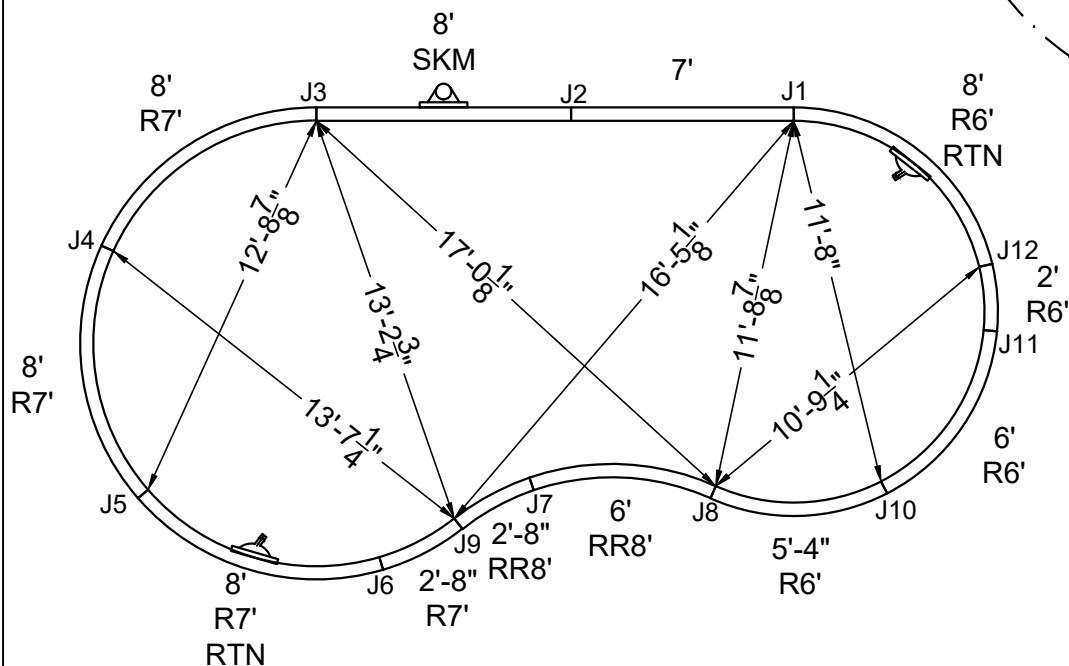

STAKE OUT

SHAPE: FLATBACK KIDNEY	SIZE: 14' X 28'	HAND: LEFT	PANEL HEIGHT: 3'-6"	DRAWN BY: NM-BCC
DWG #: MN1428FK-19	DATE: 12/20/2016	REVISION #: 01	KIT REF: MN1428FK-19-L	B



NON-DIVING POOL
USE OF DIVING EQUIPMENT IS PROHIBITED

MEETS DEPTH AND SHAPE MINIMUM STANDARD ANSI/NSPI5-2003

ALL DIMENSIONS ARE FINISHED

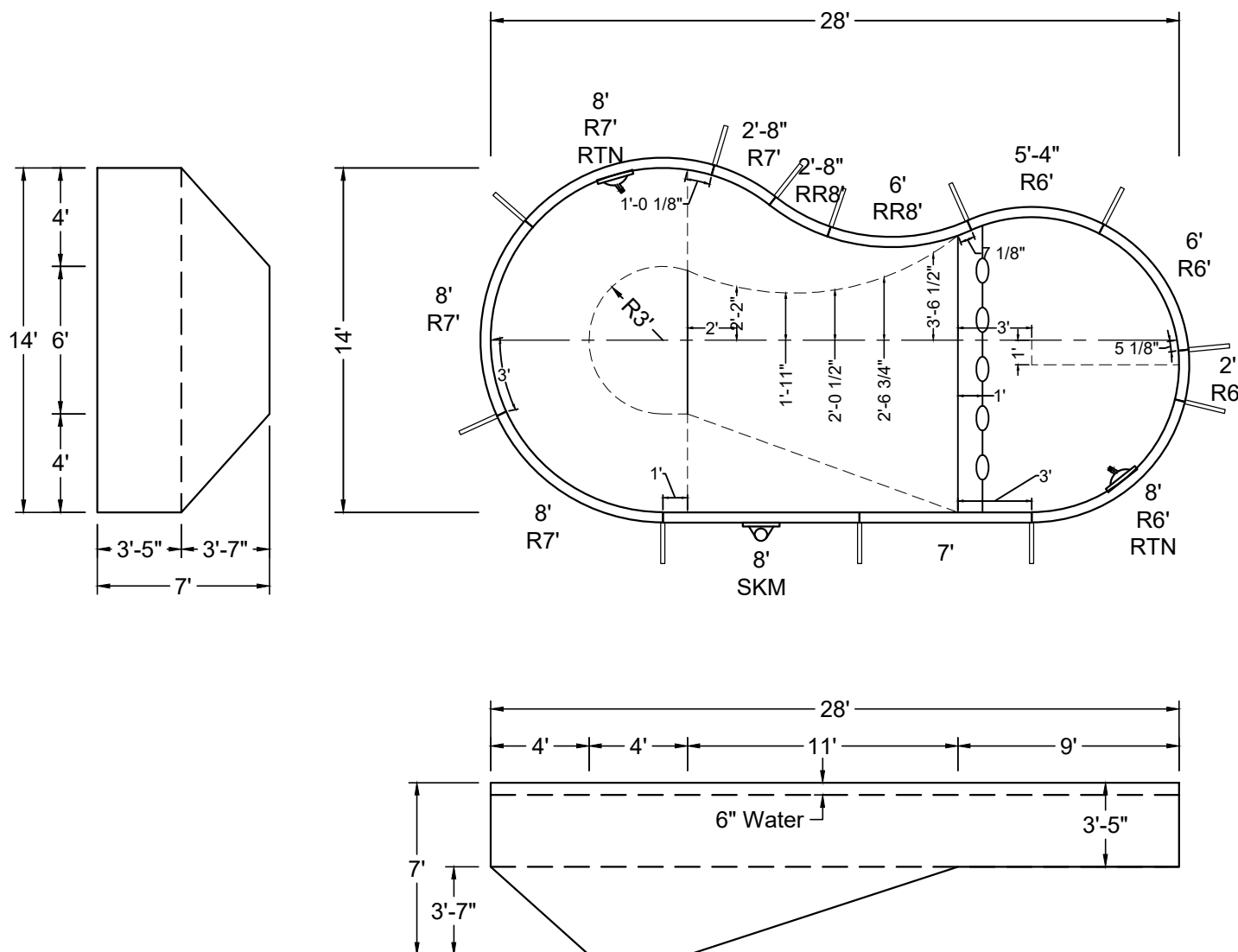

SHAPE : FLATBACK KIDNEY	SIZE : 14' X 28'	HAND : RIGHT	PANEL HEIGHT : 3'-6"	PANEL TYPE : 5" TOP
PERIMETER : 71'-8 7/8"	VOLUME : 11,136 US GAL.	SURFACE AREA : 313.122 SQ. FT.	SCALE : N.T.S	DRAWN BY : NM-BCC
DWG # : MN1428FK-19	DATE : 12/20/2016	REVISION # : 01	KIT REF : MN1428FK-19-R	A



ALL DIMENSIONS ARE FINISHED



STAKE OUT

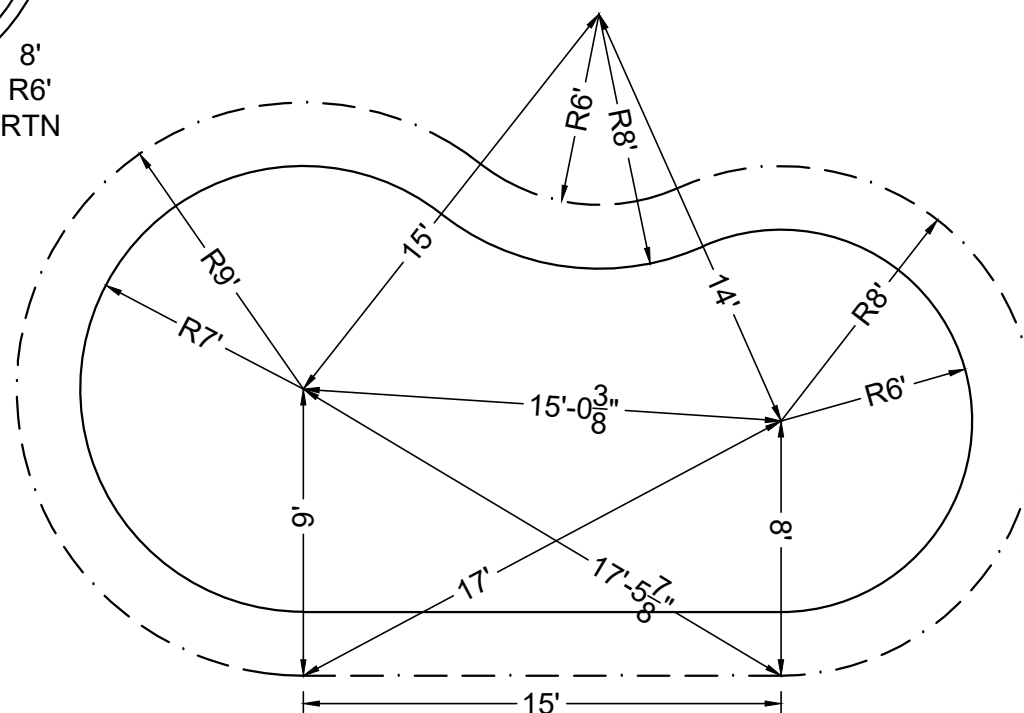

SHAPE : FLATBACK KIDNEY	SIZE : 14' X 28'	HAND : RIGHT	PANEL HEIGHT : 3'-6"	DRAWN BY : NM-BCC
DWG # : MN1428FK-19	DATE : 12/20/2016	REVISION # : 01	KIT REF : MN1428FK-19-R	B



NON-DIVING POOL
USE OF DIVING EQUIPMENT IS PROHIBITED

MEETS DEPTH AND SHAPE MINIMUM STANDARD ANSI/NSPI5-2003

ALL DIMENSIONS ARE FINISHED

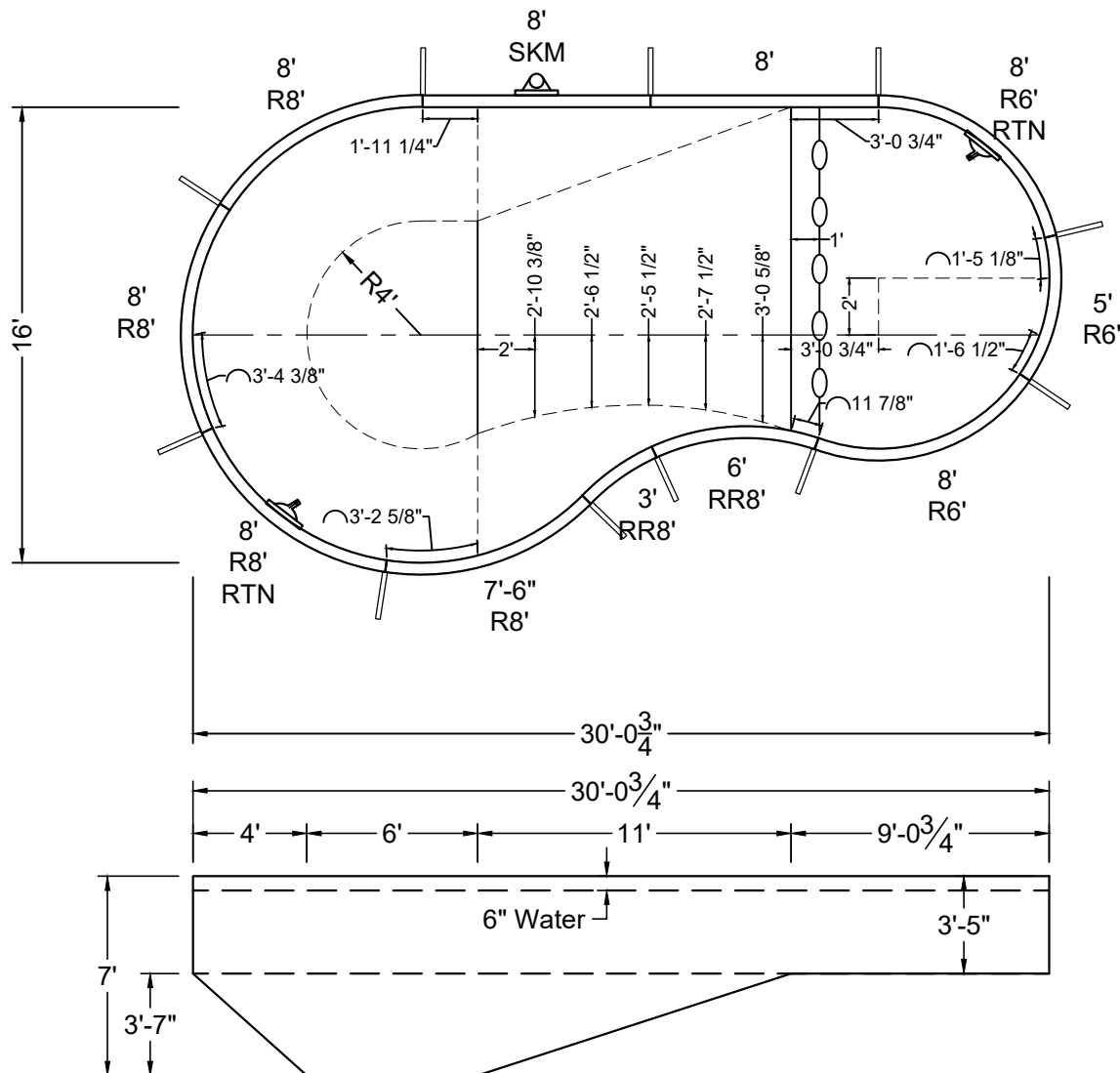
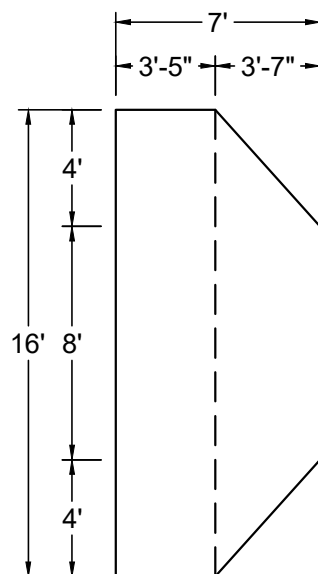

SHAPE : FLATBACK KIDNEY	SIZE : 16' X 30'-1"	HAND : LEFT	PANEL HEIGHT : 3'-6"	PANEL TYPE : 5" TOP
PERIMETER : 77'-6"	VOLUME : 13,626 US GAL.	SURFACE AREA : 366.219 SQ. FT.	SCALE : N.T.S	DRAWN BY : NM-BCC
DWG # : MN1630FK-19	DATE : 12/20/2016	REVISION # : 01	KIT REF : MN1630FK-19-L	A

ALL DIMENSIONS ARE FINISHED



NON-DIVING POOL
USE OF DIVING EQUIPMENT IS PROHIBITED

MEETS DEPTH AND SHAPE MINIMUM STANDARD ANSI/NSPI5-2003

STEEL CHECK

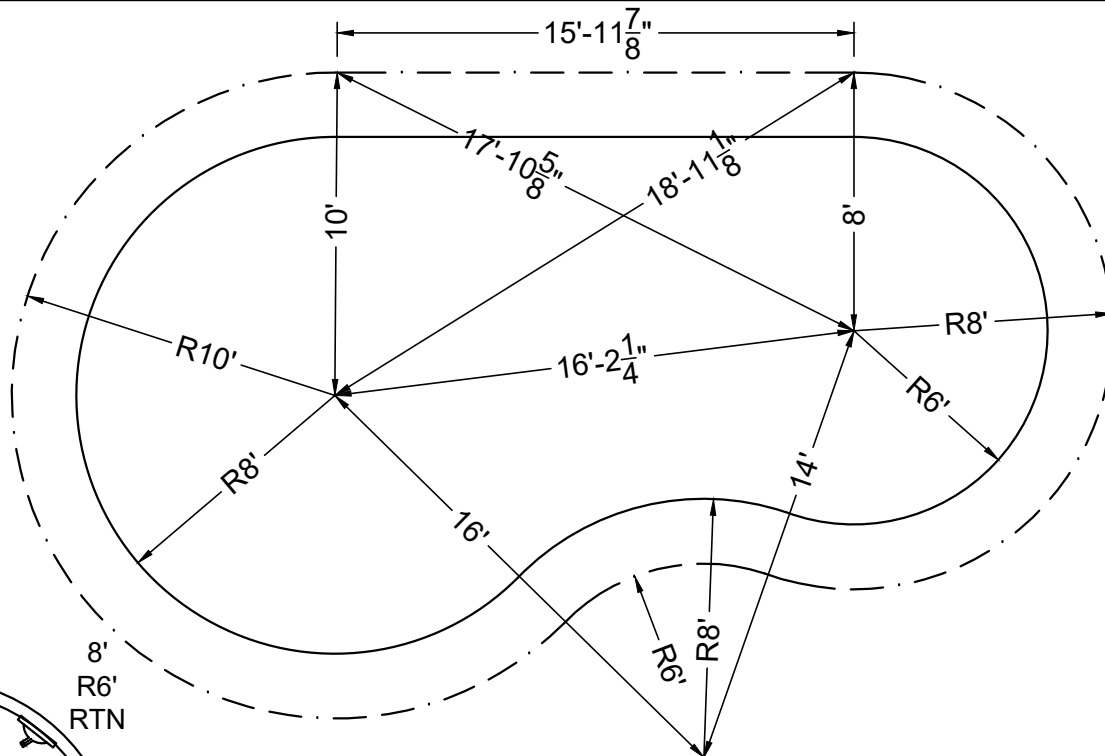
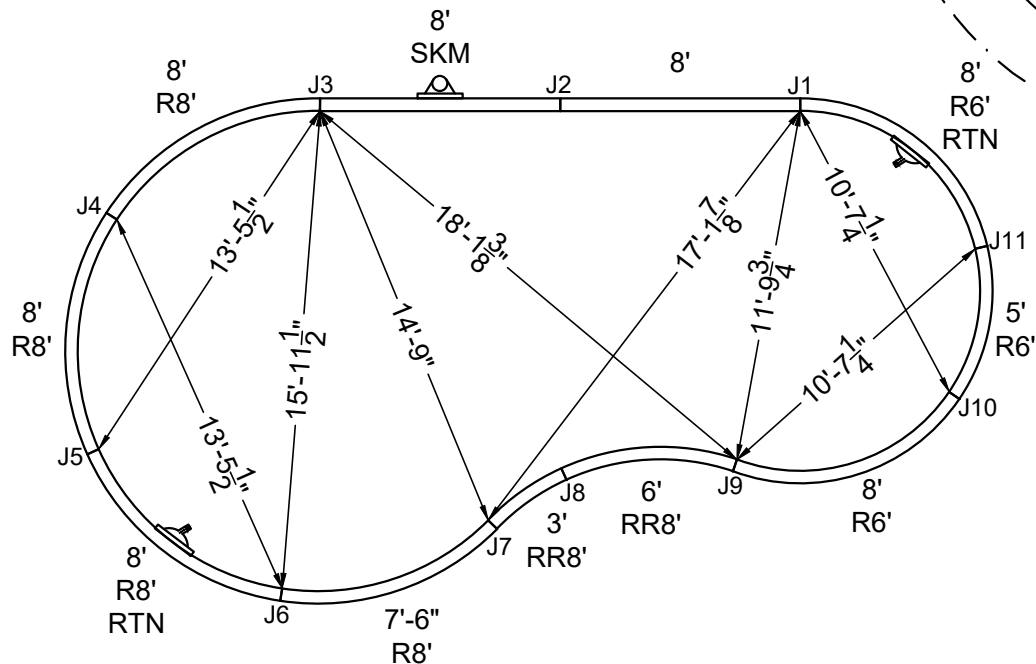

STAKE OUT

SHAPE: FLATBACK KIDNEY

SIZE: 16' X 30'-1"

HAND: LEFT

PANEL HEIGHT: 3'-6"

DRAWN BY: NM-BCC

DWG #: MN1630FK-19

DATE: 12/20/2016

REVISION #: 01

KIT REF: MN1630FK-19-L

B



NON-DIVING POOL
USE OF DIVING EQUIPMENT IS PROHIBITED

MEETS DEPTH AND SHAPE MINIMUM STANDARD ANSI/NSPI5-2003

ALL DIMENSIONS ARE FINISHED

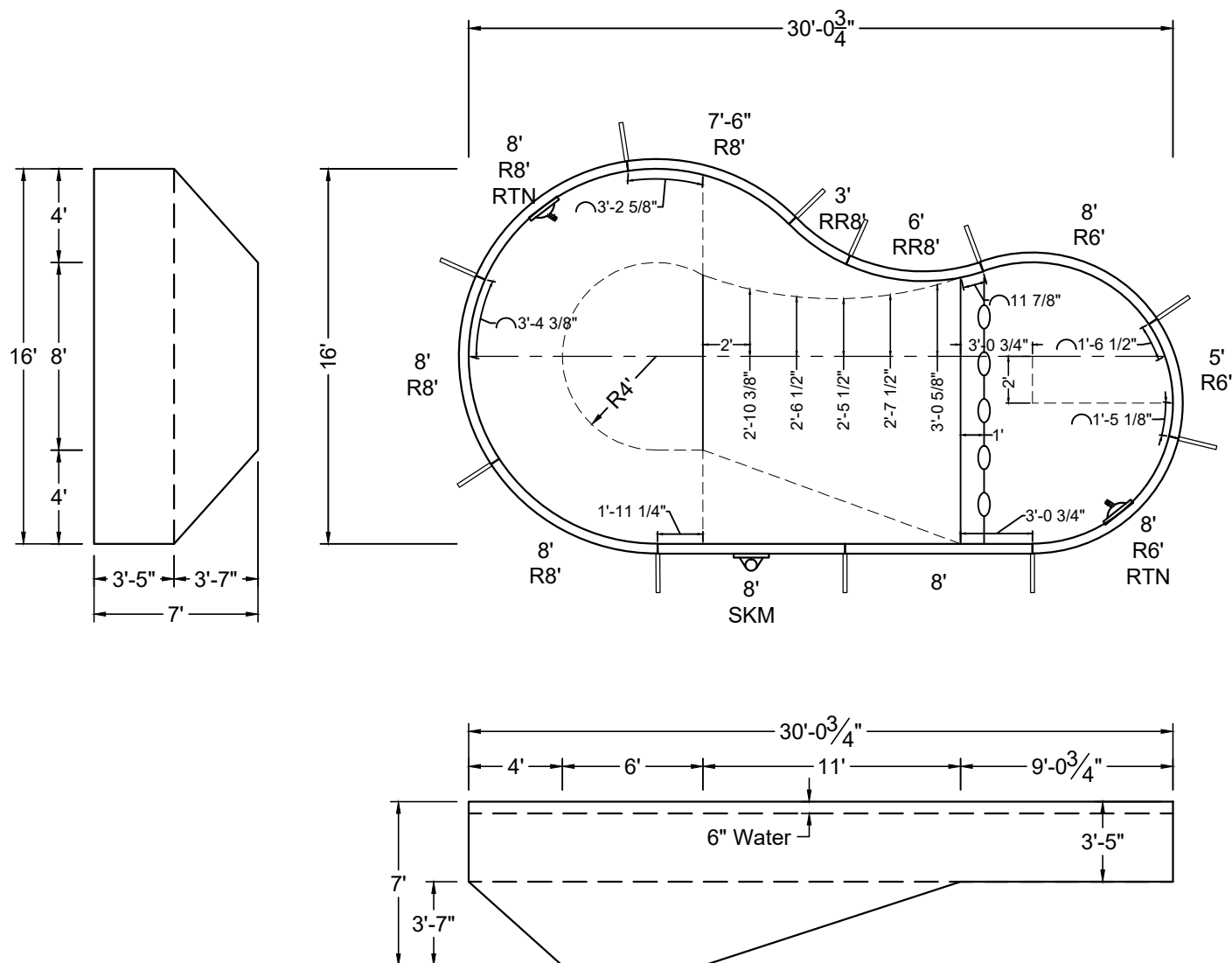

SHAPE : FLATBACK KIDNEY	SIZE : 16' X 30'-1"	HAND : RIGHT	PANEL HEIGHT : 3'-6"	PANEL TYPE : 5" TOP
PERIMETER : 77'-6"	VOLUME : 13,626 US GAL.	SURFACE AREA : 366.219 SQ. FT.	SCALE : N.T.S	DRAWN BY : NM-BCC
DWG # : MN1630FK-19	DATE : 12/20/2016	REVISION # : 01	KIT REF : MN1630FK-19-R	A



NON-DIVING POOL
USE OF DIVING EQUIPMENT IS PROHIBITED

MEETS DEPTH AND SHAPE MINIMUM STANDARD ANSI/NSPI5-2003

ALL DIMENSIONS ARE FINISHED

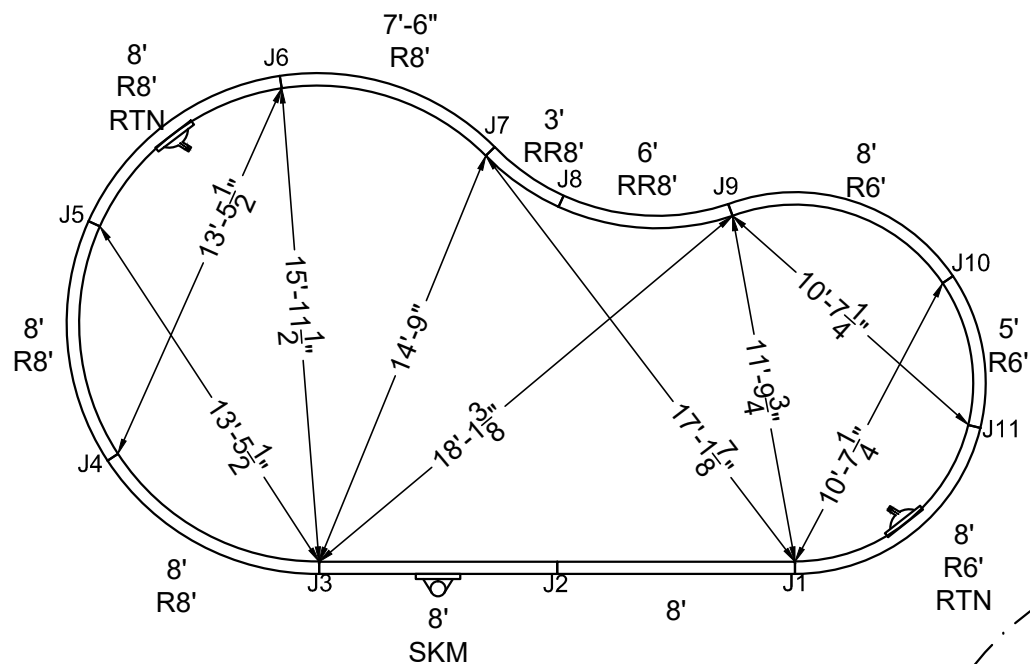

STEEL CHECK

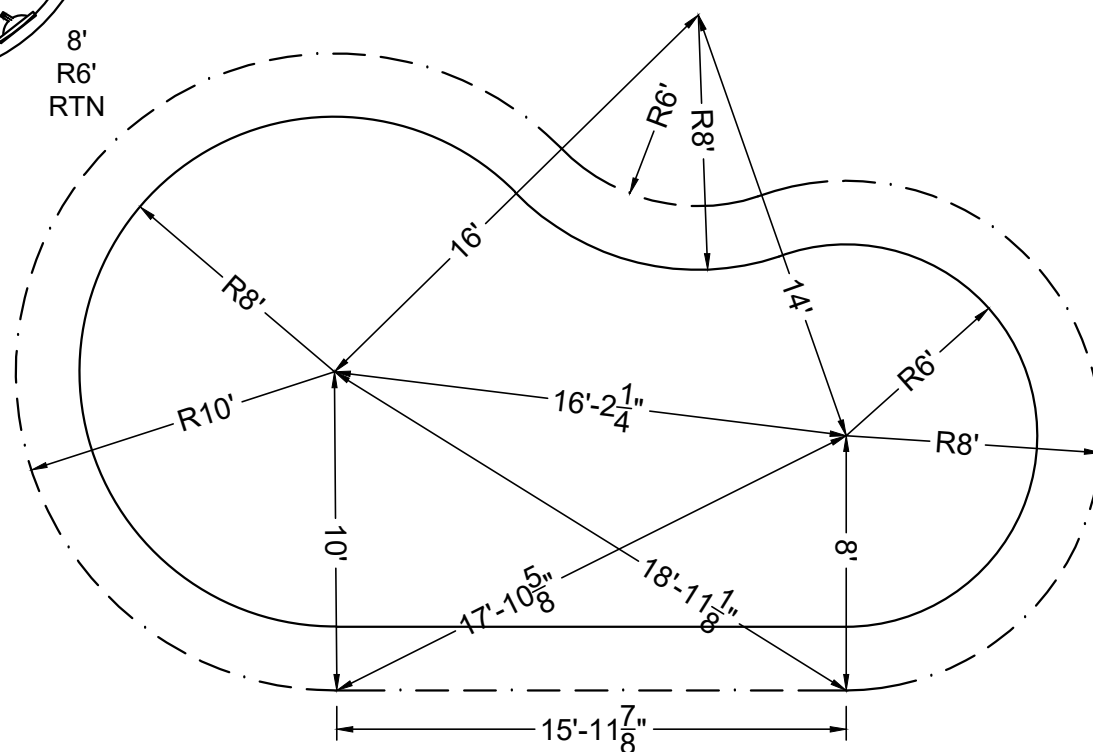

STAKE OUT

SHAPE : FLATBACK KIDNEY	SIZE : 16' X 30'-1"	HAND : RIGHT	PANEL HEIGHT : 3'-6"	DRAWN BY : NM-BCC
DWG # : MN1630FK-19	DATE : 12/20/2016	REVISION # : 01	KIT REF : MN1630FK-19-R	B

DIVING / SLIDE EQUIPMENT DISCLAIMER:

THE BOTTOM CONFIGURATION SHOWN MEETS WITH THE CURRENT ISPS MINIMUM STANDARDS FOR POOLS APPROVED FOR THE USE WITH MANUFACTURED DIVING EQUIPMENT. ALL DIVING EQUIPMENT MUST BE INSTALLED AND LOCATED IN ACCORDANCE WITH THE DIVING / SLIDE MANUFACTURER'S RECOMMENDATIONS. IF DIVING EQUIPMENT IS INSTALLED: PLEASE FOLLOW ALL THE DIVING / SLIDE EQUIPMENT MANUFACTURER'S INSTALLATION, USE AND SAFETY INSTRUCTIONS.

MEETS DEPTH AND SHAPE MINIMUM STANDARD ANSI/NSPI5-2003

ALL DIMENSIONS ARE FINISHED

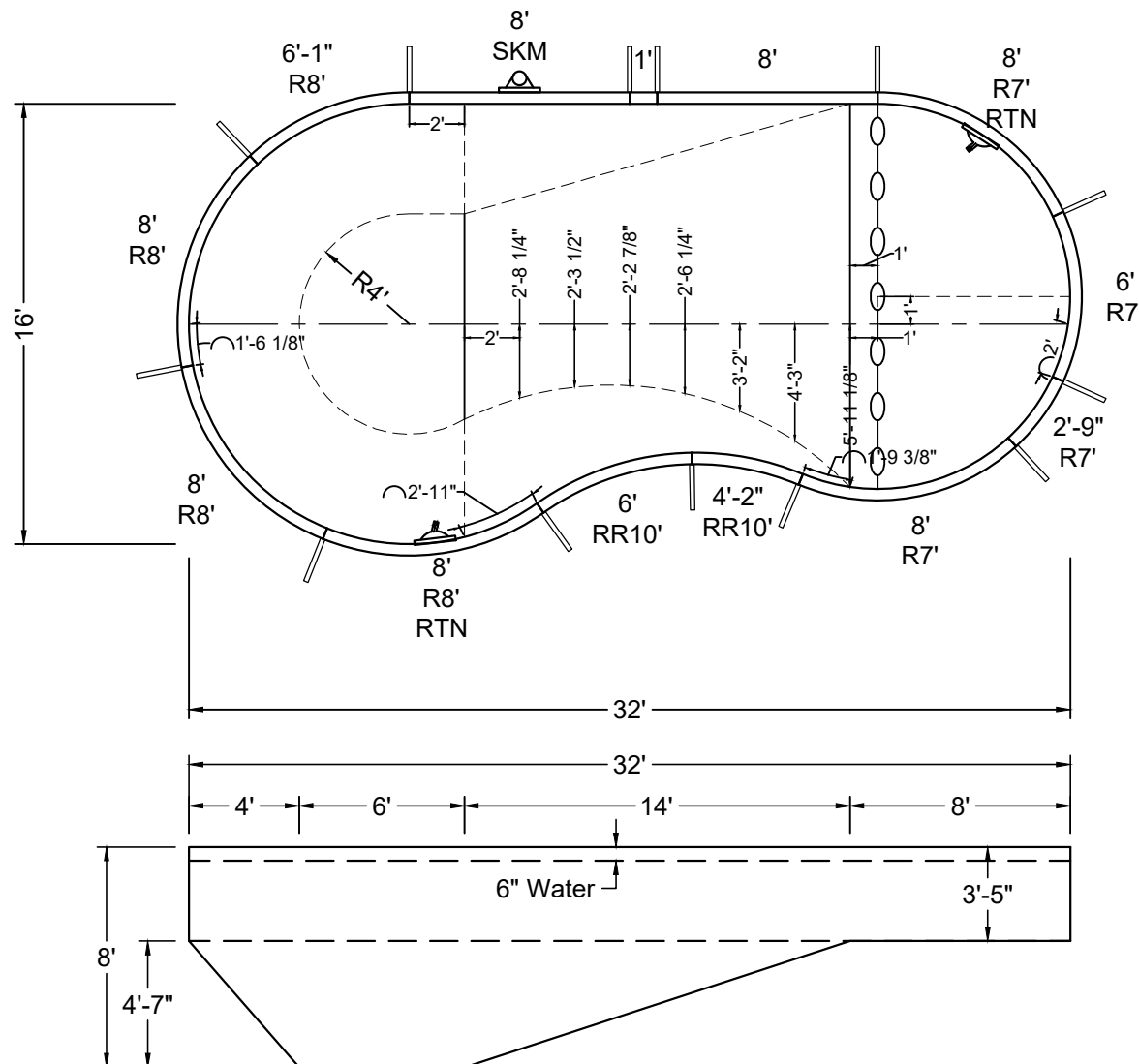
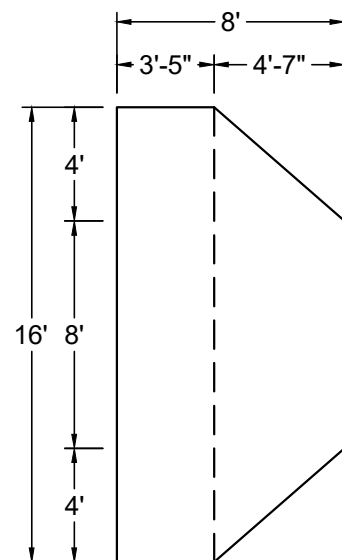

SHAPE : FLATBACK KIDNEY	SIZE : 16' X 32'	HAND : LEFT	PANEL HEIGHT : 3'-6"	PANEL TYPE : 5" TOP
PERIMETER : 81'-11 29/32"	VOLUME : 16,709 US GAL.	SURFACE AREA : 413.709 SQ. FT.	SCALE : N.T.S	DRAWN BY : NM-BCC
DWG # : MN1632FK-19	DATE : 12/20/2016	REVISION # : 01	KIT REF : MN1632FK-19-L	A

ALL DIMENSIONS ARE FINISHED

DIVING / SLIDE EQUIPMENT DISCLAIMER:

THE BOTTOM CONFIGURATION SHOWN MEETS WITH THE CURRENT ISPC MINIMUM STANDARDS FOR POOLS APPROVED FOR THE USE WITH MANUFACTURED DIVING EQUIPMENT. ALL DIVING EQUIPMENT MUST BE INSTALLED AND LOCATED IN ACCORDANCE WITH THE DIVING / SLIDE MANUFACTURER'S RECOMMENDATIONS. IF DIVING EQUIPMENT IS INSTALLED: PLEASE FOLLOW ALL THE DIVING / SLIDE EQUIPMENT MANUFACTURER'S INSTALLATION, USE AND SAFETY INSTRUCTIONS.

MEETS DEPTH AND SHAPE MINIMUM STANDARD ANSI/NSPI5-2003

STEEL CHECK

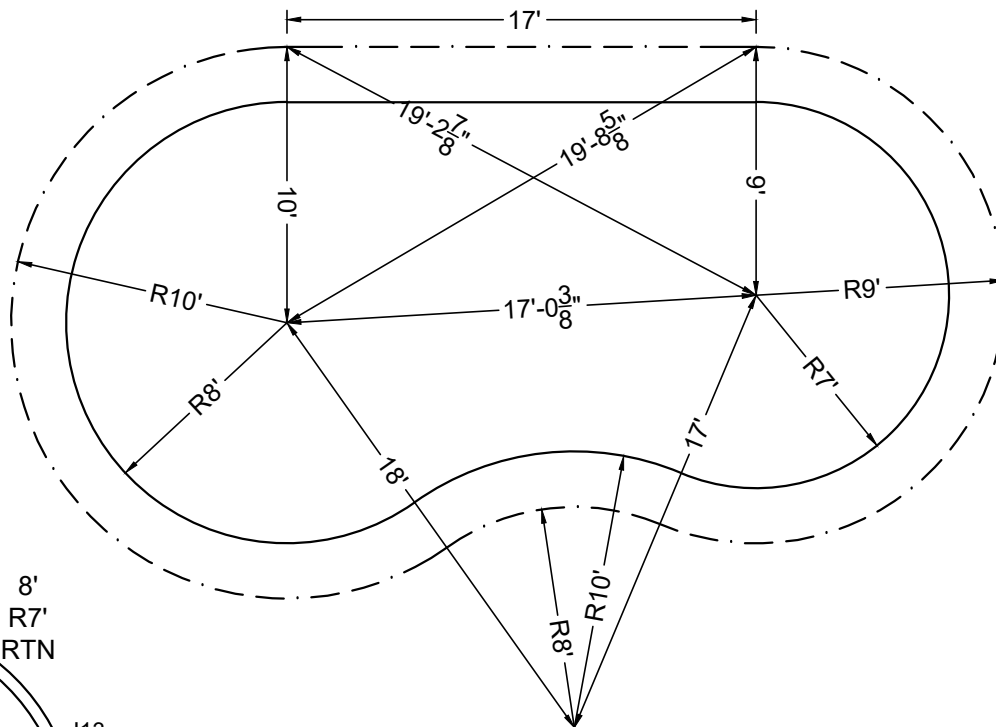
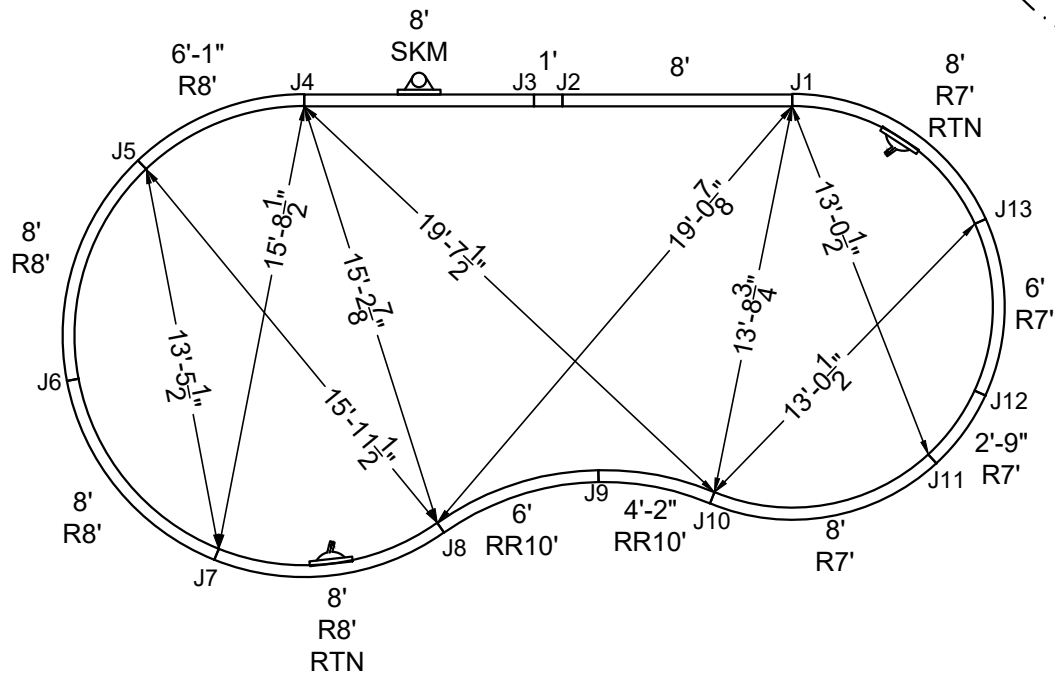

STAKE OUT

SHAPE : FLATBACK KIDNEY	SIZE : 16' X 32'	HAND : LEFT	PANEL HEIGHT : 3'-6"	DRAWN BY : NM-BCC
DWG # : MN1632FK-19	DATE : 12/20/2016	REVISION # : 01	KIT REF : MN1632FK-19-L	B



DIVING / SLIDE EQUIPMENT DISCLAIMER:

THE BOTTOM CONFIGURATION SHOWN MEETS WITH THE CURRENT IPSC MINIMUM STANDARDS FOR POOLS APPROVED FOR THE USE WITH MANUFACTURED DIVING EQUIPMENT. ALL DIVING EQUIPMENT MUST BE INSTALLED AND LOCATED IN ACCORDANCE WITH THE DIVING / SLIDE MANUFACTURER'S RECOMMENDATIONS. IF DIVING EQUIPMENT IS INSTALLED: PLEASE FOLLOW ALL THE DIVING / SLIDE EQUIPMENT MANUFACTURER'S INSTALLATION, USE AND SAFETY INSTRUCTIONS.

MEETS DEPTH AND SHAPE MINIMUM STANDARD ANSI/NSPI5-2003

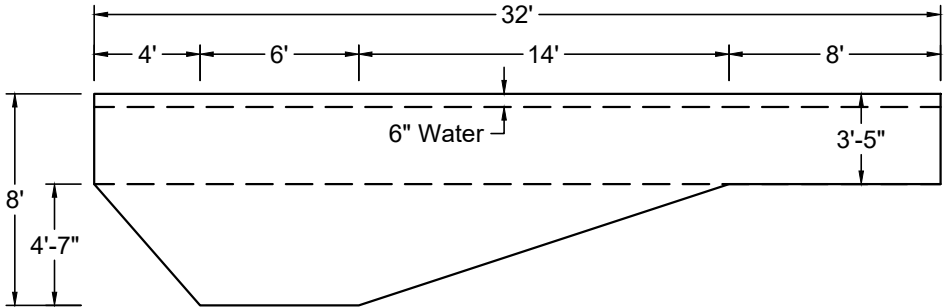

SHAPE: FLATBACK KIDNEY	SIZE: 16' X 32'	HAND: RIGHT	PANEL HEIGHT: 3'-6"	PANEL TYPE: 5" TOP
PERIMETER: 81'-11 29/32"	VOLUME: 16,709 US GAL.	SURFACE AREA: 413.709 SQ. FT.	SCALE: N.T.S	DRAWN BY: NM-BCC
DWG #: MN1632FK-19	DATE: 12/20/2016	REVISION #: 01	KIT REF: MN1632FK-19-R	A

ALL DIMENSIONS ARE FINISHED

DIVING / SLIDE EQUIPMENT DISCLAIMER:

THE BOTTOM CONFIGURATION SHOWN MEETS WITH THE CURRENT ISPSA MINIMUM STANDARDS FOR POOLS APPROVED FOR THE USE WITH MANUFACTURED DIVING EQUIPMENT. ALL DIVING EQUIPMENT MUST BE INSTALLED AND LOCATED IN ACCORDANCE WITH THE DIVING / SLIDE MANUFACTURER'S RECOMMENDATIONS. IF DIVING EQUIPMENT IS INSTALLED: PLEASE FOLLOW ALL THE DIVING / SLIDE EQUIPMENT MANUFACTURER'S INSTALLATION, USE AND SAFETY INSTRUCTIONS.

MEETS DEPTH AND SHAPE MINIMUM STANDARD ANSI/NSPI-2003

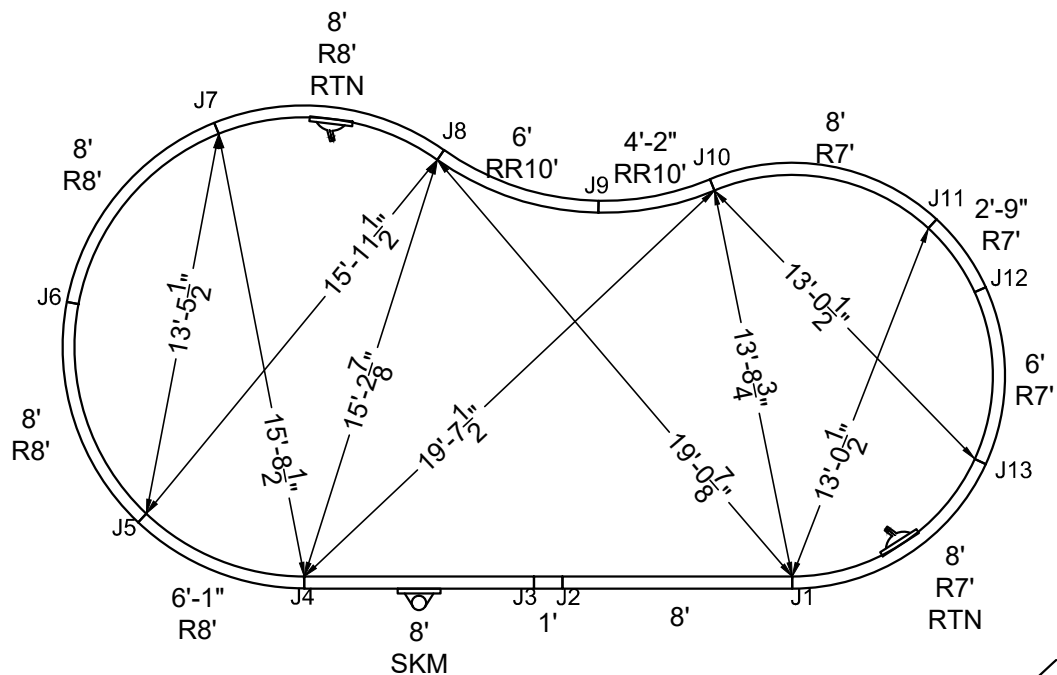

STEEL CHECK

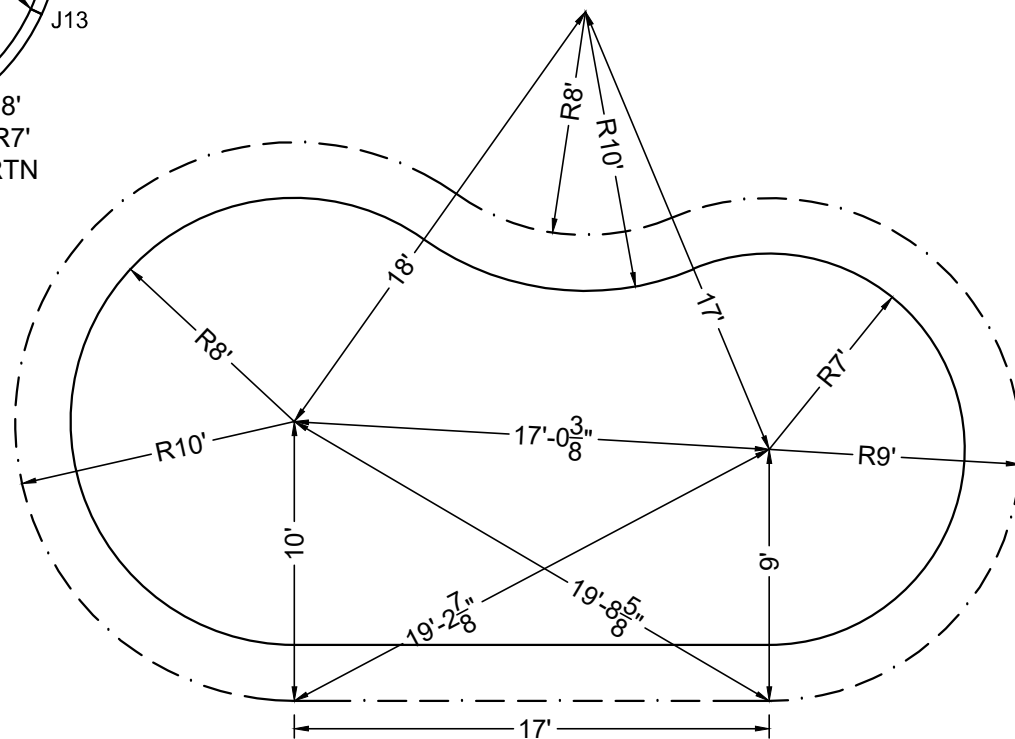

STAKE OUT

SHAPE: FLATBACK KIDNEY

SIZE: 16' X 32'

HAND: RIGHT

PANEL HEIGHT: 3'-6"

DRAWN BY: NM-BCC

DWG #: MN1632FK-19

DATE: 12/20/2016

REVISION #: 01

KIT REF: MN1632FK-19-R

B

ALL DIMENSIONS ARE FINISHED

DIVING / SLIDE EQUIPMENT DISCLAIMER:

THE BOTTOM CONFIGURATION SHOWN MEETS WITH THE CURRENT ISPSC MINIMUM STANDARDS FOR POOLS APPROVED FOR THE USE WITH MANUFACTURED DIVING EQUIPMENT. ALL DIVING EQUIPMENT MUST BE INSTALLED AND LOCATED IN ACCORDANCE WITH THE DIVING / SLIDE MANUFACTURER'S RECOMMENDATIONS. IF DIVING EQUIPMENT IS INSTALLED: PLEASE FOLLOW ALL THE DIVING / SLIDE EQUIPMENT MANUFACTURER'S INSTALLATION, USE AND SAFETY INSTRUCTIONS.

MEETS DEPTH AND SHAPE MINIMUM STANDARD ANSI/NSPI5-2003

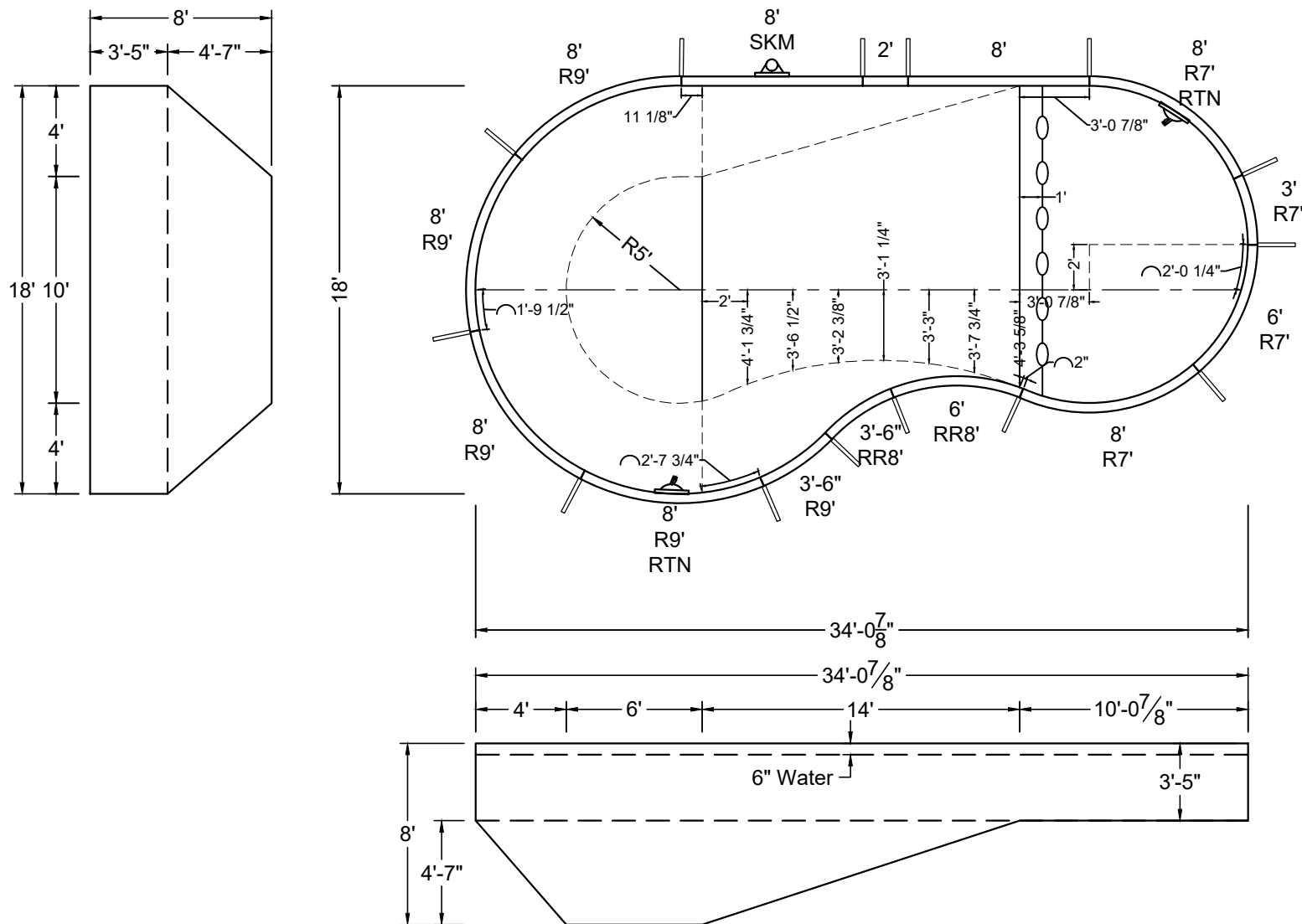

SHAPE : FLATBACK KIDNEY	SIZE : 18' X 34'-1"	HAND : LEFT	PANEL HEIGHT : 3'-6"	PANEL TYPE : 5" TOP
PERIMETER : 88'	VOLUME : 19,072 US GAL.	SURFACE AREA : 471.578 SQ. FT.	SCALE : N.T.S	DRAWN BY : NM-BCC
DWG # : MN1834FK-19	DATE : 12/20/2016	REVISION # : 01	KIT REF : MN1834FK-19-L	A



ALL DIMENSIONS ARE FINISHED

DIVING / SLIDE EQUIPMENT DISCLAIMER:

THE BOTTOM CONFIGURATION SHOWN MEETS WITH THE CURRENT IPSC MINIMUM STANDARDS FOR POOLS APPROVED FOR THE USE WITH MANUFACTURED DIVING EQUIPMENT. ALL DIVING EQUIPMENT MUST BE INSTALLED AND LOCATED IN ACCORDANCE WITH THE DIVING / SLIDE MANUFACTURER'S RECOMMENDATIONS. IF DIVING EQUIPMENT IS INSTALLED: PLEASE FOLLOW ALL THE DIVING / SLIDE EQUIPMENT MANUFACTURER'S INSTALLATION, USE AND SAFETY INSTRUCTIONS.

MEETS DEPTH AND SHAPE MINIMUM STANDARD ANSI/NSPI5-2003

STEEL CHECK

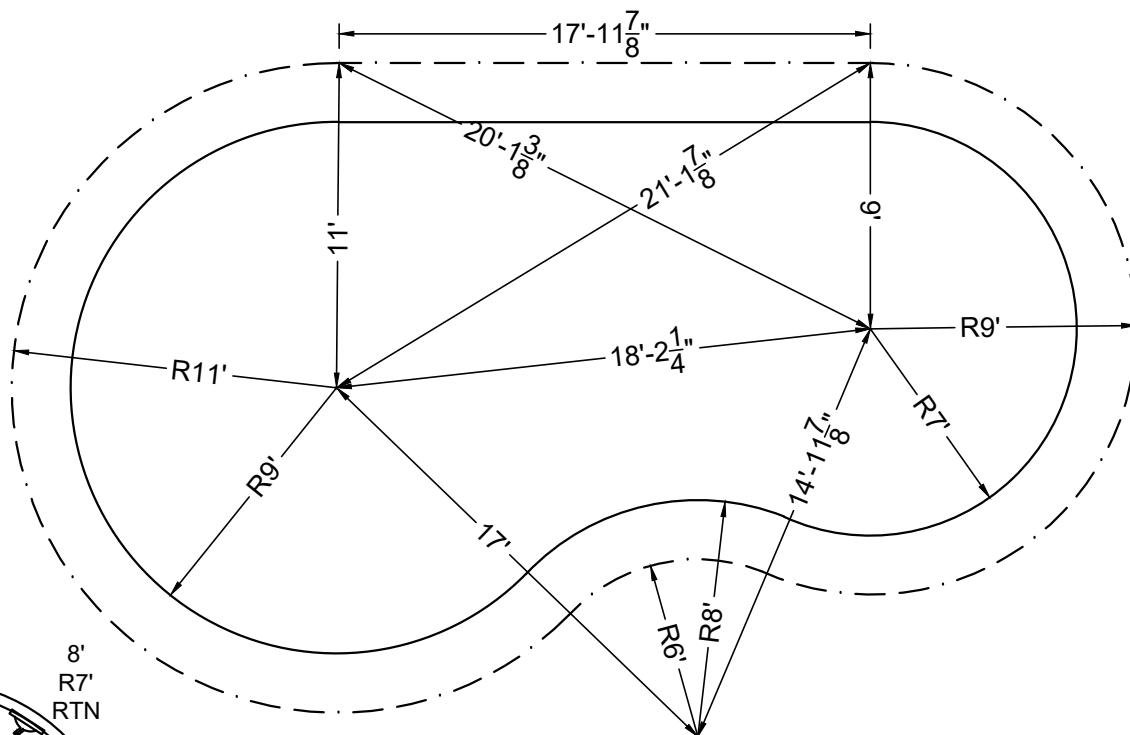

STAKE OUT

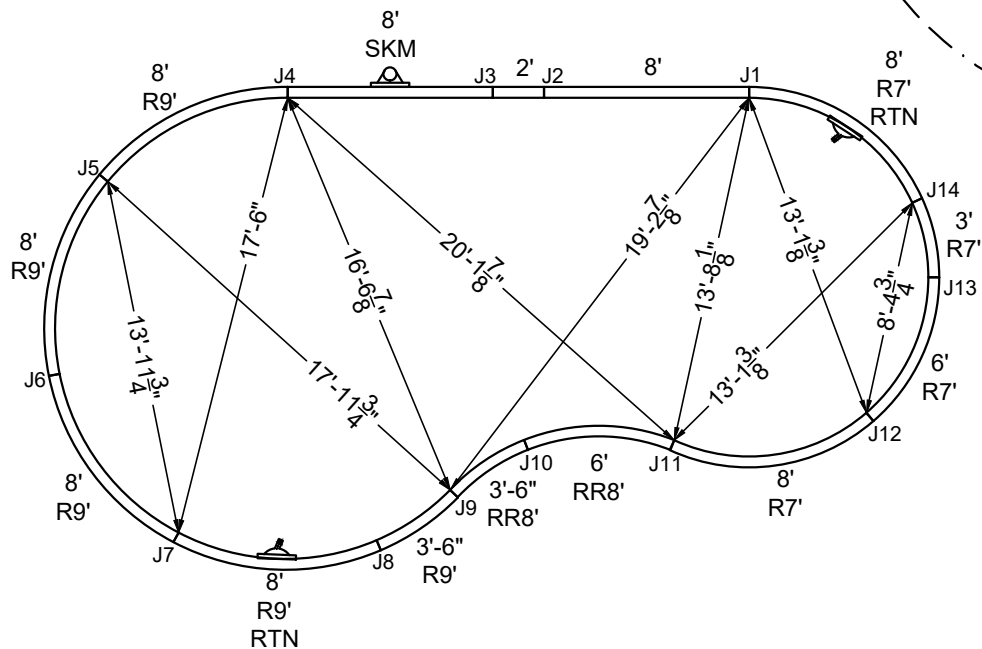

SHAPE: FLATBACK KIDNEY	SIZE: 18' X 34'-1"	HAND: LEFT	PANEL HEIGHT: 3'-6"	DRAWN BY: NM-BCC
DWG #: MN1834FK-19	DATE: 12/20/2016	REVISION #: 01	KIT REF: MN1834FK-19-L	B

ALL DIMENSIONS ARE FINISHED

DIVING / SLIDE EQUIPMENT DISCLAIMER:

THE BOTTOM CONFIGURATION SHOWN MEETS WITH THE CURRENT ISPC MINIMUM STANDARDS FOR POOLS APPROVED FOR THE USE WITH MANUFACTURED DIVING EQUIPMENT. ALL DIVING EQUIPMENT MUST BE INSTALLED AND LOCATED IN ACCORDANCE WITH THE DIVING / SLIDE MANUFACTURER'S RECOMMENDATIONS. IF DIVING EQUIPMENT IS INSTALLED: PLEASE FOLLOW ALL THE DIVING / SLIDE EQUIPMENT MANUFACTURER'S INSTALLATION, USE AND SAFETY INSTRUCTIONS.

MEETS DEPTH AND SHAPE MINIMUM STANDARD ANSI/NSPI-2003

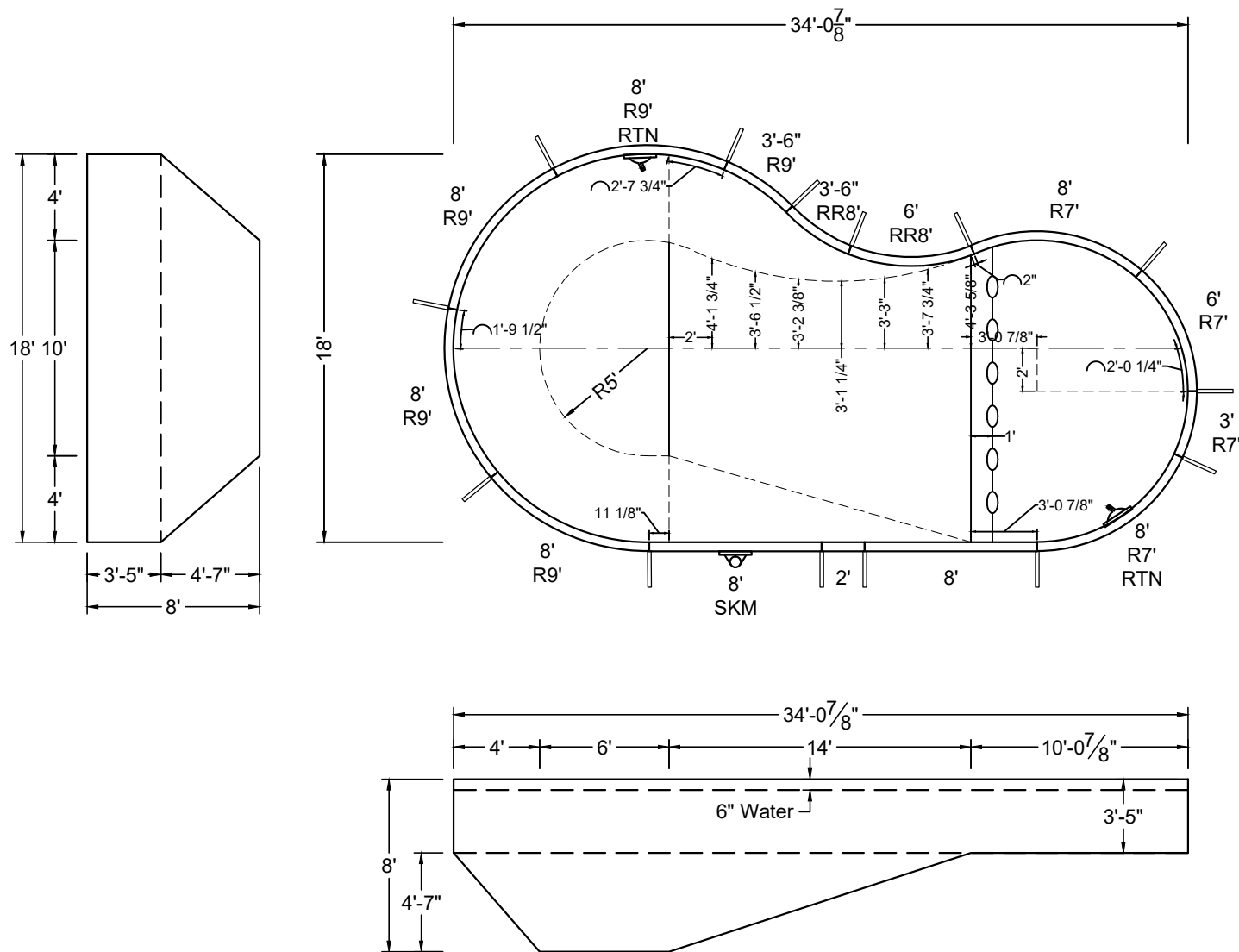

SHAPE: FLATBACK KIDNEY	SIZE: 18' X 34'-1"	HAND: RIGHT	PANEL HEIGHT: 3'-6"	PANEL TYPE: 5" TOP
PERIMETER: 88'	VOLUME: 19,072 US GAL.	SURFACE AREA: 471.578 SQ. FT.	SCALE: N.T.S	DRAWN BY: NM-BCC
DWG #: MN1834FK-19	DATE: 12/20/2016	REVISION #: 01	KIT REF: MN1834FK-19-R	A



ALL DIMENSIONS ARE FINISHED

DIVING / SLIDE EQUIPMENT DISCLAIMER:

THE BOTTOM CONFIGURATION SHOWN MEETS WITH THE CURRENT ISPS MINIMUM STANDARDS FOR POOLS APPROVED FOR THE USE WITH MANUFACTURED DIVING EQUIPMENT. ALL DIVING EQUIPMENT MUST BE INSTALLED AND LOCATED IN ACCORDANCE WITH THE DIVING / SLIDE MANUFACTURER'S RECOMMENDATIONS. IF DIVING EQUIPMENT IS INSTALLED: PLEASE FOLLOW ALL THE DIVING / SLIDE EQUIPMENT MANUFACTURER'S INSTALLATION, USE AND SAFETY INSTRUCTIONS.

MEETS DEPTH AND SHAPE MINIMUM STANDARD ANSI/NSPI-2003

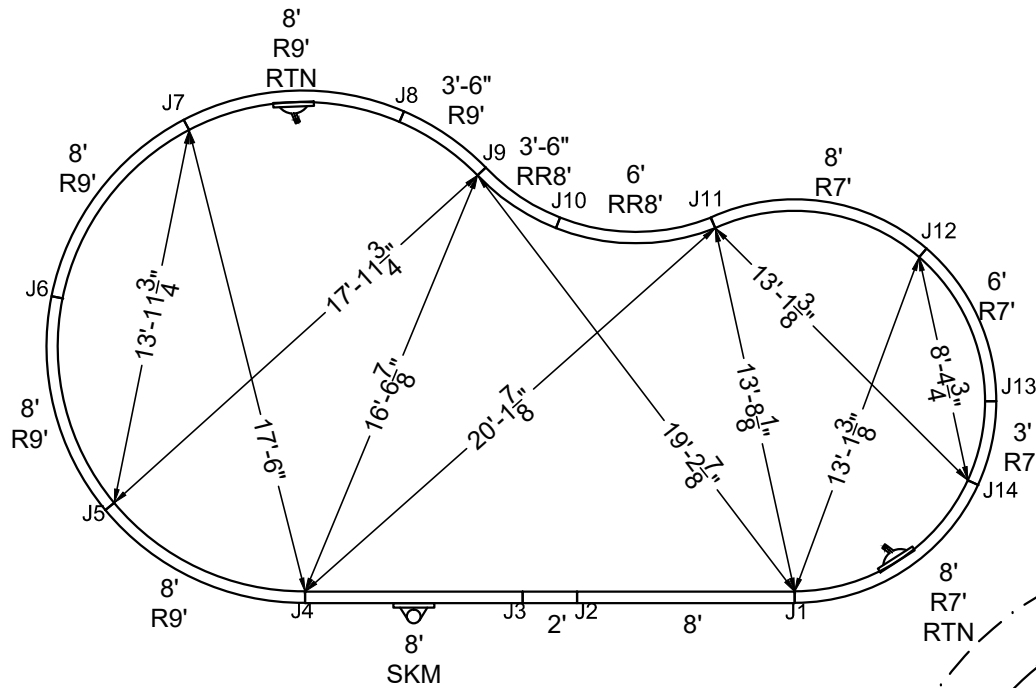

STEEL CHECK

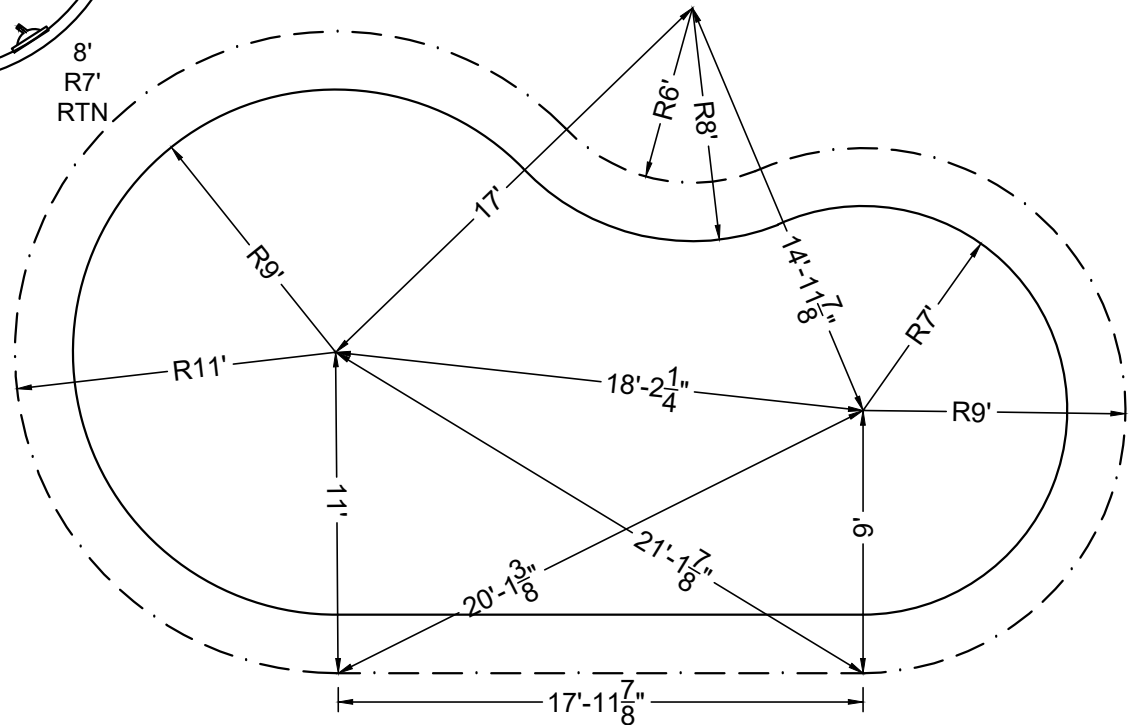

STAKE OUT

SHAPE: FLATBACK KIDNEY	SIZE: 18' X 34'-1"	HAND: RIGHT	PANEL HEIGHT: 3'-6"	DRAWN BY: NM-BCC
DWG #: MN1834FK-19	DATE: 12/20/2016	REVISION #: 01	KIT REF: MN1834FK-19-R	B

ALL DIMENSIONS ARE FINISHED

DIVING / SLIDE EQUIPMENT DISCLAIMER:

THE BOTTOM CONFIGURATION SHOWN MEETS WITH THE CURRENT ISPSC MINIMUM STANDARDS FOR POOLS APPROVED FOR THE USE WITH MANUFACTURED DIVING EQUIPMENT. ALL DIVING EQUIPMENT MUST BE INSTALLED AND LOCATED IN ACCORDANCE WITH THE DIVING / SLIDE MANUFACTURER'S RECOMMENDATIONS. IF DIVING EQUIPMENT IS INSTALLED: PLEASE FOLLOW ALL THE DIVING / SLIDE EQUIPMENT MANUFACTURER'S INSTALLATION, USE AND SAFETY INSTRUCTIONS.

MEETS DEPTH AND SHAPE MINIMUM STANDARD ANSI/NSPI5-2003

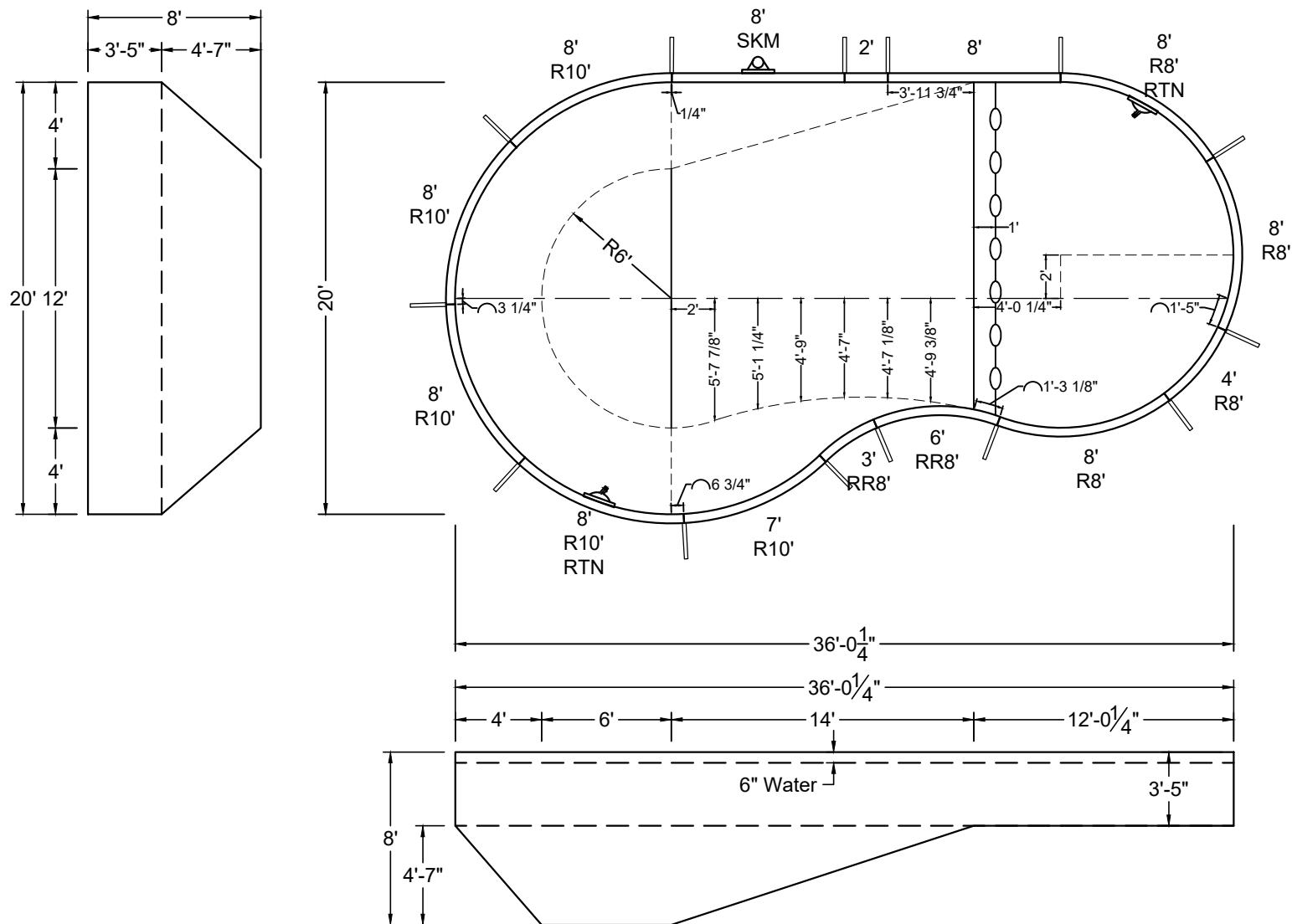

SHAPE : FLATBACK KIDNEY	SIZE : 20' X 36'	HAND : LEFT	PANEL HEIGHT : 3'-6"	PANEL TYPE : 5" TOP
PERIMETER : 94'	VOLUME : 22,447 US GAL.	SURFACE AREA : 563.069 SQ. FT.	SCALE : N.T.S	DRAWN BY : NM-BCC
DWG # : MN2036FK-19	DATE : 12/20/2016	REVISION # : 01	KIT REF : MN2036FK-19-L	A



DIVING / SLIDE EQUIPMENT DISCLAIMER:

THE BOTTOM CONFIGURATION SHOWN MEETS WITH THE CURRENT IPSC MINIMUM STANDARDS FOR POOLS APPROVED FOR THE USE WITH MANUFACTURED DIVING EQUIPMENT. ALL DIVING EQUIPMENT MUST BE INSTALLED AND LOCATED IN ACCORDANCE WITH THE DIVING / SLIDE MANUFACTURER'S RECOMMENDATIONS. IF DIVING EQUIPMENT IS INSTALLED: PLEASE FOLLOW ALL THE DIVING / SLIDE EQUIPMENT MANUFACTURER'S INSTALLATION, USE AND SAFETY INSTRUCTIONS.

MEETS DEPTH AND SHAPE MINIMUM STANDARD ANSI/NSPI5-2003

SHAPE : FLATBACK KIDNEY	SIZE : 20' X 36'	HAND : LEFT	PANEL HEIGHT : 3'-6"	DRAWN BY : NM-BCC
DWG # : MN2036FK-19	DATE : 12/20/2016	REVISION # : 01	KIT REF : MN2036FK-19-L	B

ALL DIMENSIONS ARE FINISHED

DIVING / SLIDE EQUIPMENT DISCLAIMER:

THE BOTTOM CONFIGURATION SHOWN MEETS WITH THE CURRENT ISPSA MINIMUM STANDARDS FOR POOLS APPROVED FOR THE USE WITH MANUFACTURED DIVING EQUIPMENT. ALL DIVING EQUIPMENT MUST BE INSTALLED AND LOCATED IN ACCORDANCE WITH THE DIVING / SLIDE MANUFACTURER'S RECOMMENDATIONS. IF DIVING EQUIPMENT IS INSTALLED: PLEASE FOLLOW ALL THE DIVING / SLIDE EQUIPMENT MANUFACTURER'S INSTALLATION, USE AND SAFETY INSTRUCTIONS.

MEETS DEPTH AND SHAPE MINIMUM STANDARD ANSI/NSPI5-2003

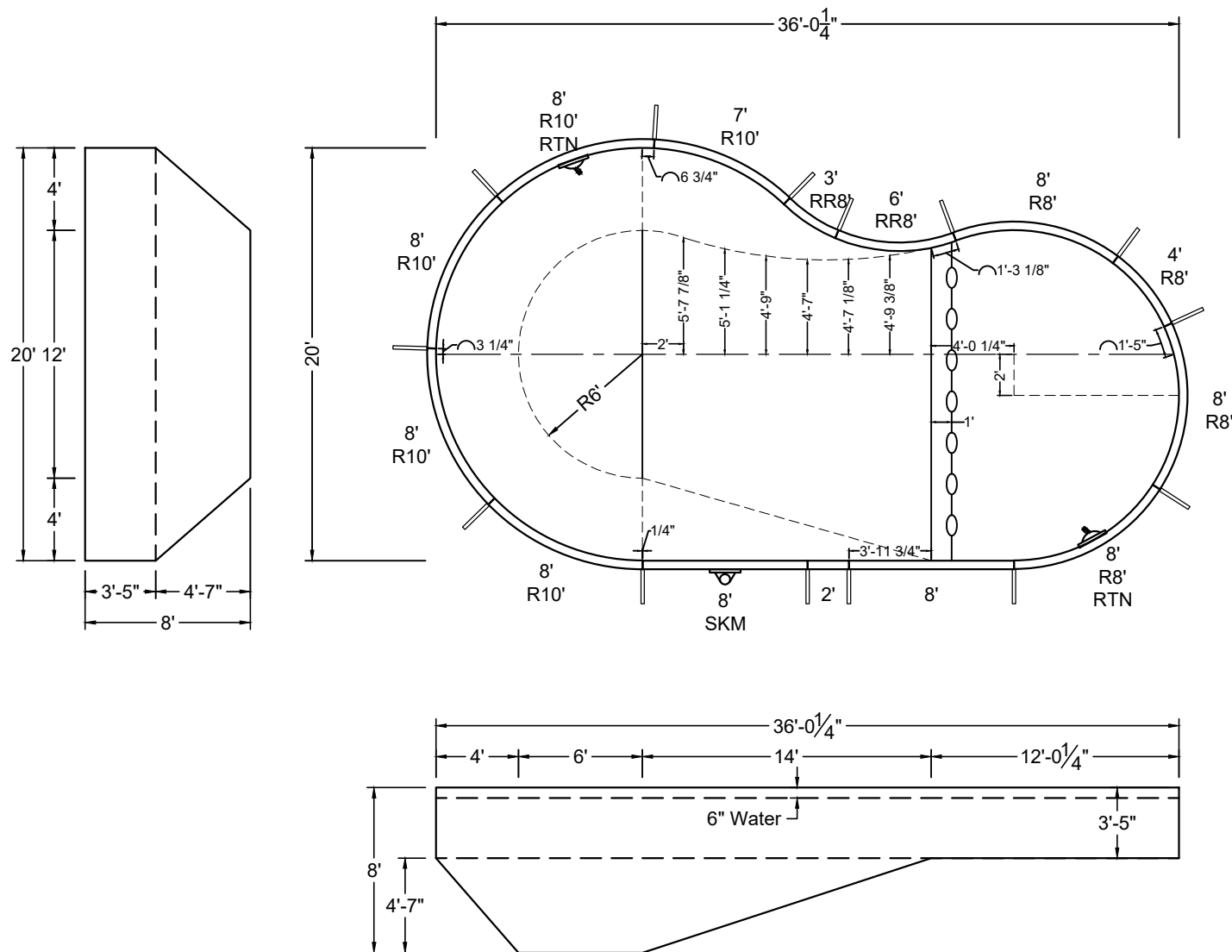

SHAPE : FLATBACK KIDNEY	SIZE : 20' X 36'	HAND : RIGHT	PANEL HEIGHT : 3'-6"	PANEL TYPE : 5" TOP
PERIMETER : 94'	VOLUME : 22,447 US GAL.	SURFACE AREA : 563.069 SQ. FT.	SCALE : N.T.S	DRAWN BY : NM-BCC
DWG # : MN2036FK-19	DATE : 12/20/2016	REVISION # : 01	KIT REF : MN2036FK-19-R	A

ALL DIMENSIONS ARE FINISHED

DIVING / SLIDE EQUIPMENT DISCLAIMER:

THE BOTTOM CONFIGURATION SHOWN MEETS WITH THE CURRENT ISPS MINIMUM STANDARDS FOR POOLS APPROVED FOR THE USE WITH MANUFACTURED DIVING EQUIPMENT. ALL DIVING EQUIPMENT MUST BE INSTALLED AND LOCATED IN ACCORDANCE WITH THE DIVING / SLIDE MANUFACTURER'S RECOMMENDATIONS. IF DIVING EQUIPMENT IS INSTALLED: PLEASE FOLLOW ALL THE DIVING / SLIDE EQUIPMENT MANUFACTURER'S INSTALLATION, USE AND SAFETY INSTRUCTIONS.

MEETS DEPTH AND SHAPE MINIMUM STANDARD ANSI/NSPI-2003

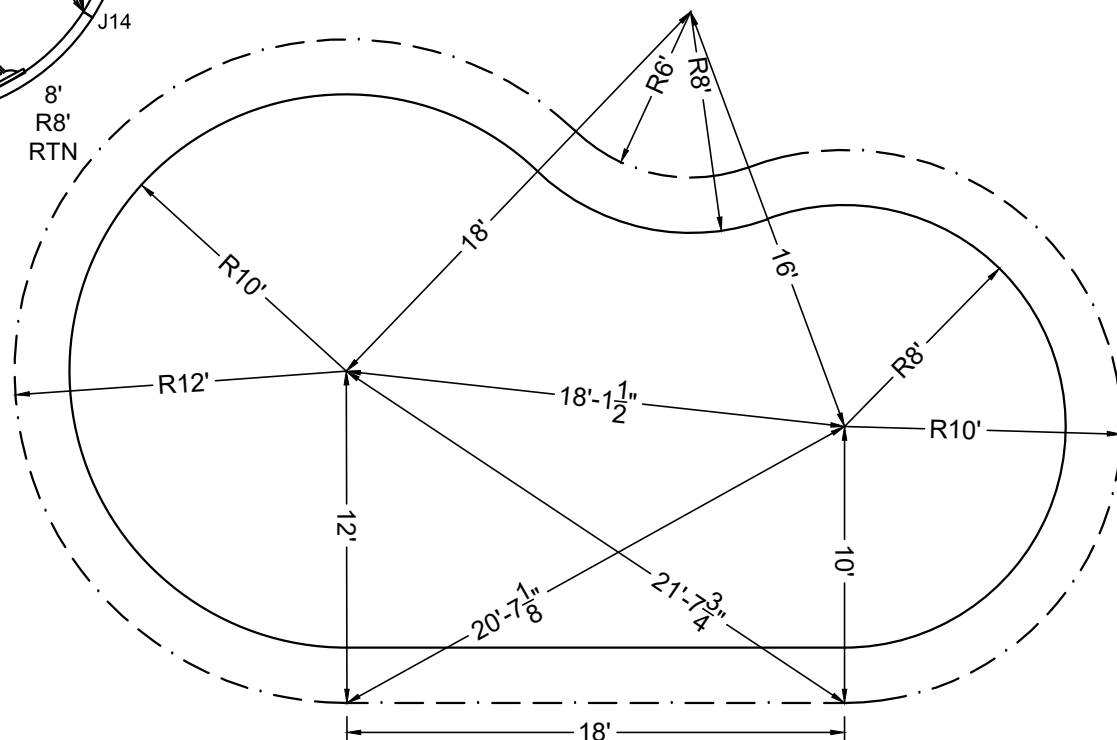
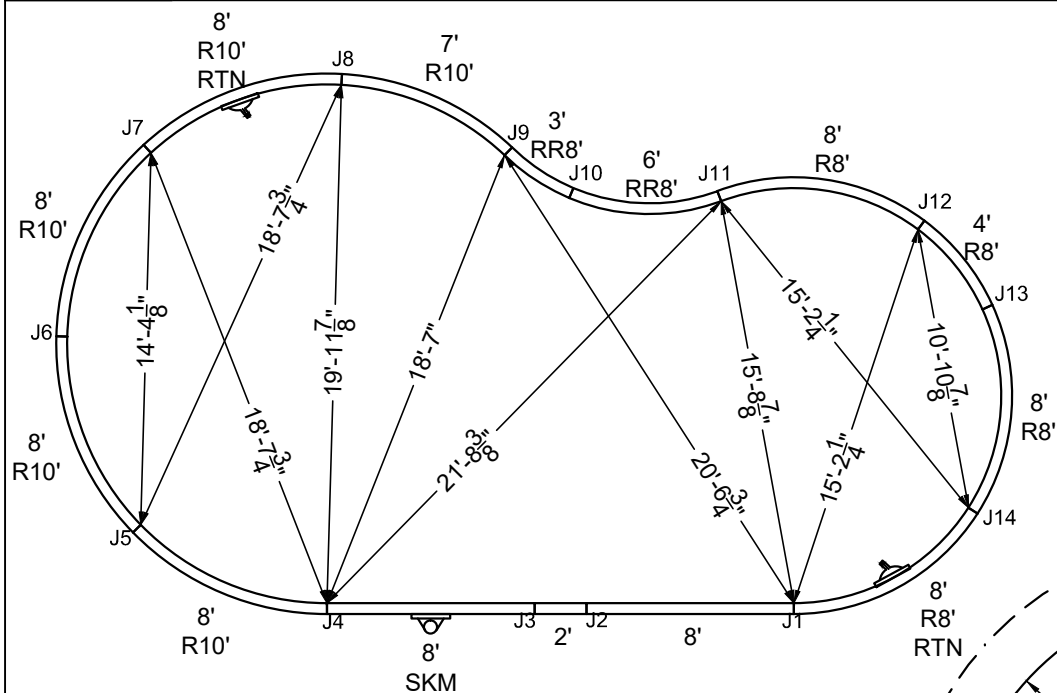

SHAPE: FLATBACK KIDNEY

SIZE: 20' X 36'

HAND: RIGHT

PANEL HEIGHT: 3'-6"

DRAWN BY: NM-BCC

DWG #: MN2036FK-19

DATE: 12/20/2016

REVISION #: 01

KIT REF: MN2036FK-19-R

B

ALL DIMENSIONS ARE FINISHED

DIVING / SLIDE EQUIPMENT DISCLAIMER:

THE BOTTOM CONFIGURATION SHOWN MEETS WITH THE CURRENT ISPS MINIMUM STANDARDS FOR POOLS APPROVED FOR THE USE WITH MANUFACTURED DIVING EQUIPMENT. ALL DIVING EQUIPMENT MUST BE INSTALLED AND LOCATED IN ACCORDANCE WITH THE DIVING / SLIDE MANUFACTURER'S RECOMMENDATIONS. IF DIVING EQUIPMENT IS INSTALLED: PLEASE FOLLOW ALL THE DIVING / SLIDE EQUIPMENT MANUFACTURER'S INSTALLATION, USE AND SAFETY INSTRUCTIONS.

MEETS DEPTH AND SHAPE MINIMUM STANDARD ANSI/NSPI-2003

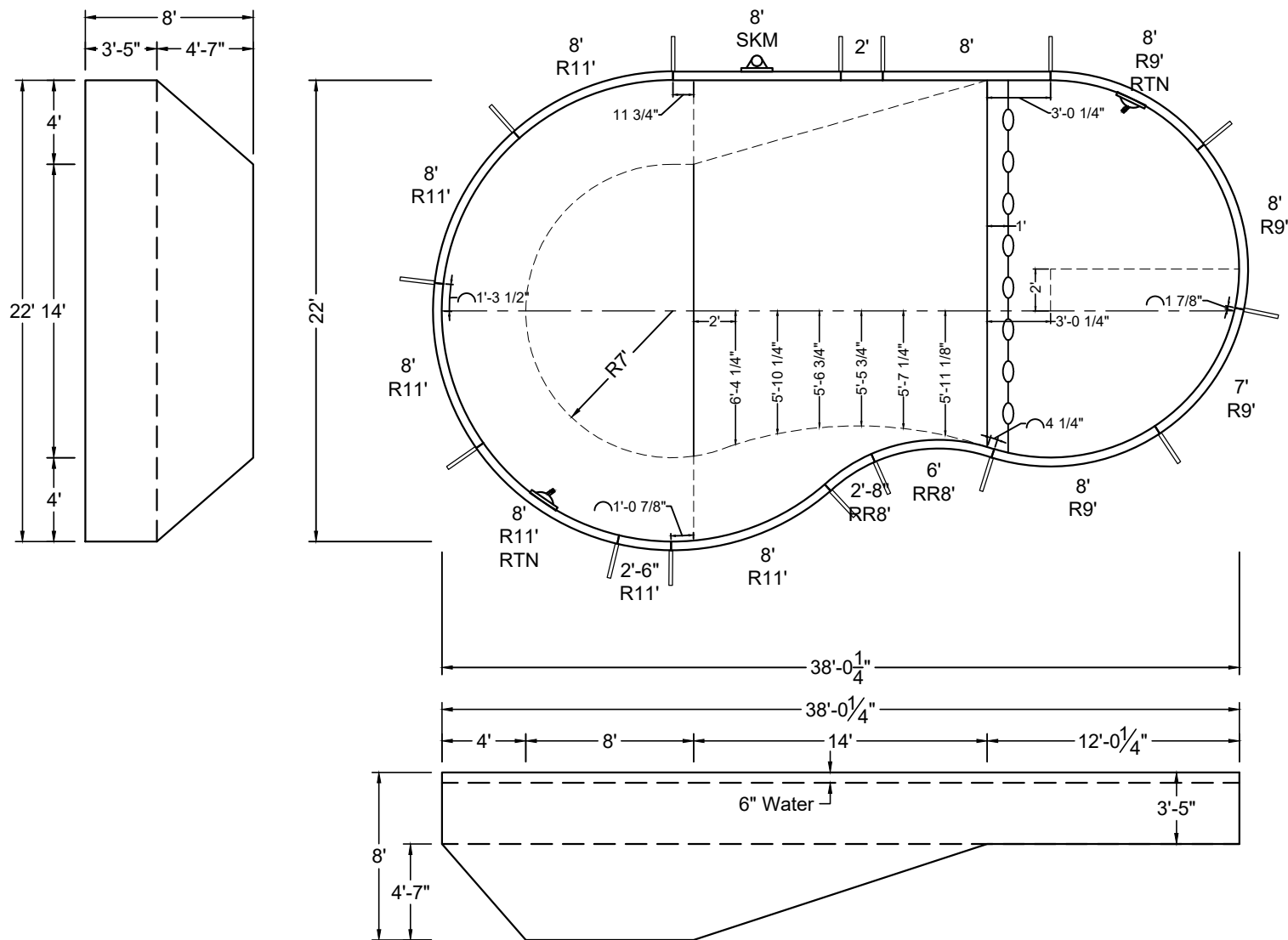

SHAPE : FLATBACK KIDNEY	SIZE : 22' X 38'	HAND : LEFT	PANEL HEIGHT : 3'-6"	PANEL TYPE : 5" TOP
PERIMETER : 100'-2"	VOLUME : 27,071 US GAL.	SURFACE AREA : 661.110 SQ. FT.	SCALE : N.T.S	DRAWN BY : NM-BCC
DWG # : MN2238FK-19	DATE : 12/21/2016	REVISION # : 01	KIT REF : MN2238FK-19-L	A

ALL DIMENSIONS ARE FINISHED

DIVING / SLIDE EQUIPMENT DISCLAIMER:

THE BOTTOM CONFIGURATION SHOWN MEETS WITH THE CURRENT ISPSC MINIMUM STANDARDS FOR POOLS APPROVED FOR THE USE WITH MANUFACTURED DIVING EQUIPMENT. ALL DIVING EQUIPMENT MUST BE INSTALLED AND LOCATED IN ACCORDANCE WITH THE DIVING / SLIDE MANUFACTURER'S RECOMMENDATIONS. IF DIVING EQUIPMENT IS INSTALLED: PLEASE FOLLOW ALL THE DIVING / SLIDE EQUIPMENT MANUFACTURER'S INSTALLATION, USE AND SAFETY INSTRUCTIONS.

MEETS DEPTH AND SHAPE MINIMUM STANDARD ANSI/NSPI5-2003

STEEL CHECK

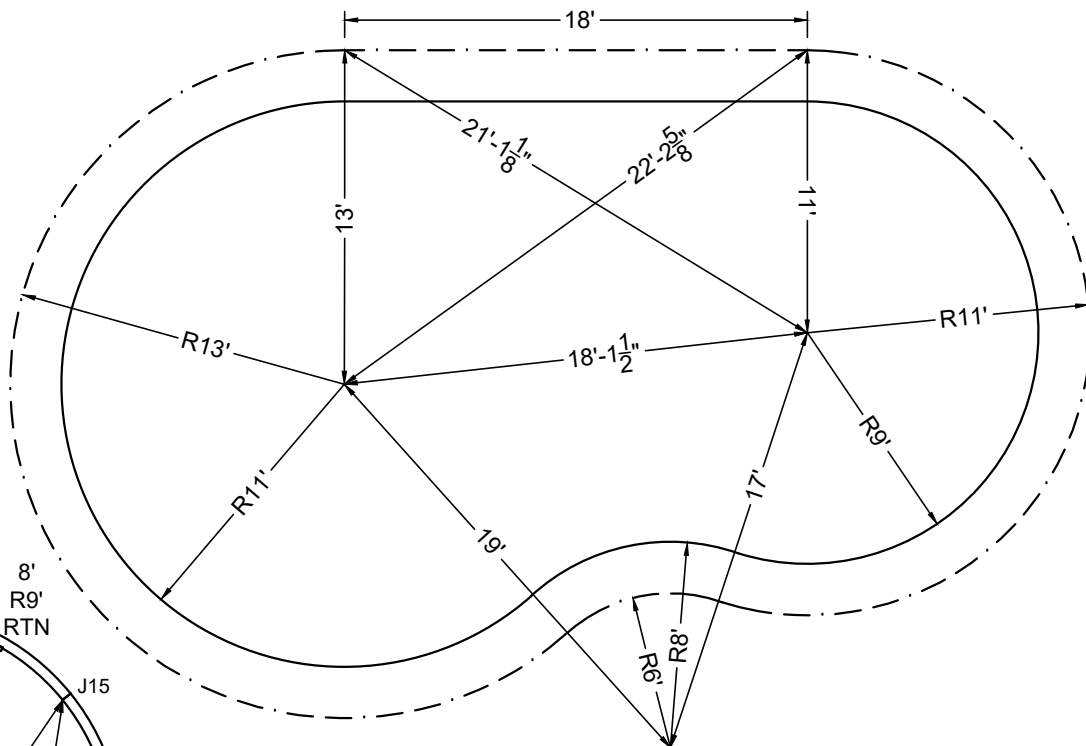
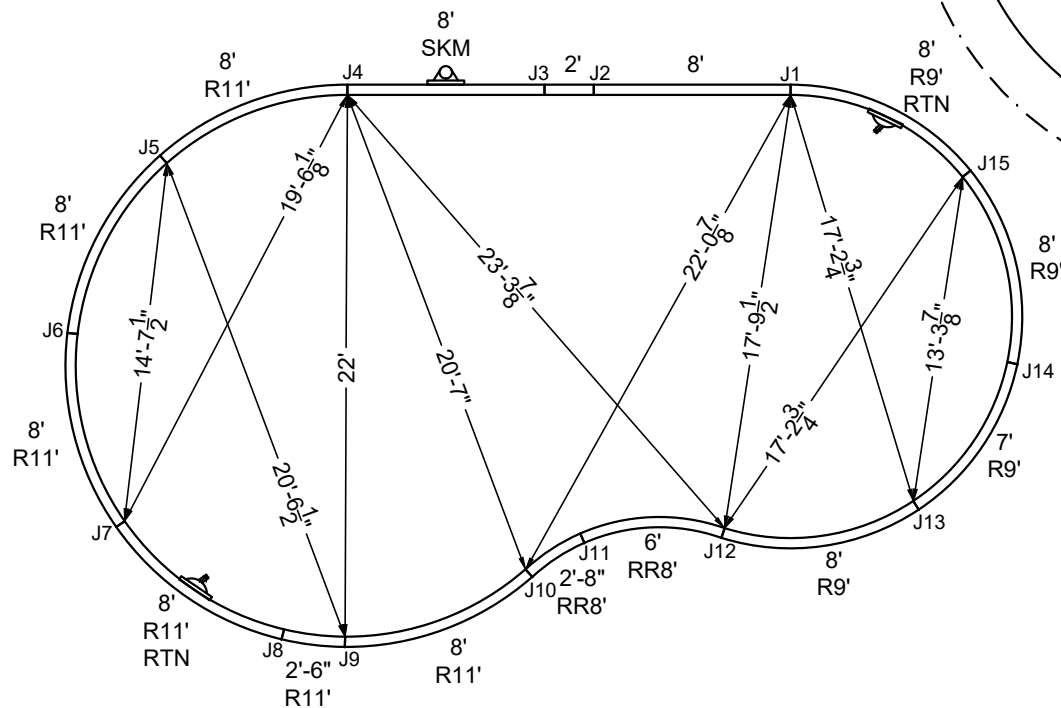

STAKE OUT

SHAPE : FLATBACK KIDNEY	SIZE : 22' X 38'	HAND : LEFT	PANEL HEIGHT : 3'-6"	DRAWN BY : NM-BCC
DWG # : MN2238FK-19	DATE : 12/21/2016	REVISION # : 01	KIT REF : MN2238FK-19-L	B

ALL DIMENSIONS ARE FINISHED

DIVING / SLIDE EQUIPMENT DISCLAIMER:

THE BOTTOM CONFIGURATION SHOWN MEETS WITH THE CURRENT ISPSC MINIMUM STANDARDS FOR POOLS APPROVED FOR THE USE WITH MANUFACTURED DIVING EQUIPMENT. ALL DIVING EQUIPMENT MUST BE INSTALLED AND LOCATED IN ACCORDANCE WITH THE DIVING / SLIDE MANUFACTURER'S RECOMMENDATIONS. IF DIVING EQUIPMENT IS INSTALLED: PLEASE FOLLOW ALL THE DIVING / SLIDE EQUIPMENT MANUFACTURER'S INSTALLATION, USE AND SAFETY INSTRUCTIONS.

MEETS DEPTH AND SHAPE MINIMUM STANDARD ANSI/NSPI5-2003

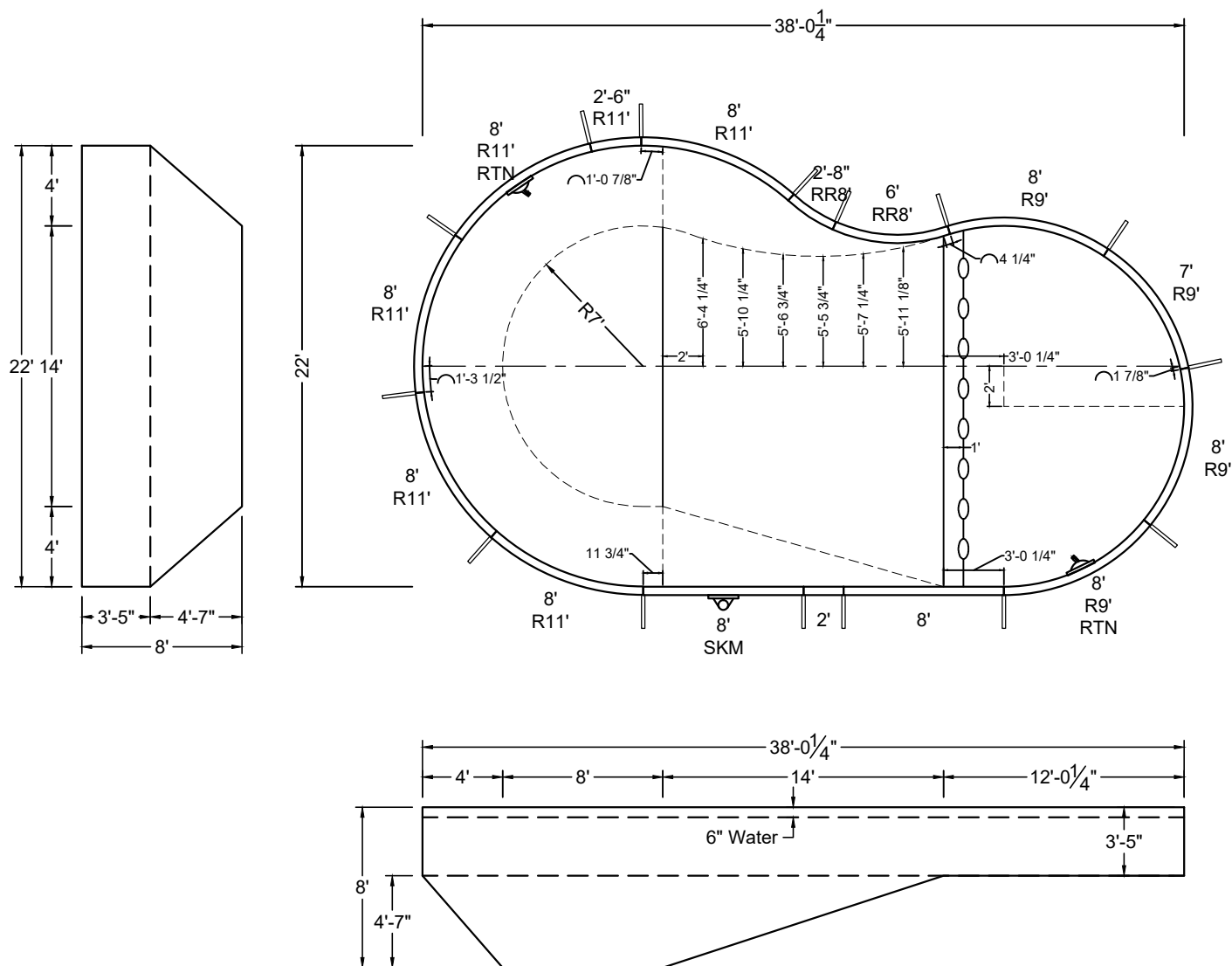

SHAPE: FLATBACK KIDNEY	SIZE: 22' X 38'	HAND: RIGHT	PANEL HEIGHT: 3'-6"	PANEL TYPE: 5" TOP
PERIMETER: 100'-2"	VOLUME: 27,071 US GAL.	SURFACE AREA: 661.110 SQ. FT.	SCALE: N.T.S	DRAWN BY: NM-BCC
DWG #: MN2238FK-19	DATE: 12/21/2016	REVISION #: 01	KIT REF: MN2238FK-19-R	A



DIVING / SLIDE EQUIPMENT DISCLAIMER:

THE BOTTOM CONFIGURATION SHOWN MEETS WITH THE CURRENT IPSPC MINIMUM STANDARDS FOR POOLS APPROVED FOR THE USE WITH MANUFACTURED DIVING EQUIPMENT. ALL DIVING EQUIPMENT MUST BE INSTALLED AND LOCATED IN ACCORDANCE WITH THE DIVING / SLIDE MANUFACTURER'S RECOMMENDATIONS. IF DIVING EQUIPMENT IS INSTALLED: PLEASE FOLLOW ALL THE DIVING / SLIDE EQUIPMENT MANUFACTURER'S INSTALLATION, USE AND SAFETY INSTRUCTIONS.

MEETS DEPTH AND SHAPE MINIMUM STANDARD ANSI/NSPI5-2003



STAKE OUT

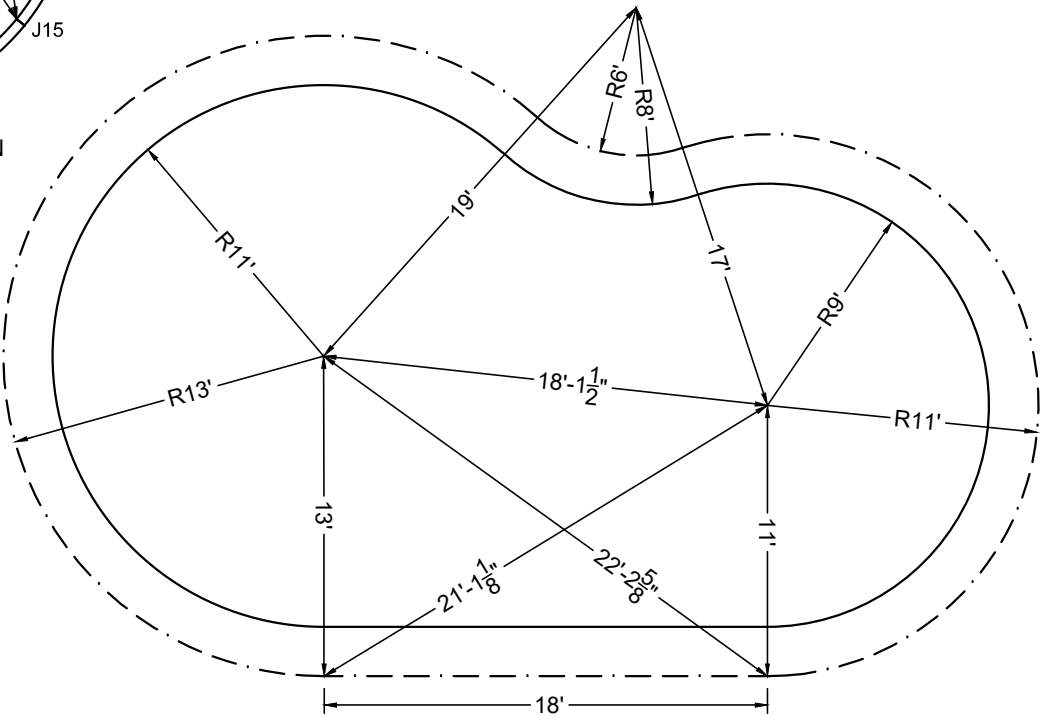

SHAPE : FLATBACK KIDNEY	SIZE : 22' X 38'	HAND : RIGHT	PANEL HEIGHT : 3'-6"	DRAWN BY : NM-BCC
DWG # : MN2238FK-19	DATE : 12/21/2016	REVISION # : 01	KIT REF : MN2238FK-19-R	B

ALL DIMENSIONS ARE FINISHED

DIVING / SLIDE EQUIPMENT DISCLAIMER:

THE BOTTOM CONFIGURATION SHOWN MEETS WITH THE CURRENT ISPC MINIMUM STANDARDS FOR POOLS APPROVED FOR THE USE WITH MANUFACTURED DIVING EQUIPMENT. ALL DIVING EQUIPMENT MUST BE INSTALLED AND LOCATED IN ACCORDANCE WITH THE DIVING / SLIDE MANUFACTURER'S RECOMMENDATIONS. IF DIVING EQUIPMENT IS INSTALLED: PLEASE FOLLOW ALL THE DIVING / SLIDE EQUIPMENT MANUFACTURER'S INSTALLATION, USE AND SAFETY INSTRUCTIONS.

MEETS DEPTH AND SHAPE MINIMUM STANDARD ANSI/NSPI5-2003

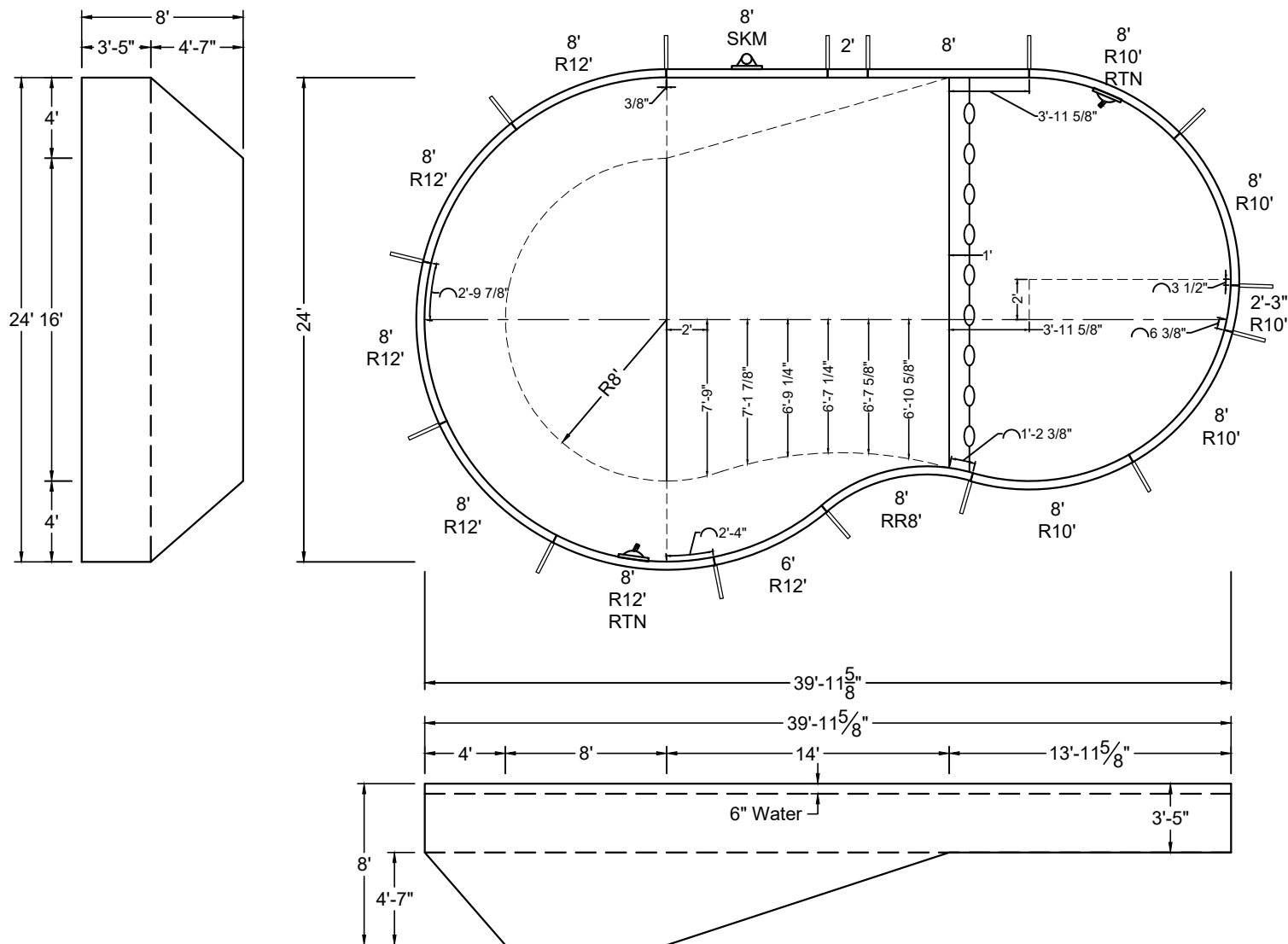

SHAPE: FLATBACK KIDNEY	SIZE: 24' X 40'	HAND: LEFT	PANEL HEIGHT: 3'-6"	PANEL TYPE: 5" TOP
PERIMETER: 106'-3"	VOLUME: 30,822 US GAL.	SURFACE AREA: 764.303 SQ. FT.	SCALE: N.T.S	DRAWN BY: NM-BCC
DWG #: MN2440FK-19	DATE: 12/21/2016	REVISION #: 01	KIT REF: MN2440FK-19-L	A



DIVING / SLIDE EQUIPMENT DISCLAIMER:

THE BOTTOM CONFIGURATION SHOWN MEETS WITH THE CURRENT IPSC MINIMUM STANDARDS FOR POOLS APPROVED FOR THE USE WITH MANUFACTURED DIVING EQUIPMENT. ALL DIVING EQUIPMENT MUST BE INSTALLED AND LOCATED IN ACCORDANCE WITH THE DIVING / SLIDE MANUFACTURER'S RECOMMENDATIONS. IF DIVING EQUIPMENT IS INSTALLED: PLEASE FOLLOW ALL THE DIVING / SLIDE EQUIPMENT MANUFACTURER'S INSTALLATION, USE AND SAFETY INSTRUCTIONS.

MEETS DEPTH AND SHAPE MINIMUM STANDARD ANSI/NSPI5-2003

SHAPE : FLATBACK KIDNEY	SIZE : 24' X 40'	HAND : LEFT	PANEL HEIGHT : 3'-6"	DRAWN BY : NM-BCC
DWG # : MN2440FK-19	DATE : 12/21/2016	REVISION # : 01	KIT REF : MN2440FK-19-L	B

ALL DIMENSIONS ARE FINISHED

DIVING / SLIDE EQUIPMENT DISCLAIMER:

THE BOTTOM CONFIGURATION SHOWN MEETS WITH THE CURRENT ISPSC MINIMUM STANDARDS FOR POOLS APPROVED FOR THE USE WITH MANUFACTURED DIVING EQUIPMENT. ALL DIVING EQUIPMENT MUST BE INSTALLED AND LOCATED IN ACCORDANCE WITH THE DIVING / SLIDE MANUFACTURER'S RECOMMENDATIONS. IF DIVING EQUIPMENT IS INSTALLED: PLEASE FOLLOW ALL THE DIVING / SLIDE EQUIPMENT MANUFACTURER'S INSTALLATION, USE AND SAFETY INSTRUCTIONS.

MEETS DEPTH AND SHAPE MINIMUM STANDARD ANSI/NSPI5-2003

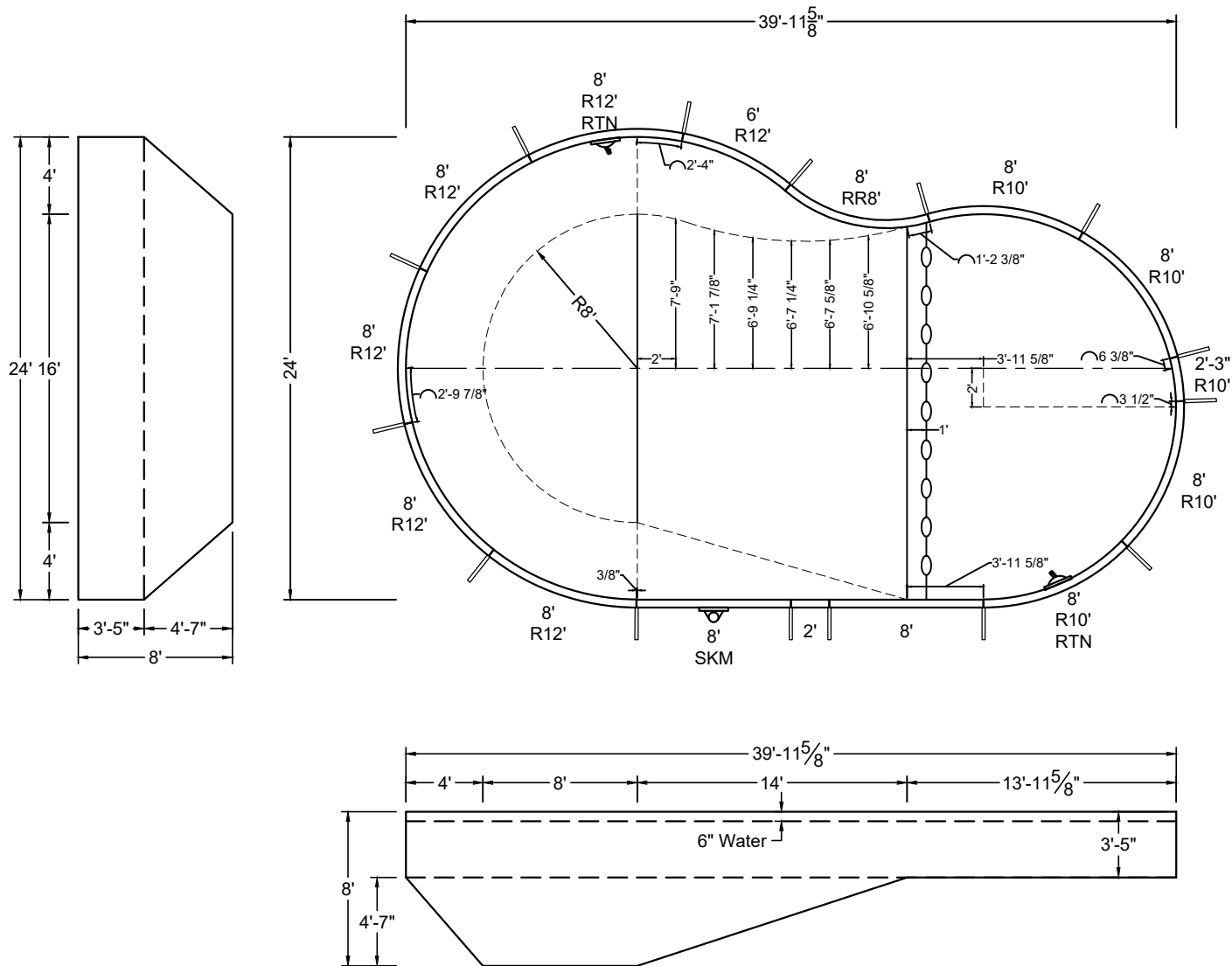

SHAPE : FLATBACK KIDNEY	SIZE : 24' X 40'	HAND : RIGHT	PANEL HEIGHT : 3'-6"	PANEL TYPE : 5" TOP
PERIMETER : 106'-3"	VOLUME : 30,822 US GAL.	SURFACE AREA : 764.303 SQ. FT.	SCALE : N.T.S	DRAWN BY : NM-BCC
DWG # : MN2440FK-19	DATE : 12/21/2016	REVISION # : 01	KIT REF : MN2440FK-19-R	A



DIVING / SLIDE EQUIPMENT DISCLAIMER:

THE BOTTOM CONFIGURATION SHOWN MEETS WITH THE CURRENT IPSC MINIMUM STANDARDS FOR POOLS APPROVED FOR THE USE WITH MANUFACTURED DIVING EQUIPMENT. ALL DIVING EQUIPMENT MUST BE INSTALLED AND LOCATED IN ACCORDANCE WITH THE DIVING / SLIDE MANUFACTURER'S RECOMMENDATIONS. IF DIVING EQUIPMENT IS INSTALLED: PLEASE FOLLOW ALL THE DIVING / SLIDE EQUIPMENT MANUFACTURER'S INSTALLATION, USE AND SAFETY INSTRUCTIONS.

MEETS DEPTH AND SHAPE MINIMUM STANDARD ANSI/NSPI5-2003



SHAPE : FLATBACK KIDNEY	SIZE : 24' X 40'	HAND : RIGHT	PANEL HEIGHT : 3'-6"	DRAWN BY : NM-BCC
DWG # : MN2440FK-19	DATE : 12/21/2016	REVISION # : 01	KIT REF : MN2440FK-19-R	B